

Western Snow Plow Solenoid Wiring Diagram

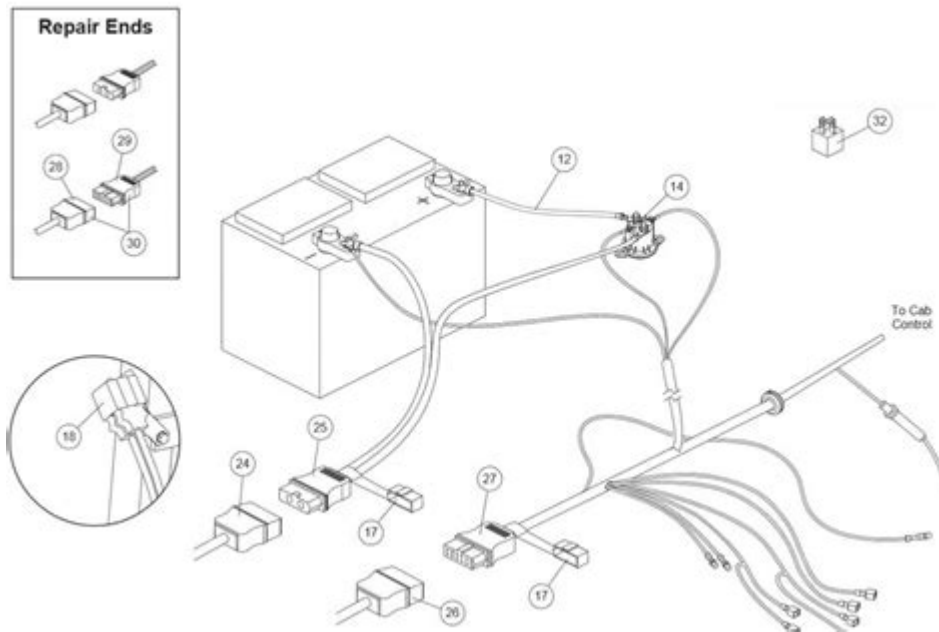

Western snow plow solenoid wiring diagram is an essential topic for anyone who owns or operates a Western snow plow. Understanding how to wire the solenoid correctly is crucial for ensuring that the plow operates efficiently and effectively. In this article, we will explore the various components of the solenoid system, provide a detailed wiring diagram, and offer tips for troubleshooting common issues. Whether you are a seasoned plow operator or a novice, this guide will help you navigate the complexities of Western snow plow solenoid wiring.

Understanding the Solenoid's Role in Snow Plow Operation

A solenoid is an electromagnetic switch that controls the flow of electricity to various components of the snow plow, such as the hydraulic pump and motor. When the operator engages the plow, the solenoid activates, allowing power to flow to the necessary components for raising, lowering, and angling the plow.

Key Functions of the Solenoid

1. **Power Distribution:** The solenoid directs power from the battery to the hydraulic pump and motor.
2. **Control of Hydraulic Functions:** It enables the operator to control the plow's movements effectively.
3. **Safety Features:** The solenoid acts as a fail-safe mechanism, preventing electrical overloads and ensuring safe operation.

Components of the Western Snow Plow Solenoid System

To successfully wire a Western snow plow solenoid, it is essential to understand the various components involved in the system. Here are the main elements:

1. Solenoid

The solenoid itself is a cylindrical device that houses an electromagnetic coil. It typically has four terminals that connect to the battery, control switch, and hydraulic pump.

2. Battery

The battery provides the necessary electrical power to the solenoid. A well-charged battery is crucial for optimal performance.

3. Control Switch

The control switch is located inside the vehicle and is used by the operator to activate the plow functions. It sends a signal to the solenoid to control the hydraulic pump.

4. Hydraulic Pump

This component is responsible for moving the hydraulic fluid that operates the plow's lifting and angling mechanisms.

5. Wiring Harness

The wiring harness connects all the components, ensuring proper electrical flow throughout the system.

Wiring Diagram for Western Snow Plow Solenoid

A wiring diagram is a visual representation of how the components of the solenoid system connect to one another. Below is a simplified version of the wiring diagram for a typical Western snow plow solenoid setup:

- Battery (+): Connects to the solenoid's terminal marked as "B" (Battery).
- Battery (-): Connects to the vehicle's ground.
- Control Switch:
 - The switch connects to the solenoid's terminal marked as "S" (Signal).
 - The other side of the switch connects to the vehicle's ground.
- Hydraulic Pump:

- Connects to the solenoid's terminal marked as "P" (Pump).
- The other side of the pump connects to the hydraulic system.

For a more detailed wiring diagram, it is advisable to consult the manufacturer's service manual or specific wiring guides provided by Western.

Sample Wiring Diagram Layout

```

```
[Battery +] ----> [Solenoid B]
[Control Switch] ----> [Solenoid S]
[Solenoid P] ----> [Hydraulic Pump]
[Battery -] ----> [Vehicle Ground]
```

```

Step-by-Step Wiring Instructions

Now that we understand the components and have a diagram, let's walk through the wiring process step by step.

Tools and Materials Needed

- Wire strippers
- Electrical tape
- Multimeter
- 12-volt battery
- Western snow plow solenoid
- Compatible wiring harness

Step 1: Disconnect the Battery

Before beginning any electrical work, ensure that the vehicle's battery is disconnected to prevent any accidental shorts or shocks.

Step 2: Identify and Prepare Wires

Using wire strippers, prepare the ends of the wires that will connect to the solenoid and other components. Make sure to remove about half an inch of insulation for a good connection.

Step 3: Connect Battery Wires

- Connect the positive battery cable to the "B" terminal on the solenoid.

- Ensure that the negative battery cable is securely connected to the vehicle's ground.

Step 4: Connect the Control Switch

- Connect one side of the control switch to the "S" terminal on the solenoid.
- Connect the other side of the control switch to the vehicle's ground.

Step 5: Connect the Hydraulic Pump

- Connect the hydraulic pump's positive wire to the "P" terminal on the solenoid.
- Connect the other side of the pump to the hydraulic system as per the manufacturer's specifications.

Step 6: Double-Check Connections

After connecting all wires, double-check each connection to ensure they are secure and correctly placed.

Step 7: Reconnect the Battery

Once all connections are confirmed, reconnect the vehicle's battery and perform a functionality test.

Troubleshooting Common Issues

Even with correct wiring, issues may arise from time to time. Here are some common problems and their solutions:

1. Plow Not Responding

- Check Battery: Ensure the battery is charged and the connections are tight.
- Inspect Wiring: Look for frayed or damaged wires that may be interrupting the signal.

2. Solenoid Clicking but No Movement

- Check the Hydraulic Fluid: Low hydraulic fluid levels can hinder operation.
- Inspect Solenoid: A faulty solenoid may need replacement.

3. Inconsistent Functioning

- Loose Connections: Make sure all connections are tight and secure.
- Corroded Terminals: Clean any corrosion from terminals and connectors.

Conclusion

Understanding the Western snow plow solenoid wiring diagram is crucial for anyone looking to maintain or operate a Western snow plow. By familiarizing yourself with the components, following the wiring instructions, and knowing how to troubleshoot common issues, you can ensure your snow plow works efficiently when you need it most. With the right tools and knowledge, you can tackle any wiring challenge confidently, keeping your plow ready for winter conditions.

Frequently Asked Questions

What is the purpose of the solenoid in a Western snow plow?

The solenoid in a Western snow plow is responsible for controlling the flow of electricity to the plow's hydraulic system, enabling the movement of the plow blade.

Where can I find a wiring diagram for my Western snow plow solenoid?

You can find a wiring diagram for your Western snow plow solenoid in the owner's manual, on the manufacturer's website, or through online forums dedicated to snow plowing.

How do I troubleshoot a solenoid issue on my Western snow plow?

To troubleshoot a solenoid issue, check the wiring connections for any signs of damage, ensure the solenoid is receiving power, and test the solenoid with a multimeter for proper function.

What are common symptoms of a faulty solenoid in a Western snow plow?

Common symptoms of a faulty solenoid include the plow not responding to controls, intermittent operation, or complete power failure to the hydraulic system.

Can I replace the solenoid on my Western snow plow myself?

Yes, you can replace the solenoid yourself if you have basic mechanical skills and follow proper safety precautions, including disconnecting the battery.

What tools do I need to rewire the solenoid on my

Western snow plow?

You will typically need basic hand tools such as a wrench set, screwdriver set, wire strippers, and electrical tape for rewiring the solenoid.

Is there a specific wire color code for Western snow plow solenoid wiring?

Yes, Western snow plow solenoids usually follow a specific wire color code, but it can vary by model, so always refer to the wiring diagram specific to your model.

What should I do if I can't find the wiring diagram for my Western snow plow solenoid?

If you can't find the wiring diagram, consider contacting Western's customer support, visiting their website, or seeking help from online snow plow communities and forums.

Find other PDF article:

<https://soc.up.edu.ph/13-note/pdf?ID=gWO66-0135&title=coding-sheet-for-content-analysis.pdf>

Western Snow Plow Solenoid Wiring Diagram

Western and non-indigenous women participating in tribal nudity

A sub for sharing western and non-indigenous people participating in tribal or other forms of ritual or customary nudity as well as peoples in western/urbanized countries participating local, non-sexual customary nudity (ie. Finnish Sauna or Japanese Onsen). Please post authentic (18+) photos only. No staged porn or porn in general.

The University of Western Ontario - Reddit

A subreddit for students, faculty, staff, and alumni at Western University in London, Ontario, Canada. We are not officially affiliated with the University and Western is not responsible for the content of this subreddit

western blot ...

western blot ... 30min buffer ... 27

Western blot ...

Western blot Western blot

The original and only 2westerneurope4u - Reddit

Ironical ultranationalistic memes about Western European countries (Netherlands, Luxembourg, Germany, France, Italy, Spain, Portugal, Greece, UK, Ireland, Denmark (incl ...

[illegible]

As we search for frugal fashions, some online clothing companies remain poised to scam us. You know the ones; they constantly pop up as sponsored ads on Facebook and Instagram. The pictures usually don't show the model's head and promises these amazing designs for \$10.

Mar 27, 2022 · I did the RN to MSN program and I really liked it. I recommend WGU to everyone. It's a go at your own pace program. You have to do a minimum, but you can take your time or go through it fast if you want. I had one term that I only did 4 classes and another one that I did 7. I wanted it get it wrapped up toward the end, so I looked ahead the term prior and turned in the ...

Western blot (WB) analysis of the protein expression levels of the target protein in the cells treated with the compound.

As we search for frugal fashions, some online clothing companies remain poised to scam us. You know the ones; they constantly pop up as sponsored ads on Facebook and Instagram. The ...

Western governors university (Wgu) : r/nursing - Reddit

Mar 27, 2022 · I did the RN to MSN program and I really liked it. I recommend WGU to everyone. It's a go at your own pace program. You have to do a minimum, but you can take your time or go ...

Western Martial Arts - Reddit

A subreddit for discussing historical fencing and martial arts, specifically European (HEMA/WMA).
Our Discord - <https://discord.gg/qstdj6a>

western blot -

Western blot () WB ...

Discover the essential Western snow plow solenoid wiring diagram to ensure optimal performance.
Learn how to wire it correctly for efficient snow removal!

[Back to Home](#)