

Wen 3500 Generator Parts Diagram

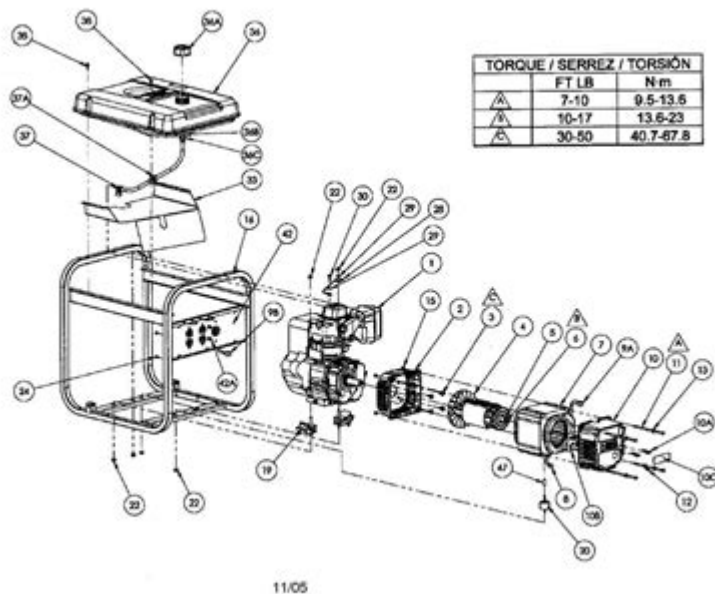

WEN 3500 generator parts diagram is an essential resource for anyone looking to understand the inner workings of the WEN 3500 generator. This generator, known for its reliability and efficiency, is a popular choice for homeowners, contractors, and outdoor enthusiasts alike. Understanding the parts diagram not only aids in maintenance and repairs but also helps users to troubleshoot issues effectively. This article will delve into the various components of the WEN 3500 generator, how they function, and the importance of each part as depicted in the parts diagram.

Overview of the WEN 3500 Generator

The WEN 3500 generator is a portable power solution that delivers a maximum output of 3500 watts, making it suitable for a range of applications, from powering tools on job sites to providing emergency backup during power outages. It features a robust design and is equipped with a 4-stroke engine for efficient performance. To maintain optimal functionality, it is crucial to understand the generator's parts and how they work together.

Understanding the Parts Diagram

A parts diagram serves as a visual representation of the various components within the WEN 3500 generator. This diagram is beneficial for identifying

parts, understanding their locations, and facilitating repairs or replacements. Here's a breakdown of the primary components typically found in the parts diagram of the WEN 3500 generator:

1. Engine Components

The engine is the heart of the WEN 3500 generator. Key components include:

- Cylinder Block: Houses the cylinders and provides support for the engine.
- Piston: Moves up and down within the cylinder, creating the power needed to turn the generator.
- Crankshaft: Converts the linear motion of the piston into rotational motion.
- Valves: Control the intake of air and fuel and the exhaust of gases.
- Ignition System: Responsible for igniting the fuel-air mixture for combustion.

2. Fuel System

The fuel system is crucial for the generator's operation. Important parts include:

- Fuel Tank: Stores the gasoline needed to power the engine.
- Fuel Pump: Moves fuel from the tank to the engine.
- Carburetor: Mixes air and fuel for combustion.
- Fuel Filter: Removes impurities from the fuel to protect the engine.

3. Electrical Components

The electrical system of the WEN 3500 generator is vital for generating and distributing power. Components include:

- Alternator: Converts mechanical energy from the engine into electrical energy.
- Voltage Regulator: Maintains a steady output voltage.
- Battery: Provides power for starting the engine and running electrical components.
- Circuit Breaker: Protects the generator from overloads.

4. Frame and Chassis

The frame supports and protects the internal components while facilitating mobility. Key features include:

- Base Frame: Provides stability and support for the generator.
- Wheels: Allow for easy transportation of the generator.
- Handle: Aids in maneuvering the generator.

5. Exhaust System

The exhaust system is responsible for expelling gases produced during combustion. Key parts include:

- Exhaust Pipe: Directs exhaust gases away from the engine.
- Muffler: Reduces noise from the exhaust system.

Importance of Each Component

Understanding the function of each component in the WEN 3500 generator helps users maintain the generator effectively and troubleshoot issues. Here's why each section is important:

Engine Components

The engine components are crucial for the generator's performance. Regular maintenance, such as oil changes and checking spark plugs, ensures the engine runs smoothly and efficiently.

Fuel System

The fuel system must be kept clean and free of blockages. Contaminated fuel can cause engine problems, leading to poor performance or failure to start. Regularly checking the fuel filter and ensuring the carburetor is clean will prolong the life of the generator.

Electrical Components

Electrical components are vital for generating power. Regular checks on the alternator and voltage regulator can prevent electrical failures. Users should also ensure that connections are tight and free of corrosion.

Frame and Chassis

A sturdy frame is essential for maintaining the integrity of the generator. Inspecting the frame for any signs of wear or damage ensures that the generator remains stable and secure during operation.

Exhaust System

The exhaust system must be free of blockages to prevent back pressure, which can damage the engine. Regular cleaning and inspection will ensure that exhaust gases are effectively expelled, contributing to better engine performance.

Common Issues and Troubleshooting Techniques

Even with regular maintenance, users may encounter issues with their WEN 3500 generator. Here are some common problems and troubleshooting techniques:

1. Generator Won't Start

- Check Fuel Level: Ensure there is enough fuel in the tank.
- Inspect Battery: Make sure the battery is charged and connections are secure.
- Examine the Ignition System: Check the spark plug for wear or damage.

2. Low Power Output

- Inspect the Load: Ensure the generator is not overloaded.
- Check the Alternator: Look for signs of wear or damage.
- Examine Fuel Quality: Use fresh, clean fuel to avoid performance issues.

3. Excessive Noise

- Inspect the Muffler: Ensure it is not clogged or damaged.
- Check for Loose Components: Tighten any loose bolts or screws that may contribute to noise.

4. Overheating

- Check Oil Levels: Ensure the engine has sufficient oil.
- Inspect Air Filter: A clogged air filter can restrict airflow, causing the

engine to overheat.

Conclusion

The **WEN 3500 generator parts diagram** is a valuable tool for anyone who owns or operates this generator. By understanding the various components and their functions, users can perform effective maintenance, troubleshoot problems, and ensure their generator operates optimally. Regular checks and upkeep of the engine, fuel system, electrical components, frame, and exhaust system will prolong the life of the generator and enhance its performance. Whether for home use, work, or recreational activities, a well-maintained WEN 3500 generator can provide reliable power whenever it's needed.

Frequently Asked Questions

What is a WEN 3500 generator parts diagram?

A WEN 3500 generator parts diagram is a visual representation that outlines the various components and parts of the WEN 3500 generator, helping users identify and understand each part's function.

Where can I find a WEN 3500 generator parts diagram?

You can find a WEN 3500 generator parts diagram on the official WEN website, in the product manual, or through authorized dealers and repair shops.

Why is it important to have a parts diagram for the WEN 3500 generator?

Having a parts diagram is important for troubleshooting, maintenance, and repairs, as it helps users locate specific components and understand how they fit together.

What are the common parts illustrated in a WEN 3500 generator parts diagram?

Common parts include the engine, fuel tank, control panel, wheels, exhaust system, and electrical components like the starter and alternator.

How can I use a parts diagram for repairs on my WEN 3500 generator?

You can use the parts diagram to identify the specific components that need repair or replacement, ensuring you order the correct parts and understand how to access them.

Are there any online resources for WEN 3500 generator parts diagrams?

Yes, several online resources, including forums, repair websites, and video tutorials, provide access to WEN 3500 generator parts diagrams and related repair guides.

What should I do if I can't find a specific part in the WEN 3500 generator parts diagram?

If you can't find a specific part, check the product manual, contact WEN customer service, or consult a professional mechanic for assistance.

Can I download a WEN 3500 generator parts diagram?

Yes, many websites, including the WEN official site, offer downloadable PDF versions of the parts diagram for the WEN 3500 generator.

Is it possible to get replacement parts for the WEN 3500 generator using the parts diagram?

Yes, you can use the parts diagram to identify and order replacement parts from authorized dealers or online retailers.

Find other PDF article:

<https://soc.up.edu.ph/49-flash/pdf?docid=mFB02-4237&title=public-relations-strategies-and-tactics.pdf>

[Wen 3500 Generator Parts Diagram](#)

WEN® Cleansing Conditioner & Styling Products | WEN® by Chaz ...

WEN ® Hair Care Adds body, bounce, and shine for beautiful, healthy-looking hair.

301 Moved Permanently

301 Moved Permanently301 Moved Permanently nginx

WEN® Cleansing Conditioner & Styling Products | WEN® by Chaz ...

WEN ® Hair Care Adds body, bounce, and shine for beautiful, healthy-looking hair.

301 Moved Permanently

301 Moved Permanently301 Moved Permanently nginx

Explore our detailed wen 3500 generator parts diagram to easily identify components and enhance

your generator's performance. Learn more for efficient repairs!

[Back to Home](#)