

Weber Genesis E 330 Parts Diagram

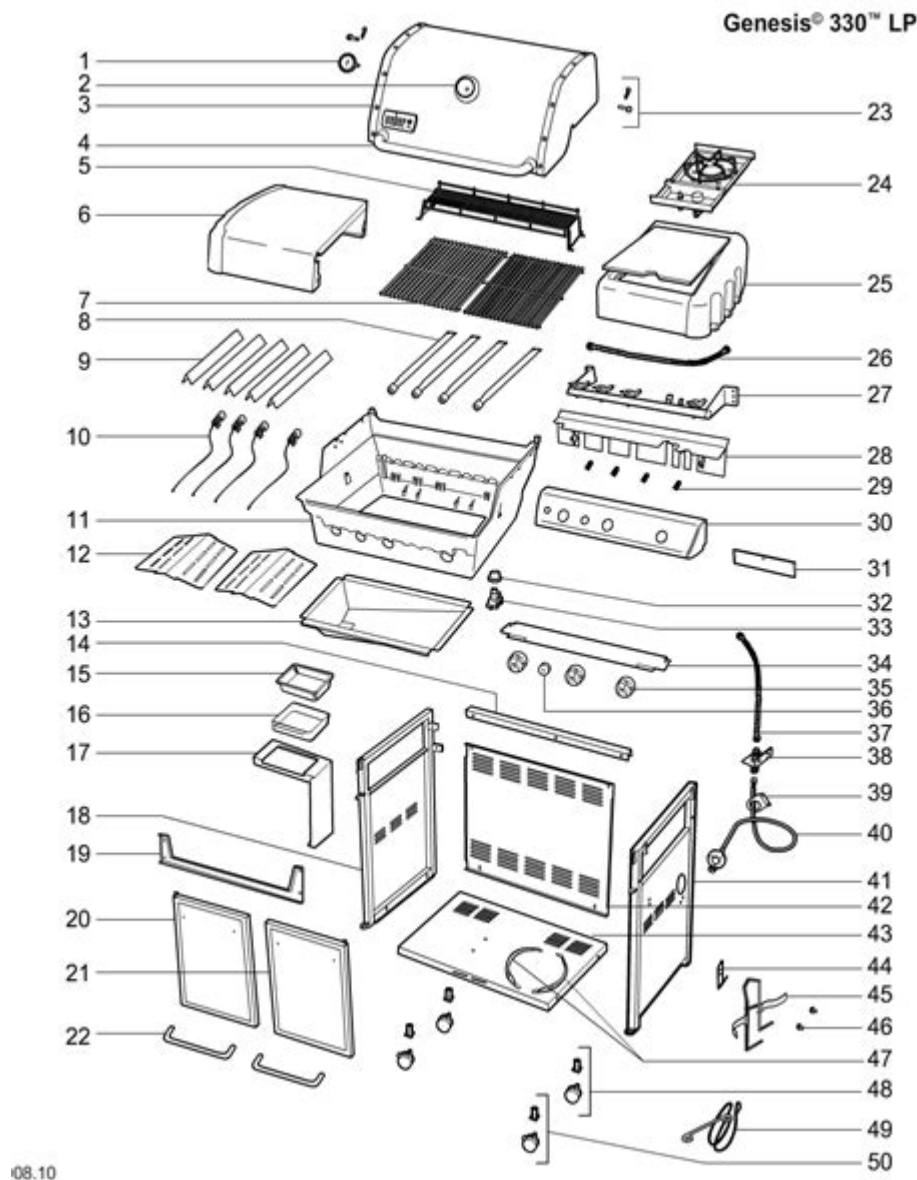

Weber Genesis E 330 Parts Diagram is an essential resource for any grill owner looking to maintain or repair their Weber Genesis E 330 gas grill. The Weber Genesis E 330 is renowned for its high-quality construction, exceptional grilling performance, and a variety of features that make it a favorite among grilling enthusiasts. Understanding the parts diagram helps users identify components, making it easier to troubleshoot issues or perform regular maintenance. In this article, we will delve into the various components of the Weber Genesis E 330, explore common issues, and provide maintenance tips to keep your grill in optimal condition.

Overview of the Weber Genesis E 330

The Weber Genesis E 330 is a three-burner gas grill that stands out for its versatility and functionality. It is equipped with a variety of features, including:

- Stainless steel burners for even heat distribution.
- Flavorizer bars that enhance the flavor of food while preventing flare-ups.
- Porcelain-enameled cast-iron cooking grates for excellent heat retention and easy cleaning.
- Side burner for additional cooking options.
- Built-in thermometer for accurate temperature readings.

Understanding the parts and their functions is crucial for anyone looking to maximize their grilling experience with this model.

Parts of the Weber Genesis E 330

To effectively utilize the Weber Genesis E 330, it's important to know the key components that make up the grill. The parts diagram provides a visual representation of these components, allowing users to easily identify each part. Below is a breakdown of the major components you'll find in the Weber Genesis E 330.

1. Burners

The grill features three stainless steel burners, which are responsible for generating heat. Each burner can be controlled independently for precise temperature management.

- Material: Stainless steel
- Function: Provides even heat and can be adjusted for different cooking needs.

2. Flavorizer Bars

These bars sit above the burners and help direct heat and smoke towards the food, enhancing flavor while catching drippings that can cause flare-ups.

- Material: Porcelain-enameled steel or stainless steel
- Function: Enhances flavor and reduces flare-ups.

3. Cooking Grates

The cooking grates are where the food is placed for grilling. They are designed to hold heat well and provide grill marks on the food.

- Material: Porcelain-enameled cast iron
- Function: Durable cooking surface that retains heat.

4. Ignition System

The ignition system is crucial for lighting the burners quickly and safely.

- Type: Electronic ignition
- Function: Provides a quick and reliable way to ignite the burners.

5. Heat Deflectors

These components help distribute heat evenly across the grilling surface.

- Material: Often made of metal or ceramic
- Function: Ensures uniform cooking temperatures.

6. Side Burner

The Genesis E 330 features a side burner, allowing for additional cooking options, such as warming sauces or side dishes.

- Type: Single burner
- Function: Provides extra cooking space.

7. Grease Management System

This system is designed to collect grease and drippings, preventing flare-ups and making cleanup easier.

- Components: Grease tray and cup
- Function: Reduces flare-ups and simplifies maintenance.

8. Lid and Handle

The lid is essential for retaining heat and smoke, while the handle allows for easy opening and closing.

- Material: Typically stainless steel or porcelain-enamelled
- Function: Retains heat and provides access to the cooking area.

Understanding the Parts Diagram

The parts diagram for the Weber Genesis E 330 is an invaluable tool for identifying and locating each component of the grill. It visually maps out where different parts are situated, allowing users to quickly reference them when needed.

Key Features of the Parts Diagram

- Visual Representation: The diagram includes labeled illustrations of all components, making it easy to identify each part.
- Part Numbers: Each component is associated with a part number, which is essential for ordering replacements or upgrades.
- Assembly Guidance: The diagram often includes assembly instructions for reassembling after maintenance or repairs.

Common Issues and Troubleshooting

Even the best grills can encounter issues over time. Understanding the parts and their functions can help you troubleshoot problems effectively. Here are some common issues you might face with the Weber Genesis E 330 and how to address them.

1. Inconsistent Heat Distribution

If you notice that your grill is not heating evenly, the issue may be related to:

- Clogged Burners: Ensure that the burners are clean and free of debris.
- Damaged Flavorizer Bars: Check for dents or rust that could affect their performance.

2. Difficulty Igniting the Grill

If the grill won't ignite, consider the following:

- Check the Battery: For electronic ignition systems, a dead battery can prevent ignition.
- Inspect the Ignition Wires: Make sure the wires are connected and undamaged.

3. Excessive Flare-Ups

Flare-ups can be dangerous and detract from the grilling experience. To minimize flare-ups:

- Clean the Grease Management System: Make sure the grease tray and cup are emptied regularly.
- Check Flavorizer Bars: Replace damaged bars to prevent excess grease from dripping onto the burners.

4. Rust or Corrosion

Over time, parts of your grill may rust or corrode. Regular inspection and maintenance can help mitigate this issue:

- Store Properly: When not in use, cover the grill to protect it from the elements.
- Use Protective Coatings: Consider using a grill-specific protective spray for metal parts.

Maintenance Tips for the Weber Genesis E 330

To ensure your Weber Genesis E 330 continues to perform at its best, it's important to carry out regular maintenance. Here are some tips to help you maintain your grill effectively.

1. Regular Cleaning

- After Each Use: Scrape down the cooking grates with a grill brush to remove food particles.
- Monthly Cleaning: Remove and clean the flavorizer bars and burners. Check for clogs and ensure that gas ports are clear.

2. Inspect Parts Regularly

- Burners and Flavorizer Bars: Look for signs of wear or damage. Replace as needed.
- Hoses and Connections: Check for leaks or cracks to ensure safe operation.

3. Season Your Grates

To maintain the non-stick surface of your cooking grates, apply a thin layer of cooking oil before preheating.

4. Store Properly During Off-Season

If you live in an area with harsh winters, consider storing your grill indoors or using a high-quality grill cover to protect it from snow and ice.

Conclusion

The Weber Genesis E 330 Parts Diagram is an essential tool for every proud grill owner. Understanding the various components and their functions, along with the common issues and

maintenance practices, will help you get the most out of your grilling experience. Regular maintenance and prompt repairs can significantly extend the life of your grill, ensuring countless delicious meals for years to come. Whether you're a seasoned grill master or a novice, familiarizing yourself with the parts diagram will enhance your grilling knowledge and skills, making each cookout enjoyable and successful.

Frequently Asked Questions

What is the importance of the Weber Genesis E 330 parts diagram?

The parts diagram is essential for understanding the layout and function of each component, aiding in maintenance and repairs.

Where can I find the Weber Genesis E 330 parts diagram?

The parts diagram can typically be found in the owner's manual, on the Weber website, or through authorized dealers.

What are the key components shown in the Weber Genesis E 330 parts diagram?

Key components include the burners, cooking grates, flavorizer bars, and ignition system.

How can I use the parts diagram to troubleshoot my Weber Genesis E 330?

You can use the diagram to identify specific parts that may be malfunctioning and determine if they need cleaning, repair, or replacement.

Are replacement parts for the Weber Genesis E 330 easy to find?

Yes, replacement parts are widely available through Weber's official website, authorized retailers, and various online marketplaces.

Can I modify my Weber Genesis E 330 using the parts diagram?

Yes, the parts diagram can help you understand how modifications may affect the grill's performance and safety.

Is the parts diagram the same for different models of the Weber Genesis series?

No, each model has its own specific parts diagram, so it's important to refer to the correct one for the Genesis E 330.

How detailed is the Weber Genesis E 330 parts diagram?

The diagram is quite detailed, showing individual parts and their locations, along with part numbers for easy identification.

Find other PDF article:

<https://soc.up.edu.ph/26-share/Book?dataid=pKI28-4493&title=guido-brunetti-books-in-order.pdf>

Weber Genesis E 330 Parts Diagram

Weber

Weber Works™ interchangeable drop-in and snap-on accessories fit ...

Weber Supply - Health & Safety Pro...

Weber Supply is an all-Canadian company that prides itself on over 160 ...

Weber - Homedepot.ca

Introducing The New Weber ® Spirit ® II The Spirit ® II series of gas grills by ...

Buy Appliances & Barbecues at the B...

As a family-owned business serving Greater Ontario since 1906, we've built ...

Weber Grills & Smokers | RONA

Browse and shop our wide selection of Weber BBQs and Smokers at ...

Weber

Weber Works™ interchangeable drop-in and snap-on accessories fit select Weber® grills, griddles, and smokers and help you go from prepping to cooking to serving seamlessly.

Weber Supply - Health & Safety Products, Fasteners, MRO ...

Weber Supply is an all-Canadian company that prides itself on over 160 years of tradition and service. Weber Supply is a distributor of quality industrial and safety products, serving markets ...

Weber - Homedepot.ca

Introducing The New Weber ® Spirit ® II The Spirit ® II series of gas grills by Weber combine bold colours - including the sleek stainless steel Spirit ® II, available only at the Home Depot - with ...

Buy Appliances & Barbecues at the Best Prices | TA Appliances

As a family-owned business serving Greater Ontario since 1906, we've built our reputation on trust, quality, and friendly customer service. Visit us at our open, airy showrooms and learn why our ...

Weber Grills & Smokers | RONA

Browse and shop our wide selection of Weber BBQs and Smokers at Rona.ca. Browse features, specs & accessories and find the perfect grill for you. We have it all, from Genesis to Summit!

Weber in Brantford, Ontario :: Brantford Home Hardware

Products by Weber in Brantford, Ontario

BBQ Repair - Ontario's BBQ Repair Experts

BBQ Experts is Ontario's #1 Mobile BBQ Repair Service utilizing genuine OEM parts from the leading manufacturers such as Napoleon, Weber & Broil King

Weber Grills - By Grillers For Grillers

Weber is the world's premier manufacturer of charcoal, gas, and electric grills, and grilling accessories. Includes recipes, grilling tips, parts, and support.

Weber in Brantford ON - YellowPages.ca

Locate and compare Weber in Brantford ON, Yellow Pages Local Listings. Find useful information, the address and the phone number of the local business you are looking for.

Weber Grill for sale in Brantford, Ontario | Facebook Marketplace

New and used Weber Grill for sale in Brantford, Ontario on Facebook Marketplace. Find great deals and sell your items for free.

Explore our comprehensive Weber Genesis E 330 parts diagram to identify and order the right components for your grill. Learn more to enhance your BBQ experience!

[Back to Home](#)