

Vermeer Sc362 Parts Diagram

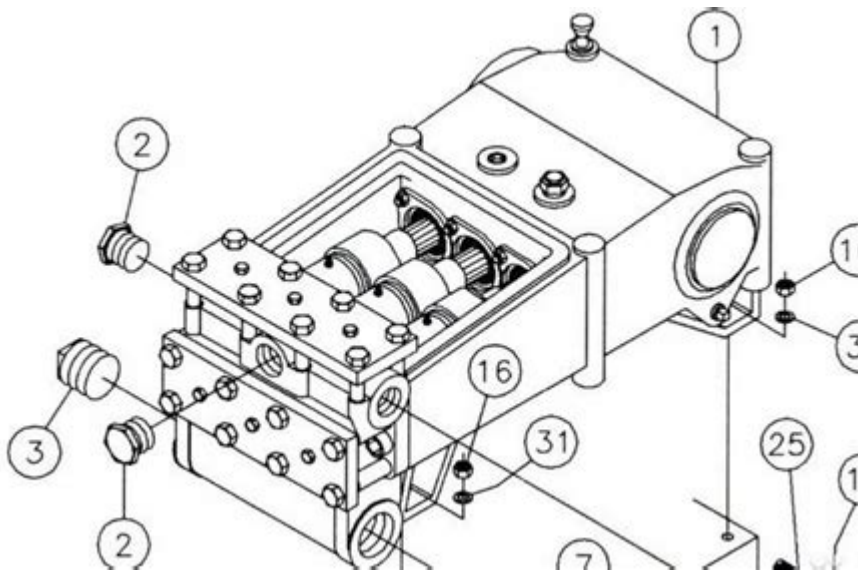

Vermeer SC362 parts diagram is an essential tool for anyone involved in the maintenance, repair, or operation of the Vermeer SC362 stump grinder. Understanding the various components of this machine is crucial for ensuring its optimal performance and longevity. The SC362 is renowned for its compact size, power, and efficiency, making it a favorite among landscapers and tree service professionals. In this article, we will delve into the parts diagram of the Vermeer SC362, exploring its components, their functions, and maintenance tips to keep the machine running smoothly.

Overview of the Vermeer SC362

The Vermeer SC362 is designed for efficient stump removal, featuring a powerful engine and a robust cutting system. Its compact design allows for easy maneuverability in tight spaces, making it ideal for residential and commercial landscaping tasks. Understanding the parts of this machine is essential for operators and technicians alike, especially when it comes to troubleshooting and repairs.

Key Features of the SC362

- **Powerful Engine:** The SC362 is equipped with a reliable engine that delivers the necessary power to tackle tough stumps.
- **Compact Design:** Its small footprint allows for easy navigation in confined areas.
- **User-Friendly Controls:** The operator's station features intuitive controls for easy operation and safety.
- **Robust Cutting System:** The cutting wheel is designed for maximum

efficiency, allowing for quick and effective stump grinding.

Understanding the Parts Diagram

The Vermeer SC362 parts diagram provides a visual representation of all components within the machine. Familiarity with this diagram is crucial for identifying parts during maintenance and repairs. The diagram typically includes:

- Engine components
- Hydraulic system
- Cutting system
- Chassis and frame parts
- Electrical system

Engine Components

The engine is the heart of the SC362, providing the necessary power for its operations. Key components include:

1. Air Filter: Prevents dirt and debris from entering the engine.
2. Fuel Tank: Stores fuel needed for operation.
3. Starter Motor: Initiates engine operation.
4. Exhaust System: Directs exhaust gases away from the engine.
5. Cooling System: Maintains optimal engine temperature.

Maintaining engine components is vital for efficient operation. Regularly checking the air filter and fuel tank for cleanliness can prevent performance issues.

Hydraulic System

The hydraulic system plays a pivotal role in the operation of the SC362, especially in controlling the cutting wheel and other movements. Key parts include:

- Hydraulic Pump: Converts mechanical energy into hydraulic energy.
- Hydraulic Hoses: Transmit hydraulic fluid between components.
- Cylinders: Actuate movements for the cutting arm and wheel.
- Reservoir: Holds hydraulic fluid.

Proper maintenance of the hydraulic system is crucial. Regular fluid checks and hose inspections can prevent leaks and ensure smooth operation.

Cutting System

The cutting system is what makes the SC362 effective for stump grinding. Important components include:

1. Cutting Wheel: The main component that grinds the stump.
2. Teeth: Sharp attachments on the cutting wheel that do the actual grinding.
3. Drive Belt: Connects the engine to the cutting wheel, transferring power.
4. Gearbox: Adjusts the speed and torque from the engine to the cutting wheel.

Keeping the cutting system in top shape is essential for efficient stump removal. Regularly inspecting and replacing worn teeth can significantly enhance performance.

Chassis and Frame Parts

The chassis and frame of the SC362 provide the structural integrity needed for operation. Key parts include:

- Frame: The main structure that supports all components.
- Wheels: Allow for mobility across various terrains.
- Axles: Connect the wheels to the frame and support the weight of the machine.

Regular checks for frame integrity and wheel condition can prevent operational issues and enhance safety.

Electrical System

The electrical system controls various functions of the SC362, including starting the engine and operating lights. Key components include:

- Battery: Powers the electrical system and starts the engine.
- Wiring Harness: Connects all electrical components.
- Fuses: Protect against electrical overload.

Maintaining the electrical system is critical for the reliable operation of the SC362. Regular battery checks and wiring inspections can prevent electrical failures.

Maintenance Tips for SC362

To ensure the longevity and optimal performance of the SC362, regular

maintenance is essential. Here are some key maintenance tips:

1. **Regular Inspections:** Conduct frequent checks on all major components, including the engine, hydraulic system, and cutting system.
2. **Fluid Checks:** Regularly check and replace engine oil, hydraulic fluid, and coolant as needed.
3. **Replace Worn Parts:** Keep an eye on wear indicators for cutting teeth and belts. Replace them promptly to maintain performance.
4. **Cleaning:** Keep the machine clean from debris and dust, especially around the engine and cooling system.
5. **Safety Checks:** Regularly inspect safety features, including emergency shut-off switches and guards.

Where to Find Replacement Parts

Finding the right replacement parts for the Vermeer SC362 is crucial for maintaining performance. Here are some options for sourcing parts:

- **Authorized Vermeer Dealers:** The best source for genuine Vermeer parts.
- **Online Retailers:** Websites specializing in heavy machinery parts often carry Vermeer components.
- **Local Machinery Suppliers:** Many local suppliers may stock common parts for the SC362.
- **Aftermarket Parts Suppliers:** While these can be less expensive, ensure they meet quality standards.

Ordering Parts Using the Diagram

When ordering parts, refer to the Vermeer SC362 parts diagram to identify the specific components needed. Here's a simple process:

1. Locate the part number on the diagram.
2. Write down the part name and number.
3. Contact your chosen supplier with the information.
4. Confirm compatibility before finalizing the order.

Conclusion

Understanding the Vermeer SC362 parts diagram is invaluable for operators and technicians alike. By familiarizing yourself with the various components of this efficient stump grinder, you can ensure proper maintenance, timely repairs, and optimal performance. Regular maintenance not only extends the life of the machine but also enhances safety and efficiency during stump removal tasks. Whether you're a landscaping professional or a dedicated DIY enthusiast, knowledge of the SC362's parts and functions will empower you to

keep this powerful tool running at its best.

Frequently Asked Questions

What is the purpose of the Vermeer SC362 parts diagram?

The Vermeer SC362 parts diagram provides a detailed visual representation of the components of the stump grinder, helping users identify parts for maintenance, repair, and replacement.

Where can I find the Vermeer SC362 parts diagram?

The Vermeer SC362 parts diagram can typically be found in the owner's manual, on the official Vermeer website, or through authorized Vermeer dealers.

How can I use the Vermeer SC362 parts diagram for repairs?

You can use the Vermeer SC362 parts diagram to locate specific components that need repair or replacement, ensuring you order the correct parts and understand how they fit together.

Are there any online resources for Vermeer SC362 parts diagrams?

Yes, several online platforms, including forums and equipment dealer websites, offer downloadable PDFs or interactive diagrams of the Vermeer SC362 parts.

What should I do if I can't find the correct part in the Vermeer SC362 parts diagram?

If you can't find the correct part, consult with a Vermeer dealer or a qualified technician who can help identify the part based on the machine's serial number and specifications.

Is there a difference between the parts diagrams for different Vermeer SC362 models?

Yes, there can be differences in parts diagrams based on the specific model and year of manufacture, so it's important to refer to the diagram that matches your machine's specifications.

Can I use the Vermeer SC362 parts diagram for

troubleshooting?

Yes, the parts diagram can be useful for troubleshooting by helping you identify which components may be causing issues based on their location and function.

Find other PDF article:

[https://soc.up.edu.ph/18-piece/Book?ID=tNr94-6385&title=dr-lipo-fat-dissolving-instructions.pdf](https://soc.up.edu.ph/18-piece/Book?ID=tNr94-6385&title=dr-lipo-fat-dissolving-injections-instructions.pdf)

Vermeer Sc362 Parts Diagram

Outlook

Sign in to Outlook to access your email account and manage your messages.

Outlook

Sign in to your Outlook.com, Hotmail.com, MSN.com or Live.com account and connect all your email accounts in one place.

Services for Senders and ISPs - Outlook.com

However, Microsoft understands that legitimate email senders should not be negatively affected. Therefore, we have established a suite of services to help senders improve their deliverability to Outlook.com consumers by proactively managing their sending reputation.

Policies, Practices, and Guidelines - Outlook.com

Senders attempting to send email to Outlook.com users should ensure they fully understand and are following the guidance on this page to help in this effort and to help avoid potential deliverability issues.

Outlook

Outlook ... Outlook

Fighting Junk Email - Outlook.com

The goal for Outlook.com is to offer a comprehensive and usable email service that helps detect and protect users from junk email, fraudulent email threats (phishing) and viruses.

Reconnect Outlook 2016/2013 to Outlook.com to resume email ...

Once you reconnect, your Outlook.com emails will resume syncing to your desktop version of Outlook. Note that your Outlook.com email account is still active and all your messages remain accessible via a web browser.

Reconnect Outlook 2016/2013 to Outlook.com to resume email ...

Once you reconnect, your Outlook.com emails will resume syncing to your desktop version of Outlook. Note that your Outlook.com email account is still active and all your messages remain accessible via a web browser.

[Reconnectez Outlook 2016/2013 à Outlook.com pour retrouver ...](#)

Une fois que vous aurez reconnecté votre compte, vos messages Outlook.com seront à nouveau synchronisés avec votre version de bureau d'Outlook. Notez que votre compte de messagerie Outlook.com est toujours actif et que tous vos messages restent accessibles via ...

windsor-breads

Here at Windsor Breads Bakery & Coffeehouse, happiness is our goal. We use the finest and freshest ingredients to scratch-bake homestyle treats such as muffins, scones & cookies that will fill your belly and warm your heart.

Windsor Breads Bakery & Coffeehouse | Windsor WI - Facebook

Windsor Breads Bakery & Coffeehouse, Windsor. 5,387 likes · 107 talking about this · 699 were here. Coffee, scones, sweet and yeast breads, muffins,...

Windsor Breads Bakery & Coffeehouse

Apr 5, 2016 · We specialize in homestyle bakery like you or your family would make if you had the time and expertise. We focus on making delicious scones, muffins, and cookies but also have a good range of savory items

Windsor Breads Bakery & Coffee House Menu - Windsor, WI

Jun 18, 2025 · Windsor Breads Bakery & Coffee House is Coffee shop at 4446 Windsor Rd, Windsor, WI 53598. Check out their menu with prices, hours, read reviews, and make a reservation online.

Windsor Breads Bakery & Coffee House - Restaurantji

Latest reviews, photos and ratings for Windsor Breads Bakery & Coffee House at 4446 Windsor Rd in Windsor - view the menu, hours, phone number, address and map.

Menu for Windsor Breads Bakery & Coffee House in Windsor, ...

Dive into the menu of Windsor Breads Bakery & Coffee House in Windsor, WI right here on Sirved. Get a sneak peek of your next meal.

Windsor Breads Bakery & Coffeehouse, LLC | Bakery | Coffee ...

Windsor Breads Bakery & Coffeehouse specializes in Stone Creek Coffees and espresso drinks along with sweet & savory breads, cookies, muffins, and other assorted bakery good.

MENU | windsor-breads

At Windsor Breads Bakery & Coffeehouse, we bake what is seasonally popular, what we think will sell and what our fabulous customers have pre-ordered for pick-up.

Windsor Breads Bakery & Coffeehouse Menu in Windsor, WI

View the menu for Windsor Breads Bakery & Coffeehouse in Windsor, WI. Order Online, get delivery, see prices and reviews.

Windsor Breads Bakery & Coffee House - Windsor, Wisconsin

Profile & Reviews for Windsor Breads Bakery & Coffee House, a Coffee Shop in Windsor. Call: +1 608-846-7446. Address: 4446 Windsor Rd, Windsor, WI 53598. Read reviews, order online, and learn more here!

Explore our detailed Vermeer SC362 parts diagram to simplify your maintenance and repairs.

Discover how to keep your equipment running smoothly. Learn more!

[Back to Home](#)