

Vermont Castings Resolute 1979 Manual

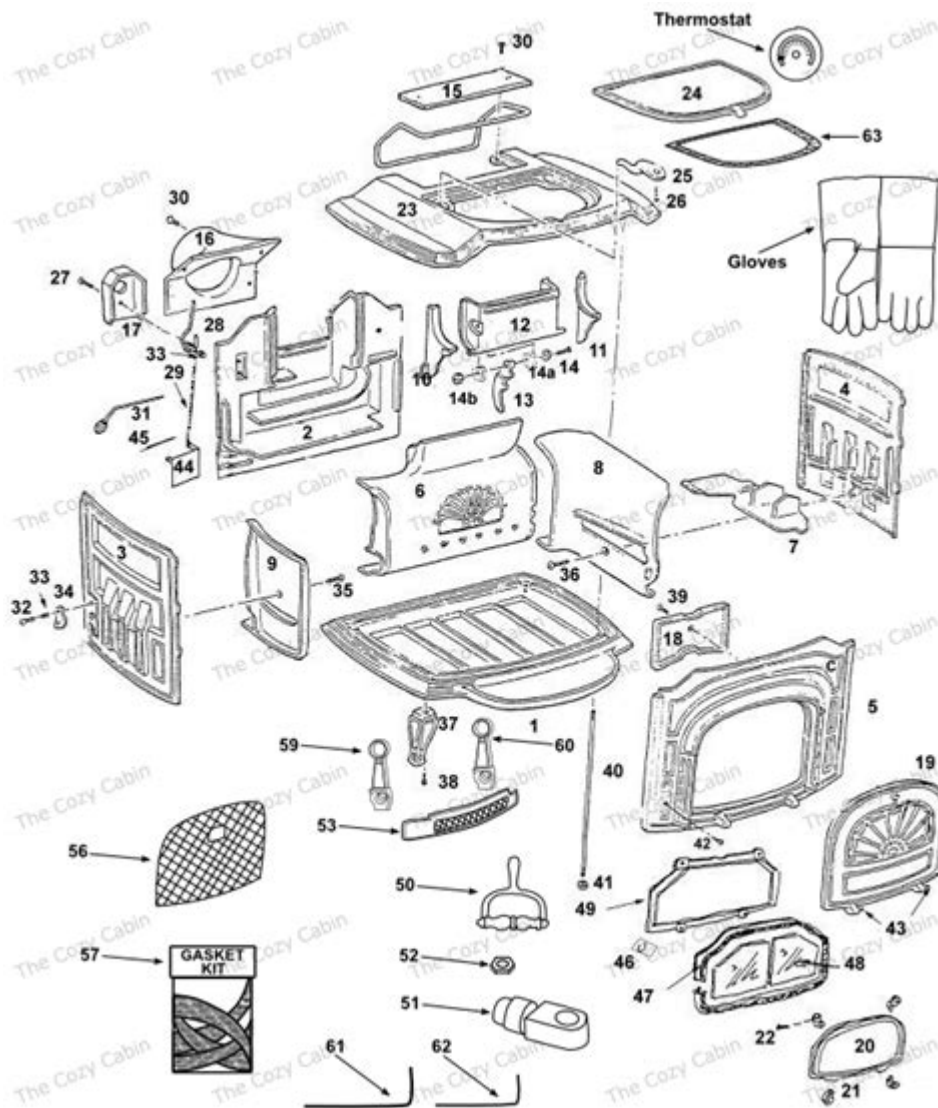

Vermont Castings Resolute 1979 Manual is an essential resource for owners and enthusiasts of one of the most revered wood stoves produced by Vermont Castings. This manual not only provides guidance on the operation and maintenance of the Resolute model but also offers insights into the historical context of the stove, its design features, and the benefits of wood-burning appliances. Understanding this manual can help users maximize the performance and longevity of their stove, ensuring it remains a reliable source of heat for years to come.

Introduction to Vermont Castings and the Resolute Model

Founded in 1975, Vermont Castings quickly gained a reputation for crafting high-quality cast iron stoves that combined aesthetic appeal with functional efficiency. The Resolute model, introduced in 1979, exemplified this commitment to excellence. It was designed to provide efficient heating while maintaining an attractive appearance that could complement any home décor.

The Resolute was notable for its innovative construction, which allowed for a more complete combustion of wood, resulting in reduced emissions and improved heat output. This model has become a classic in the wood-stove market, often sought after by collectors and those looking for reliable heating solutions.

Key Features of the Vermont Castings Resolute

The Vermont Castings Resolute features several key components that enhance its functionality and performance:

1. Durable Construction

- **Cast Iron Body:** The stove's cast iron construction provides excellent heat retention and radiates warmth long after the fire has died down.
- **Vermiculite Lining:** The interior is lined with vermiculite, a natural insulator that helps maintain high temperatures for efficient burning.

2. Air Control System

- **Primary Air Control:** This feature allows users to regulate the amount of air entering the combustion chamber, enabling greater control over the burn rate and heat output.

- Secondary Air System: By introducing air above the fire, this system helps improve combustion efficiency and reduces smoke emissions.

3. Large Viewing Window

- The Resolute includes a large glass door that provides a clear view of the fire, enhancing the aesthetic appeal and ambiance of any room.

4. Versatile Design

- Multiple Flue Options: The stove can be configured for either top or rear flue exit, providing flexibility for installation in various spaces.
- Classic Styling: The Resolute's elegant design makes it a beautiful addition to traditional or contemporary homes.

Understanding the 1979 Manual

The Vermont Castings Resolute 1979 manual serves as a comprehensive guide for users, covering everything from installation to troubleshooting. Here are the main sections typically found within the manual:

1. Safety Information

- Clearances: The manual provides essential guidelines on the minimum clearances required from walls and combustible materials to ensure safe operation.
- Ventilation Requirements: Proper venting is crucial for efficient combustion and to prevent the buildup of dangerous gases.

2. Installation Instructions

- Site Preparation: Guidelines for preparing the installation site, including selecting a suitable location and preparing the hearth.
- Assembly: Step-by-step instructions for assembling the stove components and connecting it to the flue.
- Testing for Leaks: Procedures for checking the stove for air or gas leaks after installation.

3. Operating Instructions

- Starting a Fire: Detailed guidance on how to start a fire efficiently, including recommended materials and techniques.
- Fuel Recommendations: Information on the types of wood best suited for burning in the Resolute, emphasizing seasoned hardwoods for optimal performance.
- Adjusting Air Control: Instructions on how to adjust the primary and secondary air controls for different burning conditions.

4. Maintenance and Care

- Regular Cleaning: The manual outlines a cleaning schedule to ensure the stove operates efficiently and safely. This includes:
 - Cleaning the glass door to maintain visibility.
 - Removing ash from the firebox regularly.
 - Inspecting and cleaning the flue system to prevent creosote buildup.
- Seasonal Maintenance: Instructions for preparing the stove for seasonal use, including pre-season checks and repairs.

5. Troubleshooting Guide

- Common issues and their potential solutions are provided to help users diagnose and resolve problems without needing professional assistance. This section typically includes:
- Poor Draft: Possible causes and solutions, such as checking the chimney for blockages.
- Excessive Smoke: Identification of issues related to fuel quality or air supply and how to correct them.
- Uneven Burning: Tips for ensuring proper wood placement and air adjustment.

The Benefits of Using the Vermont Castings Resolute

The Resolute model offers several advantages for homeowners:

1. Environmentally Friendly Heating

- The advanced combustion technology used in the Resolute leads to lower emissions compared to older models, making it an environmentally responsible choice.

2. Cost-Effective Heating Solution

- Wood is often more affordable than other heating fuels, and the Resolute's efficiency means less wood is needed to produce the same amount of heat.

3. Aesthetic Appeal

- The classic design of the Resolute adds character to any living space, providing not just heat but also a focal point for the room.

4. Reliability During Outages

- In the event of power outages or fuel shortages, wood stoves like the Resolute can provide a dependable heat source.

Conclusion

The Vermont Castings Resolute 1979 manual is an invaluable tool for anyone who owns this iconic wood stove. By understanding the various sections of the manual, users can ensure safe operation, efficient heating, and proper maintenance of their Resolute. Vermont Castings has established a legacy of quality, and the Resolute model is a testament to that commitment. Whether you're a new owner or a seasoned enthusiast, familiarizing yourself with this manual will enhance your experience and satisfaction with one of the finest wood stoves available on the market.

Frequently Asked Questions

What is the primary purpose of the Vermont Castings Resolute 1979 manual?

The Vermont Castings Resolute 1979 manual provides essential information on the operation, maintenance, and safety guidelines for the Resolute wood stove, ensuring optimal performance and longevity.

Where can I find a digital copy of the Vermont Castings Resolute 1979 manual?

You can often find a digital copy of the Vermont Castings Resolute 1979 manual on the official Vermont Castings website or through various online forums and communities dedicated to wood stove enthusiasts.

What are some key maintenance tips included in the Vermont Castings Resolute 1979 manual?

Key maintenance tips include regular cleaning of the flue and stovepipe, checking for cracks in the firebox, ensuring proper ash removal, and inspecting the door gasket for an airtight seal.

How do I troubleshoot common issues with the Vermont Castings Resolute 1979 stove as outlined in the manual?

The manual provides troubleshooting steps for common issues such as poor draft, excessive smoke, and irregular burning, including checking for blockages, adjusting the air control, and ensuring proper installation.

What safety precautions are recommended in the Vermont Castings Resolute 1979 manual?

The manual recommends safety precautions such as keeping flammable materials away from the stove, using a spark guard, ensuring proper ventilation, and having a carbon monoxide detector installed nearby.

Is the Vermont Castings Resolute 1979 manual relevant for newer models?

While the Vermont Castings Resolute 1979 manual is specific to that model, many operational and safety principles can still be relevant for newer models, but it's best to consult the manual for the specific model you own.

What fuel types does the Vermont Castings Resolute 1979 manual recommend?

The manual recommends using seasoned hardwood for optimal performance, but it also provides guidelines on burning softwood and other fuel types, emphasizing the importance of proper moisture

content.

Find other PDF article:

<https://soc.up.edu.ph/05-pen/pdf?dataid=iNb00-2393&title=amada-turret-pega-357m-manual.pdf>

Vermont Castings Resolute 1979 Manual

MasonCountyPress.com | Mason County's E-Edition

Apr 2, 2024 · Mason County Press. Mason County's best source for online news and information, including Ludington, Scottville, Custer, Fountain, Free Soil, Walhalla.

News - Shelton-Mason County Journal

5 days ago · Mason County Commissioner Sharon Trask will not seek reelection, according to a letter she sent to the Journal and other officials. She will serve out the rest of her four-year term, ending in 2026. "I will be here until Dec. 31 at 11:59 p.m.," Trask told the Journal, adding she will still be an active Mason County community member after ...

Subscribe | Mason County News - hillcountrypassport.com

Mason County News Outside Texas. For delivery in the United States, outside of the State of Texas, select this option.

MasonCountyPress.com | Mason County's E-Edition - Sur.ly

MasonCountyPress.com | Mason County's E-Edition Mason County Press. Mason County's best source for online news and information, including Ludington, Scottville, Custer, Fountain, Free Soil, Walhalla.

About - MasonCountyPress.com

The Mason County Press began publishing in Scottville, Michigan as a weekly newspaper on August 24, 1938 by Harry E. Kruse. It ceased printing on March 11, 1976 and was re-started briefly from 1986 to 1987.

Shelton-Mason County Journal Homepage

The Shelton-Mason County Journal encourages original letters to the editor of local interest. Diverse and varied opinions are welcome. We will not publish letters that are deemed libelous or scurrilous in nature.

79th District Court arraignments, published July 28, 2025

1 day ago · By Alan Neushwander, Contributing Writer LUDINGTON — The following were recently arraigned in Mason County's 79th District Court: Felonies -Tiffany Layne Miller, 41; possession of a controlled substance — methamphetamine/ecstasy; arrested Nov. 22, 2024 by Ludington Police Department; arraigned July 21; preliminary hearing: Aug. 6; bail: \$5,000 ...

News - MasonWebTV.com

Jul 16, 2025 · [VIDEO] The Mason County Commission passed two resolutions Monday declaring the county a Disaster Area due to wildfires burning in the County: the Bear Gulch Fire near Lake

Cushman and the Toonerville Fire near Belfair.

Newspaper & Radio | Ludington, MI - Official Website

Check the Ludington Daily News or Mason County Press for up to date news information. Radio For up to date news from our local radios stations access one of the links below.

MasonCountyPress.com | Mason County's E-Edition

4 days ago · Mason County Press. Mason County's best source for online news and information, including Ludington, Scottville, Custer, Fountain, Free Soil, Walhalla.

homebrew - tar: Error opening archive: Failed to open when ...

Jul 15, 2021 · When I am using this command to upgrade my macOS big sur: brew upgrade shows some package could not be opened log: ==> Installing dependencies for sphinx-doc: ...

Is there a way to get Firefox-like-Containers in Safari?

May 2, 2020 · 321 1 1 gold badge 2 2 silver badges 4 4 bronze badges 4 Nor a real nor a complete solution, but if your intention is to separate a specific website (like Facebook), you ...

What is xcrun and why would updating to macOS Mojave cause it ...

Dec 8, 2021 · xcrun is a tool that helps managing Xcode versions on your system. It allows you to write scripts that don't need to know where your Xcode instance or developer tools are installed.

iOS MAC address randomization for personal hotspots

What is the technical difference between an algebra and a logic? How does Rav Kotler assign final letters in 5 cases in Vayikra-Bamidbar? Difference between theory and simulation of ...

command line - Change mouse settings via terminal - Ask ... - Ask ...

Jul 11, 2022 · What is the technical difference between an algebra and a logic? Books or References on the Theory Behind Proof Assistants? I wonder whether there exists a book of ...

command line - How to remove cmake - Ask Different

May 5, 2020 · I recently installed cmake with the ./bootstrap executable which is part of the source distribution. Now I don't need it and want to get rid of it. However, instead of downloading ...

Apple Watch Series 2 is reporting way too much exercise

Mar 18, 2018 · Twice in the last week my Apple Watch (Latest WatchOS 4) has reported massive amounts of exercise, when in fact I hadn't done any those days. Like many hundreds of ...

Can I scale my 2560x1440 screen by 66% to pretend to be 4K?

Jul 3, 2023 · Your 4K display is scaling at 2 times; and your 2K display is scaling at 1.333 to get the same size. Also note that if the displays were different physical sizes, there would be ...

How to disable top bar of the iOS keyboard? - Ask Different

Nov 9, 2017 · Question concerning the computation of the socle of a module over a modular group algebra in GAP using GAP's MeatAxe Net convergence and integration Removing color ...

Names and location of .dmg files for OS X installation

I believe a file was download and mounted to a director under Applications: cd /Applications ls -l | grep -i install drwxr-xr-x 3 root wheel 102 Nov 2 23:55 Install macOS High Sierra.app Is t...

Unlock the secrets of your Vermont Castings Resolute 1979 manual. Discover how to maximize your stove's performance and maintenance. Learn more now!

[Back to Home](#)