

Vermeer Baler Parts Diagram

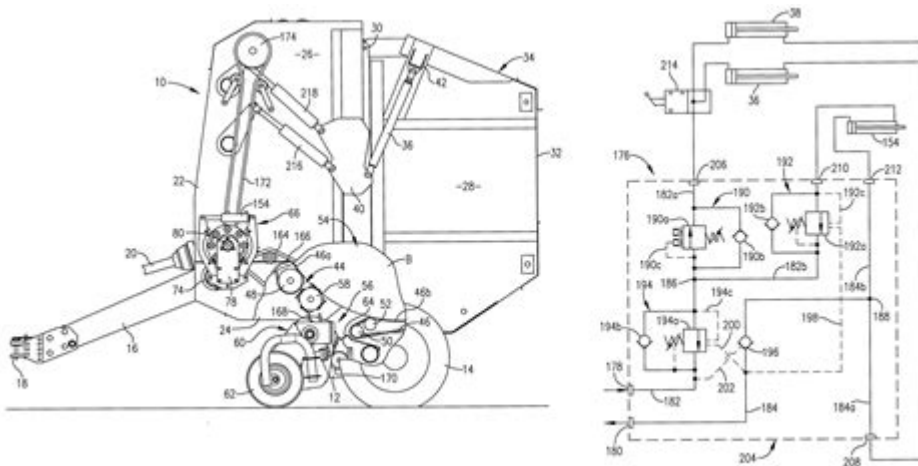

Vermeer baler parts diagram is an essential reference for anyone who operates or maintains Vermeer balers. These machines are crucial in agricultural operations, particularly in hay and forage production. Understanding the components and how they work together can greatly enhance efficiency and prolong the lifespan of the equipment. This article will delve into the various parts of Vermeer balers, their functions, and how to interpret a parts diagram effectively.

Understanding Vermeer Balers

Vermeer balers are renowned for their reliability and efficiency in producing bales of hay, straw, and silage. They come in various models, each designed to meet specific needs. Knowing the parts of these machines is crucial for maintenance and troubleshooting.

Types of Vermeer Balers

Vermeer manufactures several types of balers, including:

- Round Balers
- Square Balers
- Large Square Balers
- Mini Balers

Each type has unique features and components, so it's vital to refer to the specific parts diagram for your model.

The Importance of a Parts Diagram

A parts diagram serves as a visual guide to understanding the assembly and function of each component within the baler. It can help operators and maintenance personnel identify parts quickly and accurately, which is crucial during repairs or routine maintenance.

Benefits of Using a Parts Diagram

Using a parts diagram has several advantages:

1. **Easy Identification:** Quickly identify the correct part needed for repairs.
2. **Improved Maintenance:** Understand how different parts interact, leading to better maintenance practices.
3. **Time Efficiency:** Save time in repairs by knowing how to disassemble and reassemble parts accurately.
4. **Preventive Care:** Recognize wear and tear in components before they fail, allowing for proactive maintenance.

Key Components of Vermeer Balers

Understanding the key components of Vermeer balers is crucial for effective operation and maintenance. Here are some of the primary parts you'll find in a typical baler:

1. Pickup Assembly

The pickup assembly is responsible for gathering the material from the field. It consists of:

- Pickup Teeth
- Drive Chain
- Pickup Roller

2. Bale Chamber

The bale chamber is where the material is compressed into bales. Key parts include:

- Rollers
- Belts
- Compression Plates

3. Twine or Net Wrap System

This system secures the bales. It consists of:

- Twine Arms
- Net Wrap Dispenser
- Cutters

4. Drive System

The drive system powers the baler. It includes:

- Gearbox
- Pulleys
- Belts

5. Hydraulics

Hydraulic systems control various functions, such as:

- Bale Ejection
- Pickup Height Adjustment
- Twine and Net Tension Control

How to Read a Vermeer Baler Parts Diagram

Reading a parts diagram effectively can take some practice. Here's how to navigate it:

1. Familiarize Yourself with Symbols

Parts diagrams often use standardized symbols to represent various components. Familiarizing yourself with these symbols can significantly enhance your understanding.

2. Identify Major Sections

Diagrams are usually divided into sections based on the machine's components. Focus on one section at a time, such as the pickup or bale chamber.

3. Cross-Reference with the Manual

Always cross-reference the parts diagram with the operator's manual or service guide. This can provide additional details, such as torque specifications and maintenance schedules.

4. Use the Diagram for Troubleshooting

When encountering issues, refer to the parts diagram to pinpoint potential problem areas. This can help streamline the troubleshooting process.

Common Issues and Solutions

Understanding common issues associated with Vermeer balers can enhance your operational efficiency. Here are some frequent problems and potential solutions:

1. Bale Formation Issues

If bales are not forming correctly, check:

- The pickup assembly for clogs or damage.
- The bale chamber for wear on rollers or belts.
- The twine or net wrap system for proper tension.

2. Hydraulic Failures

For hydraulic issues, inspect:

- Hydraulic fluid levels and quality.
- Hoses for leaks or damage.
- Filters for clogs.

3. Drive System Problems

Common drive system issues include:

- Slipping belts or broken pulleys.
- Noisy operation indicating wear.
- Overheating components.

Conclusion

A comprehensive understanding of the **Vermeer baler parts diagram** is essential for anyone involved in the operation or maintenance of these machines. By familiarizing yourself with the key components, how to read the diagrams, and common issues, you can ensure that your baler operates efficiently and effectively. Regular maintenance, informed by the parts diagram, will not only extend the life of your equipment but also enhance productivity in your agricultural operations.

Frequently Asked Questions

What is a Vermeer baler parts diagram used for?

A Vermeer baler parts diagram is used to identify and locate various components of the baler, helping users understand its structure and aiding in maintenance, repairs, and replacement of parts.

Where can I find a Vermeer baler parts diagram?

You can find a Vermeer baler parts diagram on the official Vermeer website, through authorized dealers, or in the owner's manual that comes with the baler.

Are there different parts diagrams for different models of Vermeer balers?

Yes, each model of Vermeer baler has its specific parts diagram that details the unique components and configurations of that model.

How can I interpret a Vermeer baler parts diagram?

To interpret a Vermeer baler parts diagram, familiarize yourself with the labels and symbols used in the diagram, which indicate different parts and their relationships, often accompanied by part numbers for easy reference.

What should I do if I can't find a specific part in the Vermeer baler parts diagram?

If you can't find a specific part in the Vermeer baler parts diagram, consider contacting Vermeer customer support or your local dealer for assistance, as they can provide guidance and help you locate the part.

Find other PDF article:

<https://soc.up.edu.ph/63-zoom/Book?trackid=AEV74-2417&title=tsultrim-allione-feeding-your-demons.pdf>

Vermeer Baler Parts Diagram

Ayuda de Google Drive

Centro de asistencia oficial de Google Drive donde puedes encontrar sugerencias y tutoriales para aprender a utilizar el producto y respuestas a otras preguntas ...

Use Google Drive for desktop

Install & set up Drive for desktop for Windows Important: Before you start, check that your operating system is compatible with Drive for desktop. Tip: If you use a work or school ...

Cómo usar Google Drive

Cómo usar Google Drive En esta sección, obtendrás información sobre lo siguiente: Cómo usar las funciones de Google Drive Cómo subir, compartir y organizar archivos Cómo usar Drive ...

Utilizar Google Drive - Ordenador - Ayuda de Google Drive

Google Drive te ayuda a mantener todos tus archivos juntos. Puedes subir y compartir tus archivos desde cualquier dispositivo, crear archivos nuevos, mantenerlos organizados, ...

Como usar o Google Drive - Computador - Ajuda do Google Drive

Se você não conhece o Google Drive, este artigo vai ajudar a começar a usar o serviço, cobrindo as coisas mais importantes e úteis que você pode fazer, desde aprender a usar o Drive e ...

Use o Google Drive para computador

No Drive para computador, pode encontrar o menu do Drive para computador no tabuleiro do sistema na parte inferior direita. Afixe o Drive para computador para que seja mais fácil ...

How to use Google Drive

How to use Google Drive Want advanced Google Workspace features for your business? Try Google Workspace today! Google Drive helps you keep all your files together. You can upload ...

Install Drive for desktop - Google Workspace Learning Center

Get started with Drive for Google Workspace Install Drive for desktop You can find and open your files from Google Drive on your computer with Drive for desktop. You can use Drive for ...

Instalar Drive para ordenadores

Descubre cómo instalar Google Drive para ordenadores y acceder a tus archivos de manera eficiente desde tu computadora.

Ayuda de Drive - Google Help

Noticias del equipo de Google Drive ¿Nunca usaste Google Drive? Consulta guías de capacitación, sugerencias y otros recursos del Centro de aprendizaje de G Suite. Blog de los ...

Jailhouse Rock (song) - Wikipedia

"Jailhouse Rock " is a rock and roll song recorded by American singer Elvis Presley for the film of the same name. It was written by Jerry Leiber and Mike Stoller.

'Jailhouse Rock': The Story Behind Elvis Presley's Classic Hit

Jun 16, 2022 · "Jailhouse Rock" was written by songwriter and producer duo Jerry Leiber and Mike Stoller, who wrote other Presley hits such as "Hound Dog" and "Love Me." The duo was assigned to write the song,...

Why Elvis Presley's Songwriters Wrote 'Jailhouse Rock'

Feb 8, 2021 · Here's a look at why famous songwriters Jerry Leiber and Mike Stoller wrote "Jailhouse Rock" in the first place. Elvis Presley | Michael Ochs Archives/Getty Images. Two ...

Jailhouse Rock by Elvis Presley - Songfacts

This was written by Jerry Leiber and Mike Stoller, who also wrote "Hound Dog," which became a huge hit when Elvis recorded it. Leiber and Stoller excelled at writing catchy pop songs with elements of blues music. Their songs could be very funny and clever, and often take place in unusual situations.

Elvis Presley - Jailhouse Rock Lyrics - Genius

"Jailhouse Rock" is a song written by Jerry Leiber and Mike Stoller. The song was released as a 45rpm single on September 24, 1957, to coincide with the release of Presley's motion picture ...

Elvis Presley - "Jailhouse Rock": A Timeless Classic That Shaped Rock ...

Jan 29, 2025 · Released in 1957, "Jailhouse Rock" is one of Elvis Presley's most iconic songs, and it remains a defining track in the history of rock 'n' roll. Written by Jerry Leiber and Mike Stoller, the song not only captured the rebellious spirit of the 1950s but also cemented Elvis's place as the King of Rock.

Who wrote "Jailhouse Rock" by Elvis Presley? - Genius

"Jailhouse Rock" by Elvis Presley was written by Mike Stoller, Jerry Leiber & Leiber-Stoller.

Jailhouse Rock (1957) - IMDb

Jailhouse Rock: Directed by Richard Thorpe. With Elvis Presley, Judy Tyler, Mickey Shaughnessy, Vaughn Taylor. After serving time for manslaughter, young Vince Everett becomes a teenage rock star.

Jailhouse Rock (song) | Elvis Presley Wiki | Fandom

"Jailhouse Rock" is a song written by Jerry Leiber and Mike Stoller, and recorded by Elvis Presley on

April 30, 1957 [1], for the film Jailhouse Rock.

Jailhouse Rock | Under Appreciated Rock by Martin Winfree

“Jailhouse Rock” is a song written by Jerry Leiber and Mike Stoller that first became a hit for Elvis Presley. The song was released as a 45 rpm single on September 24, 1957, to coincide with the release of Presley’s motion picture, Jailhouse Rock.

Explore our comprehensive guide on the Vermeer baler parts diagram. Understand each component and enhance your maintenance skills. Learn more today!

[Back to Home](#)