

Vacuum Hose Honda Shadow Carburetor Hose Diagram

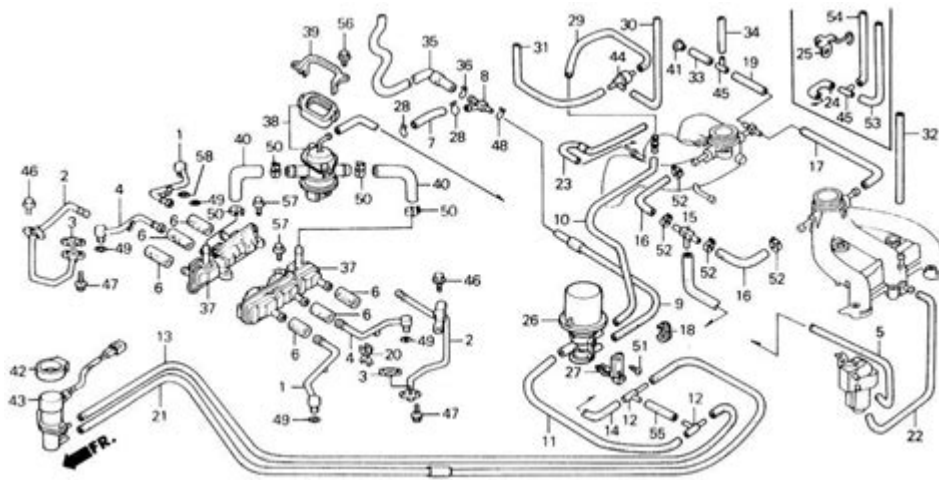

Understanding the Vacuum Hose System in Honda Shadow Carburetors

When it comes to motorcycle maintenance, one crucial aspect that often gets overlooked is the vacuum hose system, especially in models like the Honda Shadow. The **vacuum hose Honda Shadow carburetor hose diagram** serves as a vital reference for both novice and experienced mechanics alike, aiding in the proper installation, understanding, and troubleshooting of the carburetor system. This article will explore the function of vacuum hoses, provide a detailed diagram, and offer guidance on troubleshooting common issues.

The Role of Vacuum Hoses in Carburetors

Vacuum hoses play a significant role in the operation of carburetors in motorcycles like the Honda Shadow. These hoses are responsible for controlling the airflow and fuel mixture, which is critical for optimal engine performance. Here are some key functions of vacuum hoses in a carburetor system:

- **Fuel Delivery:** Vacuum hoses help create a vacuum that draws fuel from the float bowl into the carburetor.
- **Choke Function:** When starting the engine, the vacuum helps to engage the choke, enriching the air-fuel mixture for easier ignition.
- **Petcock Operation:** In models with a vacuum-operated petcock, these hoses control the flow of fuel from the tank to the carburetor.

- **Air-Fuel Mixture Adjustment:** The hoses contribute to the balance of air and fuel for proper combustion.

Understanding these functions is crucial for any Honda Shadow owner, as issues with vacuum hoses can lead to poor engine performance, stalling, or even total engine failure.

Components of the Honda Shadow Vacuum Hose System

To fully grasp the vacuum hose system, it's important to identify its main components. Here are the primary elements involved:

1. Carburetor

The carburetor is the heart of the fuel delivery system, mixing air and fuel to create a combustible mixture. The vacuum generated in the carburetor is key to its functionality.

2. Vacuum Hoses

These are flexible tubes that connect various components, allowing for the transfer of vacuum pressure. They are typically made from rubber or silicone and can wear out over time.

3. Choke Mechanism

The choke enriches the fuel mixture during cold starts. It is often actuated by a cable connected to the vacuum system.

4. Petcock

The petcock is a fuel valve that controls the flow of fuel from the tank to the carburetor. In vacuum-operated models, it opens and closes based on the presence of vacuum pressure.

5. Intake Manifold

The intake manifold connects the carburetor to the engine. It is where the air-fuel mixture enters the combustion chamber.

Creating a Vacuum Hose Diagram for Honda Shadow

A vacuum hose diagram is an invaluable tool for Honda Shadow owners and mechanics. This diagram outlines the routing of hoses and their connection points. While specific diagrams may vary based on the model year, a general overview includes the following information:

1. **Identify the Carburetor:** Locate the carburetor on your motorcycle, typically found between the air filter and the intake manifold.
2. **Trace the Hoses:** Observe how the hoses are connected to the carburetor, petcock, and choke mechanism.
3. **Label the Hoses:** Make a note of which hose connects to which component to avoid confusion during maintenance.
4. **Consult the Service Manual:** Refer to your Honda Shadow service manual for a specific diagram related to your model.

A basic vacuum hose diagram for a Honda Shadow often looks like this:

- Carburetor: Main body with two or more hose connections.
- Choke Hose: Connected to the choke mechanism.
- Petcock Hose: Leading from the petcock to the carburetor.
- Intake Manifold: The connection point for the air-fuel mixture.

Common Issues with Vacuum Hoses

Vacuum hoses can become damaged or degraded over time, leading to various issues that can affect motorcycle performance. Here are some common problems to watch for:

1. Cracks and Leaks

Cracks or holes in the hoses can cause vacuum leaks, leading to an improper air-fuel mixture. This can result in rough idling, stalling, or decreased power.

2. Disconnections

Hoses can become disconnected due to vibrations or improper installation. This can lead to a loss of vacuum pressure and affect performance.

3. Blockages

Debris or fuel residue can block hoses, preventing proper airflow. Regular inspection and cleaning can help avoid this issue.

4. Material Degradation

Over time, hoses can become brittle or soft due to exposure to heat, fuel, and other environmental factors. It's essential to replace old hoses to maintain optimal performance.

Troubleshooting Vacuum Hose Issues

If you suspect that your vacuum hoses may be causing problems, follow these troubleshooting steps:

1. **Visual Inspection:** Check the hoses for any visible signs of wear, cracking, or disconnection.
2. **Listen for Hissing Sounds:** A hissing sound when the engine is running can indicate a vacuum leak.
3. **Conduct a Smoke Test:** A smoke test can help identify leaks by introducing smoke into the system and observing where it escapes.
4. **Check the Fuel Flow:** Ensure that the petcock is functioning correctly and that fuel is flowing to the carburetor.
5. **Consult a Mechanic:** If problems persist, consider consulting a professional mechanic for a thorough inspection.

Conclusion

Understanding the **vacuum hose Honda Shadow carburetor hose diagram** is essential for maintaining your motorcycle's performance and ensuring a smooth riding experience. By familiarizing yourself with the components, functions, and potential issues related to vacuum hoses, you can better troubleshoot problems and keep your Honda Shadow running optimally. Regular inspection and maintenance of these hoses can prevent costly repairs and extend the life of your motorcycle. Always refer to your service manual for specific guidance tailored to your model for the best results.

Frequently Asked Questions

What is the purpose of the vacuum hose in the Honda Shadow carburetor system?

The vacuum hose in the Honda Shadow carburetor system helps regulate the air-fuel mixture by allowing the carburetor to respond to changes in engine load and throttle position.

Where can I find a detailed diagram of the vacuum hoses for my Honda Shadow carburetor?

You can find detailed vacuum hose diagrams for Honda Shadow carburetors in the service manual for your specific model or on various motorcycle enthusiast forums and websites dedicated to Honda motorcycle maintenance.

How do I identify a vacuum hose leak in my Honda Shadow?

To identify a vacuum hose leak in your Honda Shadow, inspect the hoses for cracks or breaks, listen for hissing sounds near the carburetor, and check for any performance issues such as rough idling or poor acceleration.

What are the common symptoms of a faulty vacuum hose in a Honda Shadow?

Common symptoms of a faulty vacuum hose in a Honda Shadow include rough engine idle, stalling, poor acceleration, and unexpected changes in engine performance.

Can I replace the vacuum hoses on my Honda Shadow myself?

Yes, you can replace the vacuum hoses on your Honda Shadow yourself. Ensure you have the correct replacement hoses, tools, and follow the service manual for guidance on proper installation.

What tools do I need to work on the vacuum hoses of my Honda Shadow?

To work on the vacuum hoses of your Honda Shadow, you typically need basic hand tools such as pliers, screwdrivers, and possibly a socket set. A service manual will also help guide you through the process.

Find other PDF article:

<https://soc.up.edu.ph/42-scope/Book?ID=1Hr60-3565&title=multi-step-word-problems-worksheet.pdf>

Vacuum Hose Honda Shadow Carburetor Hose Diagram

GaussDB (DWS) vacuum -

Feb 8, 2024 · vacuum VACUUM UPDATE DELETE
...

GaussDB (DWS) VACUUM -

Feb 28, 2021 · vacuum GaussDB (DWS) vacuum
(vacuum) ...

vacuum -

Jun 10, 2021 · vacuum (OldestXmin)
sql, ...

-GaussDB (DWS) (vacuum full)

Nov 26, 2020 · vacuum full DWS (vacuum full) 1
...

GaussDB (DWS) -

Mar 20, 2021 · GaussDB (DWS) ...

GaussDB (DWS) vacuum -

Feb 8, 2024 · vacuum VACUUM UPDATE DELETE
...

GaussDB (DWS) VACUUM -

Feb 28, 2021 · vacuum GaussDB (DWS) vacuum
(vacuum) ...

vacuum -

Jun 10, 2021 · vacuum (OldestXmin)
sql, ...

-GaussDB (DWS) (vacuum full)

Nov 26, 2020 · vacuum full DWS (vacuum full) 1
...

GaussDB (DWS) -

Mar 20, 2021 · GaussDB (DWS) ...

CSGO VAC -

CSGO VAC xxxx
...

GaussTech GaussDB Ustore - ...

Oct 30, 2024 · vacuum vacuum
Astore ...

```
Dec 14, 2023 · 0000 00 (auto)vacuum-CU&0CU0000CU0CU000000vacuum full0000000000000000
CU0CU000autovacuum00000 ...
```

Nov 29, 2020 · VACUUM VACUUM FULL vacuum_defer_cleanup_age
VACUUM ANALYZE VACUUM ...

HFSSの真空領域を定義する際、境界条件として“Vacuum”を選択し、領域を指定する。

[Back to Home](#)