

Tristar Shotgun Parts Diagram

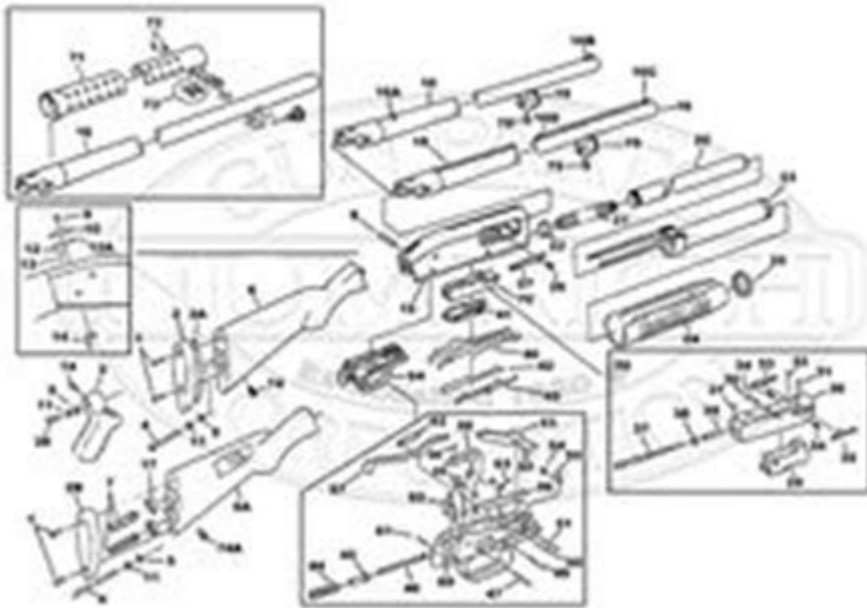

Tristar shotgun parts diagram serves as an essential tool for both enthusiasts and professionals who work on or maintain Tristar shotguns. Understanding the various components of a shotgun not only aids in proper maintenance and repair but also enhances the overall shooting experience by ensuring that the firearm operates smoothly and efficiently. This article will explore the Tristar shotgun parts diagram, discuss the various components, their functions, and how they contribute to the overall operation of the shotgun.

Overview of Tristar Shotguns

Tristar Arms is a well-known manufacturer of shotguns, particularly recognized for their reliable and affordable firearms. Their product line includes a variety of models, from semi-automatics to over-and-under shotguns, catering to different shooting preferences—be it sport shooting, hunting, or self-defense.

Importance of Understanding Shotgun Parts

A thorough understanding of the parts of a shotgun is crucial for several reasons:

1. **Maintenance:** Knowing the parts helps in performing regular maintenance and troubleshooting any issues.
2. **Customization:** Enthusiasts may want to upgrade or customize their shotguns, which requires knowledge of the different parts.
3. **Safety:** Understanding each component is vital for safe handling and operation.
4. **Performance:** Familiarity with the parts can lead to improved performance through better handling

and adjustments.

Main Components of a Tristar Shotgun

The shotgun consists of several key components, each playing a specific role in its operation. Below are the primary parts commonly found in Tristar shotguns:

1. Receiver

The receiver is the core component of the shotgun. It houses the trigger mechanism, and bolt, and serves as the connection point for the stock and barrel.

- Function: It is responsible for housing the firing mechanism and linking the shotgun's different parts.
- Types: The receiver can come in various designs, such as monoblock or split receiver designs.

2. Barrel

The barrel is the elongated tube through which the shot travels.

- Function: It determines the shotgun's range and accuracy.
- Variations: Different barrel lengths can affect the performance and suitability for various shooting activities.

3. Stock

The stock is the part of the shotgun that is held against the shooter's shoulder.

- Function: It provides stability when aiming and firing.
- Material: Stocks can be made from various materials, including wood and synthetic composites.

4. Forearm

The forearm, located beneath the barrel, allows the shooter to hold the shotgun securely.

- Function: It aids in controlling the shotgun while aiming and shooting.
- Designs: Some forearms feature checkering for a non-slip grip.

5. Trigger Assembly

The trigger assembly consists of the trigger and associated parts that release the firing mechanism.

- Function: It initiates the firing process when pulled.
- Safety Features: Modern trigger assemblies often include safety mechanisms to prevent accidental discharge.

6. Bolt and Firing Pin

The bolt is a critical component that locks the shell in place during firing.

- Function: It also houses the firing pin, which strikes the primer of the shell to ignite the powder.
- Maintenance: Regular cleaning is essential to ensure it functions correctly.

7. Choke

The choke is a constriction at the end of the barrel that affects the shot spread.

- Function: It can be changed to alter the shotgun's performance for different shooting scenarios.
- Types: Common choke types include cylinder, improved cylinder, modified, and full.

8. Ejector and Extractor

These components are responsible for the ejection of spent shells and the extraction of live rounds.

- Function: The ejector pushes out spent cartridges, while the extractor pulls live rounds from the chamber.
- Design: Some shotguns have automatic ejectors, while others require manual operation.

9. Safety Mechanism

The safety mechanism prevents the shotgun from firing accidentally.

- Function: It is usually located on the receiver and must be disengaged before firing.
- Types: There are different types of safeties, including crossbolt and tang safeties.

Understanding the Tristar Shotgun Parts Diagram

A Tristar shotgun parts diagram visually represents the various components and their arrangement. It is an invaluable resource for both new and experienced gun owners. The diagram typically includes:

- Labeling of Parts: Each part is labeled for easy identification.

- Exploded View: An exploded view shows how various components fit together, making it easier to understand assembly and disassembly.
- Reference for Repairs: Provides a clear reference for replacing or repairing specific parts.

Using the Parts Diagram for Maintenance

To maintain your Tristar shotgun effectively, follow these steps using the parts diagram:

1. Refer to the Diagram: Start by locating the specific part you wish to clean or inspect.
2. Disassemble Carefully: Follow the diagram to disassemble the shotgun, ensuring you do not lose any small parts.
3. Clean Components: Use appropriate cleaning materials for each part. Metal parts may require oil, while stocks may need a gentle wood cleaner.
4. Inspect for Wear: Check components for signs of wear or damage, such as cracks or rust.
5. Reassemble: Use the parts diagram to ensure that everything is put back together correctly.

Common Issues and Troubleshooting

Understanding the parts can help troubleshoot common issues that may arise with Tristar shotguns:

1. Failure to Fire

- Possible Causes: This could be due to a malfunctioning trigger assembly or a faulty firing pin.
- Solution: Inspect the trigger assembly and firing pin using the parts diagram for guidance.

2. Ejection Problems

- Possible Causes: A dirty or worn ejector/extractor may cause ejection issues.
- Solution: Clean and inspect these components regularly to ensure they function properly.

3. Misfiring or Double Feeding

- Possible Causes: This could occur due to a faulty magazine or issues with the bolt.
- Solution: Check the magazine and ensure the bolt is moving freely.

Conclusion

Understanding the Tristar shotgun parts diagram is crucial for effective maintenance, troubleshooting, and overall performance enhancement. By familiarizing oneself with the various components, shotgun

owners can ensure their firearms operate smoothly, safely, and efficiently. Whether you are a seasoned shooter or a novice, having a comprehensive grasp of your firearm's parts will ultimately lead to a better shooting experience. Regular maintenance and the ability to identify potential issues will not only prolong the life of the shotgun but also enhance its performance, making every shot count.

Frequently Asked Questions

What is a Tristar shotgun parts diagram used for?

A Tristar shotgun parts diagram is used to identify and locate various components of the shotgun, making it easier for users to understand the assembly, disassembly, and maintenance of their firearm.

Where can I find a Tristar shotgun parts diagram?

You can find a Tristar shotgun parts diagram on the official Tristar Arms website, in the owner's manual that comes with the shotgun, or through various online firearm forums and parts retailers.

Are there different parts diagrams for different models of Tristar shotguns?

Yes, there are specific parts diagrams for each model of Tristar shotguns, as the components can vary significantly between models. It's important to refer to the diagram that corresponds to your specific model.

Can I order replacement parts using the Tristar shotgun parts diagram?

Yes, you can use the Tristar shotgun parts diagram to identify the specific parts you need, which can then be ordered through authorized dealers or directly from Tristar Arms.

Is it safe to perform maintenance using the Tristar shotgun parts diagram?

Yes, as long as you follow the instructions carefully and ensure the shotgun is unloaded, using the parts diagram for maintenance is safe and can help prevent improper assembly.

What should I do if I can't find my Tristar shotgun parts diagram?

If you can't find your Tristar shotgun parts diagram, consider contacting Tristar Arms customer support for assistance, or check online resources such as firearm enthusiast forums or gun shop websites.

Find other PDF article:

Tristar Shotgun Parts Diagram

Access another computer with Chrome Remote Desktop

The virtual desktop session is created and .chrome-remote-desktop-session starts when Chrome Remote Desktop starts. Tip: Your desktop environment may not support more than one ...

Access another computer with Chrome Remote Desktop

Learn how Chrome Remote Desktop is managed. Make sure you're using the latest version of Chrome or Chrome OS. If you have any other issues, please report them in the Chrome Help ...

Accedere a un altro computer con Chrome Remote Desktop

All'avvio di Chrome Remote Desktop, viene creata la sessione desktop virtuale e viene avviata .chrome-remote-desktop-session. Suggerimento: l'ambiente desktop potrebbe non supportare ...

Accedere a un altro computer con Chrome Remote Desktop

Sul computer, Chrome Remote Desktop è disponibile sul web. Per utilizzare il tuo dispositivo mobile per l'accesso remoto, scarica l'app Chrome Remote Desktop. Suggerimento: in qualità ...

Chrome ...

Chrome .chrome-remote-desktop-session : ...

Acessar outro computador com a Área de trabalho remota do ...

No computador, a Área de trabalho remota do Google Chrome está disponível na Web. Para usar seu dispositivo móvel para acesso remoto, faça o download do app Área de trabalho remota ...

Acceder a otro ordenador con Escritorio Remoto de Chrome

Por ejemplo, Cinnamon tiene un archivo llamado cinnamon.desktop. En algunas versiones, el archivo puede tener el siguiente comando: gnome-session --session=cinnamon. Crea un ...

Mengakses komputer lain dengan Chrome Desktop Jarak Jauh

Chrome Desktop Jarak Jauh tersedia di web yang dapat diakses dari komputer Anda. Untuk menggunakan perangkat seluler Anda untuk akses jarak jauh, download aplikasi Chrome ...

Toegang tot een andere computer met Chrome Remote Desktop

Via je computer is Chrome Remote Desktop beschikbaar op internet. Als je je mobiele apparaat wilt gebruiken voor externe toegang, download je de Chrome Remote Desktop-app. Tip: Als ...

Chrome - **Google Chrome**

Chrome .chrome-remote-desktop-session ...

WhatsApp Web

Log in to WhatsApp Web for simple, reliable and private messaging on your desktop. Send and receive messages and files with ease, all for free.

Como entrar no WhatsApp Web pelo PC e pelo celular passo a ...

Jun 24, 2024 · Entrar no WhatsApp Web é um procedimento bastante simples; aprenda como conectar e abrir a sua conta no mensageiro pelo PC e celular, via código QR e número do ...

Sobre o WhatsApp Web | Central de Ajuda do WhatsApp

Acesse a página web.whatsapp.com no seu navegador. Siga as instruções exibidas na tela para escanear o QR code no seu celular. Comece a usar o WhatsApp no seu navegador.

WhatsApp Web Entrar: Como acessar e usar no Computador ...

Jul 14, 2025 · WhatsApp Web Entrar: Aprenda a acessar e usar o WhatsApp no PC pelo navegador ou aplicativo. Veja o tutorial completo e fácil de seguir!

Como entrar no WhatsApp Web pelo PC - Olhar Digital

Jul 6, 2022 · Desta forma, ao invés de sempre sacar o celular, basta abrir uma nova janela no navegador do computador e acessar o app. A seguir, confira como entrar no WhatsApp Web ...

WhatsApp Web: como escanear o código QR para acessar ...

Nov 2, 2024 · Quer usar o WhatsApp Web? Saiba como escanear o código QR que aparece na tela do computador e converse sempre em tela grande.

WHATSAPP WEB ENTRAR: COMO USAR O WHATSAPP NO PC ...

Jun 5, 2025 · Whatsapp web entrar: como usar o whatsapp no pc ou notebook é uma dúvida frequente, e este guia completo visa esclarecer todas as etapas, desde a configuração inicial ...

WhatsApp Web: Veja como acessar o WhatsApp no computador

Oct 6, 2024 · Neste simples tutorial, vamos mostrar como entrar no WhatsApp Web em poucos minutos e aproveitar todos os recursos do aplicativo em sua versão para computadores

WhatsApp Web: como escanear o código QR e usar [tutorial fácil]

May 16, 2023 · Para entrar no WhatsApp Web, acesse as configurações do app, abra a seção “Aparelhos conectados” e selecione a opção “Conectar um aparelho”. A câmera será aberta e ...

Como usar o WhatsApp Web - CCM

Aug 19, 2022 · Com o WhatsApp Web, é possível acessar o aplicativo a partir do seu PC ou notebook. Veja como é simples usar o aplicativo online pelo computador. Para acessar o ...

Explore our comprehensive Tristar shotgun parts diagram to identify components and enhance your firearm maintenance. Learn more for expert tips and insights!

[Back to Home](#)