

# Trim Motor Wiring 3 Wire Tilt Trim Diagram

SERVICE MANUAL NUMBER 14

OILDYNE TRIM PUMP

## Model With Trim In Handle and Trailer Switch Separate

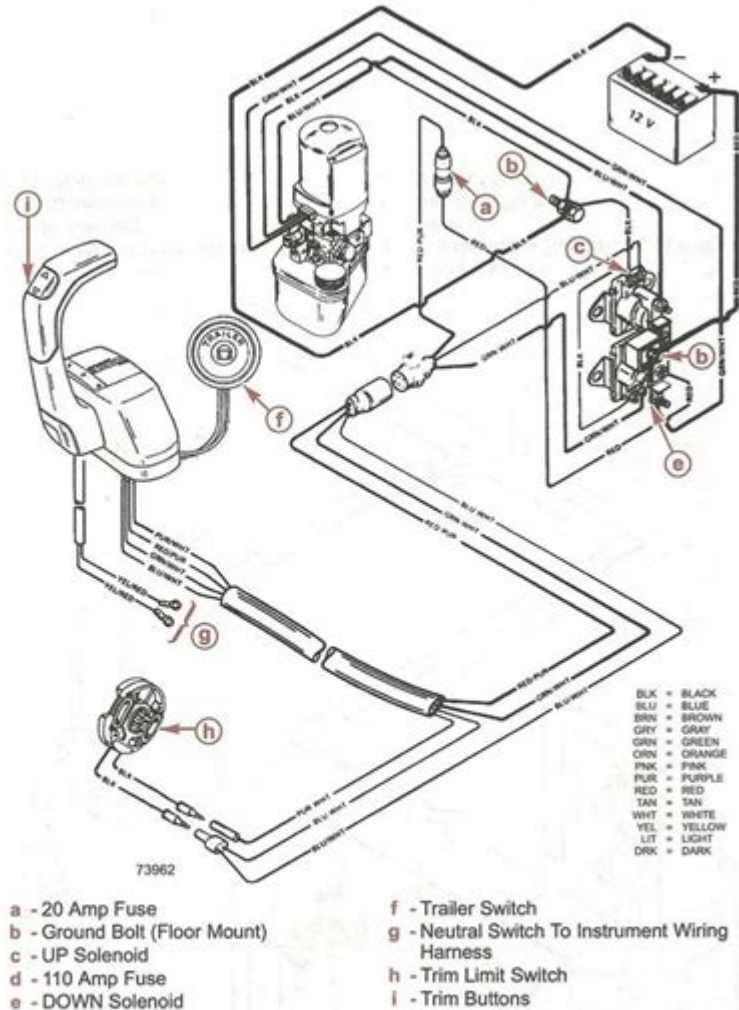

**Trim motor wiring 3 wire tilt trim diagram** is essential for boat enthusiasts and marine technicians who need to understand how to operate and troubleshoot the trim system of a boat. The trim motor is a crucial component of the boat's power tilt and trim mechanism, which allows the operator to adjust the angle of the outboard motor or stern drive. This adjustment optimizes the boat's performance, efficiency, and handling in various water conditions. In this article, we will delve into the fundamentals of the trim motor wiring, provide a detailed tilt trim diagram, and discuss common issues and solutions related to the trim system.

# Understanding the Trim System

Before we dive into the specifics of the trim motor wiring 3 wire tilt trim diagram, it's important to understand the purpose and functionality of the trim system.

## What is a Trim System?

The trim system in a boat allows the operator to adjust the angle of the engine relative to the water surface. This adjustment helps improve the boat's performance by:

- Enhancing fuel efficiency
- Improving speed and handling
- Reducing drag
- Offering better visibility

## Components of the Trim System

The trim system typically consists of the following components:

1. Trim Motor: The electric motor that powers the tilt and trim mechanism.
2. Trim Cylinders: Hydraulic cylinders that raise and lower the motor.
3. Trim Switch: Controls located on the throttle or at the helm to operate the trim motor.
4. Wiring Harness: Electrical connections that link the trim switch to the trim motor.
5. Battery: Powers the trim motor and associated components.

## Trim Motor Wiring 3 Wire Configuration

In a typical 3 wire trim motor system, each wire serves a specific purpose. Understanding these connections is crucial for troubleshooting and repairs.

## Wiring Color Codes

The three wires in a typical 3 wire tilting trim motor system are usually color-coded as follows:

1. Red Wire: Power supply (+)
2. Green Wire: Up signal
3. Black Wire: Down signal (-)

It is essential to verify the wiring colors against the manufacturer's manual, as they can vary between different models or brands.

# Trim Motor Wiring Diagram

A typical trim motor wiring diagram for a 3 wire system can be illustrated as follows:

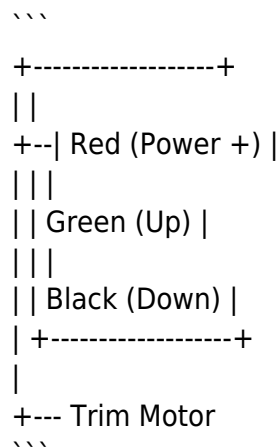

This diagram shows the basic connections: the red wire connects to the battery's positive terminal, while the green and black wires connect to the trim switch, allowing control of the motor's movement.

## Installing the Trim Motor Wiring

When installing or replacing the trim motor wiring, follow these steps to ensure a proper connection:

### Tools and Materials Needed

- Wire strippers
- Electrical tape or heat shrink tubing
- Crimp connectors
- Multimeter
- Screwdriver set

### Installation Steps

1. Disconnect Power: Always start by disconnecting the battery to avoid any electrical shock or short circuit.
2. Remove Old Wiring: If replacing an existing trim motor, carefully disconnect and remove the old wiring harness. Take note of the original connections for reference.
3. Prepare New Wires: Strip about 1/2 inch of insulation from the ends of the new wires. Use the appropriate connectors for each wire.
4. Connect the Wires:

- Connect the red wire to the positive terminal of the battery.
- Connect the green wire to the trim switch (up signal).
- Connect the black wire to the trim switch (down signal).

5. Secure Connections: Use electrical tape or heat shrink tubing to secure and insulate the connections. Ensure there are no exposed wires that could lead to short circuits.

6. Reconnect Power: Reconnect the battery and test the trim motor using the trim switch. Ensure both the up and down functions are working correctly.

## Troubleshooting Common Issues

When dealing with trim motor wiring, various issues can arise. Here are some common problems and troubleshooting tips:

### 1. Trim Motor Not Working

- Check Power Supply: Use a multimeter to verify that power is reaching the trim motor. If not, inspect the battery and connections.
- Inspect Wiring: Look for any damaged wires or loose connections that may be interrupting the power supply.

### 2. Motor Runs in One Direction Only

- Faulty Trim Switch: The switch may be malfunctioning. Test the switch with a multimeter to ensure it is functioning properly.
- Wiring Issues: Inspect the connections for the green and black wires. A short or break in one of these wires may cause the motor to operate in only one direction.

### 3. Unusual Noises or Vibrations

- Check for Obstructions: Inspect the trim cylinders for any debris or obstructions that may hinder movement.
- Lubrication: Ensure that the trim system is adequately lubricated to prevent wear and tear.

## Conclusion

Understanding the **trim motor wiring 3 wire tilt trim diagram** is vital for anyone involved in boating or marine maintenance. Proper installation, troubleshooting, and maintenance of the trim motor wiring can enhance the performance and longevity of your boat's trim system. By following the guidelines provided in this article, boat owners and technicians can ensure a safe and efficient

operation, keeping their vessels in optimal condition for all water adventures.

## **Frequently Asked Questions**

### **What are the common color codes used in a 3-wire tilt trim motor wiring diagram?**

Typically, the three wires in a tilt trim motor wiring diagram are color-coded as follows: one wire is usually green (up), one is black (ground), and the other is brown or red (down).

### **How do you troubleshoot a 3-wire tilt trim motor if it isn't working?**

To troubleshoot a non-working tilt trim motor, first check the power supply and connections. Use a multimeter to test for voltage at the motor terminals. Inspect the wiring for any damage or corrosion, and ensure the switch is functioning correctly.

### **What tools are needed to work on a 3-wire tilt trim motor wiring?**

You will need basic tools such as a multimeter for testing voltage, wire strippers for preparing wire ends, crimping tools for connections, and possibly a screwdriver for accessing the motor and switch.

### **Can I replace a 3-wire tilt trim motor with a 2-wire motor?**

No, a 3-wire tilt trim motor cannot be replaced with a 2-wire motor without modifications, as the 3-wire configuration typically provides both up and down functions along with a ground, while a 2-wire motor usually only supports one directional function.

### **What should I do if my trim motor is making a clicking sound?**

If the trim motor is making a clicking sound, it could indicate a faulty relay or switch, lack of power, or a jammed motor. Check the relay and connections, and ensure there are no obstructions in the trim tilt mechanism.

### **Is there a specific sequence for wiring a 3-wire tilt trim motor?**

Yes, when wiring a 3-wire tilt trim motor, connect the ground wire to the battery's negative terminal, the up wire to the switch terminal for upward movement, and the down wire to the switch terminal for downward movement, ensuring all connections are secure.

Find other PDF article:

<https://soc.up.edu.ph/10-plan/Book?docid=DEL92-3291&title=buying-a-plane-for-flight-training.pdf>

# [Trim Motor Wiring 3 Wire Tilt Trim Diagram](#)

## **String.prototype.trim () - JavaScript | MDN**

Jul 10, 2025 · The trim() method of String values removes whitespace from both ends of this string and returns a new string, without modifying the original string. To return a new string with whitespace trimmed from just one end, use trimStart() or trimEnd().

## **JavaScript String trim () Method - W3Schools**

Description The trim() method removes whitespace from both sides of a string. The trim() method does not change the original string.

## [How to Use the TRIM Function in Excel \(7 Examples\)](#)

Jul 5, 2024 · Learn how to use the TRIM function in Excel by showing how you can use the TRIM function with different functions to remove spaces.

## **Find Trim & Mouldings | Home Hardware**

Learn more about trim and mouldings from Home Hardware. Shop baseboards, crown moulding, window casings, door casings, wainscoting, chair rails and more.

## [TRIM Definition & Meaning - Merriam-Webster](#)

The meaning of TRIM is to remove by or as if by cutting. How to use trim in a sentence.

## *TRIM | English meaning - Cambridge Dictionary*

trim noun (CUT) [ S ] an act of making something, especially someone's hair, tidier or more level by cutting a small amount off it:

## **What is TRIM and How To Check and Enable it on Windows 10**

May 1, 2017 · TRIM is a special ATA command that allows the operating system to inform a solid-state drive (SSD) drive which blocks of data are no longer considered in use and thus can be wiped internally. It's an SSD-related term that can be ...

## [Trim by OneMain | Save Money Automagically](#)

Join over 2M people using Trim. Over \$86M delivered in savings. "I'd highly recommend anyone, no matter their financial situation, see what Trim can help them with. It's worked for me, ...

## [Types of Moulding: How to Choose Trim Styles - Homedepot.ca](#)

Moulding and trim are often used interchangeably, but trim also includes elements like the casings around doors and windows, baseboards, and crown moulding that help to provide a polished finish to your space. We'll help you choose the best type of ...

## [10 Types of Trim That Will Instantly Elevate Your Home](#)

Apr 26, 2023 · Trim is typically used to fill in the gaps between two areas, like the wall and the ceiling. But it can also be used decoratively to accent picture frames, mirrors, and more. We're sharing 10 popular types of trim and how to use each in ...

## *String.prototype.trim () - JavaScript | MDN*

Jul 10, 2025 · The trim() method of String values removes whitespace from both ends of this string and returns a new string, without modifying the original string. To return a new string with ...

## JavaScript String trim () Method - W3Schools

Description The trim() method removes whitespace from both sides of a string. The trim() method does not change the original string.

## How to Use the TRIM Function in Excel (7 Examples)

Jul 5, 2024 · Learn how to use the TRIM function in Excel by showing how you can use the TRIM function with different functions to remove spaces.

### Find Trim & Mouldings | Home Hardware

Learn more about trim and mouldings from Home Hardware. Shop baseboards, crown moulding, window casings, door casings, wainscoting, chair rails and more.

### *TRIM Definition & Meaning - Merriam-Webster*

The meaning of TRIM is to remove by or as if by cutting. How to use trim in a sentence.

## TRIM | English meaning - Cambridge Dictionary

trim noun (CUT) [ S ] an act of making something, especially someone's hair, tidier or more level by cutting a small amount off it:

### *What is TRIM and How To Check and Enable it on Windows 10*

May 1, 2017 · TRIM is a special ATA command that allows the operating system to inform a solid-state drive (SSD) drive which blocks of data are no longer considered in use and thus can be ...

### *Trim by OneMain | Save Money Automagically*

Join over 2M people using Trim. Over \$86M delivered in savings. "I'd highly recommend anyone, no matter their financial situation, see what Trim can help them with. It's worked for me, ...

### *Types of Moulding: How to Choose Trim Styles - Homedepot.ca*

Moulding and trim are often used interchangeably, but trim also includes elements like the casings around doors and windows, baseboards, and crown moulding that help to provide a polished ...

### *10 Types of Trim That Will Instantly Elevate Your Home*

Apr 26, 2023 · Trim is typically used to fill in the gaps between two areas, like the wall and the ceiling. But it can also be used decoratively to accent picture frames, mirrors, and more. We're ...

"Master your boat's trim motor wiring with our detailed 3 wire tilt trim diagram. Ensure proper installation and functionality. Learn more for expert tips!"

[Back to Home](#)