

Trane Xv90 Parts Diagram

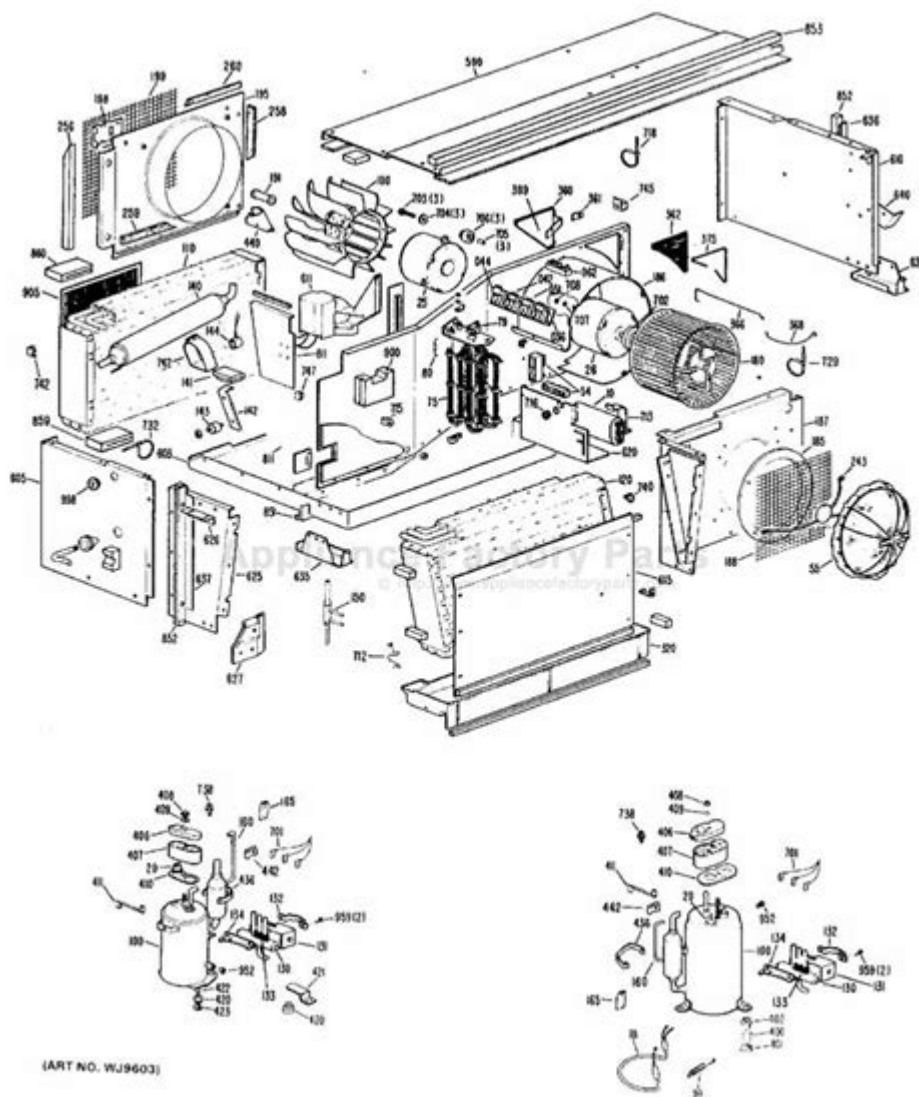

Trane XV90 parts diagram is an essential component for technicians and homeowners alike when it comes to understanding the inner workings of the Trane XV90 gas furnace. This model is known for its efficiency, durability, and advanced features which provide superior heating performance. A clear understanding of the parts diagram can help identify components during maintenance or repairs, ensuring the system operates at its best. In this article, we will delve into the various components of the Trane XV90, their functions, and how to interpret the parts diagram effectively.

Overview of the Trane XV90 Furnace

The Trane XV90 is a high-efficiency gas furnace that boasts an Annual Fuel Utilization Efficiency (AFUE) rating of up to 90%. This means that 90% of the energy consumed is converted into heat for your home, making it one of the more energy-efficient models available. The furnace uses a two-stage heating system,

allowing for better temperature control and comfort.

Understanding the Parts Diagram

The parts diagram of the Trane XV90 is typically a visual representation that outlines the various components of the furnace. It is crucial for technicians to familiarize themselves with this diagram, as it aids in identifying parts quickly and accurately. The diagram usually consists of labeled components, which can be broken down into several categories.

Main Components

1. Blower Assembly

- The blower assembly is responsible for circulating heated air throughout the home. It includes the motor, blower wheel, and housing.

2. Heat Exchanger

- The heat exchanger is a vital component where the combustion process occurs. It transfers heat from the gas burner to the air that circulates through the home.

3. Gas Valve

- This component regulates the flow of gas to the burner, ensuring that the right amount of fuel is used for combustion.

4. Burner Assembly

- The burner assembly ignites the gas and is responsible for producing heat. It can include multiple burners to ensure even heating.

5. Ignition System

- The ignition system is essential for starting the furnace. It can be either a pilot light or an electronic ignition system, depending on the model.

6. Thermostat

- The thermostat controls the temperature of your home by signaling the furnace when to turn on and off.

7. Drain Pan

- The drain pan collects condensation from the heat exchanger, preventing water damage and ensuring efficient operation.

8. Flue Pipe

- The flue pipe is responsible for venting exhaust gases outside the home, which is crucial for safety and

efficiency.

Detailed Breakdown of Key Components

Blower Assembly

The blower assembly plays a critical role in the heating process. It generally consists of:

- Blower Motor: Powers the blower wheel to circulate air.
- Blower Wheel: Designed to move air efficiently through the furnace and into the ductwork.
- Blower Housing: Encloses the motor and wheel while directing airflow.

Regular maintenance of the blower assembly is vital to ensure optimal performance. Dust and debris can accumulate, leading to reduced efficiency and potential breakdowns.

Heat Exchanger

The heat exchanger is a metal component that requires careful inspection. Its primary function is to transfer heat from the combustion process to the air. Key points to consider:

- Cracks or Corrosion: Inspect for any signs of damage that could lead to carbon monoxide leaks.
- Cleaning: Ensure the heat exchanger is free from soot and debris to maintain efficiency.

Gas Valve

The gas valve is crucial for safety and efficiency. It must be functioning correctly to avoid gas leaks or unsafe combustion. Key checks include:

- Pressure Settings: Ensure the gas pressure is within the manufacturer's specifications.
- Electrical Connections: Inspect for any loose or corroded connections.

Burner Assembly

The burner assembly requires regular checks to ensure it ignites properly and burns cleanly. Important factors include:

- Clogged Burners: Dirt or debris can impede gas flow and affect combustion.
- Flame Characteristics: A proper flame should be blue and steady. Yellow or flickering flames may indicate issues.

Ignition System

The ignition system should be checked for reliability. If your furnace uses an electronic ignition, ensure:

- Connections: All wiring is secure and free from damage.
- Electrodes: Clean the ignitor to ensure proper spark.

Importance of Regular Maintenance

Understanding the parts diagram of the Trane XV90 is essential, but regular maintenance is equally important for ensuring optimal performance. Regular maintenance can include:

1. Annual Inspections: Schedule professional maintenance at least once a year to check all components.
2. Filter Replacement: Change or clean the air filter regularly to prevent airflow issues.
3. Cleaning Components: Ensure that burners, heat exchangers, and blowers are clean and free from debris.
4. Checking Thermostat Settings: Ensure that the thermostat is functioning correctly and is calibrated accurately.

Common Issues and Troubleshooting Tips

Even with diligent maintenance, issues can arise. Here are some common problems and troubleshooting tips related to the Trane XV90:

1. Furnace Won't Start:

- Check the thermostat settings and ensure it's set to "heat."
- Inspect the circuit breaker or fuse for the furnace.
- Verify that the gas supply is on.

2. Inadequate Heating:

- Examine the air filter for clogs and replace if necessary.
- Inspect the blower motor operation to ensure it's running correctly.
- Check for closed vents or obstructions in the ductwork.

3. Strange Noises:

- Rattling noises may indicate loose components; inspect and tighten as needed.
- Hissing sounds can suggest a gas leak; shut off the gas supply and call a technician immediately.

Conclusion

The Trane XV90 parts diagram serves as an invaluable resource for understanding the furnace's components and their functions. Whether you are a homeowner looking to perform basic maintenance or a technician conducting repairs, familiarity with the parts diagram is crucial. Regular maintenance and timely troubleshooting can ensure that your Trane XV90 furnace operates efficiently, keeping your home warm and comfortable during the colder months. By leveraging the knowledge gained from understanding the parts diagram, you can extend the life of your heating system while maximizing its performance.

Frequently Asked Questions

What is a Trane XV90 parts diagram used for?

A Trane XV90 parts diagram is used to identify and locate individual components within the HVAC system, helping technicians and homeowners understand how the system is assembled and where parts can be replaced.

Where can I find a Trane XV90 parts diagram?

Trane XV90 parts diagrams can typically be found in the service manual provided with the unit, on the Trane official website, or through authorized Trane dealers and HVAC service providers.

How do I interpret a Trane XV90 parts diagram?

To interpret a Trane XV90 parts diagram, familiarize yourself with the symbols and labels used, locate the section relevant to your issue, and cross-reference with the parts list provided to find specific components.

What common parts can be identified in a Trane XV90 parts diagram?

Common parts identified in a Trane XV90 parts diagram include the blower motor, heat exchanger, circuit board, compressor, and various sensors and valves.

Are Trane XV90 parts diagrams the same for all models?

No, Trane XV90 parts diagrams can vary between different models and manufacturing years, so it's important to ensure you have the correct diagram that corresponds to your specific unit.

Can I replace parts on the Trane XV90 using the parts diagram?

Yes, you can use the parts diagram to identify and replace components on the Trane XV90, but it is recommended to consult with a professional technician for proper installation and to avoid voiding

warranties.

What should I do if I can't find a Trane XV90 parts diagram?

If you can't find a Trane XV90 parts diagram, consider contacting Trane customer support, reaching out to your HVAC technician, or visiting HVAC forums where other users might share resources.

Find other PDF article:

<https://soc.up.edu.ph/25-style/Book?dataid=Gqm02-9321&title=glenn-beck-interview-with-whitney-webb.pdf>

Trane Xv90 Parts Diagram

Heating and Air Conditioning | Trane Commercial HVAC

6 days ago · Trane is the building technology and energy solutions leader who deploys a depth and breadth of expertise, backgrounds, and perspectives to innovate new technologies and ...

HVAC heating and air conditioning equipment powered by Trane®

Find your new HVAC system from air conditioning to filters, heating, thermostats to ventilation built with the dependability of Trane, or find service or repair near you.

English - Trane Heating & Air Conditioning

Parts & Supplies For Service Technicians Parts, supplies, and technical information for your research and repair. Visit Trane Supply Locate a Trane Parts Store

Trane® Heating and Cooling Systems - AC Units, Furnaces & More

Explore our Trane heating and cooling units including air conditioners, furnaces, heat pumps, and dual AC and heating units.

R-454B Compliant 17 Multi-Speed Heat Pump with ...

Although Trane products come with a lot, there are a few features that aren't included with your purchase. Our heat pumps don't come standard with coils, heaters, electrical wiring, or remote ...

Trane® Residential – Chauffage et Climatisation Résidentiels – ...

Comparez les climatiseurs, fournaies et thermopompes Trane centraux, puis connectez-vous avec un spécialiste Trane local pour aider à réparer ou remplacer votre appareil.

Your System - Trane®

From owner's manuals to HVAC maintenance tips to warranty & registration - visit the Your System hub for everything you need. Trust Trane® for all things HVAC.

2024 HVAC Pricing & Installation Costs - Buying Guide - Trane®

View AC unit costs and the cost for a new furnace and find out the price of a new unit before you contact a Trane technician.

Contact Us - Talk to Trane®

Contact Trane to find a dealer to help with HVAC repairs and maintenance, or to share questions or concerns related to your system.

Cooling - Trane®

Smart Comfort, Anytime, Anywhere Control your home's climate on the go with Trane's smart thermostat. Energy savings and convenience at your fingertips. Trane Smart Thermostat

Heating and Air Conditioning | Trane Commercial HVAC

6 days ago · Trane is the building technology and energy solutions leader who deploys a depth and breadth of expertise, backgrounds, and perspectives to innovate new technologies and individualize solutions that get it right for you today and the world tomorrow.

HVAC heating and air conditioning equipment powered by Trane®

Find your new HVAC system from air conditioning to filters, heating, thermostats to ventilation built with the dependability of Trane, or find service or repair near you.

English - Trane Heating & Air Conditioning

Parts & Supplies For Service Technicians Parts, supplies, and technical information for your research and repair. Visit Trane Supply Locate a Trane Parts Store

Trane® Heating and Cooling Systems - AC Units, Furnaces & More

Explore our Trane heating and cooling units including air conditioners, furnaces, heat pumps, and dual AC and heating units.

R-454B Compliant 17 Multi-Speed Heat Pump with ...

Although Trane products come with a lot, there are a few features that aren't included with your purchase. Our heat pumps don't come standard with coils, heaters, electrical wiring, or remote controls.

Trane® Residential – Chauffage et Climatisation Résidentiels – ...

Comparez les climatiseurs, fournaies et thermopompes Trane centraux, puis connectez-vous avec un spécialiste Trane local pour aider à réparer ou remplacer votre appareil.

Your System - Trane®

From owner's manuals to HVAC maintenance tips to warranty & registration - visit the Your System hub for everything you need. Trust Trane® for all things HVAC.

2024 HVAC Pricing & Installation Costs - Buying Guide - Trane®

View AC unit costs and the cost for a new furnace and find out the price of a new unit before you contact a Trane technician.

Contact Us - Talk to Trane®

Contact Trane to find a dealer to help with HVAC repairs and maintenance, or to share questions or concerns related to your system.

Cooling - Trane®

Smart Comfort, Anytime, Anywhere Control your home's climate on the go with Trane's smart thermostat. Energy savings and convenience at your fingertips. Trane Smart Thermostat

Explore our comprehensive Trane XV90 parts diagram for easy identification and troubleshooting.
Learn more about your system's components today!

[Back to Home](#)