

Troy Bilt Riding Mower Drive Belt Diagram

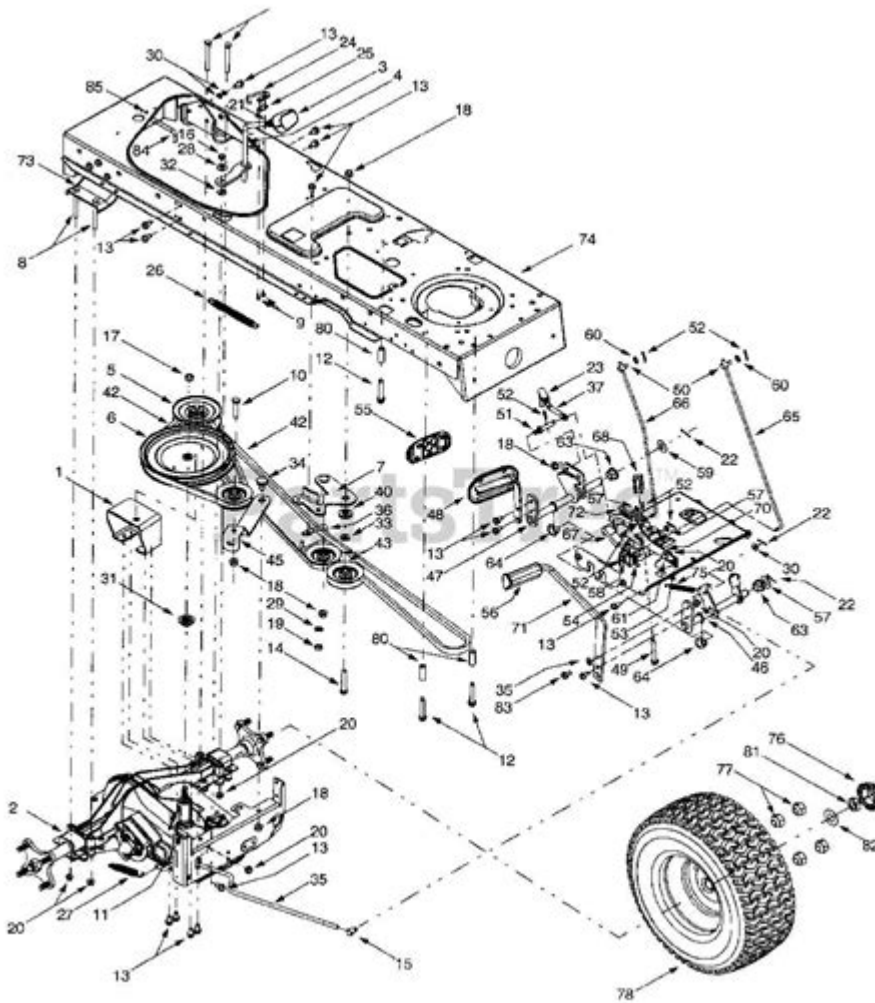

Troy Bilt riding mower drive belt diagram is an essential reference for anyone looking to maintain or repair their lawn care equipment. Understanding the drive belt system is crucial for ensuring optimal performance and longevity of your riding mower. In this article, we will delve into the components of the drive belt system, how to interpret the diagram, common issues that may arise, and tips for maintenance and replacement.

Understanding the Drive Belt System

A drive belt is a crucial component of your Troy Bilt riding mower. It connects the engine's power to the wheels, allowing the mower to move forward and backward. The drive belt is part of a system that includes pulleys, tensioners, and other components that work together to transmit power effectively.

Components of the Drive Belt System

1. Engine: The power source for the mower, it drives the belt.
2. Drive Belt: This rubber belt transfers power from the engine to the transmission.
3. Pulleys: These are wheels that the belt rides on, directing the motion from the engine to the wheels.
4. Tensioner: This component keeps the belt taut, ensuring it doesn't slip during operation.
5. Transmission: Converts the rotational motion from the engine into a usable format for the wheels.

Interpreting the Drive Belt Diagram

The Troy Bilt riding mower drive belt diagram provides a visual representation of how these components fit and interact with each other. Understanding this diagram is essential for troubleshooting issues or performing maintenance tasks.

Key Elements of the Diagram

- Belt Routing: The diagram shows how the belt should be routed around the pulleys. It's important to follow this routing to ensure proper function.
- Tension Adjustments: There may be indications on the diagram for how to adjust the tensioner for the drive belt.
- Component Labels: Each part is typically labeled, making it easier to identify what needs to be checked or replaced.

Common Issues with the Drive Belt

Over time, the drive belt can wear out or become damaged due to various factors. Recognizing these issues early can save you from costly repairs.

Signs of a Worn or Damaged Drive Belt

1. Squeaking or Squealing Noises: If you hear these sounds when starting or operating your mower, it may indicate a worn belt.
2. Loss of Power: If the mower struggles to move or feels sluggish, it could be a sign of a slipping belt.
3. Visible Cracks or Fraying: Inspect the belt for any visible signs of wear. Cracks, fraying, or missing chunks can indicate the need for replacement.
4. Belt Slipping Off Pulleys: If the belt frequently comes off its designated

path, it may be misaligned or too worn to stay in place.

Steps to Diagnose Drive Belt Issues

1. Visual Inspection: Check for any visible damage or wear on the belt.
2. Listen for Noises: Pay attention to any unusual sounds while the mower is operating.
3. Check Tension: Ensure the tensioner is functioning properly and that the belt is appropriately tight.
4. Examine Pulleys: Make sure the pulleys are not damaged and are aligned correctly.

Replacing the Drive Belt

When the time comes to replace your Troy Bilt riding mower's drive belt, it's important to do so correctly to avoid further issues. Following the Troy Bilt riding mower drive belt diagram will ensure that you route the new belt correctly.

Tools Required

- Socket wrench set
- Screwdrivers (flathead and Phillips)
- Replacement drive belt
- Clean cloth

Steps for Replacement

1. Prepare the Mower: Ensure the mower is on a flat, stable surface. Disconnect the spark plug to avoid accidental starting.
2. Remove the Old Belt:
 - Consult the drive belt diagram for the correct routing.
 - Loosen the tensioner and carefully remove the old belt from the pulleys.
3. Install the New Belt:
 - Refer to the diagram for the correct routing of the new belt.
 - Make sure the belt is seated properly on all pulleys.
 - Adjust the tensioner to maintain the correct tension on the belt.
4. Reconnect the Spark Plug: Once the new belt is in place, reconnect the spark plug.
5. Test the Mower: Start the mower and check for proper operation. Listen for any unusual noises and ensure the mower moves smoothly.

Maintenance Tips for the Drive Belt

Regular maintenance can prolong the life of your drive belt and ensure your Troy Bilt riding mower operates efficiently. Here are some tips:

Regular Inspections

1. Monthly Check: Inspect the drive belt monthly for any signs of wear or damage.
2. Tension Checks: Ensure that the tensioner is working correctly and that the belt maintains appropriate tension.

Keep It Clean

- Debris Removal: Regularly clean around the pulleys and the belt to prevent debris from causing wear.
- Lubrication: Apply a light lubricant to the moving parts of the tensioner and pulleys to reduce friction.

Operating Conditions

- Avoid Overloading: Do not exceed the mower's capacity, as this can cause undue stress on the belt.
- Correct Usage: Follow the manufacturer's guidelines for operation to avoid unnecessary wear.

Conclusion

Understanding the Troy Bilt riding mower drive belt diagram is essential for anyone involved in the maintenance and repair of their mower. By familiarizing yourself with the drive belt system, recognizing common issues, and following proper replacement and maintenance procedures, you can ensure your mower runs efficiently for years to come. Regular checks and adherence to the diagram will help you avoid costly repairs and maintain a lush, well-manicured lawn.

Frequently Asked Questions

What is the purpose of the drive belt in a Troy-Bilt riding mower?

The drive belt transfers power from the engine to the wheels, enabling the mower to move forward and backward.

Where can I find the drive belt diagram for my specific Troy-Bilt riding mower model?

The drive belt diagram can typically be found in the owner's manual, on the Troy-Bilt website, or on the mower's deck under the seat.

What are the common symptoms of a worn drive belt on a Troy-Bilt riding mower?

Common symptoms include slipping, unusual noises, or the mower not moving when the engine is running.

How often should I check or replace the drive belt on my Troy-Bilt riding mower?

It's recommended to check the drive belt for wear and tear at the beginning of each mowing season and replace it every 2-3 years, or as needed.

Can I install the drive belt on my Troy-Bilt riding mower without professional help?

Yes, many users can replace the drive belt themselves by following the diagram and instructions in the owner's manual, but caution is advised.

What tools do I need to replace the drive belt on a Troy-Bilt riding mower?

You will typically need basic hand tools such as wrenches, sockets, and screwdrivers to remove the deck and install the new belt.

Is the drive belt diagram the same for all Troy-Bilt riding mower models?

No, the drive belt diagram varies by model, so it's important to refer to the specific diagram for your mower.

What should I do if I can't find the drive belt diagram for my Troy-Bilt riding mower?

If you can't find the diagram, you can contact Troy-Bilt customer service, visit their official website, or check online forums for assistance.

Find other PDF article:

<https://soc.up.edu.ph/35-bold/Book?ID=KWx28-2260&title=julius-caesar-worksheets.pdf>

Troy Bilt Riding Mower Drive Belt Diagram

Troy - Wikipedia

It is best known as the setting for the Greek myth of the Trojan War. The archaeological site is open to the public as a tourist destination, and was added to the UNESCO World Heritage list ...

Troy (2004) - IMDb

May 14, 2004 · Troy: Directed by Wolfgang Petersen. With Julian Glover, Brian Cox, Nathan Jones, Adoni Maropis. An adaptation of Homer's great epic, the film follows the assault on ...

Where Was Troy And What Happened To It? - WorldAtlas

Oct 13, 2022 · Troy was an ancient Bronze Age city located in modern-day Turkey. It was also the legendary setting for Homer's epic poems, the Iliad and the Odyssey, mentioned in the ...

Troy streaming: where to watch movie online? - JustWatch

Find out how and where to watch "Troy" online on Netflix, Prime Video, and Disney+ today - including 4K and free options.

Troy (film) - Wikipedia

Troy is a 2004 epic historical action film directed by Wolfgang Petersen and written by David Benioff.

Troy (2004) - Full cast & crew - IMDb

Troy (2004) - Cast and crew credits, including actors, actresses, directors, writers and more.

Trojan War - Wikipedia

The war was waged by the Achaeans (Greeks) against the city of Troy after Paris of Troy took Helen from her husband Menelaus, king of Sparta. The war is one of the most important ...

Home | Troy Life & Fire Safety Ltd.

Troy Life & Fire Safety Ltd. is one of the largest suppliers of Fire Alarm, Fire Suppression, Security, Nurse call and Communications Systems in Canada. As an Edwards Authorized ...

Troy - Prime Video

Based on the epic poem The Iliad by Homer.

Troy Apple Premium Partner | Troyestore

Uzman ekiplerden teknik destek alın Apple ürünleriniz için destek yetkili servis Troy'da! Hemen randevunuzu oluşturup teknik servis hizmeti alın.

Troy - Wikipedia

It is best known as the setting for the Greek myth of the Trojan War. The archaeological site is open to the public as a tourist destination, and was added to the UNESCO World Heritage list in 1998. ...

Troy (2004) - IMDb

May 14, 2004 · Troy: Directed by Wolfgang Petersen. With Julian Glover, Brian Cox, Nathan Jones, Adoni Maropis. An adaptation of Homer's great epic, the film follows the assault on Troy by the ...

Where Was Troy And What Happened To It? - WorldAtlas

Oct 13, 2022 · Troy was an ancient Bronze Age city located in modern-day Turkey. It was also the legendary setting for Homer's epic poems, the Iliad and the Odyssey, mentioned in the ...

Troy streaming: where to watch movie online? - JustWatch

Find out how and where to watch "Troy" online on Netflix, Prime Video, and Disney+ today - including 4K and free options.

Troy (film) - Wikipedia

Troy is a 2004 epic historical action film directed by Wolfgang Petersen and written by David Benioff.

Troy (2004) - Full cast & crew - IMDb

Troy (2004) - Cast and crew credits, including actors, actresses, directors, writers and more.

Trojan War - Wikipedia

The war was waged by the Achaeans (Greeks) against the city of Troy after Paris of Troy took Helen from her husband Menelaus, king of Sparta. The war is one of the most important events in Greek ...

Home | Troy Life & Fire Safety Ltd.

Troy Life & Fire Safety Ltd. is one of the largest suppliers of Fire Alarm, Fire Suppression, Security, Nurse call and Communications Systems in Canada. As an Edwards Authorized National Partner, ...

Troy - Prime Video

Based on the epic poem The Iliad by Homer.

Troy Apple Premium Partner | Troyestore

Uzman ekiplerden teknik destek alın Apple ürünleriniz için destek yetkili servis Troy'da! Hemen randevunuzu oluşturup teknik servis hizmeti alın.

Discover the Troy Bilt riding mower drive belt diagram to simplify your repairs. Learn more about maintenance tips and enhance your mower's performance today!

[Back to Home](#)