

# TwS Wireless Earbuds Manual

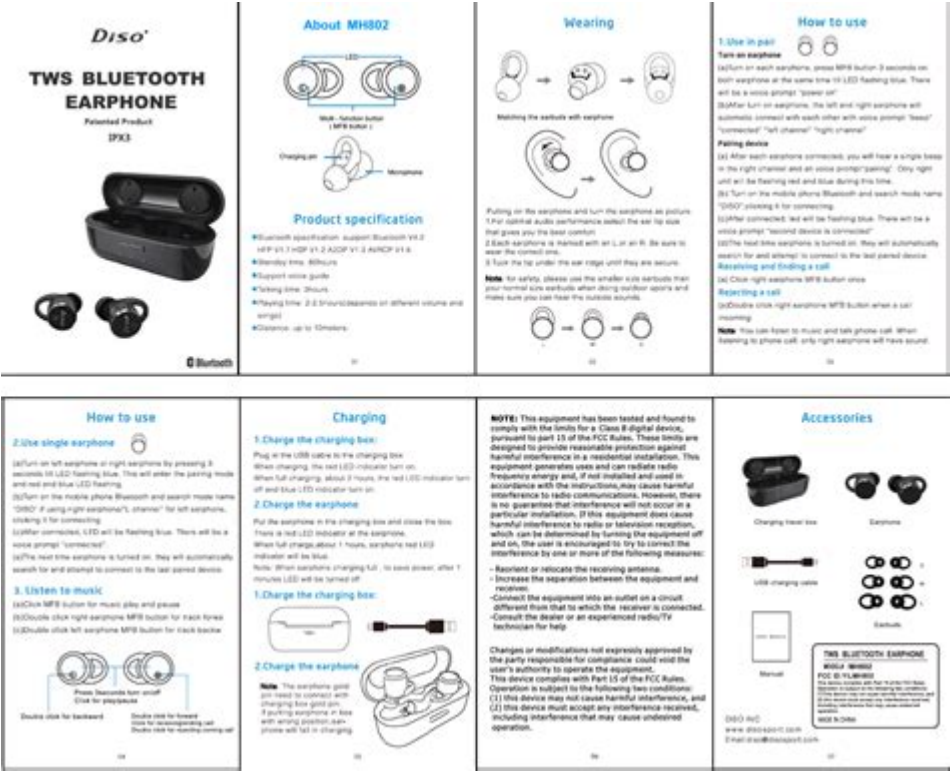

**TWS WIRELESS EARBUDS MANUAL** IS AN ESSENTIAL GUIDE FOR ANYONE LOOKING TO MAXIMIZE THEIR EXPERIENCE WITH TRUE WIRELESS STEREO (TWS) EARBUDS. WITH THE RAPID TECHNOLOGICAL ADVANCEMENTS IN AUDIO DEVICES, TWS EARBUDS HAVE BECOME INCREASINGLY POPULAR DUE TO THEIR CONVENIENCE, PORTABILITY, AND IMPRESSIVE SOUND QUALITY. THIS ARTICLE AIMS TO PROVIDE A COMPREHENSIVE OVERVIEW OF TWS WIRELESS EARBUDS, INCLUDING THEIR FEATURES, BENEFITS, AND A DETAILED MANUAL ON HOW TO OPERATE THEM EFFECTIVELY.

## WHAT ARE TWS WIRELESS EARBUDS?

TWS WIRELESS EARBUDS ARE COMPACT AUDIO DEVICES DESIGNED TO DELIVER HIGH-QUALITY SOUND WITHOUT THE HASSLE OF WIRES. UNLIKE TRADITIONAL WIRED HEADPHONES, TWS EARBUDS CONSIST OF TWO SEPARATE EARPIECES THAT CONNECT TO EACH OTHER AND YOUR AUDIO SOURCE VIA BLUETOOTH. THIS TECHNOLOGY ALLOWS USERS TO ENJOY THEIR FAVORITE MUSIC, PODCASTS, AND CALLS WITHOUT THE CONSTRAINTS OF CORDS.

## KEY FEATURES OF TWS WIRELESS EARBUDS

WHEN CHOOSING TWS WIRELESS EARBUDS, IT'S IMPORTANT TO CONSIDER SEVERAL KEY FEATURES THAT CAN SIGNIFICANTLY ENHANCE YOUR LISTENING EXPERIENCE:

- **BLUETOOTH CONNECTIVITY:** Most TWS earbuds use Bluetooth 5.0 or higher for a stable and efficient connection.
- **BATTERY LIFE:** Check the battery duration of both the earbuds and the charging case. Many models offer 4-8 hours of playback on a single charge, with additional charges available from the case.

- **SOUND QUALITY:** LOOK FOR EARBUDS THAT PROVIDE CLEAR SOUND AND GOOD BASS RESPONSE, AS WELL AS NOISE CANCELLATION FEATURES.
- **COMFORT AND FIT:** ERGONOMIC DESIGN AND DIFFERENT EAR TIP SIZES CAN GREATLY INFLUENCE COMFORT DURING EXTENDED USE.
- **WATER RESISTANCE:** MANY TWS EARBUDS COME WITH AN IP RATING, INDICATING THEIR RESISTANCE TO SWEAT AND MOISTURE, MAKING THEM SUITABLE FOR WORKOUTS.

## BENEFITS OF USING TWS WIRELESS EARBUDS

THERE ARE NUMEROUS ADVANTAGES TO USING TWS WIRELESS EARBUDS, MAKING THEM A PREFERRED CHOICE FOR MANY USERS:

1. **FREEDOM OF MOVEMENT:** WITH NO WIRES TO GET TANGLED, TWS EARBUDS ALLOW FOR UNRESTRICTED MOVEMENT, IDEAL FOR WORKOUTS, COMMUTING, OR MULTITASKING.
2. **COMPACT AND PORTABLE:** THEY ARE LIGHTWEIGHT AND CAN EASILY FIT IN YOUR POCKET, MAKING THEM CONVENIENT FOR ON-THE-GO USE.
3. **MULTIPLE USES:** TWS EARBUDS CAN BE USED FOR MUSIC, CALLS, GAMING, AND EVEN VOICE COMMANDS WITH SMART ASSISTANTS.
4. **IMPROVED SOUND QUALITY:** MANY TWS EARBUDS OFFER HIGH-DEFINITION AUDIO AND NOISE ISOLATION, ENHANCING THE LISTENING EXPERIENCE.
5. **TOUCH CONTROLS:** MOST MODELS COME EQUIPPED WITH TOUCH-SENSITIVE CONTROLS THAT ALLOW USERS TO PLAY, PAUSE, SKIP TRACKS, AND MANAGE CALLS EFFORTLESSLY.

## TWS WIRELESS EARBUDS MANUAL: GETTING STARTED

HAVING A WELL-STRUCTURED MANUAL TO GUIDE YOU THROUGH THE SETUP AND USE OF YOUR TWS WIRELESS EARBUDS IS CRUCIAL. HERE'S A STEP-BY-STEP GUIDE TO HELP YOU NAVIGATE YOUR NEW DEVICE.

### 1. UNBOXING AND INITIAL SETUP

UPON RECEIVING YOUR TWS WIRELESS EARBUDS, FOLLOW THESE STEPS FOR UNBOXING AND INITIAL SETUP:

- REMOVE THE EARBUDS AND CHARGING CASE FROM THE PACKAGING.
- CHARGE THE CHARGING CASE USING THE PROVIDED USB CABLE UNTIL THE LED INDICATOR SHOWS A FULL CHARGE.
- PLACE THE EARBUDS IN THE CHARGING CASE TO ENSURE THEY HAVE SUFFICIENT BATTERY FOR INITIAL USE.

### 2. PAIRING WITH YOUR DEVICE

TO ENJOY YOUR TWS EARBUDS, PAIRING THEM WITH YOUR SMARTPHONE OR AUDIO DEVICE IS ESSENTIAL. HERE'S HOW TO DO IT:

### 1. ACTIVATE BLUETOOTH ON YOUR DEVICE:

- GO TO THE SETTINGS MENU OF YOUR SMARTPHONE OR DEVICE.
- ENABLE BLUETOOTH.

### 2. ENTER PAIRING MODE:

- TAKE THE EARBUDS OUT OF THE CHARGING CASE; THEY SHOULD AUTOMATICALLY ENTER PAIRING MODE.
- IF THEY DON'T, PRESS AND HOLD THE TOUCH CONTROL OR BUTTON ON EACH EARBUD UNTIL YOU SEE A FLASHING LED LIGHT.

### 3. CONNECT THE EARBUDS:

- LOOK FOR THE EARBUDS IN THE BLUETOOTH MENU OF YOUR DEVICE.
- SELECT THE EARBUDS TO ESTABLISH A CONNECTION. ONCE CONNECTED, YOU MAY HEAR AN AUDIO CONFIRMATION.

## 3. USING YOUR TWS WIRELESS EARBUDS

ONCE PAIRED, YOU CAN START USING YOUR TWS WIRELESS EARBUDS. HERE ARE SOME COMMON FUNCTIONS:

- MUSIC CONTROL:
  - TAP THE RIGHT EARBUD TO PLAY/PAUSE MUSIC.
  - DOUBLE-TAP TO SKIP TO THE NEXT TRACK.
  - TRIPLE-TAP TO GO BACK TO THE PREVIOUS TRACK.
- CALLS:
  - TAP THE EARBUD ONCE TO ANSWER/END CALLS.
  - DOUBLE-TAP TO REJECT AN INCOMING CALL.
- VOICE ASSISTANT:
  - PRESS AND HOLD THE DESIGNATED EARBUD TO ACTIVATE YOUR DEVICE'S VOICE ASSISTANT (E.G., SIRI, GOOGLE ASSISTANT).

## MAINTENANCE AND TROUBLESHOOTING

TO ENSURE YOUR TWS WIRELESS EARBUDS LAST LONG AND PERFORM OPTIMALLY, FOLLOW THESE MAINTENANCE TIPS:

### 1. CLEANING YOUR EARBUDS

REGULAR CLEANING IS ESSENTIAL TO MAINTAIN SOUND QUALITY AND HYGIENE. USE A SOFT, DRY CLOTH TO WIPE THE EXTERIOR AND A COTTON SWAB FOR THE SPEAKER MESH. AVOID USING LIQUIDS OR HARSH CHEMICALS.

### 2. SOFTWARE UPDATES

CHECK FOR FIRMWARE UPDATES FROM THE MANUFACTURER'S APP OR WEBSITE. KEEPING YOUR EARBUDS UPDATED CAN ENHANCE PERFORMANCE AND ADD NEW FEATURES.

### 3. BATTERY CARE

TO PROLONG BATTERY LIFE, AVOID LETTING YOUR EARBUDS COMPLETELY DISCHARGE FREQUENTLY. CHARGE THEM REGULARLY AND STORE THEM IN A COOL, DRY PLACE.

## 4. TROUBLESHOOTING COMMON ISSUES

IF YOU ENCOUNTER PROBLEMS WITH YOUR TWS WIRELESS EARBUDS, CONSIDER THESE TROUBLESHOOTING STEPS:

- UNABLE TO CONNECT:
  - ENSURE BLUETOOTH IS TURNED ON AND THE EARBUDS ARE IN PAIRING MODE.
  - FORGET THE DEVICE IN BLUETOOTH SETTINGS AND TRY RECONNECTING.
- AUDIO QUALITY ISSUES:
  - CHECK FOR DIRT IN THE SPEAKER MESH AND CLEAN IF NECESSARY.
  - ENSURE THE BATTERY IS CHARGED AND THE DEVICE IS WITHIN RANGE.
- BATTERY DRAINING QUICKLY:
  - REDUCE THE VOLUME AND TURN OFF FEATURES LIKE NOISE CANCELLATION IF NOT NEEDED.

## CONCLUSION

UNDERSTANDING YOUR **TWS WIRELESS EARBUDS MANUAL** IS CRUCIAL FOR A SEAMLESS AUDIO EXPERIENCE. BY FAMILIARIZING YOURSELF WITH THEIR FEATURES, SETUP, AND MAINTENANCE, YOU CAN ENHANCE YOUR ENJOYMENT OF MUSIC, CALLS, AND MORE. AS TWS TECHNOLOGY CONTINUES TO EVOLVE, KEEPING UP WITH BEST PRACTICES AND TROUBLESHOOTING CAN ENSURE THAT YOU MAXIMIZE THE USE OF YOUR WIRELESS EARBUDS FOR YEARS TO COME. WHETHER YOU ARE A CASUAL LISTENER OR AN AUDIOPHILE, TWS WIRELESS EARBUDS OFFER A CONVENIENT AND HIGH-QUALITY AUDIO SOLUTION THAT ADAPTS TO YOUR LIFESTYLE.

## FREQUENTLY ASKED QUESTIONS

### WHAT SHOULD I DO IF MY TWS WIRELESS EARBUDS WON'T CONNECT TO MY DEVICE?

FIRST, ENSURE THAT THE EARBUDS ARE CHARGED AND IN PAIRING MODE. IF THEY STILL WON'T CONNECT, TRY RESTARTING YOUR DEVICE AND THE EARBUDS, AND THEN ATTEMPT TO PAIR AGAIN.

### HOW CAN I RESET MY TWS WIRELESS EARBUDS TO FACTORY SETTINGS?

TO RESET YOUR TWS EARBUDS, PLACE THEM IN THEIR CHARGING CASE, THEN PRESS AND HOLD THE TOUCH SENSORS OR BUTTONS ON BOTH EARBUDS FOR ABOUT 10 SECONDS UNTIL YOU SEE THE LED INDICATORS FLASH, INDICATING THEY HAVE BEEN RESET.

### WHAT DO THE LED INDICATORS ON MY TWS WIRELESS EARBUDS MEAN?

LED INDICATORS TYPICALLY SHOW THE BATTERY STATUS, CONNECTION STATUS, AND CHARGING STATE. REFER TO YOUR MANUAL FOR SPECIFIC MEANINGS, AS THEY CAN VARY BY MODEL.

### HOW DO I CHARGE MY TWS WIRELESS EARBUDS PROPERLY?

TO CHARGE YOUR TWS EARBUDS, PLACE THEM IN THE CHARGING CASE AND CONNECT THE CASE TO A POWER SOURCE USING THE PROVIDED USB CABLE. ENSURE THE CASE IS FULLY CHARGED BEFORE USE.

### CAN I USE ONLY ONE EARBUD AT A TIME?

YES, MOST TWS EARBUDS ALLOW YOU TO USE JUST ONE EARBUD AT A TIME. SIMPLY TAKE ONE EARBUD OUT OF THE CASE, AND IT WILL CONNECT TO YOUR DEVICE INDEPENDENTLY.

## How do I update the firmware of my TWS wireless earbuds?

CHECK THE MANUFACTURER'S APP OR WEBSITE FOR FIRMWARE UPDATES. IF AVAILABLE, FOLLOW THE INSTRUCTIONS PROVIDED IN THE APP TO DOWNLOAD AND INSTALL THE LATEST FIRMWARE.

## What should I do if the audio quality is poor on my TWS wireless earbuds?

ENSURE THAT THE EARBUDS ARE PROPERLY SEATED IN YOUR EARS FOR A GOOD SEAL, CHECK FOR ANY OBSTRUCTIONS, AND TRY RESETTING THE EARBUDS. IF THE PROBLEM PERSISTS, CONSULT YOUR MANUAL FOR TROUBLESHOOTING TIPS.

## Are my TWS wireless earbuds water-resistant?

CHECK THE SPECIFICATIONS IN YOUR MANUAL. MANY TWS EARBUDS COME WITH AN IP RATING INDICATING THEIR LEVEL OF WATER RESISTANCE, WHICH CAN RANGE FROM SPLASH-PROOF TO FULLY WATERPROOF.

Find other PDF article:

<https://soc.up.edu.ph/29-scan/pdf?trackid=kmf86-1494&title=how-does-deep-pressure-therapy-work.pdf>

## [Tws Wireless Earbuds Manual](#)

vivovivo TWS A3 -

vivo TWS A3 app 1 vivo app

TWS -

Jun 25, 2020 · TWS TWS TWS ...

vivo vivo tws4hifi tws4 tws3e tws air2 ...

Aug 30, 2024 · vivo vivo vivo vivo tws4hifi tws4 tws3e tws air2 Jov IP54

10 2024 /TWS Buds ...

May 6, 2024 · 7 Pro 399 400 TWS TWS

5 200 2025 618 ...

Jun 3, 2025 · 5 tws 80 30 20 ( ) 50 20

vivo

iQOO TWS 1i 10 45 15 2

2025 TWS ...

Jul 9, 2025 · WF-1000XM5 “ ” TWS

Jan 13, 2023 · 2022 TWS TWS

$\text{E}[\text{TWS}] = \text{E}[\text{TWS} + \text{E}[\text{TWS} | \text{E}[\text{TWS}]]]$

2.4g?PC?PC?airpods/

vivo TWS A3 app 1 vivo app

[illegible]

Aug 30, 2024 · vivo·····vivo·····vivo·····vivo tws4hifi  
tws4tws3etws air2·····Jovl·····IP54·····

May 6, 2024 · 7:00 PM Pro 399 400 TWS

[illegible]

iQOO TWS 1i□□□□□□□□□□□□□□□□□□□□10□□□□□□□□□□□□□□□□45□□□□□□□□□□□□□□□□15□□□□□□□□□□2□□□□□

Jul 9, 2025 · 0000 WF-1000XM5 00000000000000000000 “0000” 00000000000000000000 “00” 0TWS 0000000000  
000000000000 0000000000

Jan 13, 2023 · 2022 TWS TWS

$\text{TWSS}_1 + \text{TWSS}_2 + \text{TWSS}_3 + \dots + \text{TWSS}_n$

2.4g?PC?twspc?twspc 2.4g?twspcPC?airpodspc/pcpc  
pcpc

"Get the ultimate guide with our TWS wireless earbuds manual. Discover setup tips

[Back to Home](#)