

Troy Bilt Tb160 Carburetor Diagram

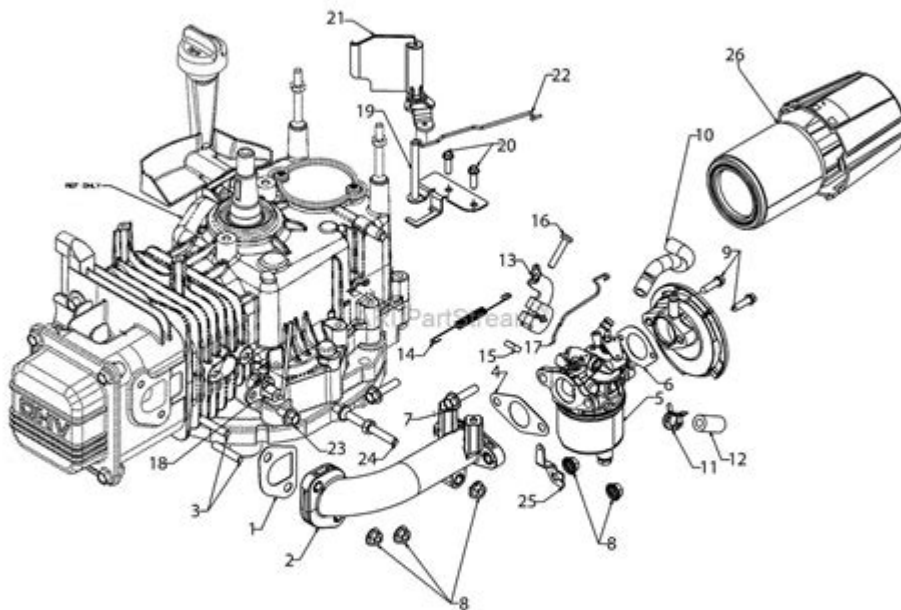

Copyright
Page Design © 2004 - 2016 by JRI Network Services, Inc.

TROY BILT TB160 CARBURETOR DIAGRAM IS AN ESSENTIAL REFERENCE FOR ANYONE LOOKING TO MAINTAIN, REPAIR, OR UNDERSTAND THEIR LAWN MOWER. THIS MODEL, WIDELY KNOWN FOR ITS RELIABILITY AND PERFORMANCE, COMES EQUIPPED WITH A CARBURETOR THAT PLAYS A CRITICAL ROLE IN THE ENGINE'S OVERALL FUNCTION. UNDERSTANDING THE LAYOUT AND COMPONENTS OF THE CARBURETOR CAN SIGNIFICANTLY ENHANCE YOUR ABILITY TO TROUBLESHOOT ISSUES AND CARRY OUT EFFECTIVE MAINTENANCE. IN THIS ARTICLE, WE WILL EXPLORE THE COMPONENTS OF THE CARBURETOR, HOW TO READ THE DIAGRAM, THE COMMON PROBLEMS ASSOCIATED WITH IT, AND STEP-BY-STEP INSTRUCTIONS FOR MAINTENANCE.

UNDERSTANDING THE CARBURETOR FUNCTIONS

A CARBURETOR IS A DEVICE THAT MIXES AIR WITH A FINE SPRAY OF LIQUID FUEL. THE MIXTURE IS ESSENTIAL FOR COMBUSTION IN THE ENGINE. THE PROPER FUNCTIONING OF THE CARBURETOR ENSURES THAT THE ENGINE RUNS SMOOTHLY, PROVIDING THE NECESSARY POWER FOR CUTTING GRASS AND PERFORMING OTHER TASKS.

KEY FUNCTIONS OF A CARBURETOR

1. AIR-FUEL MIXTURE: THE CARBURETOR'S PRIMARY FUNCTION IS TO MIX AIR AND FUEL IN THE CORRECT PROPORTIONS FOR COMBUSTION.
2. ATOMIZATION: IT BREAKS DOWN THE FUEL INTO SMALL DROPLETS, ALLOWING FOR BETTER MIXING WITH AIR.
3. THROTTLE CONTROL: IT REGULATES THE AMOUNT OF AIR AND FUEL ENTERING THE ENGINE, CONTROLLING ENGINE SPEED AND POWER OUTPUT.
4. STARTING ASSISTANCE: SOME CARBURETORS HAVE FEATURES THAT HELP WITH COLD STARTS, SUCH AS CHOKE MECHANISMS.

COMPONENTS OF THE TROY BILT TB160 CARBURETOR

UNDERSTANDING THE SPECIFIC COMPONENTS OF THE TROY BILT TB160 CARBURETOR CAN HELP YOU IDENTIFY ISSUES AND PERFORM MAINTENANCE EFFECTIVELY. HERE'S A BREAKDOWN OF THE KEY COMPONENTS:

MAIN COMPONENTS

- FLOAT CHAMBER: MAINTAINS A RESERVOIR OF FUEL, ENSURING A STEADY SUPPLY TO THE ENGINE.
- FLOAT: REGULATES THE FUEL LEVEL IN THE FLOAT CHAMBER.
- NEEDLE VALVE: CONTROLS FUEL FLOW INTO THE FLOAT CHAMBER.
- MAIN JET: RESPONSIBLE FOR DELIVERING FUEL INTO THE AIRFLOW.
- CHOKE PLATE: A VALVE THAT RESTRICTS AIRFLOW FOR COLD STARTS.
- THROTTLE PLATE: CONTROLS THE AMOUNT OF AIR-FUEL MIXTURE ENTERING THE ENGINE.
- VENTURI TUBE: CREATES A VACUUM THAT DRAWS FUEL FROM THE FLOAT CHAMBER INTO THE AIRSTREAM.

READING THE TROY BILT TB160 CARBURETOR DIAGRAM

THE TROY BILT TB160 CARBURETOR DIAGRAM PROVIDES A VISUAL REPRESENTATION OF THE COMPONENTS AND THEIR RELATIONSHIPS. FAMILIARIZING YOURSELF WITH THIS DIAGRAM CAN HELP YOU UNDERSTAND HOW THE CARBURETOR WORKS AND HOW TO TROUBLESHOOT ISSUES.

KEY FEATURES OF THE DIAGRAM

1. LABELS: EACH COMPONENT IS USUALLY LABELED FOR EASY IDENTIFICATION.
2. FLOW ARROWS: ARROWS MAY INDICATE THE DIRECTION OF AIRFLOW AND FUEL FLOW.
3. CONNECTIONS: SHOWS HOW DIFFERENT PARTS CONNECT, WHICH IS CRUCIAL FOR REASSEMBLY.
4. COLOR CODES: SOME DIAGRAMS USE COLOR CODES TO INDICATE DIFFERENT FUEL TYPES OR COMPONENT MATERIALS.

COMMON PROBLEMS WITH THE CARBURETOR

EVEN WITH PROPER MAINTENANCE, CARBURETORS CAN ENCOUNTER ISSUES THAT AFFECT PERFORMANCE. HERE ARE SOME COMMON PROBLEMS ASSOCIATED WITH THE TROY BILT TB160 CARBURETOR:

1. CLOGGED JETS

- SYMPTOMS: POOR ENGINE PERFORMANCE, STARTING DIFFICULTIES, OR STALLING.

- SOLUTION: CLEAN THE JETS USING CARBURETOR CLEANER OR A FINE WIRE TO REMOVE ANY DEBRIS.

2. FUEL LEAKS

- SYMPTOMS: VISIBLE FUEL POOLING UNDER THE MOWER OR A STRONG SMELL OF GASOLINE.
- SOLUTION: INSPECT THE FLOAT AND NEEDLE VALVE FOR DAMAGE OR WEAR AND REPLACE IF NECESSARY.

3. STICKING FLOAT

- SYMPTOMS: OVERFLOWS IN THE FUEL CHAMBER AND INCONSISTENT FUEL DELIVERY.
- SOLUTION: CHECK FOR DIRT OR DEBRIS THAT MAY BE CAUSING THE FLOAT TO STICK. CLEAN OR REPLACE AS NEEDED.

4. CHOKE ISSUES

- SYMPTOMS: DIFFICULTY STARTING, ESPECIALLY IN COLD WEATHER.
- SOLUTION: ENSURE THE CHOKE PLATE OPERATES SMOOTHLY AND ISN'T STUCK IN THE CLOSED POSITION.

MAINTENANCE TIPS FOR THE CARBURETOR

REGULAR MAINTENANCE CAN HELP PREVENT MANY COMMON CARBURETOR ISSUES. HERE ARE SOME ESSENTIAL TIPS:

1. REGULAR CLEANING

- CLEAN THE CARBURETOR REGULARLY, ESPECIALLY IF THE MOWER SITS FOR EXTENDED PERIODS.
- USE A CARBURETOR CLEANER AND A SOFT BRUSH TO REMOVE DEPOSITS.

2. FUEL QUALITY

- ALWAYS USE FRESH FUEL TO PREVENT GUM AND VARNISH BUILDUP.
- CONSIDER ADDING A FUEL STABILIZER IF THE MOWER WILL NOT BE USED FOR A WHILE.

3. CHECK FOR AIR LEAKS

- INSPECT GASKETS AND SEALS REGULARLY FOR SIGNS OF WEAR OR DAMAGE.
- REPLACE ANY DAMAGED COMPONENTS TO ENSURE A PROPER SEAL.

4. ADJUSTING THE CARBURETOR

- CONSULT THE OWNER'S MANUAL FOR SPECIFIC ADJUSTMENT PROCEDURES.
- MAKE MINOR ADJUSTMENTS TO THE IDLE AND MIXTURE SCREWS TO ACHIEVE OPTIMAL PERFORMANCE.

STEP-BY-STEP GUIDE TO CLEANING THE CARBURETOR

CLEANING THE CARBURETOR CAN GREATLY ENHANCE THE PERFORMANCE OF YOUR TROY BILT TB160. FOLLOW THESE STEPS FOR A THOROUGH CLEANING:

MATERIALS NEEDED

- CARBURETOR CLEANER
- SOFT BRUSH OR TOOTHBRUSH
- SCREWDRIVER SET
- CLEAN RAGS
- COMPRESSED AIR (OPTIONAL)

STEPS FOR CLEANING

1. DISASSEMBLE:
 - REMOVE THE AIR FILTER AND THE CARBURETOR FROM THE ENGINE.
 - TAKE NOTE OF THE CONFIGURATION FOR REASSEMBLY.
2. SOAK COMPONENTS:
 - SOAK THE CARBURETOR BODY IN CARBURETOR CLEANER FOR 15-30 MINUTES.
 - USE A SOFT BRUSH TO SCRUB AWAY ANY STUBBORN DEPOSITS.
3. CLEAN JETS AND PASSAGES:
 - USE COMPRESSED AIR OR A FINE WIRE TO CLEAR OUT JETS AND PASSAGES.
 - ENSURE ALL PATHWAYS ARE UNOBSTRUCTED.
4. INSPECT PARTS:
 - CHECK THE FLOAT, NEEDLE VALVE, AND GASKETS FOR WEAR OR DAMAGE.
 - REPLACE ANY DAMAGED COMPONENTS.
5. REASSEMBLE:
 - REASSEMBLE THE CARBURETOR, ENSURING ALL PARTS ARE CORRECTLY POSITIONED.
 - REATTACH IT TO THE ENGINE AND REPLACE THE AIR FILTER.
6. TEST RUN:
 - START THE MOWER AND ALLOW IT TO RUN TO ENSURE EVERYTHING IS FUNCTIONING CORRECTLY.

CONCLUSION

THE TROY BILT TB160 CARBURETOR DIAGRAM SERVES AS A VALUABLE TOOL FOR ANY OWNER LOOKING TO MAINTAIN OR REPAIR THEIR MOWER. UNDERSTANDING THE COMPONENTS, READING THE DIAGRAM, AND PERFORMING REGULAR MAINTENANCE CAN ENHANCE THE PERFORMANCE AND LONGEVITY OF YOUR LAWN MOWER. BY FOLLOWING THE GUIDELINES OUTLINED IN THIS ARTICLE, YOU CAN EFFECTIVELY TROUBLESHOOT ISSUES AND ENSURE THAT YOUR MOWER OPERATES AT ITS BEST, READY TO TACKLE ANY LAWN CARE TASK. WHETHER YOU'RE AN EXPERIENCED MECHANIC OR A DIY ENTHUSIAST, HAVING A COMPREHENSIVE UNDERSTANDING OF THE CARBURETOR WILL EMPOWER YOU TO KEEP YOUR TROY BILT TB160 IN PRIME CONDITION.

FREQUENTLY ASKED QUESTIONS

WHAT IS THE PURPOSE OF THE CARBURETOR IN THE TROY BILT TB160?

THE CARBURETOR IN THE TROY BILT TB160 IS RESPONSIBLE FOR MIXING THE RIGHT AMOUNT OF AIR AND FUEL FOR COMBUSTION IN THE ENGINE, ENSURING OPTIMAL PERFORMANCE AND EFFICIENCY.

WHERE CAN I FIND A DETAILED CARBURETOR DIAGRAM FOR THE TROY BILT TB160?

A DETAILED CARBURETOR DIAGRAM FOR THE TROY BILT TB160 CAN BE FOUND IN THE OWNER'S MANUAL, ON THE TROY BILT OFFICIAL WEBSITE, OR THROUGH VARIOUS REPAIR AND PARTS WEBSITES.

WHAT ARE THE COMMON ISSUES THAT CAN ARISE WITH THE CARBURETOR IN THE TB160?

COMMON ISSUES WITH THE TB160 CARBURETOR INCLUDE CLOGGING DUE TO OLD FUEL, IMPROPER ADJUSTMENTS LEADING TO POOR ENGINE PERFORMANCE, AND LEAKS FROM WORN GASKETS.

HOW DO I TROUBLESHOOT CARBURETOR PROBLEMS IN MY TROY BILT TB160?

TO TROUBLESHOOT CARBURETOR PROBLEMS IN YOUR TB160, START BY CHECKING FOR FUEL FLOW, INSPECTING FOR CLOGS OR DEBRIS, AND VERIFYING THAT THE CARBURETOR IS PROPERLY ADJUSTED AND SECURELY MOUNTED.

CAN I REPLACE THE CARBURETOR ON THE TROY BILT TB160 MYSELF?

YES, YOU CAN REPLACE THE CARBURETOR ON THE TROY BILT TB160 YOURSELF IF YOU HAVE BASIC MECHANICAL SKILLS AND THE RIGHT TOOLS. BE SURE TO REFER TO THE CARBURETOR DIAGRAM FOR GUIDANCE DURING THE REPLACEMENT PROCESS.

Find other PDF article:

<https://soc.up.edu.ph/28-font/Book?ID=RgV10-2600&title=hollywood-self-guided-driving-tour.pdf>

[Troy Bilt Tb160 Carburetor Diagram](#)

Troy - Wikipedia

It is best known as the setting for the Greek myth of the Trojan War. The archaeological site is open to the public as a tourist destination, and was added to the UNESCO World Heritage list in 1998. Troy was repeatedly destroyed and rebuilt during its 4000 years of occupation.

Troy (2004) - IMDb

May 14, 2004 · Troy: Directed by Wolfgang Petersen. With Julian Glover, Brian Cox, Nathan Jones, Adoni Maropis. An adaptation of Homer's great epic, the film follows the assault on Troy by the united Greek forces.

Where Was Troy And What Happened To It? - WorldAtlas

Oct 13, 2022 · Troy was an ancient Bronze Age city located in modern-day Turkey. It was also the legendary setting for Homer's epic poems, the Iliad and the Odyssey, mentioned in the introduction. The city of Troy was strategically positioned between the Mediterranean Sea and the civilizations to the East.

Troy streaming: where to watch movie online? - JustWatch

Find out how and where to watch "Troy" online on Netflix, Prime Video, and Disney+ today - including 4K and free options.

Troy (film) - Wikipedia

Troy is a 2004 epic historical action film directed by Wolfgang Petersen and written by David Benioff.

Troy (2004) - Full cast & crew - IMDb

Troy (2004) - Cast and crew credits, including actors, actresses, directors, writers and more.

Trojan War - Wikipedia

The war was waged by the Achaeans (Greeks) against the city of Troy after Paris of Troy took Helen from her husband Menelaus, king of Sparta. The war is one of the most important events in Greek mythology, and it has been narrated through many works of ...

Home | Troy Life & Fire Safety Ltd.

Troy Life & Fire Safety Ltd. is one of the largest suppliers of Fire Alarm, Fire Suppression, Security, Nurse call and Communications Systems in Canada. As an Edwards Authorized ...

Troy - Prime Video

Based on the epic poem The Iliad by Homer.

Troy Apple Premium Partner | Troyestore

Uzman ekiplerden teknik destek alın Apple ürünleriniz için destek yetkili servis Troy'da! Hemen randevunuzu oluşturup teknik servis hizmeti alın.

Troy - Wikipedia

It is best known as the setting for the Greek myth of the Trojan War. The archaeological site is open to the public as a tourist destination, and ...

Troy (2004) - IMDb

May 14, 2004 · Troy: Directed by Wolfgang Petersen. With Julian Glover, Brian Cox, Nathan Jones, Adoni Maropis. An adaptation of ...

Where Was Troy And What Happened To It? - WorldAtlas

Oct 13, 2022 · Troy was an ancient Bronze Age city located in modern-day Turkey. It was also the legendary setting for Homer's epic poems, ...

Troy streaming: where to watch movie online? - JustWatch

Find out how and where to watch "Troy" online on Netflix, Prime Video, and Disney+ today - including 4K and free options.

Troy (film) - Wikipedia

Troy is a 2004 epic historical action film directed by Wolfgang Petersen and written by David Benioff.

Explore the Troy Bilt TB160 carburetor diagram to enhance your understanding of its components. Learn more about maintenance and troubleshooting tips today!

[Back to Home](#)