

# True T 72 Service Manual

## 1. FEATURE CHART

1-1. FRONT VIEW (MSR-23NM MSR-49NM MSF-23NM MSF-49NM)

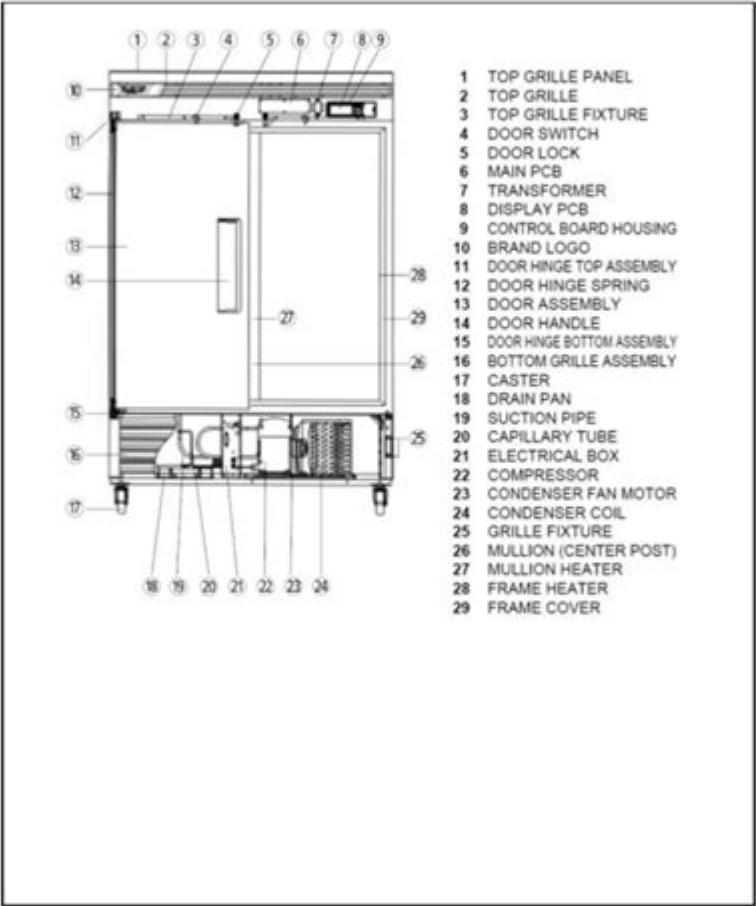

True T 72 Service Manual is an essential resource for technicians and owners of True T 72 refrigeration equipment. This manual provides comprehensive guidelines for installation, operation, maintenance, and troubleshooting of the True T 72 series, which is widely used in food service and commercial settings. Ensuring that your True T 72 operates efficiently not only helps maintain the quality of stored products but also contributes to lower energy costs and a longer lifespan for the unit. This article will delve into the key components and features of the True T 72, explain the importance of the service manual, and provide practical tips on maintenance and troubleshooting.

## Overview of the True T 72

The True T 72 is a two-door reach-in refrigerator designed to meet the rigorous demands of the foodservice

INDUSTRY. KNOWN FOR ITS DURABILITY, EFFICIENCY, AND INNOVATIVE FEATURES, THE TRUE T 72 IS AN IDEAL SOLUTION FOR KEEPING PERISHABLE FOOD ITEMS AT OPTIMAL TEMPERATURES.

## KEY FEATURES

- CAPACITY: WITH A SPACIOUS INTERIOR, THE TRUE T 72 CAN HOLD A SIGNIFICANT AMOUNT OF FOOD ITEMS, MAKING IT SUITABLE FOR RESTAURANTS, CAFES, AND CATERING SERVICES.
- TEMPERATURE CONTROL: THE UNIT IS EQUIPPED WITH A RELIABLE TEMPERATURE CONTROL SYSTEM, ALLOWING FOR PRECISE ADJUSTMENTS TO MAINTAIN FOOD SAFETY.
- ENERGY EFFICIENCY: DESIGNED WITH ENERGY-SAVING FEATURES, THE TRUE T 72 HELPS REDUCE ELECTRICITY COSTS WHILE PROVIDING OPTIMAL COOLING.
- DURABLE CONSTRUCTION: THE UNIT FEATURES A STAINLESS STEEL EXTERIOR AND INTERIOR, ENSURING LONGEVITY AND EASE OF CLEANING.
- SELF-CLOSING DOORS: THE SELF-CLOSING DOORS ENHANCE ENERGY EFFICIENCY BY MINIMIZING COLD AIR LOSS.

## IMPORTANCE OF THE SERVICE MANUAL

THE TRUE T 72 SERVICE MANUAL IS A CRITICAL TOOL FOR ANYONE WORKING WITH THIS REFRIGERATION UNIT. IT PROVIDES DETAILED INSTRUCTIONS THAT COVER EVERY ASPECT OF THE EQUIPMENT, ENSURING THAT BOTH NOVICE AND EXPERIENCED TECHNICIANS CAN OPERATE AND MAINTAIN THE UNIT EFFECTIVELY.

## CONTENTS OF THE SERVICE MANUAL

THE SERVICE MANUAL TYPICALLY INCLUDES THE FOLLOWING SECTIONS:

1. PRODUCT SPECIFICATIONS: DETAILED INFORMATION ON DIMENSIONS, WEIGHT, AND PERFORMANCE PARAMETERS.
2. INSTALLATION GUIDELINES: STEP-BY-STEP INSTRUCTIONS ON HOW TO INSTALL THE UNIT SAFELY AND EFFECTIVELY.
3. OPERATING INSTRUCTIONS: INFORMATION ON HOW TO OPERATE THE REFRIGERATOR, INCLUDING TEMPERATURE SETTINGS AND BEST PRACTICES FOR LOADING AND UNLOADING.
4. MAINTENANCE PROCEDURES: REGULAR MAINTENANCE TASKS TO ENSURE OPTIMAL PERFORMANCE, INCLUDING CLEANING SCHEDULES AND COMPONENT CHECKS.
5. TROUBLESHOOTING GUIDE: COMMON ISSUES THAT MAY ARISE ALONG WITH SOLUTIONS AND DIAGNOSTIC STEPS.
6. PARTS LIST: A COMPREHENSIVE LIST OF ALL COMPONENTS WITH PART NUMBERS FOR EASY ORDERING.

## INSTALLATION GUIDELINES

PROPER INSTALLATION IS VITAL FOR THE EFFICIENT OPERATION OF THE TRUE T 72. HERE ARE SOME KEY STEPS TO FOLLOW WHEN INSTALLING THE UNIT:

## SITE PREPARATION

- LOCATION: CHOOSE A WELL-VENTILATED AREA AWAY FROM DIRECT SUNLIGHT AND HEAT SOURCES.
- LEVEL SURFACE: ENSURE THAT THE FLOOR IS LEVEL TO PREVENT THE REFRIGERATOR FROM TIPPING OR CAUSING UNEVEN WEAR.
- ELECTRICAL REQUIREMENTS: CHECK THAT THE ELECTRICAL SUPPLY MEETS THE REQUIRED VOLTAGE AND AMPERAGE FOR THE TRUE T 72.

## INSTALLATION STEPS

1. UNPACK THE UNIT: CAREFULLY REMOVE THE TRUE T 72 FROM ITS PACKAGING, INSPECTING FOR ANY VISIBLE DAMAGE.
2. POSITION THE REFRIGERATOR: MOVE THE UNIT TO ITS DESIRED LOCATION, ENSURING THERE IS ADEQUATE SPACE FOR AIRFLOW AROUND THE UNIT.
3. CONNECT POWER: PLUG THE UNIT INTO A PROPERLY GROUNDED OUTLET, ENSURING THAT THE ELECTRICAL CONNECTION MEETS THE SPECIFICATIONS OUTLINED IN THE SERVICE MANUAL.
4. SET TEMPERATURE: ADJUST THE THERMOSTAT TO THE DESIRED SETTING AS PER THE OPERATING INSTRUCTIONS.

## MAINTENANCE PROCEDURES

REGULAR MAINTENANCE IS ESSENTIAL TO PROLONG THE LIFE OF THE TRUE T 72 AND TO ENSURE IT OPERATES EFFICIENTLY. HERE ARE SOME RECOMMENDED MAINTENANCE TASKS:

### DAILY MAINTENANCE

- CHECK TEMPERATURE: MONITOR THE INTERNAL TEMPERATURE TO ENSURE IT REMAINS WITHIN THE SAFE RANGE.
- CLEAN THE INTERIOR: WIPE DOWN SURFACES TO PREVENT THE BUILDUP OF SPILLS OR CONTAMINANTS.
- INSPECT DOOR SEALS: ENSURE THAT DOOR GASKETS ARE SEALING PROPERLY TO MINIMIZE AIR LEAKS.

### MONTHLY MAINTENANCE

1. CLEAN CONDENSER COILS: DUST AND DEBRIS CAN ACCUMULATE ON THE COILS, REDUCING EFFICIENCY. USE A SOFT BRUSH OR VACUUM TO CLEAN THEM.
2. CHECK DRAINAGE SYSTEM: ENSURE THAT THE CONDENSATE DRAIN IS CLEAR AND FUNCTIONING TO PREVENT WATER BUILDUP.
3. INSPECT ELECTRICAL COMPONENTS: LOOK FOR SIGNS OF WEAR OR DAMAGE ON ELECTRICAL CONNECTIONS AND COMPONENTS.

### ANNUAL MAINTENANCE

- PROFESSIONAL INSPECTION: IT IS ADVISABLE TO HAVE A CERTIFIED TECHNICIAN PERFORM A COMPREHENSIVE INSPECTION AND MAINTENANCE SERVICE AT LEAST ONCE A YEAR.
- REFRIGERANT CHECK: ENSURE THAT REFRIGERANT LEVELS ARE ADEQUATE AND THAT THERE ARE NO LEAKS IN THE SYSTEM.

## TROUBLESHOOTING COMMON ISSUES

THE TRUE T 72 SERVICE MANUAL INCLUDES A TROUBLESHOOTING GUIDE THAT CAN HELP IDENTIFY AND RESOLVE COMMON PROBLEMS THAT MAY ARISE DURING OPERATION. HERE ARE SOME TYPICAL ISSUES AND THEIR POTENTIAL SOLUTIONS:

### UNIT NOT COOLING

- CHECK POWER SUPPLY: ENSURE THAT THE UNIT IS PROPERLY PLUGGED IN AND THAT THE OUTLET IS FUNCTIONING.
- THERMOSTAT SETTING: VERIFY THAT THE THERMOSTAT IS SET TO THE DESIRED COOLING TEMPERATURE.
- BLOCKED CONDENSER COILS: CLEAN THE COILS IF THEY ARE DIRTY OR OBSTRUCTED.

## EXCESSIVE NOISE

- CHECK FOR LOOSE PARTS: INSPECT THE UNIT FOR ANY LOOSE SCREWS OR COMPONENTS THAT MAY BE RATTLING.
- COMPRESSOR ISSUES: IF THE COMPRESSOR IS MAKING UNUSUAL NOISES, IT MAY REQUIRE SERVICING BY A PROFESSIONAL.

## LEAKING WATER

- INSPECT DRAIN PAN: ENSURE THAT THE DRAIN PAN IS PROPERLY POSITIONED AND NOT OVERFLOWING.
- CHECK FOR BLOCKAGES: CLEAR ANY BLOCKAGES IN THE DRAINAGE SYSTEM TO PREVENT WATER BUILDUP.

## CONCLUSION

THE TRUE T 72 SERVICE MANUAL IS AN INVALUABLE RESOURCE FOR ANYONE INVOLVED WITH THE OPERATION AND MAINTENANCE OF THIS REFRIGERATION UNIT. BY FOLLOWING THE GUIDELINES PROVIDED IN THE MANUAL, USERS CAN ENSURE THAT THEIR TRUE T 72 OPERATES EFFICIENTLY AND RELIABLY, ULTIMATELY ENHANCING THEIR FOOD SERVICE OPERATIONS. REGULAR MAINTENANCE, PROPER INSTALLATION, AND PROMPT TROUBLESHOOTING CAN SIGNIFICANTLY EXTEND THE LIFESPAN OF THE UNIT AND IMPROVE OVERALL PERFORMANCE. WHETHER YOU ARE A TECHNICIAN OR A BUSINESS OWNER, FAMILIARIZING YOURSELF WITH THE CONTENTS OF THE SERVICE MANUAL WILL EMPOWER YOU TO TAKE FULL ADVANTAGE OF THE CAPABILITIES OFFERED BY THE TRUE T 72.

## FREQUENTLY ASKED QUESTIONS

### WHAT IS THE PURPOSE OF THE TRUE T 72 SERVICE MANUAL?

THE TRUE T 72 SERVICE MANUAL PROVIDES DETAILED INSTRUCTIONS FOR THE MAINTENANCE, TROUBLESHOOTING, AND REPAIR OF THE TRUE T 72 REFRIGERATION UNIT, ENSURING OPTIMAL PERFORMANCE AND LONGEVITY.

### WHERE CAN I FIND THE TRUE T 72 SERVICE MANUAL?

THE TRUE T 72 SERVICE MANUAL CAN TYPICALLY BE FOUND ON THE MANUFACTURER'S OFFICIAL WEBSITE, THROUGH AUTHORIZED DEALERS, OR BY CONTACTING TRUE'S CUSTOMER SERVICE FOR A DIGITAL OR PRINTED COPY.

### WHAT ARE THE KEY SECTIONS INCLUDED IN THE TRUE T 72 SERVICE MANUAL?

KEY SECTIONS OF THE TRUE T 72 SERVICE MANUAL USUALLY INCLUDE INSTALLATION INSTRUCTIONS, ELECTRICAL SCHEMATICS, PARTS LISTS, TROUBLESHOOTING GUIDES, AND MAINTENANCE SCHEDULES.

### HOW OFTEN SHOULD I REFER TO THE TRUE T 72 SERVICE MANUAL FOR MAINTENANCE?

IT'S RECOMMENDED TO REFER TO THE TRUE T 72 SERVICE MANUAL AT LEAST ONCE A MONTH FOR ROUTINE MAINTENANCE CHECKS AND TO FOLLOW THE SPECIFIC MAINTENANCE SCHEDULE OUTLINED IN THE MANUAL.

### CAN THE TRUE T 72 SERVICE MANUAL HELP WITH TROUBLESHOOTING COMMON ISSUES?

YES, THE TRUE T 72 SERVICE MANUAL CONTAINS A TROUBLESHOOTING SECTION THAT OUTLINES COMMON ISSUES, THEIR SYMPTOMS, AND STEP-BY-STEP SOLUTIONS TO HELP TECHNICIANS DIAGNOSE AND FIX PROBLEMS.

### IS THE TRUE T 72 SERVICE MANUAL SUITABLE FOR BEGINNERS?

WHILE THE TRUE T 72 SERVICE MANUAL IS TECHNICAL IN NATURE, IT IS DESIGNED TO BE USER-FRIENDLY, MAKING IT SUITABLE FOR BOTH EXPERIENCED TECHNICIANS AND BEGINNERS WITH SOME MECHANICAL KNOWLEDGE.



science direct PDF ...  
science direct PDF?

Mar 20, 2024 · 7 4 ...

[minecraft1.20.1 - minecraft](#)  
Nov 20, 2024 · minecraft1.20.1minecraft1.20.1minecraft"/gamerule keepInventory true"minecraft  
minecraft ...

ture[true]\_[]  
ture[true] true[1]adj. []2adv. []3n.

**FALSE** · **TRUE** · **True** · **True**

Oct 21, 2023 · True · 1 · 5 · ...

**true false** □□□□□□ - □□□□  
 true□□□□ 1□right □□□□I got about half the answers right. □□□□□□□□□□ 2□correct □□□□□□□□□□  
 □□□□Only one of the answers is correct. □□□□ ...

true - 眞  
 Mar 31, 2013 · true 眞 truer 眞 truer 眞 trued 眞 trued 眞 truing 眞 true  
 眞 [tru:] 眞 [tru] 1adj. 眞 2adv. 眞 ...

[java 编译选项 -m 选项](#)  
 Mar 5, 2024 · [Java 编译选项 -m 选项](#) ["/gamerule keepInventory true"](#) [Java 编译选项 -m 选项](#)  
[编译选项 -m 选项](#) ...

1.12

Mar 31, 2020 · gamerule keepInventory true 1 2T

Excel IF 函数-01

TRUE 1 TRUE 2 0 B

science direct PDF ...  
science direct PDF?

Mar 20, 2024 · 7 4 ...

Nov 20, 2024 · 1.20.1 to 1.20.1  
...

Unlock the secrets to your True T 72 with our comprehensive service manual. Discover how to

maintain and troubleshoot your unit effectively. Learn more!

[Back to Home](#)