

# Suzuki King Quad 300 Parts Diagram

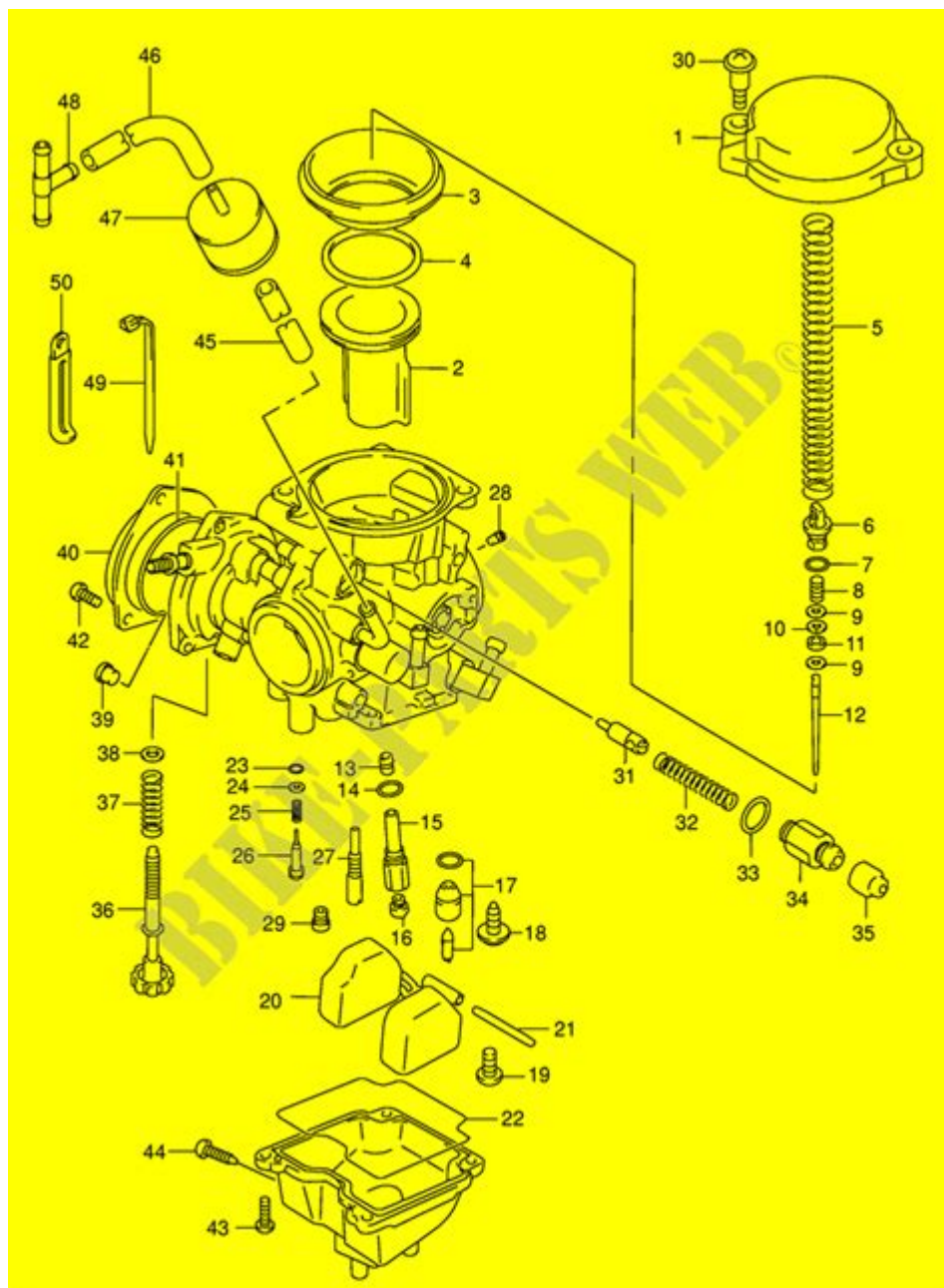

**Suzuki King Quad 300 Parts Diagram** is an essential tool for both enthusiasts and mechanics who work on these robust all-terrain vehicles (ATVs). Understanding the parts and components of the King Quad 300 can enhance your maintenance, repair, and modification capabilities. This article delves into the significance of the parts diagram, a breakdown of various components, common issues, and maintenance tips, ensuring that you have all the necessary information to keep your Suzuki King Quad 300 running smoothly.

## Overview of the Suzuki King Quad 300

The Suzuki King Quad 300 is a versatile ATV that has gained popularity for its reliable performance, durability, and advanced engineering. Introduced in the late 1990s and produced until the early 2000s, this model features a robust build designed for both recreational and utility purposes. Its powerful engine, four-wheel drive capabilities, and user-friendly design make it an ideal choice for outdoor enthusiasts and those who require a reliable workhorse.

## Importance of Parts Diagrams

Parts diagrams play a critical role in the understanding and servicing of the Suzuki King Quad 300. Here are some reasons why they are crucial:

### 1. Clear Visualization

- Parts diagrams provide a detailed visual representation of the ATV's components.
- They help users identify specific parts and their locations on the vehicle.

### 2. Accurate Identification

- Many components may look similar; diagrams help ensure the right parts are ordered and replaced.
- They assist in distinguishing between OEM (Original Equipment Manufacturer) parts and aftermarket alternatives.

### 3. Facilitating Repairs

- When performing repairs or maintenance, diagrams make it easier to understand the assembly and disassembly process.
- They can highlight parts that may need special tools for removal or installation.

### 4. Enhancing Communication

- Mechanics and enthusiasts can communicate more effectively about repairs using part numbers and diagrams.
- They provide a common language for discussing specific components.

## Key Components of the King Quad 300

The Suzuki King Quad 300 consists of several key components. Understanding these parts is crucial for

anyone looking to maintain or repair the vehicle. Here's a breakdown of the main components:

## 1. Engine

- Engine Type: Liquid-cooled, 4-stroke, single-cylinder engine.
- Displacement: Approximately 300cc.
- Fuel System: Carbureted with a Mikuni BS34SS.

## 2. Transmission

- Type: Automatic transmission with selectable 2WD and 4WD.
- Drive System: Chain drive system that delivers power to the rear wheels.

## 3. Chassis and Suspension

- Frame: Sturdy steel frame designed for durability.
- Suspension: Independent front suspension with double wishbones; rear swingarm suspension.
- Brakes: Front disc brakes and rear drum brakes for reliable stopping power.

## 4. Wheels and Tires

- Tires: Typically equipped with all-terrain tires designed for various surfaces.
- Wheel Size: Usually 12 inches in diameter.

## 5. Electrical System

- Battery: 12V system powering the lights, ignition, and other electrical components.
- Starter: Electric start for convenience.

## 6. Bodywork and Accessories

- Fenders: Protects the rider from mud and debris.
- Cargo Rack: Often included for carrying gear or supplies.

## Common Issues and Troubleshooting

Despite its reliability, the Suzuki King Quad 300 may encounter common issues over time. Familiarity

with these potential problems can help in efficient troubleshooting:

## **1. Starting Issues**

- Symptoms: Engine cranks but does not start.
- Possible Causes:
  - Dead battery: Check the voltage and connections.
  - Fuel issues: Ensure there is fuel in the tank and that the fuel filter is clean.

## **2. Overheating**

- Symptoms: Engine temperature rises excessively during operation.
- Possible Causes:
  - Low coolant levels: Check and top off coolant.
  - Clogged radiator: Clean any debris blocking airflow.

## **3. Transmission Problems**

- Symptoms: Slipping or difficulty engaging gears.
- Possible Causes:
  - Low transmission fluid: Check the fluid level and quality.
  - Worn components: Inspect the belt and clutches for wear.

## **4. Brake Issues**

- Symptoms: Poor braking performance or noise.
- Possible Causes:
  - Worn brake pads or shoes: Inspect and replace if necessary.
  - Air in the brake lines: Bleed the brakes to remove air.

## **Maintenance Tips for the King Quad 300**

Regular maintenance is vital for keeping your Suzuki King Quad 300 in peak condition. Here are some essential tips:

## **1. Regular Oil Changes**

- Change the oil every 1,000 miles or annually, whichever comes first.
- Use the recommended oil type and filter.

## **2. Check the Air Filter**

- Inspect the air filter regularly and clean or replace it as needed.
- A clean air filter ensures optimal engine performance.

## **3. Inspect Tires and Wheels**

- Check tire pressure regularly and inspect for wear and tear.
- Rotate tires if necessary to ensure even wear.

## **4. Maintain the Battery**

- Keep the battery terminals clean and free from corrosion.
- Ensure the battery is charged, especially before long rides.

## **5. Lubrication of Moving Parts**

- Regularly lubricate the chain and other moving components.
- Follow the manufacturer's recommendations for lubrication intervals.

## **Where to Find Parts Diagrams and Components**

Finding parts diagrams and components for the Suzuki King Quad 300 can be done through various resources:

### **1. OEM Parts Distributors**

- Websites like Suzuki's official parts website or authorized dealers often provide diagrams and parts lists.

### **2. Repair Manuals**

- Service manuals for the King Quad 300 are available for purchase online or at motorcycle shops and can provide in-depth diagrams and repair instructions.

### **3. Online Forums and Communities**

- ATV enthusiast forums and online communities are excellent resources for troubleshooting advice, parts diagrams, and recommendations on where to purchase parts.

### **4. Local Mechanics**

- Experienced mechanics who specialize in ATVs may have access to parts diagrams and can often assist with repairs.

## **Conclusion**

In summary, understanding the Suzuki King Quad 300 parts diagram is essential for maintaining, repairing, and enhancing your ATV. By familiarizing yourself with the key components, potential issues, and proper maintenance practices, you can ensure that your King Quad 300 remains in optimal condition for years to come. Whether you are a seasoned mechanic or an ATV enthusiast, having access to parts diagrams will enhance your overall experience with this remarkable vehicle. With the right knowledge and resources, you can enjoy the rugged capabilities of the King Quad 300 to the fullest.

## **Frequently Asked Questions**

### **What is the purpose of the Suzuki King Quad 300 parts diagram?**

The parts diagram serves as a visual reference to identify and locate specific components of the Suzuki King Quad 300, aiding in maintenance and repairs.

### **Where can I find a Suzuki King Quad 300 parts diagram?**

You can find the parts diagram in the owner's manual, on Suzuki's official website, or through various ATV parts retailers online.

### **Are there different parts diagrams for different model years of the Suzuki King Quad 300?**

Yes, there are variations in parts diagrams for different model years, so it's important to use the diagram that corresponds to your specific year and model.

## **How can I use the parts diagram to order replacement parts for my Suzuki King Quad 300?**

You can use the parts diagram to identify the exact part number needed, which can then be used to order replacements from authorized dealers or online retailers.

## **What should I do if I can't find the parts diagram for my Suzuki King Quad 300?**

If you can't find the parts diagram, consider reaching out to a Suzuki dealer or searching for ATV forums where enthusiasts may share diagrams or offer assistance.

## **Is the parts diagram for the Suzuki King Quad 300 available in digital format?**

Yes, many online resources provide digital versions of the parts diagram, making it easier to view and print as needed.

## **Can I use a parts diagram to troubleshoot issues with my Suzuki King Quad 300?**

Yes, a parts diagram can help you understand the layout and function of individual components, which can be useful for troubleshooting mechanical issues.

## **Are there aftermarket alternatives available if I can't find OEM parts for the Suzuki King Quad 300?**

Yes, many aftermarket manufacturers produce compatible parts for the Suzuki King Quad 300, but ensure they meet quality standards before purchasing.

## **What tools do I need to work on parts identified in the Suzuki King Quad 300 parts diagram?**

Basic tools such as wrenches, screwdrivers, pliers, and possibly specialized tools for specific components, as indicated in the service manual, will be necessary.

Find other PDF article:

<https://soc.up.edu.ph/21-brief/pdf?ID=WaM92-9818&title=falling-for-apunzel.pdf>

# [Suzuki King Quad 300 Parts Diagram](#)

## *Ignis Maps - Suzuki Forums*

Mar 9, 2023 · Hi Folks, I have an 2017 Ignis SZ5. Obviously my maps are out of date. Even to download the new ones from the internet and transfer to the SD card from my PC to my car ...

## **Automatic lights | Suzuki Forums**

Nov 8, 2024 · Edwina gma said: Is there a Suzuki customer service GENERAL ENQUIRIES For general enquiries, please call our Customer Service team on 08085 011959 option 2 or ...

## **Suzuki Vitara GPS/NAVIGATION install - Suzuki Forums**

Jan 20, 2021 · Hello, I have on my Suzuki Vitara 2018 1.6/ Firmware version 1850.2\_170730 / I have some question: Where and how are the instructions to install an updated MAP for ...

## **Canada - Suzuki Forums**

Mar 5, 2007 · New Hampshire, USA Suzuki Automotive Meet: Aug 19, 2018 LockDoc3 Mar 18, 2018 2 2.3K

## **Vitara USB | Suzuki Forums**

Oct 6, 2024 · Hi I've got a 2024 vitara full hybrid which I love but I've got a problem with it that even the Suzuki garage can't figure out. when I put a usb stick into the slot it connects and ...

## **Cvt transmission - Suzuki Forums**

Aug 28, 2011 · Software update: Campai gn Notice Suzuki has received reports of the Check Engine Lamp turning ON (DTC P0721 and/or P0777) and loss of acceleration or higher than ...

## *Samurai stalling - Suzuki Forums*

Dec 26, 2008 · I have a 1988 Samurai. I took it off roading today and while driving home it started to stall when I was driving. It will run until I punt it in gear and let out on the clutch. In order to ...

## coolant? - Suzuki Forums

Sep 2, 2009 · Suzuki Super-Blue coolant is not yet available, we have been advised to use Subaru Super-Blue coolant, it is made by the same manufacturer Suzuki sources in Japan and ...

## *Suzuki Scross - USB issue | Suzuki Forums*

Nov 26, 2024 · Suzuki Scross - USB issue Jump to Latest 370 views 1 reply 2 participants last post by fordem Nov 26, 2024 K

## *p1431 | Suzuki Forums*

Jun 26, 2024 · hello, i got a p1431 fuel level sensor 2 circuit performance? is this right, and what is it? on my 2006 suzuki Grand Vitara, i have tried to swap my temeratur sensor with no luck, ...

## *Ignis Maps - Suzuki Forums*

Mar 9, 2023 · Hi Folks, I have an 2017 Ignis SZ5. Obviously my maps are out of date. Even to download the new ones from the internet and transfer to the SD card from my PC to my car ...

## Automatic lights | Suzuki Forums

Nov 8, 2024 · Edwina gma said: Is there a Suzuki customer service GENERAL ENQUIRIES For general enquiries, please call our Customer Service team on 08085 011959 option 2 or ...

### Suzuki Vitara GPS/NAVIGATION install - Suzuki Forums

Jan 20, 2021 · Hello, I have on my Suzuki Vitara 2018 1.6/ Firmware version 1850.2\_170730 / I have some question: Where and how are the instructions to install an updated MAP for ...

### **Canada - Suzuki Forums**

Mar 5, 2007 · New Hampshire, USA Suzuki Automotive Meet: Aug 19, 2018 LockDoc3 Mar 18, 2018 2 2.3K

### **Vitara USB | Suzuki Forums**

Oct 6, 2024 · Hi I've got a 2024 vitara full hybrid which I love but I've got a problem with it that even the Suzuki garage can't figure out. when I put a usb stick into the slot it connects and ...

### **Cvt transmission - Suzuki Forums**

Aug 28, 2011 · Software update: Campai gn Notice Suzuki has received reports of the Check Engine Lamp turning ON (DTC P0721 and/or P0777) and loss of acceleration or higher than ...

### **Samurai stalling - Suzuki Forums**

Dec 26, 2008 · I have a 1988 Samurai. I took it off roading today and while driving home it started to stall when I was driving. It will run until I punt it in gear and let out on the clutch. In order to ...

### coolant? - Suzuki Forums

Sep 2, 2009 · Suzuki Super-Blue coolant is not yet available, we have been advised to use Subaru Super-Blue coolant, it is made by the same manufacturer Suzuki sources in Japan and ...

### *Suzuki Scross - USB issue | Suzuki Forums*

Nov 26, 2024 · Suzuki Scross - USB issue Jump to Latest 370 views 1 reply 2 participants last post by fordem Nov 26, 2024 K

### **p1431 | Suzuki Forums**

Jun 26, 2024 · hello, i got a p1431 fuel level sensor 2 circuit performance? is this right, and what is it? on my 2006 suzuki Grand Vitara, i have tried to swap my temeratur sensor with no luck, ...

Discover the Suzuki King Quad 300 parts diagram to easily identify and source essential components. Learn more about maintaining your ATV today!

[Back to Home](#)