

# Sub Zero 550 Manual

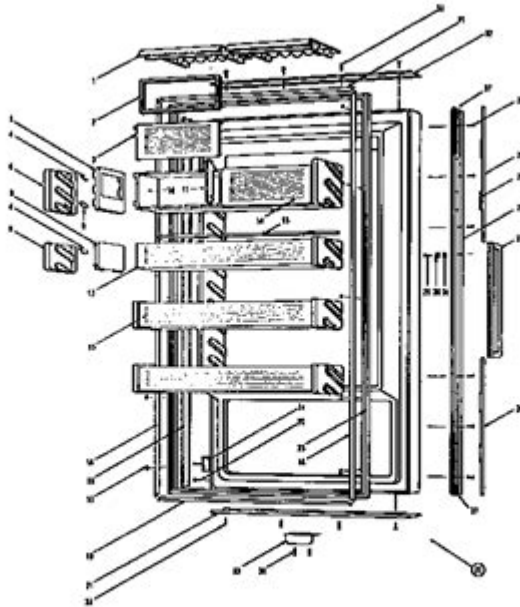

**Sub Zero 550 Manual** is an essential resource for owners of the Sub Zero 550 refrigerator, a premium appliance known for its exceptional performance and durability. This manual is not just a collection of instructions; it serves as a comprehensive guide to help users understand the features, maintenance, troubleshooting, and care of their appliance. In this article, we will explore the key sections of the Sub Zero 550 manual, its importance for users, and practical tips for maximizing the lifespan and efficiency of your refrigerator.

## Overview of the Sub Zero 550 Refrigerator

The Sub Zero 550 refrigerator is part of the renowned Sub Zero line of luxury kitchen appliances. Known for its innovative technology and sophisticated design, the 550 model features dual refrigeration systems, ensuring that both the refrigerator and freezer maintain optimal temperatures. This design not only preserves food quality but also enhances energy efficiency.

### Key Features

- **Dual Refrigeration:** Separate systems for refrigerator and freezer compartments.

- Advanced Filtration: Air purification to reduce odors and bacteria.
- Customizable Shelving: Adjustable shelves to accommodate various food items.
- Energy Efficiency: Designed to minimize energy consumption without sacrificing performance.

## Importance of the Sub Zero 550 Manual

The Sub Zero 550 manual is crucial for several reasons:

1. Installation Guidance: The manual provides detailed instructions for proper installation, ensuring that your appliance operates efficiently from the start.
2. Operating Instructions: Users can learn how to utilize all the features of the refrigerator, from temperature settings to special functions.
3. Maintenance Tips: Regular maintenance is vital for extending the life of your appliance. The manual outlines essential cleaning procedures and maintenance schedules.
4. Troubleshooting: If issues arise, the troubleshooting section can help diagnose and resolve common problems.
5. Warranty Information: The manual includes warranty details, which are essential for understanding coverage and service options.

## Installation Instructions

Proper installation is critical for the optimal performance of your Sub Zero 550 refrigerator. Here are the basic steps outlined in the manual:

### Required Tools and Materials

- Screwdriver
- Level
- Measuring tape
- Water supply line (for models with ice maker)

### Installation Steps

1. Choose Location: Ensure that the refrigerator is placed in a well-ventilated area with adequate clearance for air circulation.
2. Prepare the Space: Remove any obstacles that may hinder the appliance's installation.
3. Level the Refrigerator: Use a level to ensure that the refrigerator is perfectly horizontal. Adjust the feet as necessary.
4. Connect Water Supply: If your model includes an ice maker, connect it to the water supply following the guidelines provided in the manual.
5. Power Connection: Plug the refrigerator into a grounded outlet.

6. Set Temperature Controls: Adjust the temperature settings according to the guidelines before loading food.

## Operating Your Sub Zero 550 Refrigerator

Understanding how to operate your Sub Zero 550 effectively will enhance your experience and ensure that your food stays fresh.

### Temperature Settings

The manual recommends the following temperature settings:

- Refrigerator: 34°F to 38°F (1°C to 3°C)
- Freezer: 0°F (-18°C)

### Utilizing Features

- Shelving Adjustments: The manual provides instructions for adjusting shelves and bins to maximize storage space.
- Temperature Control: Users can adjust temperature settings easily via the control panel.
- Air Purification: The refrigerator features an air purification system that can be activated or deactivated as needed.

## Maintenance and Cleaning

Regular maintenance is key to ensuring your Sub Zero 550 operates efficiently. The manual provides a detailed maintenance schedule that includes:

### Daily Maintenance

- Check Temperature Settings: Ensure that the temperatures are within the recommended ranges.
- Inspect Seals: Regularly check the door seals for wear and tear. Clean them with warm, soapy water to maintain their integrity.

### Weekly Maintenance

- Clean Interior: Wipe down the interior shelves and walls with a mild detergent.
- Check Filters: Inspect and replace air filters as necessary to maintain air quality.

### Monthly Maintenance

- **Condenser Coils:** Clean the condenser coils to ensure optimal energy efficiency. Dust and debris can hinder performance.
- **Ice Maker Maintenance:** If equipped, ensure that the ice maker is clean and functioning properly.

## Troubleshooting Common Issues

Even the most reliable appliances may encounter issues. The Sub Zero 550 manual includes a troubleshooting section that addresses common problems:

### Common Problems and Solutions

#### 1. Refrigerator Not Cooling:

- Check if the power cord is plugged in.
- Ensure that the temperature settings are correctly adjusted.
- Inspect the condenser coils for dust buildup.

#### 2. Unusual Noises:

- Noises may be normal; however, check if items are vibrating against the interior walls.
- Inspect the compressor and fans for any obstructions.

#### 3. Water Leaks:

- Ensure that the water supply line is securely connected.
- Check the drain pan for cracks or damage.

## Warranty and Service Information

The Sub Zero 550 manual provides comprehensive warranty information, detailing coverage periods and what is included. Typically, Sub Zero offers a limited warranty that covers parts and labor for a specific duration, ensuring that your investment is protected.

### Service Options

If you encounter issues that cannot be resolved through troubleshooting, the manual advises contacting a qualified service technician. Sub Zero also provides customer support for any questions regarding your appliance.

## Conclusion

The **Sub Zero 550 manual** is an invaluable resource for any owner of this high-quality refrigerator. By understanding the features, following proper installation and maintenance procedures, and utilizing the troubleshooting

guidelines, users can ensure their appliance operates efficiently and lasts for years. Whether you are a new owner or a seasoned user, referring to the manual will enhance your experience and help you get the most out of your Sub Zero 550 refrigerator.

## **Frequently Asked Questions**

### **What is the purpose of the Sub Zero 550 manual?**

The Sub Zero 550 manual provides essential information on the operation, maintenance, and troubleshooting of the Sub Zero 550 refrigerator model, ensuring optimal performance.

### **Where can I find a digital copy of the Sub Zero 550 manual?**

A digital copy of the Sub Zero 550 manual can typically be found on the official Sub Zero website under the support or customer service section, or through authorized appliance retailers.

### **What are some common troubleshooting tips included in the Sub Zero 550 manual?**

Common troubleshooting tips in the Sub Zero 550 manual include checking door seals for leaks, ensuring proper temperature settings, and cleaning the condenser coils to enhance efficiency.

### **Does the Sub Zero 550 manual include maintenance schedules?**

Yes, the Sub Zero 550 manual includes recommended maintenance schedules, detailing routine tasks such as cleaning, filter replacement, and inspection of components to ensure longevity.

### **How do I reset the Sub Zero 550 refrigerator according to the manual?**

To reset the Sub Zero 550 refrigerator, refer to the manual for specific instructions, which generally involve unplugging the unit for a few minutes and then plugging it back in.

### **Are there safety precautions mentioned in the Sub Zero 550 manual?**

Yes, the Sub Zero 550 manual outlines important safety precautions, including proper installation guidelines, electrical safety tips, and recommendations for avoiding food spoilage.

<https://soc.up.edu.ph/21-brief/pdf?trackid=TmB86-6224&title=fact-and-opinion-worksheets-middle-school.pdf>

### SUB Definition & Meaning - Merriam-Webster

**000.sub00000000\_0000**

sub (n,n,17) -

sub□□□□□□□□□□□□ □□□□

**sub** -

**sub**□□□□□□□□ - □□□□

**excel vba** **sub** **process** **data**

CLIP GENERAL SUB THMBNL ...

recap sub lift sub clean

**D-Sub** ☐ **VGA** ☐ - ☐

D-Sub 1 D-Sub D-Subminiature 2 D-Sub ...

### SUB Definition & Meaning - Merriam-Webster

The meaning of SUB is substitute. How to use sub in a sentence.

[illegible]

$\mathrm{sub}_{\left(n, n, 17\right)}$

“ ”

sub 1 subway, submarine, subsoil, subconscious  
2 subeditor, subcontinent, subsonic, subtitle, subplot

May 26, 2024 · sub1. "sub" "substitute"2. "m" SMm

1sub-sub,“under,from under”“”“”sub-sub12sub-sub16sub-sub

Dec 29, 2024 · Excel VBA Visual Basic for Applications

```
sub SayHello()  
    ' ...  
end sub
```

THMBNL ██████████ ██████████ ██████████ ██████████ ██████████  
████████████████████ PRIVATE\M4ROOT \THMBNL GENERAL████████ CLIP ██████████ SUB ██ ...

recap sub lift sub clean recap fixture recap = fixture note  
sub subject to details

D-Sub 1 D-Sub D-Subminiature 2 D-Sub  
Central Processing Unit/CPU 3  
...

[Back to Home](#)