

Sta Rite Mse 7 Manual

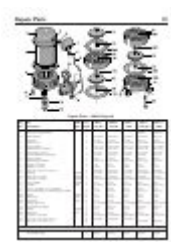

Sta Rite MSE 7 Manual

The Sta Rite MSE 7 is a high-performance multi-stage centrifugal pump designed for various water systems, including residential, commercial, and agricultural applications. This pump is known for its efficiency, durability, and ease of maintenance. To ensure optimal performance and longevity of the Sta Rite MSE 7 pump, it is essential to understand its components, specifications, installation guidelines, troubleshooting techniques, and maintenance requirements. This article serves as a comprehensive manual for the Sta Rite MSE 7, offering detailed insights into each aspect of this remarkable equipment.

Overview of the Sta Rite MSE 7 Pump

The Sta Rite MSE 7 pump is a robust and efficient solution for transferring water in various scenarios. It features a multi-stage design, which allows it to generate high pressure while maintaining a compact size. This pump is suitable for a wide range of applications, from irrigation systems to water supply for homes and commercial properties.

Key Features

- Multi-stage Design: The pump has multiple impellers, allowing it to achieve high-pressure outputs suitable for various applications.
- Durable Construction: Made from high-quality materials, the Sta Rite MSE 7 is designed to withstand harsh conditions and resist corrosion.
- Energy Efficiency: The pump is engineered to operate efficiently, saving energy and reducing operational costs.
- Quiet Operation: The design of the pump minimizes noise during operation, making it suitable for residential environments.

Specifications

Understanding the specifications of the Sta Rite MSE 7 is crucial for ensuring that it meets the requirements of your specific application. Here are the key specifications:

- Model: Sta Rite MSE 7
- Power Supply: 230V, 60Hz
- Flow Rate: Up to 45 gallons per minute (GPM)
- Maximum Head: 150 feet
- Motor Power: 1 HP
- Weight: Approximately 50 pounds
- Inlet/Outlet Size: 1-inch NPT

Installation Guidelines

Proper installation is vital for the efficient operation of the Sta Rite MSE 7 pump. Here are the steps to ensure correct installation:

Preparation

1. Select the Location: Choose a suitable location for the pump, preferably close to the water source and with adequate drainage.
2. Check Electrical Supply: Ensure that the electrical supply matches the required specifications (230V, 60Hz) and is capable of handling the pump's power needs.

Installation Steps

1. Mount the Pump: Secure the pump on a stable base using bolts or brackets to prevent vibration during operation.
2. Connect the Inlet Pipe: Attach the inlet pipe from the water source to the pump's inlet. Use Teflon tape on the threads for a watertight seal.
3. Connect the Outlet Pipe: Similarly, connect the outlet pipe to the pump's discharge port.
4. Electrical Connections: Follow local electrical codes to connect the power supply to the pump. Ensure all connections are secure and insulated.
5. Priming the Pump: Before starting the pump, it must be primed. Fill the pump casing with water to remove air, ensuring proper operation.

Testing the Installation

- Turn on the power supply and check for leaks in the piping.
- Observe the pump's operation for any unusual noises or vibrations.
- Measure the flow rate to ensure it meets the desired specifications.

Operating the Sta Rite MSE 7 Pump

Once installed, operating the Sta Rite MSE 7 pump is straightforward. Here are some key points to

consider during operation:

Starting the Pump

- Ensure that the power supply is connected and that the pump is primed.
- Turn on the power switch to activate the pump.
- Monitor the flow of water and the pressure gauge if available.

Normal Operating Conditions

- The Sta Rite MSE 7 is designed to run continuously for extended periods, but it's advisable to monitor its performance regularly.
- Maintain a consistent water supply to avoid dry running, which can damage the pump.

Troubleshooting Common Issues

Despite its reliability, users may encounter issues with the Sta Rite MSE 7 pump. Here are some common problems and their solutions:

Problem: Pump Won't Start

- Possible Causes:
 - Power supply issues.
 - Tripped circuit breaker.
 - Faulty motor.
- Solutions:
 - Check the power supply and ensure it is connected.
 - Reset the circuit breaker if tripped.
 - Consult a professional if the motor is suspected to be faulty.

Problem: Low Water Flow

- Possible Causes:
 - Clogged inlet filter.
 - Air leaks in the suction line.
 - Impeller wear or blockage.
- Solutions:
 - Inspect and clean the inlet filter.
 - Check all connections for air leaks and repair as necessary.

- Remove the pump casing to inspect and clean the impeller.

Problem: Excessive Noise

- Possible Causes:
 - Unbalanced impeller.
 - Loose mounting.
- Solutions:
 - Ensure that the impeller is properly balanced and securely attached.
 - Tighten any loose mounting bolts or brackets.

Maintenance Requirements

Regular maintenance is essential for the longevity and performance of the Sta Rite MSE 7 pump. Here are some maintenance practices to follow:

Routine Maintenance Tasks

1. Inspect Electrical Connections: Regularly check all electrical connections for signs of wear or damage.
2. Clean the Inlet Filter: Clean the inlet filter periodically to prevent clogging and ensure optimal flow.
3. Check for Leaks: Inspect all connections and hoses for leaks and repair them promptly.
4. Monitor Performance: Keep an eye on the flow rate and pressure to spot any abnormal changes early.

Seasonal Maintenance

- Winterization: If the pump is not in use during winter, drain all water from the pump and lines to prevent freezing.
- Lubrication: Check and lubricate any moving parts as recommended by the manufacturer.

Conclusion

The Sta Rite MSE 7 pump is an exceptional choice for a variety of water transfer and pressure boosting applications. By understanding its specifications, installation procedures, operational guidelines, and maintenance needs, users can ensure the pump operates efficiently and lasts for years. Following the troubleshooting tips can also help address common issues quickly and effectively, keeping your water system running smoothly. Always refer to the manufacturer's manual for specific details and recommendations regarding your Sta Rite MSE 7 pump.

Frequently Asked Questions

What is the purpose of the Sta-Rite MSE 7 manual?

The Sta-Rite MSE 7 manual provides detailed instructions on the installation, operation, maintenance, and troubleshooting of the Sta-Rite MSE 7 series pumps, ensuring optimal performance and longevity.

Where can I find the Sta-Rite MSE 7 manual?

The Sta-Rite MSE 7 manual can typically be found on the manufacturer's official website, or you can request a physical copy from authorized distributors or service centers.

What are the key features outlined in the Sta-Rite MSE 7 manual?

Key features outlined in the manual include specifications for flow rates, power requirements, installation dimensions, safety precautions, and maintenance schedules.

How do I troubleshoot common issues with the Sta-Rite MSE 7 pump as per the manual?

The manual provides a troubleshooting section that addresses common issues such as low pressure, abnormal noise, and motor failure, along with step-by-step solutions for each problem.

Is the Sta-Rite MSE 7 manual available in digital format?

Yes, the Sta-Rite MSE 7 manual is often available in PDF format for download on the manufacturer's website, making it easily accessible for users.

What safety precautions are mentioned in the Sta-Rite MSE 7 manual?

The manual emphasizes safety precautions such as ensuring proper electrical connections, grounding the pump, and following lockout/tagout procedures during maintenance.

How often should I perform maintenance on my Sta-Rite MSE 7 as per the manual?

The manual recommends performing regular maintenance checks at least once a year, with more frequent inspections if the pump is used heavily or in harsh conditions.

Find other PDF article:

<https://soc.up.edu.ph/56-quote/files?ID=WcF12-9284&title=strategies-for-teaching-math-to-special-needs-students.pdf>

Sta Rite Mse 7 Manual

STA[SQE] -

STA[supplier technology assistant] 1 2 3 4 ...

IC[STA] -

STA[IO]false path[multicycle path 1 STA] Design Under Analysis[DUA] ...

abaqus[sta] -

Abaqus abaqus[sta] odb[cpu]...[sta] 5

STA -

STA-PT[SI 1 SI]skew[path]timing report

STA[TTA] ...

TTA-S Ref. 4: TTA STA

AWD[AGL]STA ...

4. STA

StA - Abkürzung & Bedeutung im Recht - JuraForum.de

Mar 21, 2025 · StA - Juristische Abkürzungen erklärt von JuraForum.deDie juristische Abkürzung „StA“ findet für zwei Begriffe Verwendung: Staatsanwalt und Staatsanwaltschaft. Ein ...

Staatsanwaltschaft (StA) in Deutschland - Aufgaben und Funktion

Sep 23, 2024 · Die Staatsanwaltschaft zeichnet sich verantwortlich für die Strafverfolgung und die Strafvollstreckung in der Bundesrepublik Deutschland. Sie versteht sich als eine ...

Die strafrechtlichen Verfügungen - JuraForum.de

Die strafrechtlichen Verfügungen sind Entscheidungen oder Anordnungen im Strafrecht, die das Verfahren und die Strafverfolgung betreffen.

802.11[ap]sta?

“[ap]sta?”802.11[AP]STA[MAC] ...

STA[SQE] -

STA[supplier technology assistant] 1 2 3 4 ...

IC[STA] -

STA[IO]false path[multicycle path 1 STA] Design Under Analysis[DUA] ...

abaqus - sta -

00/00 0000 Abaqus abaqus sta odb cpu... sta 5

STA -

STA-PT SI 1 skew path timing report

STA ...

TTA-S Ref. 4: TTA STA ...

AWD AGL STA ...

4. STA ...

StA - Abkürzung & Bedeutung im Recht - JuraForum.de

Mar 21, 2025 · StA - Juristische Abkürzungen erklärt von JuraForum.de Die juristische Abkürzung „StA“ findet für zwei Begriffe Verwendung: Staatsanwalt und Staatsanwaltschaft. Ein ...

Staatsanwaltschaft (StA) in Deutschland – Aufgaben und Funktion

Sep 23, 2024 · Die Staatsanwaltschaft zeichnet sich verantwortlich für die Strafverfolgung und die Strafvollstreckung in der Bundesrepublik Deutschland. Sie versteht sich als eine ...

Die strafrechtlichen Verfügungen - JuraForum.de

Die strafrechtlichen Verfügungen sind Entscheidungen oder Anordnungen im Strafrecht, die das Verfahren und die Strafverfolgung betreffen.

802.11ap sta? -

“ap sta?” 802.11 AP STA MAC ...

Find the complete Sta Rite MSE 7 manual here! Get essential tips and insights for optimal performance. Learn more to maximize your equipment's efficiency today!

[Back to Home](#)