

Smith And Wesson Mp 15 Parts Diagram

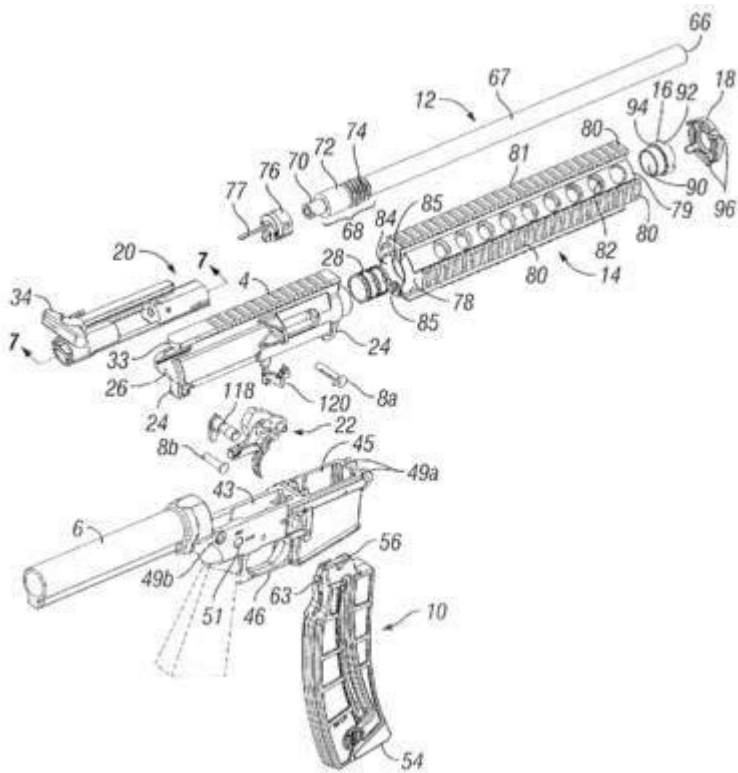

Smith and Wesson MP 15 parts diagram offers a comprehensive visual representation of the components that make up this popular rifle. The Smith and Wesson MP 15 is a versatile firearm designed for both sport shooting and personal defense. Understanding the various parts of the MP 15 not only aids in proper maintenance and repair but also enhances the user's knowledge of the rifle's functionality. In this article, we will delve into the essential components of the MP 15 rifle, the importance of each part, and how they work together to ensure the firearm operates effectively and safely.

Overview of the Smith and Wesson MP 15

The Smith and Wesson MP 15 is part of the M&P (Military and Police) series, known for its reliability and user-friendly design. The rifle is built on an AR-15 platform, which allows for customization and adaptability to various shooting styles and preferences. Its lightweight design, coupled with a robust construction, makes it a popular choice among both novice and experienced shooters.

Key Features of the MP 15

- **Caliber:** The MP 15 typically comes in .223 Remington and 5.56 NATO calibers, allowing for a wide range of ammunition usage.
- **Barrel Length:** Standard barrel lengths range from 16 to 20 inches, providing options for

different shooting applications.

- Adjustable Stock: Many MP 15 models come with a collapsible stock for enhanced portability and comfort.

- Accessory Rails: The rifle features Picatinny rails for mounting optics, lights, and other accessories.

Understanding the Parts Diagram

A parts diagram is an essential resource for any owner of the Smith and Wesson MP 15. It provides a detailed illustration of each component, making it easier to identify and understand how they fit together. Here's a breakdown of the key sections typically included in a parts diagram:

Upper Receiver Assembly

The upper receiver houses several critical components of the MP 15:

1. Barrel: The barrel is responsible for directing the bullet and is a key factor in the rifle's accuracy.
2. Gas System: The gas block and gas tube collect gas from the fired cartridge to cycle the action.
3. Bolt Carrier Group: This includes the bolt, carrier, and firing pin, which are essential for chambering and firing a round.
4. Ejection Port: This allows spent casings to exit the rifle after firing.

Lower Receiver Assembly

The lower receiver is the firearm's serialized part and includes several important components:

1. Trigger Group: Comprising the trigger, hammer, and associated springs, the trigger group controls the firing mechanism.
2. Pistol Grip: This part allows the shooter to hold and control the rifle comfortably.
3. Stock Assembly: The stock provides stability and support when aiming and shooting.
4. Magazine Release: This mechanism allows for the quick release of the magazine for reloading.

Importance of Each Component

Understanding the role of each component in the Smith and Wesson MP 15 is vital for both maintenance and operation. Here's a closer look at some of the key parts and their functions:

Barrel

The barrel's quality significantly influences the rifle's accuracy and performance. A well-made barrel can improve bullet stability and reduce fluctuations in velocity, leading to tighter groupings on target.

Gas Block and System

The gas system is crucial for semi-automatic operation. When a round is fired, gas is redirected through the gas block into the gas tube, cycling the bolt carrier group. A malfunction in this system can lead to failures to eject or feed.

Bolt Carrier Group

The bolt carrier group (BCG) is often referred to as the heart of the rifle. It is responsible for chambering, firing, and ejecting rounds. Regular cleaning and lubrication of the BCG are essential to ensure reliable performance.

Trigger Group

The trigger group's design affects the rifle's shooting experience. A smooth, crisp trigger pull can enhance accuracy, making it easier to hit targets consistently.

Maintenance and Repair

Proper maintenance is crucial for ensuring the longevity and reliability of the Smith and Wesson MP 15. Familiarity with the parts diagram can significantly ease the process of cleaning, inspecting, and replacing components.

Routine Maintenance Steps

1. **Cleaning:** Regularly clean the barrel, bolt carrier group, and chamber to prevent fouling and buildup.
2. **Lubrication:** Use appropriate gun oils to lubricate moving parts, especially in the bolt carrier group and trigger assembly.
3. **Inspection:** Routinely check for wear and tear on key components like the gas system and trigger group.
4. **Replacement:** Replace worn parts as necessary, following the parts diagram to ensure correct installation.

Common Repairs

- Replacing the Firing Pin: If the rifle experiences misfires, it may be necessary to replace the firing pin.
- Adjusting the Gas Block: If the rifle fails to cycle, adjusting the gas block can ensure proper gas flow.
- Trigger Adjustment: Some users may prefer a lighter or heavier trigger pull, requiring adjustments or component replacements.

Conclusion

The Smith and Wesson MP 15 parts diagram is an invaluable tool for any owner of this versatile rifle. By understanding the various components and their functions, users can maintain their firearm effectively and ensure reliable performance. Regular maintenance, coupled with a clear understanding of the parts, can enhance the shooting experience and prolong the life of the rifle. Whether for sport shooting or home defense, being knowledgeable about the MP 15 and its parts is key to becoming a proficient and responsible gun owner.

In summary, the Smith and Wesson MP 15 is more than just a firearm; it is a system of intricately designed parts that work together to deliver performance and reliability. Familiarity with its parts diagram empowers users to take control of their maintenance and enhances their overall shooting experience.

Frequently Asked Questions

What is the purpose of the Smith and Wesson MP 15 parts diagram?

The Smith and Wesson MP 15 parts diagram provides a visual representation of the rifle's components, helping users identify, assemble, and disassemble the firearm correctly.

Where can I find a reliable Smith and Wesson MP 15 parts diagram?

Reliable Smith and Wesson MP 15 parts diagrams can be found on the official Smith and Wesson website, in the owner's manual, or through reputable firearm parts retailers.

Are there any differences between the MP 15 parts diagram and other AR-15 platforms?

Yes, while the MP 15 shares similarities with other AR-15 platforms, the parts diagram may include specific components unique to the MP 15 model, such as proprietary parts.

Can I use the MP 15 parts diagram for troubleshooting issues?

Yes, the MP 15 parts diagram can be useful for troubleshooting by allowing you to identify specific parts that may be malfunctioning or require replacement.

Is the MP 15 parts diagram useful for upgrading parts?

Absolutely! The MP 15 parts diagram helps users understand where aftermarket upgrades can be installed and what parts are compatible with the rifle.

What are common parts to replace on the Smith and Wesson MP 15?

Common parts that may need replacement on the Smith and Wesson MP 15 include the trigger assembly, buffer tube, handguard, and barrel, depending on wear and upgrades.

How do I interpret the MP 15 parts diagram effectively?

To interpret the MP 15 parts diagram effectively, familiarize yourself with the labeling of parts, reference the corresponding numbers or names, and follow along with a disassembly or assembly guide.

Find other PDF article:

<https://soc.up.edu.ph/42-scope/files?docid=iJO91-8198&title=museum-hole-in-one-guide.pdf>

Smith And Wesson Mp 15 Parts Diagram

Smith And Wesson MP 15 Parts Diagram - PDF

Smith And Wesson MP 15 Parts Diagram B...

EndNote Smith And Wesson MP 15 Parts Diagram - PDF

EndNote Smith And Wesson MP 15 Parts Diagram

Smith et al. Smith And Wesson MP 15 Parts Diagram - PDF

Smith et al. argue that... et al. Smith et al. Smith And Wesson MP 15 Parts Diagram alia Smith et al. ...

origin Smith And Wesson MP 15 Parts Diagram hfss - PDF

Oct 20, 2024 · 1 Smith And Wesson MP 15 Parts Diagram origin Smith And Wesson MP 15 Parts Diagram origin Smith And Wesson MP 15 Parts Diagram ...

Smith And Wesson MP 15 Parts Diagram Smith And Wesson MP 15 Parts Diagram ...

Smith And Wesson MP 15 Parts Diagram Smith And Wesson MP 15 Parts Diagram Smith And Wesson MP 15 Parts Diagram ...

Smith And Wesson MP 15 Parts Diagram - PDF

Smith And Wesson MP 15 Parts Diagram B...

[illegible]

[Back to Home](#)