

Snow Joe Parts Diagram

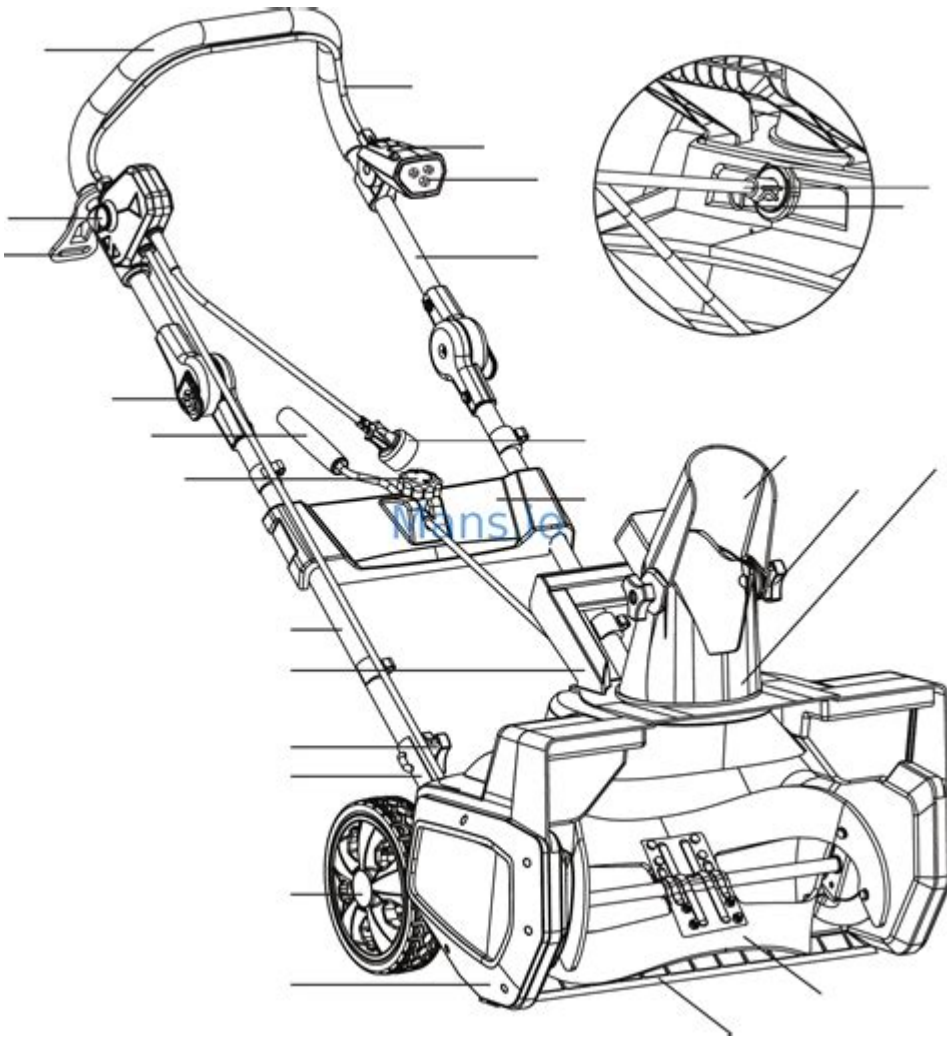

Snow Joe parts diagram is an essential tool for anyone who owns a Snow Joe snow blower, electric shovel, or any other Snow Joe equipment. Understanding the parts of your machine can help you troubleshoot issues, perform maintenance, and ensure that your equipment runs efficiently throughout the winter months. In this article, we will delve into the details of the Snow Joe parts diagram, discuss the various components of Snow Joe products, and highlight the importance of having access to this information.

Understanding the Snow Joe Parts Diagram

A Snow Joe parts diagram is a visual representation that outlines the various components of a Snow Joe machine. It typically includes labeled illustrations of parts, their names, and part numbers. This diagram serves as a useful reference for users looking to identify specific parts for repair, replacement, or maintenance.

Importance of the Parts Diagram

1. Easy Identification: The parts diagram allows users to quickly locate and identify the components they may need to work on.
2. Maintenance and Repairs: Knowing the layout of your equipment can simplify the maintenance process and make repairs more efficient.
3. Ordering Replacement Parts: With part numbers available on the diagram, ordering replacements becomes straightforward, ensuring you get the right parts the first time.
4. Enhanced Understanding: The diagram helps users understand how various parts interact, promoting better care and operation of the equipment.

Common Components of Snow Joe Equipment

Snow Joe offers a variety of equipment designed for snow removal and other outdoor tasks. Here are some common components you may find in a Snow Joe snow blower or electric shovel:

1. Snow Blower Components

- Auger: The rotating blade that gathers snow and moves it into the blower housing.
- Impeller: The fan-like component that throws the snow out of the chute.
- Chute: The part that directs the snow where you want it to go.
- Skids: Adjustable feet that determine the height of the blower from the ground.
- Handle Assembly: The part that houses controls and provides a grip for the operator.

2. Electric Shovel Components

- Blade: The front component that cuts through the snow.
- Motor: Powers the shovel and drives the blade.
- Trigger: Activates the motor and controls the operation of the shovel.
- Wheels: Provide mobility and ease of use.
- Safety Switch: Prevents accidental activation of the motor.

How to Use the Snow Joe Parts Diagram

Using the Snow Joe parts diagram effectively can make maintenance and repairs much easier. Here's how to utilize it:

Step-by-Step Guide

1. **Locate the Diagram:** Find the parts diagram specific to your Snow Joe model. This can usually be found in the user manual or on the Snow Joe website.
2. **Identify the Part:** If you have a specific issue or need to replace a part, refer to the diagram to locate it visually.
3. **Check the Part Number:** Make note of the part number associated with the component you need.
4. **Order the Part:** Use the part number to order from authorized retailers or directly from Snow Joe.
5. **Refer to Maintenance Instructions:** The diagram may also include maintenance tips or instructions for specific parts, helping you keep your equipment in top condition.

Where to Find Snow Joe Parts Diagrams

Finding a reliable Snow Joe parts diagram is crucial for effective maintenance and repair. Here are several sources to consider:

1. Official Snow Joe Website

The official Snow Joe website offers downloadable user manuals and parts diagrams for all their products. This is the most reliable and up-to-date source for diagrams.

2. Authorized Retailers

Many authorized retailers and dealers provide access to parts diagrams for the products they sell. This can be particularly useful if you're looking for a specific part or need assistance with repairs.

3. Online Forums and Communities

There are several online forums dedicated to snow removal equipment where Snow Joe users share experiences, tips, and sometimes even diagrams. Participating in these communities can provide valuable insights.

4. YouTube Tutorials

YouTube is a great resource for visual learners. Many users upload repair and maintenance videos that often include references to parts diagrams, making it easier to understand the parts in context.

Tips for Maintaining Your Snow Joe Equipment

Proper maintenance of your Snow Joe equipment can prolong its lifespan and improve performance. Here are some tips to consider:

1. Regular Cleaning

After each use, ensure that your snow blower or shovel is free from snow and ice buildup. This prevents rust and keeps the parts moving smoothly.

2. Lubrication

Check the manufacturer's guidelines for lubrication points and use appropriate lubricants on moving parts to reduce wear.

3. Inspect Parts Regularly

Before the snow season starts, inspect key components like the auger, impeller, and blades for any signs of damage or wear.

4. Store Properly

When not in use, store your equipment in a dry place and cover it to protect it from dust and moisture.

Conclusion

A thorough understanding of the **Snow Joe parts diagram** is invaluable for anyone looking to maintain or repair their Snow Joe equipment. By familiarizing yourself with the components and utilizing the diagram effectively, you can ensure that your snow blower or electric shovel operates at peak performance when you need it most. Whether you're a seasoned user or a first-time owner, having access to this information will enhance your experience and help you tackle winter weather efficiently.

Frequently Asked Questions

What is a Snow Joe parts diagram used for?

A Snow Joe parts diagram is used to identify and locate various components of Snow Joe equipment, helping users understand assembly, disassembly, and replacement of parts.

Where can I find the Snow Joe parts diagram for my model?

You can find the Snow Joe parts diagram for your model on the official Snow Joe website, or in the user manual that came with your equipment. Many retailers also provide diagrams for specific models.

Do I need a specific model number to access the Snow Joe parts diagram?

Yes, you will need the specific model number of your Snow Joe equipment to access the correct parts diagram, as each model may have different components and layouts.

Can I order replacement parts directly from the Snow Joe parts diagram?

Yes, once you identify the necessary parts from the Snow Joe parts diagram, you can typically order them directly from the Snow Joe website or through authorized retailers.

Is the Snow Joe parts diagram available in digital format?

Yes, the Snow Joe parts diagram is usually available in digital format as a PDF on the Snow Joe website, making it easy to download and reference.

Find other PDF article:

<https://soc.up.edu.ph/05-pen/files?dataid=xVx75-7367&title=amazon-internship-interview-process.pdf>

[Snow Joe Parts Diagram](#)

Eggsmart | Canadian Comfort for Breakfast, Brunch & Lunch.

For those with a sweet tooth! Brunch or Lunch! & Get 10% OFF Your Order! start your day! © Copyright 2025. Eggsmart, All Rights Reserved. We value your privacy. We use cookies on ...

Eggsmart

Eggsmart, All Rights Reserved.

Eggsmart, Kitchener - Menu, Reviews (114), Photos (58)

Jun 23, 2025 · Eggsmart is a cozy breakfast spot serving tasty and healthy meals, including their popular meat lovers egg skillet. The friendly servers provide good service, and the menu ...

Eggsmart - Chairmans Brands

Eggsmart is the new take on breakfast! Our casual dining restaurants provide the perfect ambiance for enjoying a delicious twist on the classic breakfast, brunch, or lunch. Our 43 ...

Eggsmart | Menu

Served with Thick toast, signature home fries and seasonal fruit garnish. Double Smoked Bacon, Sausage, Smoked Ham, Peppers, Caramelized Onions topped with Cheddar Cheese | 1290 ...

Eggsmart (2690 Eglinton Ave E) - SkipTheDishes

Order food delivery and take out online from Eggsmart (2690 Eglinton Ave E). Browse their menu and store hours.

Eggsmart | Canadian Breakfast, Brunch & Lunch Near You

Explore delicious breakfast, brunch, and lunch in Burlington! Eggsmart offers mouthwatering Canadian meals made with fresh, local ingredients and 100% cage-free eggs.

Eggsmart's Delivery & Takeout Near You - DoorDash

Order online with DoorDash and get Eggsmart's delivered to your door. No-contact delivery and takeout orders available now.

Locations - Eggsmart

Out of these, the cookies that are categorized as necessary are stored on your browser as they are essential for the working of basic functionalities of the website. We also use third-party ...

Eggsmart (@eggsmart_can) • Instagram photos and videos

3,339 Followers, 707 Following, 942 Posts - Eggsmart (@eggsmart_can) on Instagram: "☑️100% Canadian Breakfast, Brunch & Lunch Restaurant The Official Eggsmart Instagram Account ...

Nitrous+ RDA 22 (Global version) - Store - Damn Vape

6th Anniversary Special Offer Nitrous+ RDA☐single cap+dual cap☐ * 2 types of metal top cap; * Single coil & dual coil; * Ultra compressed chamber; * Smooth/ tasty/ quiet; * Super easy to ...

Damn Vape NITROUS 22mm RDA

Check out the Damn Vape Nitrous 22mm RDA, featuring a 1.5mL deep juice wells, elevated postless build deck, and single or dual coil configuration.

Damn Vape Nitrous: I've never seen an RDA quite like this. It's ...

Damn Vape Nitrous: I've never seen an RDA quite like this. It's time for a single coil baby! ☐ Share Sort by: Top Open comment sort options Best Top New Controversial Old Q&A Add a ...

Nitrous RTA Damn Vape Atomizer | Svapoebasta

Nitrous RTA is a rebuildable atomizer by Damn Vape for mouth-to-lung vaping and Flavour Chasing. The deck is designed for single coil, with a liquid capacity of 2.5ml and top refill ...

Damn Vape Nitrous RDA | Dual Cap Edition | 22mm RDA - Ecigone

Damn Vape Nitrous RDA features a 22mm compact design, dual cap system for single & dual coils, an ultra-compressed chamber, and is compatible with squonk mods.

DAMN VAPE : NITROUS 24MM RDTA - TV69

The Nitrous RDTA by Damn Vape is a high-performance, rebuildable, dripping tank atomizer with a simple, easy-to-use build deck, adjustable airflow, and a large 3ml capacity.

RDA vape | Buy RDA vape online | RDA vape for sale

RDA vape for sale online at discounted prices today. RDA vape is the perfect way to enjoy vaping at your convenience both indoor and outdoor.

Store - Damn Vape - Damn love it

Buy RBA and get free panel (Note what you need Billbet Box AIO / Pulse AIO / Cthulhu AIO)

Nitrous Zaion AIO check atomizer/short problem : r/Vaping - Reddit

Hello, so I just ran into a problem with my Nitrous Zaion AIO by Damn Vape that I had for around 10 days now. I am using it with the atemporal boro that came with the kit.

Damn Vape Nitrous RDTA | 4-Wire Wicking System | 24mm RDTA ...

Damn Vape Nitrous RDTA features a 24mm post-less deck compatible with single & dual coil setups, honeycomb airflow, and PCTG tank suitable for DTL & RDL vaping.

Explore our detailed Snow Joe parts diagram to easily identify and order the right components for your snow removal needs. Learn more for hassle-free maintenance!

[Back to Home](#)