

Shark Navigator Vacuum Manual

Getting Started



FIRST THING'S FIRST, YOU NEED TO KNOW WHAT'S IN THE BOX YOU JUST OPENED:

- A** Vacuum Body
- B** Floor Power Nozzle
- C** Handle Assembly
- D** Super Stretch Hose
- E** Cleaning Wand
- F** Pet Hair Power Brush
- G** Cleaning Attachments
- H** 24" Crevice Tool
- I** Extended Reach Kit
- J** Accessory Bag (not shown)

* **Note:** Optional tools are available for sale for any UV410 model: 1-800-798-7398.

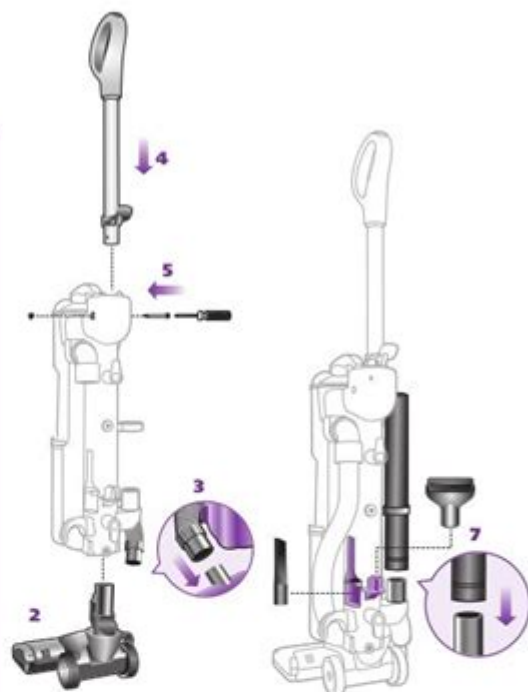

Your Shark® Navigator™ Upright is easy to assemble:

- 1** Lay your vacuum body on a level surface.
- 2** Slide the electrical connection from the power nozzle into the main body to click into place.
- 3** Connect the hose from the main body to the power nozzle; push with a slight turning motion to create a snug fit.
- 4** Slide the handle assembly into the upright unit aligning the hose hook on the handle assembly with the power cord hooks on the back of the unit.
- 5** Secure the handle assembly in place with included nut/bolt (shipped attached to handle assembly).
- 6** Place the vacuum in the upright position.
- 7** Store the Crevice Tool, Dusting Brush and Cleaning Wand on the unit.

Shark Navigator Vacuum Manual is an essential guide for users of one of the most popular vacuum cleaner brands on the market. The Shark Navigator series is renowned for its powerful suction, versatility, and user-friendly features. This article will delve into the specifics of the Shark Navigator vacuum manual, covering its features, maintenance tips, troubleshooting common issues, and more.

Overview of the Shark Navigator Vacuum

The Shark Navigator vacuum series includes various models designed for different cleaning needs. Some of the key features that make these vacuums stand out include:

- Lightweight Design: Easy to maneuver and carry around the house.
- Powerful Suction: Engineered to pick up both large debris and fine dust.
- Washable Filters: Helps maintain optimal performance without the need for constant replacements.
- Versatile Cleaning Tools: Comes with attachments for cleaning upholstery, stairs, and hard-to-reach areas.

Understanding the Shark Navigator Vacuum Manual

The Shark Navigator vacuum manual serves as a comprehensive resource for users, providing detailed information about setup, operation, and maintenance. Here are the primary sections you can expect to find in the manual:

Getting Started

This section typically includes:

- Unboxing Instructions: How to safely remove the vacuum and its accessories from the packaging.
- Assembly Steps: Illustrated instructions for putting together the vacuum, including attaching the handle and hose.
- Powering On: Guidance on how to plug in and turn on the vacuum for the first time.

Operating the Vacuum

The manual provides detailed instructions on how to operate the vacuum effectively. Key points include:

- Adjusting the Height: Depending on the surface type (carpet, hardwood, etc.), you may need to adjust the height settings for optimal cleaning.
- Using Attachments: Instructions on how to use different tools, such as the crevice tool or dusting brush, that come with the vacuum.
- Switching Modes: Information on switching from carpet to bare floor modes, ensuring the vacuum operates efficiently on different surfaces.

Maintenance and Care

Regular maintenance is crucial for extending the life of your Shark Navigator vacuum. The manual typically covers:

- **Cleaning the Filters:** Detailed steps on how to remove, wash, and reinstall the filters. It usually recommends washing the filters every few months to maintain suction power.
- **Emptying the Dust Cup:** Instructions on how to properly remove and empty the dust cup, as well as clean it if necessary.
- **Checking for Blockages:** Guidance on inspecting the hose and brush roll for clogs or debris that may affect performance.

Troubleshooting Common Issues

Even the best appliances can experience issues. The Shark Navigator vacuum manual includes a troubleshooting section to help users diagnose and fix common problems. Here are some of the issues you might encounter:

Vacuum Won't Turn On

If your vacuum is unresponsive, check the following:

1. **Power Source:** Ensure the vacuum is plugged in and the outlet is functional.
2. **Power Switch:** Verify that the power switch is in the "on" position.
3. **Thermal Fuse:** If the vacuum overheats, it may trip the thermal fuse. Allow it to cool down for 30 minutes before trying again.

Loss of Suction

If you notice a decrease in suction power, consider:

- **Emptying the Dust Cup:** A full dust cup can hinder performance.
- **Checking Filters:** Clogged or dirty filters can reduce suction. Clean them as per the manual's instructions.
- **Inspecting Brushes:** Ensure the brush roll is free from hair or debris that can impede its movement.

Strange Noises

If your vacuum is making unusual sounds, it could indicate a problem. Steps to take include:

- Inspecting for Blockages: Look for any obstructions in the hose or brush roll.
- Checking the Belt: A worn or broken belt can cause noise. The manual will provide guidance on how to replace it if necessary.

Additional Features of the Shark Navigator Vacuum

Apart from the basics, several models in the Shark Navigator line offer additional features that enhance their usability:

Lift-Away Technology

Many Shark Navigator models come equipped with Lift-Away technology, allowing users to detach the canister for portable cleaning. This feature is particularly useful for:

- Cleaning Stairs: Easily maneuver the vacuum on steps without lifting the entire unit.
- Reaching High Areas: Use the vacuum to clean ceilings, drapes, or other hard-to-reach spots.

Anti-Allergen Complete Seal Technology

Some models are designed with a complete seal that traps allergens and dust inside the vacuum. This is beneficial for households with allergy sufferers, as it helps improve indoor air quality.

LED Headlights

LED headlights can illuminate dark corners and under furniture, making it easier to spot hidden dirt and debris.

Conclusion

The **Shark Navigator vacuum manual** is an invaluable resource for anyone looking to get the most out of their vacuum cleaner. From setup to troubleshooting, the manual provides detailed instructions to ensure effective cleaning and maintenance. By following the guidelines outlined in the manual, users can ensure their Shark Navigator vacuum operates at peak performance for years to come.

For those seeking further assistance, Shark's customer service is readily available to answer any questions not covered in the manual. Regular maintenance and understanding

the features of your vacuum will not only enhance your cleaning experience but also prolong the life of your appliance. Whether you are a first-time user or a seasoned veteran, the Shark Navigator series offers a reliable solution for all your cleaning needs.

Frequently Asked Questions

Where can I find the Shark Navigator vacuum manual?

You can find the Shark Navigator vacuum manual on the official Shark website under the support section or by searching for your specific model number.

What should I do if I can't locate my Shark Navigator vacuum manual?

If you can't locate your manual, you can download a digital version from the Shark website or contact Shark customer support for assistance.

What common maintenance tips are included in the Shark Navigator vacuum manual?

The manual typically includes maintenance tips such as regularly checking and cleaning the filters, emptying the dust canister, and inspecting the brush roll for debris.

Does the Shark Navigator vacuum manual provide troubleshooting steps?

Yes, the manual includes troubleshooting steps for common issues such as loss of suction, brush roll not spinning, and electrical problems.

How do I reset my Shark Navigator vacuum according to the manual?

To reset your Shark Navigator vacuum, unplug it, wait for a few minutes, then plug it back in. Some models may have a specific reset button; refer to the manual for details.

Are replacement parts mentioned in the Shark Navigator vacuum manual?

Yes, the manual usually lists recommended replacement parts and accessories, along with instructions on how to order them.

Find other PDF article:

<https://soc.up.edu.ph/46-rule/files?ID=xLa50-7797&title=periods-of-american-history.pdf>

[Shark Navigator Vacuum Manual](#)

[AGV ARAI SHOEI SHARK - Mobile01](#)

Jan 21, 2015 · [AGV ARAI SHOEI SHARK](#) [AGV ...](#)

[...](#)

Aug 18, 2023 · [...](#)

[shark](#) - [...](#)

[Shark](#) [Tek](#) [...](#)

[Card Shark](#) - [...](#)

[Card Shark](#) [18](#) [...](#)

[BYD SHARK](#) [...](#)

[Shark](#) [38.66~41.65](#) [Shark](#) [...](#)

[AGV ARAI SHOEI SHARK - Mobile01](#)

Jan 21, 2015 · [AGV ARAI SHOEI SHARK](#) [AGV ...](#)

[AGV ARAI SHOEI SHARK](#) [...](#)

[...](#)

Aug 18, 2023 · [Ginglymostoma](#)

[cirratum](#) [...](#)

[shark](#) - [...](#)

[Shark](#) [Tek](#) [...](#)

[...](#)

[Card Shark](#) - [...](#)

[Card Shark](#) [18](#) [...](#)

[...](#)

[BYD SHARK](#) [...](#)

[Shark](#) [38.66~41.65](#) [Shark](#) [...](#)

[...](#)

[Shark](#) - [...](#)

[Shark](#) [Ultra7 265K](#) [RTX4090D](#) [64GB DDR5](#) [2TB](#)

[Z890](#) [4M.2](#) [...](#)

[SHARK D-SKWAL 2 NANO](#) [...](#)

Sep 29, 2023 · [ESP](#) [D-SKWAL 2](#) [ESP](#) [SHARK](#) [...](#)

[...](#)

[shark](#) - [Mobile01](#)

Feb 16, 2022 · [shark](#) [cp](#) [shoei](#) [arai](#) [8](#) [shark](#) [...](#)

[...](#)

2023 AGV ...

SHARK

[illegible]

1973 2014
...

Unlock the full potential of your Shark Navigator vacuum with our comprehensive manual. Discover how to optimize performance and troubleshoot issues. Learn more!

[Back to Home](#)