

Scag Tiger Cat 2 Drive Belt Diagram

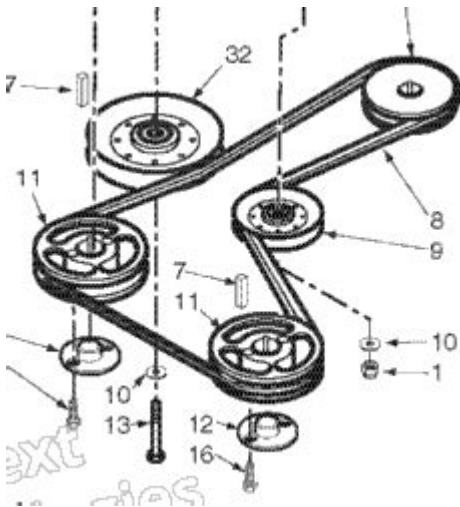

Scag Tiger Cat 2 Drive Belt Diagram is an essential aspect of understanding and maintaining the Scag Tiger Cat 2 mower. Known for its durability and superior performance, the Scag Tiger Cat 2 is a popular choice among professional landscapers and homeowners alike. However, like any piece of machinery, it requires regular maintenance to ensure optimal performance. One of the critical components of the mower is the drive belt, which plays a significant role in transferring power from the engine to the mower's cutting deck. This article will provide a comprehensive overview of the Scag Tiger Cat 2 drive belt diagram, its components, installation, and maintenance tips.

Understanding the Drive Belt System

The drive belt system on the Scag Tiger Cat 2 is designed to efficiently transmit power from the engine to the mower blades. A well-functioning drive belt is crucial for the mower's performance, and understanding its layout can help in troubleshooting issues and performing maintenance.

Components of the Drive Belt System

The drive belt system comprises several components, each playing a vital role in the overall operation

of the mower. The main components include:

1. Engine Pulley: The engine pulley is connected to the engine and drives the belt.
2. Belt: The drive belt itself is the primary component that transfers power.
3. Idler Pulley: This pulley maintains tension on the drive belt, preventing slippage.
4. Deck Pulley: The deck pulley transmits the power to the mower blades.
5. Tensioner: The tensioner adjusts the tension on the belt to ensure efficient operation.

Drive Belt Diagram Overview

The drive belt diagram is a visual representation of how the components are arranged and connected in the Scag Tiger Cat 2. Understanding this diagram is crucial for anyone attempting maintenance or repairs.

Key Features of the Drive Belt Diagram

The drive belt diagram typically includes:

- Component Labels: Each part of the drive system is labeled for easy identification.
- Belt Routing: The diagram shows the path the drive belt takes around the pulleys.
- Tension Adjustment Points: These are indicated to help the user know where to adjust belt tension.

Importance of the Drive Belt Diagram

Having a clear and accurate drive belt diagram is essential for several reasons:

1. Ease of Maintenance: It provides a reference for technicians and DIY enthusiasts when replacing or

adjusting the drive belt.

2. Troubleshooting Issues: When there are performance issues with the mower, the diagram can help identify potential problems within the drive belt system.
3. Avoiding Mistakes: With the diagram as a guide, there is a reduced risk of incorrectly routing the drive belt, which can lead to further mechanical issues.

Installing the Drive Belt

Proper installation of the drive belt is crucial for the efficient operation of the Scag Tiger Cat 2. Here is a step-by-step guide to installing the drive belt:

Tools Required

- Wrench set
- Screwdriver
- Pliers
- Replacement drive belt

Installation Steps

1. Safety First: Ensure the mower is turned off, and the key is removed from the ignition.
2. Access the Drive Belt: Remove any necessary covers or shields to access the drive belt system.
3. Remove the Old Belt: If replacing, carefully remove the old drive belt from the pulleys. Take note of how it is routed.
4. Check Components: Inspect the pulleys, idlers, and tensioners for wear and replace if necessary.
5. Install the New Belt: Following the drive belt diagram, thread the new belt around the pulleys, ensuring it is correctly positioned.

6. **Adjust Tension:** Use the tensioner to adjust the belt tension according to the manufacturer's specifications.
7. **Reassemble the Mower:** Replace any covers or shields that were removed during the process.
8. **Test the Mower:** Start the mower to test the functionality of the new drive belt and ensure there are no unusual noises or performance issues.

Maintenance Tips for the Drive Belt

Regular maintenance of the drive belt system can prolong its life and improve the performance of the Scag Tiger Cat 2. Here are some maintenance tips:

Regular Inspection

- Check the belt for signs of wear, such as fraying, cracks, or glazing.
- Inspect the pulleys and idlers for any signs of misalignment or damage.

Keep it Clean

- Clean the area around the drive belt regularly to prevent debris from accumulating.
- Use compressed air to blow out any grass clippings or dirt that may interfere with the operation.

Proper Tension Adjustment

- Regularly check the tension of the drive belt. An overly tight or loose belt can lead to premature wear or slippage.
- Refer to the owner's manual for specific tensioning guidelines.

Common Issues and Troubleshooting

Even with proper maintenance, issues may arise with the drive belt system. Here are some common problems and their potential solutions:

Slipping Belt

- Symptoms: The mower may lose power, or the blades may not spin correctly.
- Solution: Check the tension of the belt and adjust accordingly. Inspect for wear or damage and replace if necessary.

Fraying or Cracking Belt

- Symptoms: Visible damage to the belt.
- Solution: Replace the drive belt immediately to avoid further damage to the mower.

Noisy Operation

- Symptoms: Unusual noises during operation.
- Solution: Check for misalignment of the pulleys or worn bearings. Realign or replace components as necessary.

Conclusion

The Scag Tiger Cat 2 drive belt diagram is an invaluable tool for anyone involved in the maintenance

and repair of this high-performance mower. Understanding the components, installation process, and maintenance requirements of the drive belt system is essential for ensuring the longevity and efficiency of the machine. By following the guidelines outlined in this article, users can effectively manage their mower's drive belt system, minimizing downtime and maximizing productivity. Regular inspections and adherence to maintenance tips will not only extend the life of the drive belt but also enhance the overall performance of the Scag Tiger Cat 2, allowing users to tackle any landscaping job with confidence.

Frequently Asked Questions

What is the purpose of the drive belt in a Scag Tiger Cat 2?

The drive belt in a Scag Tiger Cat 2 transmits power from the engine to the transmission, allowing the mower to drive forward and backward.

Where can I find the drive belt diagram for a Scag Tiger Cat 2?

The drive belt diagram can typically be found in the owner's manual or service manual of the Scag Tiger Cat 2, and it may also be available on the Scag website or through authorized dealers.

What are common symptoms of a worn drive belt in a Scag Tiger Cat 2?

Common symptoms of a worn drive belt include reduced power to the wheels, slipping during operation, unusual noises, and visible cracks or fraying on the belt itself.

How often should I check or replace the drive belt on my Scag Tiger Cat 2?

It's recommended to check the drive belt regularly for signs of wear and replace it at least once a season, or more frequently if you use the mower heavily.

Can I replace the drive belt on a Scag Tiger Cat 2 myself?

Yes, replacing the drive belt on a Scag Tiger Cat 2 can be done by a knowledgeable owner, but it requires following the proper steps outlined in the owner's manual or service guide.

What tools do I need to replace the drive belt on a Scag Tiger Cat 2?

To replace the drive belt on a Scag Tiger Cat 2, you will typically need basic hand tools such as wrenches, sockets, and possibly a screwdriver, depending on the specific model.

Is there a specific tension setting for the drive belt on the Scag Tiger Cat 2?

Yes, the drive belt on the Scag Tiger Cat 2 should be tensioned according to the specifications provided in the owner's manual, ensuring proper operation and longevity of the belt.

What should I do if the drive belt keeps slipping on my Scag Tiger Cat 2?

If the drive belt keeps slipping, check for proper tension, inspect for wear or damage, and ensure that all pulleys are aligned and in good condition. If issues persist, consider consulting a professional.

Find other PDF article:

<https://soc.up.edu.ph/41-buzz/pdf?ID=ulr64-6508&title=military-mental-health-assessment.pdf>

[Scag Tiger Cat 2 Drive Belt Diagram](#)

[MyChart - Login Page - Bronson Healthcare Group](#)

Any questions regarding your health information should be discussed with your healthcare provider at your next visit. MyChart Help Support for MyChart is provided by Bronson ...

Bronson MyChart - access to your electronic health information

Get secure, online access to your electronic health information, and by proxy your family's health information, using Bronson MyChart.

Sign In

Sign-in with your Bronson username and Password. WARNING: You are about to enter a restricted computing environment. The system you are using provides access to confidential ...

Log in to Your MyChart Account

In your web browser, enter the address of your healthcare organization's MyChart website and access the login page. Enter your MyChart username and password, and click Sign In.

MyChart - Login Page - Bronson Health

Log in to MyChart. Error: Please enable cookies to log in to MyChart. MyChart Username. Password. Forgot login information? Log in with passkey Sign up. MyChart® licensed from ...

Help With Bronson MyChart

You can now sync your health data to Bronson MyChart using Track My Health. This feature connects key health information such as heart rate, steps, and blood pressure to your MyChart ...

MyChart - login recovery page

If the information you submitted matched a MyChart account in our records, your username has been sent to the email address on file.

Sign-in with your Bronson username and Password.

Sign-in with your Bronson username and Password. WARNING: You are about to enter a restricted computing environment. The system you are using provides access to confidential ...

Bronson Healthcare | Patient Portal

View our Patient Help Center. All data is securely encrypted. © 2025 MedBridge Inc. All rights reserved. California residents know your rights. Click here for details.

MyChart - login recovery page - Bronson Health

If you have an e-mail address on file then your MyChart Username will be sent to your e-mail account. If you do not remember any of this information, you will have to contact Bronson ...

my msn email on my iPhone suddenly stopped working

Oct 2, 2024 · i can't get my msn email on iphone all of a sudden***Moved from Microsoft 365 and Office / Other / For home / Other***

Price increase for MSN premium for 2023? - Microsoft Community

Feb 16, 2023 · My subscription to MSN premium is listed on my Microsoft account subscriptions page at \$49.95 per year. That is the price I have been paying for several years. I just got an email ...

MSN email account , can no longer send or receive emails

Nov 11, 2024 · Can no longer send or receive email in my MSN email account , message - failed server / account info ? updated sever and password still cannot access emails

Outlook 365 (Classic) and @msn email address issues

Oct 5, 2024 · I have an @msn email account that was working okay in Outlook Classic up until the end of September 2024. I keep getting the password Pop Up Box and have verified I can login to ...

MSN premium with 365 Personal subscription. - Microsoft ...

Feb 22, 2025 · MSN Premium is a very old product, and I believe there is currently no need to renew it. You can subscribe to M365 Home Edition to replace its features. still retain the email accounts ...

[recover my msn.com email account - Microsoft Community](#)

May 12, 2020 · I delete my msn.com alias email account then i found that my email account completely deleted. I want to recover my email address as I have many subscriptions linked to it ...

MSN Member Center Unable to add member - Microsoft Community

Jan 9, 2025 · Welcome to Microsoft Community. I understand you are having problem adding your msn account and I'd like to help. In order to further analyze your issue in depth, please don't ...

[My MSN email in Outlook keeps asking me for a password. Please ...](#)

Nov 3, 2024 · I have had issues recently with my MSN email. I use Outlook. It keeps asking me for my password and when I enter I get a 'cannot not verify account name or password'. I have tried ...

Have MSN Premium - can't create @msn.com email, issue has not ...

Nov 15, 2024 · It is currently not possible to create an MSN account through MSN Premium. But as Microsoft Community Outlook Technical Support. I don't know much more about MSN Premium. ...

[Microsoft Community](#)

.. Windows, Surface, Bing, Microsoft Edge, Windows Insider, Microsoft Advertising, Microsoft 365 and Office, Microsoft 365 Insider, Outlook and Microsoft Teams forums are available exclusively ...

Discover the Scag Tiger Cat 2 drive belt diagram and learn how to maintain your mower efficiently. Keep your equipment running smoothly—learn more now!

[Back to Home](#)