

Savage Mark II Parts Diagram

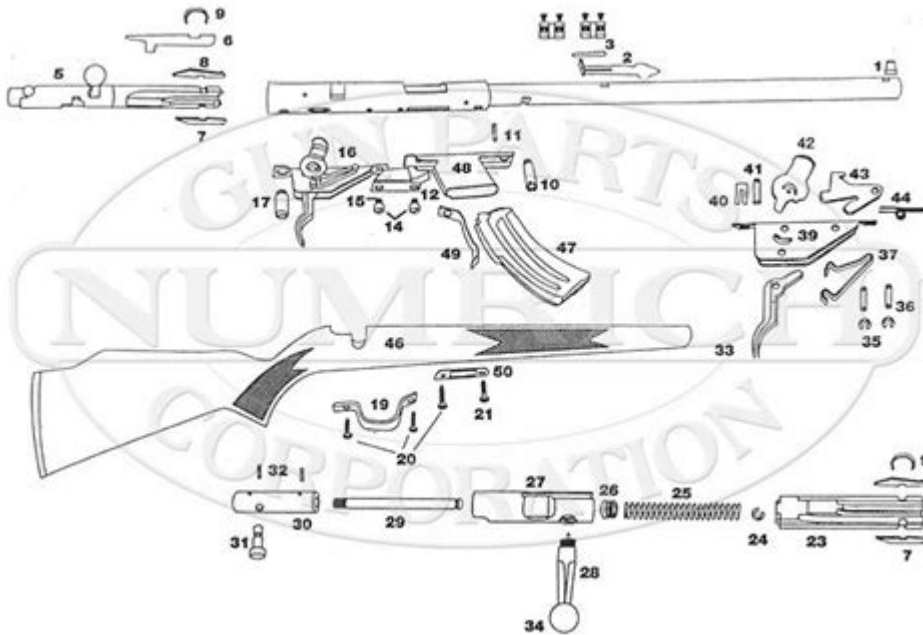

SAVAGE MARK II PARTS DIAGRAM IS AN ESSENTIAL RESOURCE FOR FIREARM ENTHUSIASTS AND GUNSMITHS ALIKE, PROVIDING A DETAILED VISUAL REPRESENTATION OF THE VARIOUS COMPONENTS THAT MAKE UP THIS POPULAR RIMFIRE RIFLE. WHETHER YOU ARE A SEASONED GUNSMITH LOOKING TO MAKE REPAIRS, A NOVICE WANTING TO UNDERSTAND YOUR FIREARM BETTER, OR SIMPLY A COLLECTOR AIMING TO IDENTIFY PARTS, HAVING ACCESS TO AN ACCURATE PARTS DIAGRAM CAN GREATLY ENHANCE YOUR EXPERIENCE. THIS ARTICLE WILL EXPLORE THE KEY ELEMENTS OF THE SAVAGE MARK II PARTS DIAGRAM, ITS SIGNIFICANCE, AND HOW TO USE IT EFFECTIVELY FOR MAINTENANCE AND REPAIRS.

UNDERSTANDING THE SAVAGE MARK II

THE SAVAGE MARK II IS A BOLT-ACTION RIFLE THAT IS WELL-REGARDED FOR ITS ACCURACY, RELIABILITY, AND AFFORDABILITY. DESIGNED PRIMARILY FOR SMALL GAME HUNTING AND TARGET SHOOTING, IT HAS GAINED A REPUTATION FOR BEING A SOLID ENTRY-LEVEL RIFLE FOR NEW SHOOTERS WHILE ALSO SATISFYING THE NEEDS OF EXPERIENCED MARKSMEN.

KEY FEATURES OF THE SAVAGE MARK II

- **CALIBER OPTIONS:** THE SAVAGE MARK II IS AVAILABLE IN VARIOUS CALIBERS, INCLUDING .22 LR, .22 WMR, AND .17 HMR.
- **BARREL LENGTHS:** IT COMES IN DIFFERENT BARREL LENGTHS, ALLOWING USERS TO CHOOSE BASED ON THEIR SHOOTING STYLE AND PURPOSE.
- **STOCK VARIANTS:** THE RIFLE IS OFFERED WITH MULTIPLE STOCK OPTIONS, INCLUDING SYNTHETIC AND WOODEN STOCKS, PROVIDING CHOICES FOR AESTHETICS AND ERGONOMICS.
- **ACCURACY:** THE MARK II IS KNOWN FOR ITS EXCEPTIONAL ACCURACY, MAKING IT A FAVORITE AMONG TARGET SHOOTERS.

THE IMPORTANCE OF A PARTS DIAGRAM

A PARTS DIAGRAM SERVES MULTIPLE PURPOSES WHEN IT COMES TO FIREARMS MAINTENANCE AND REPAIR. HERE ARE SOME REASONS WHY HAVING A SAVAGE MARK II PARTS DIAGRAM IS CRUCIAL:

1. VISUAL REFERENCE

A WELL-ILLUSTRATED PARTS DIAGRAM OFFERS A CLEAR AND CONCISE VISUAL REFERENCE FOR IDENTIFYING EACH COMPONENT OF THE RIFLE. THIS IS ESPECIALLY USEFUL FOR BEGINNERS WHO MAY NOT YET BE FAMILIAR WITH THE NAMES OR FUNCTIONS OF THE VARIOUS PARTS.

2. SIMPLIFIED REPAIRS

WHEN PERFORMING REPAIRS OR MAINTENANCE, HAVING A PARTS DIAGRAM CAN SIMPLIFY THE PROCESS. IT CAN HELP YOU PINPOINT WHERE EACH COMPONENT FITS AND HOW THEY INTERACT WITH ONE ANOTHER, REDUCING THE LIKELIHOOD OF ERRORS DURING REASSEMBLY.

3. ORDERING REPLACEMENT PARTS

IF A PART BECOMES DAMAGED OR NEEDS TO BE REPLACED, A PARTS DIAGRAM CAN ASSIST YOU IN IDENTIFYING THE SPECIFIC COMPONENT REQUIRED. THIS CAN STREAMLINE THE PROCESS OF ORDERING PARTS FROM MANUFACTURERS OR SUPPLIERS.

4. ENHANCING KNOWLEDGE

FOR THOSE INTERESTED IN GUNSMITHING OR SIMPLY WISHING TO DEEPEN THEIR UNDERSTANDING OF FIREARMS, A PARTS DIAGRAM PROVIDES INSIGHT INTO HOW EACH COMPONENT CONTRIBUTES TO THE RIFLE'S FUNCTION. THIS KNOWLEDGE CAN BE INVALUABLE FOR TROUBLESHOOTING ISSUES OR ENHANCING PERFORMANCE.

COMPONENTS OF THE SAVAGE MARK II PARTS DIAGRAM

THE SAVAGE MARK II PARTS DIAGRAM TYPICALLY INCLUDES A VARIETY OF COMPONENTS. UNDERSTANDING THESE PARTS CAN HELP USERS MANAGE THEIR RIFLES EFFECTIVELY. BELOW ARE SOME OF THE MAIN COMPONENTS YOU WILL FIND IN THE DIAGRAM:

1. ACTION COMPONENTS

- BOLT: THE PART THAT LOCKS THE CARTRIDGE IN PLACE AND IS MANIPULATED BY THE SHOOTER TO LOAD AND EJECT ROUNDS.
- BOLT HANDLE: ATTACHED TO THE BOLT, THIS IS WHAT THE SHOOTER USES TO OPERATE THE BOLT.
- TRIGGER ASSEMBLY: THIS INCLUDES THE TRIGGER AND SEAR, WHICH ARE CRITICAL FOR FIRING THE RIFLE.

2. BARREL ASSEMBLY

- BARREL: THE LONG METAL TUBE THROUGH WHICH THE BULLET TRAVELS WHEN FIRED.
- MUZZLE: THE END OF THE BARREL WHERE THE BULLET EXITS.
- SIGHTS: THESE CAN INCLUDE IRON SIGHTS OR MOUNTS FOR SCOPES, AIDING IN AIMING.

3. STOCK ASSEMBLY

- STOCK: THE PART OF THE RIFLE THAT THE SHOOTER HOLDS, WHICH CAN COME IN DIFFERENT MATERIALS AND SHAPES.

- PISTOL GRIP: THE PART OF THE STOCK THAT THE SHOOTER HOLDS WITH THEIR DOMINANT HAND.
- BUTT PLATE: THE REAR PART OF THE STOCK THAT RESTS AGAINST THE SHOULDER.

4. MAGAZINE ASSEMBLY

- MAGAZINE: THE COMPONENT THAT HOLDS THE CARTRIDGES BEFORE THEY ARE FED INTO THE CHAMBER.
- FOLLOWER: THE PART INSIDE THE MAGAZINE THAT PUSHES THE CARTRIDGES UPWARD.
- BASE PLATE: THE BOTTOM PART OF THE MAGAZINE THAT HOLDS THE COMPONENTS TOGETHER.

USING THE SAVAGE MARK II PARTS DIAGRAM

TO EFFECTIVELY USE THE SAVAGE MARK II PARTS DIAGRAM, FOLLOW THESE STEPS:

1. OBTAIN A QUALITY DIAGRAM

START BY FINDING A HIGH-QUALITY PARTS DIAGRAM. THIS CAN OFTEN BE FOUND IN THE OWNER'S MANUAL, ONLINE FORUMS, OR MANUFACTURER WEBSITES. ENSURE THAT IT IS SPECIFIC TO THE MODEL YOU OWN, AS THERE MAY BE VARIATIONS.

2. FAMILIARIZE YOURSELF WITH EACH PART

REVIEW THE DIAGRAM THOROUGHLY, MAKING NOTE OF THE NAMES AND FUNCTIONS OF EACH COMPONENT. YOU MAY EVEN WANT TO CROSS-REFERENCE THE DIAGRAM WITH YOUR RIFLE TO SEE HOW EACH PART FITS TOGETHER.

3. IDENTIFY ISSUES

IF YOU ARE EXPERIENCING PROBLEMS WITH YOUR RIFLE, USE THE DIAGRAM TO IDENTIFY POTENTIAL ISSUES. COMPARE THE MALFUNCTIONING PART WITH THE DIAGRAM TO SEE IF THERE ARE ANY VISIBLE SIGNS OF WEAR OR DAMAGE.

4. FOLLOW ASSEMBLY INSTRUCTIONS

WHEN DISASSEMBLING OR REASSEMBLING YOUR RIFLE, REFER TO THE DIAGRAM TO ENSURE THAT YOU ARE PLACING EACH PART IN THE CORRECT POSITION. THIS WILL HELP PREVENT ANY MISALIGNMENT OR OPERATIONAL ISSUES.

5. KEEP IT HANDY

CONSIDER PRINTING OUT THE PARTS DIAGRAM AND KEEPING IT IN YOUR GUNSMITHING KIT. HAVING A PHYSICAL COPY ON HAND CAN BE CONVENIENT FOR QUICK REFERENCE DURING MAINTENANCE OR REPAIRS.

CONCLUSION

THE **SAVAGE MARK II PARTS DIAGRAM** IS NOT JUST A HELPFUL TOOL; IT IS AN ESSENTIAL RESOURCE FOR ANYONE LOOKING TO MAINTAIN OR REPAIR THEIR RIFLE. BY UNDERSTANDING THE COMPONENTS, UTILIZING THE DIAGRAM EFFECTIVELY, AND FOLLOWING

PROPER MAINTENANCE PROCEDURES, YOU CAN ENSURE THAT YOUR SAVAGE MARK II REMAINS IN OPTIMAL CONDITION. WHETHER YOU ARE A SEASONED GUNSMITH OR A BEGINNER, FAMILIARIZING YOURSELF WITH YOUR FIREARM'S PARTS WILL ENHANCE YOUR SHOOTING EXPERIENCE AND DEEPEN YOUR APPRECIATION FOR THIS REMARKABLE RIFLE.

FREQUENTLY ASKED QUESTIONS

WHAT IS A SAVAGE MARK II PARTS DIAGRAM USED FOR?

A SAVAGE MARK II PARTS DIAGRAM IS USED TO IDENTIFY AND UNDERSTAND THE VARIOUS COMPONENTS OF THE RIFLE, ASSISTING IN ASSEMBLY, DISASSEMBLY, MAINTENANCE, AND REPAIRS.

WHERE CAN I FIND A DETAILED PARTS DIAGRAM FOR THE SAVAGE MARK II?

YOU CAN FIND A DETAILED PARTS DIAGRAM FOR THE SAVAGE MARK II ON THE OFFICIAL SAVAGE ARMS WEBSITE, IN THE OWNER'S MANUAL, OR THROUGH VARIOUS ONLINE GUN PARTS RETAILERS.

ARE THERE ANY COMMON ISSUES THAT CAN BE RESOLVED USING THE SAVAGE MARK II PARTS DIAGRAM?

YES, COMMON ISSUES SUCH AS MISFEEDS, FAILURE TO EJECT, OR ACCURACY PROBLEMS CAN OFTEN BE DIAGNOSED AND RESOLVED BY REFERENCING THE PARTS DIAGRAM TO IDENTIFY FAULTY COMPONENTS.

IS IT NECESSARY TO HAVE A PARTS DIAGRAM WHEN PERFORMING MAINTENANCE ON THE SAVAGE MARK II?

WHILE IT IS NOT STRICTLY NECESSARY, HAVING A PARTS DIAGRAM IS HIGHLY RECOMMENDED AS IT PROVIDES CLARITY ON HOW COMPONENTS FIT TOGETHER, MAKING MAINTENANCE TASKS EASIER AND MORE EFFICIENT.

CAN I ORDER INDIVIDUAL PARTS FOR THE SAVAGE MARK II USING THE PARTS DIAGRAM?

YES, YOU CAN ORDER INDIVIDUAL PARTS FOR THE SAVAGE MARK II BY IDENTIFYING THE SPECIFIC PART NUMBER ON THE DIAGRAM AND PURCHASING IT FROM AUTHORIZED DEALERS OR ONLINE RETAILERS.

Find other PDF article:

<https://soc.up.edu.ph/01-text/Book?ID=sfv34-8767&title=2006-mercedes-c230-service-manual.pdf>

Savage Mark II Parts Diagram

Savage Arms | Firearms, Rifles, Shotguns, Handguns

Savage Arms has been building firearms since 1894. Our rifles, shotguns and handguns are accurate, dependable and loaded with innovations for high performance.

Mounting a Scope to Your Savage REVEL

Mar 17, 2025 · Follow along with this step-by-step guide on how to properly mount and secure a scope to your Savage REVEL lever action rifle!

[Rimfire](#) | [Hunting](#), [Target](#), [Competition](#) | [Savage Arms](#)

Explore Savage's extensive rimfire rifle lineup in bolt action and semi-auto for plinking, hunting, and competition. Available in .22 LR, .17 HMR, and more.

[Firearms | Explore All Savage Firearms | Savage Arms](#)

Explore all Savage Arms firearms by type, usage, model name, and more. Find the ideal Savage firearm purpose-built for your hunting and shooting needs.

Mark I and Mark II | Bolt Action 22 LR | Savage Arms

At Savage, bolt-action rifles are in our DNA. We know what it takes to build a truly reliable bolt gun, and we put all of it into our trusted Mark I and Mark II Series.

[Firearms | Centerfire, Handgun, Rimfire, Shotgun | Savage](#)

Explore the full range of Savage firearms by type, including centerfire, handgun, rimfire, and shotgun. Find the perfect Savage firearm for your needs today.

Revel | Modern Rimfire Lever Action Rifle | Savage Arms

The Savage Revel is a modern rimfire lever action rifle with a walnut stock, oversized finger loop. Ideal for small game or plinking with easy takedown..

17 WSM | Browse All Rimfire 17 WSM Rifles | Savage Arms

Explore our full lineup of Savage 17 WSM rifles, designed for rimfire accuracy, reliability, and performance. Hunt and shoot with precision and confidence.

[Shotguns | Hunting, Competition, Tactical | Savage Arms](#)

Savage offers shotguns for every need—hunting, competition, or tactical. From semi-auto and bolt action to pump and break action, Savage has a shotgun for you.

[US and International Product Catalog - Savage Arms](#)

Browse the latest Savage Arms Catalog for our newest firearms and accessories and their product specifications. US and International versions available.

[Savage Arms | Firearms, Rifles, Shotguns, Handguns](#)

Savage Arms has been building firearms since 1894. Our rifles, shotguns and handguns are accurate, dependable and loaded with innovations for high performance.

[Mounting a Scope to Your Savage REVEL](#)

Mar 17, 2025 · Follow along with this step-by-step guide on how to properly mount and secure a scope to your Savage REVEL lever action rifle!

[Rimfire | Hunting, Target, Competition | Savage Arms](#)

Explore Savage's extensive rimfire rifle lineup in bolt action and semi-auto for plinking, hunting, and competition. Available in .22 LR, .17 HMR, and more.

Firearms | Explore All Savage Firearms | Savage Arms

Explore all Savage Arms firearms by type, usage, model name, and more. Find the ideal Savage firearm purpose-built for your hunting and shooting needs.

[Mark I and Mark II | Bolt Action 22 LR | Savage Arms](#)

At Savage, bolt-action rifles are in our DNA. We know what it takes to build a truly reliable bolt gun, and we put all of it into our trusted Mark I and Mark II Series.

Firearms | Centerfire, Handgun, Rimfire, Shotgun | Savage

Explore the full range of Savage firearms by type, including centerfire, handgun, rimfire, and shotgun. Find the perfect Savage firearm for your needs today.

Revel | Modern Rimfire Lever Action Rifle | Savage Arms

The Savage Revel is a modern rimfire lever action rifle with a walnut stock, oversized finger loop. Ideal for small game or plinking with easy takedown..

17 WSM | Browse All Rimfire 17 WSM Rifles | Savage Arms

Explore our full lineup of Savage 17 WSM rifles, designed for rimfire accuracy, reliability, and performance. Hunt and shoot with precision and confidence.

Shotguns | Hunting, Competition, Tactical | Savage Arms

Savage offers shotguns for every need—hunting, competition, or tactical. From semi-auto and bolt action to pump and break action, Savage has a shotgun for you.

US and International Product Catalog - Savage Arms

Browse the latest Savage Arms Catalog for our newest firearms and accessories and their product specifications. US and International versions available.

Explore our detailed Savage Mark II parts diagram for easy identification and maintenance. Discover how to enhance your rifle's performance. Learn more now!

[Back to Home](#)