

# Scag Turf Tiger Drive Belt Diagram

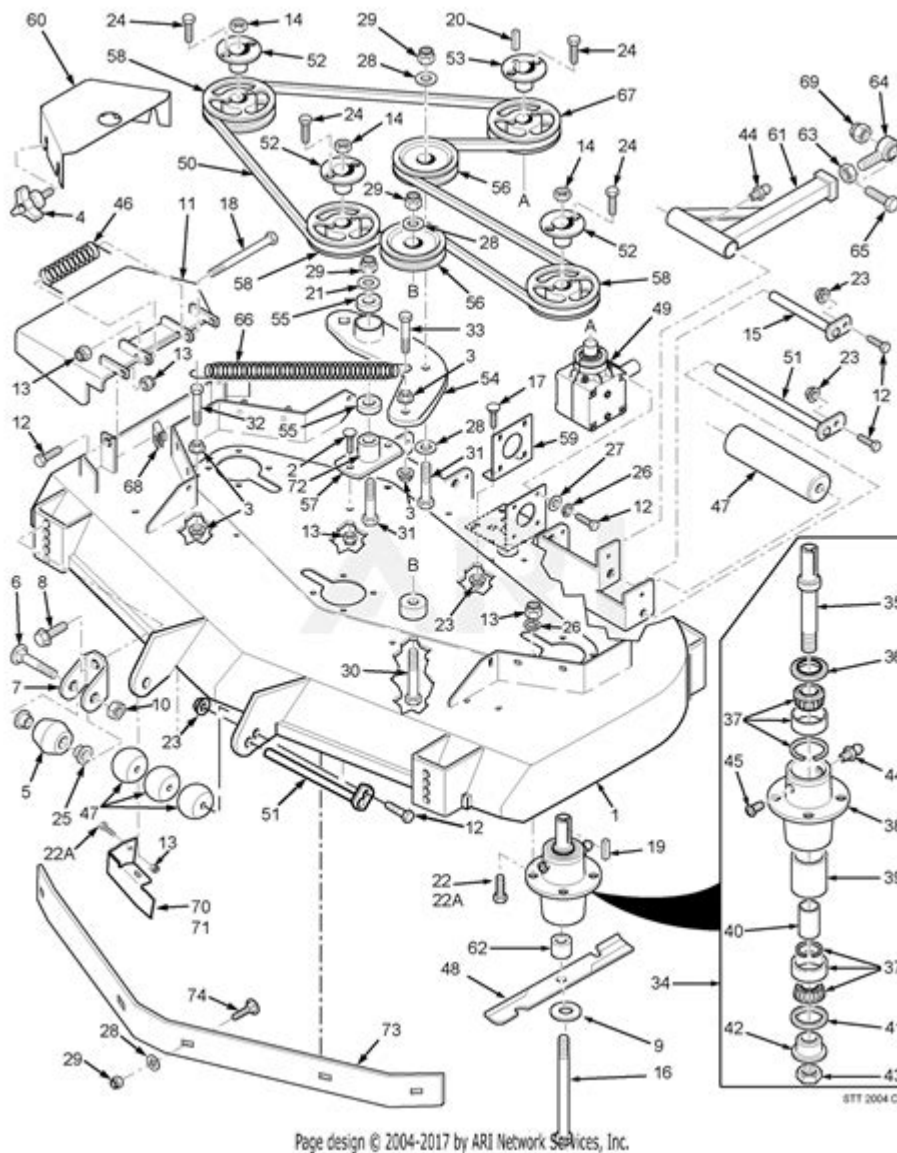

**Scag Turf Tiger drive belt diagram** is an essential topic for anyone who owns or maintains a Scag Turf Tiger lawn mower. This powerful commercial mower is known for its reliability and efficiency, making it a popular choice among landscaping professionals and homeowners alike. Understanding the drive belt system is vital for proper maintenance, troubleshooting, and ensuring optimal performance. This article will delve into the importance of the drive belt, the layout of the drive belt diagram, and tips for maintenance and troubleshooting.

## The Importance of the Drive Belt in a Scag Turf Tiger Mower

The drive belt is a critical component of the Scag Turf Tiger mower, as it

transmits power from the engine to the wheels and cutting deck. A well-functioning drive belt ensures that the mower operates smoothly and efficiently, allowing for a clean and even cut. Here are some key reasons why the drive belt is important:

- **Power Transmission:** The drive belt connects the engine to the wheels and blades, allowing the mower to move and cut grass effectively.
- **Durability:** A high-quality drive belt can withstand the rigors of commercial mowing, providing reliable service over an extended period.
- **Maintenance:** Regular inspection and maintenance of the drive belt can prevent premature wear and potential breakdowns, ensuring that the mower remains in optimal condition.

## Understanding the Drive Belt Diagram

The drive belt diagram is a visual representation of how the various components of the mower are connected by the drive belt. It serves as a guide for assembly, disassembly, and troubleshooting. The diagram typically includes:

- **Belt routing:** Shows the path the belt takes around pulleys and other components.
- **Pulley locations:** Indicates where each pulley is positioned relative to the engine and blades.
- **Adjustment points:** Highlights areas where belt tension can be adjusted.

## Components of the Drive Belt System

To better understand the drive belt diagram, it's essential to know the different components involved in the system. Below are the main parts that work together with the drive belt:

1. **Engine:** The power source of the mower, which drives the entire system.
2. **Pulleys:** These are circular components that guide the drive belt and transfer power from the engine to the blades and wheels.
3. **Idler Pulley:** This pulley helps maintain tension on the belt, ensuring it does not slip off during operation.
4. **Drive Belt:** The belt itself, which connects the engine to the pulleys

and facilitates power transfer.

5. **Deck Belt:** A separate belt that drives the cutting blades, often sharing some components with the drive belt system.

## Deciphering the Drive Belt Diagram

When looking at a Scag Turf Tiger drive belt diagram, you will notice several key features:

1. **Belt Routing:** The diagram will show the path the drive belt takes. It is essential to follow this routing when replacing or adjusting the belt to ensure proper functionality.
2. **Pulleys and their Positions:** Each pulley will be labeled, often indicating whether it is a drive pulley, idler pulley, or blade pulley.
3. **Tension Adjustment Points:** Look for markings that indicate where adjustments can be made to maintain proper belt tension.

## Common Issues with the Drive Belt

Understanding potential issues with the drive belt is crucial for effective maintenance. Here are some common problems that may arise:

- **Wear and Tear:** Over time, drive belts can become worn, leading to reduced performance or failure.
- **Incorrect Tension:** A belt that is too loose can slip, while a belt that is too tight can cause premature wear on the pulleys.
- **Misalignment:** If the pulleys are not aligned correctly, it can cause the drive belt to wear unevenly or break.
- **Environmental Factors:** Debris, moisture, and extreme temperatures can all affect the life span of the drive belt.

## Maintenance Tips for the Drive Belt

Proper maintenance of the drive belt is essential to ensure the longevity and efficiency of your Scag Turf Tiger mower. Here are some tips for maintaining the drive belt:

## **Regular Inspections**

Inspect the drive belt regularly for signs of wear, such as fraying, cracking, or glazing. It's advisable to check the belt every few uses or at the beginning of each mowing season.

## **Check Belt Tension**

Make sure the belt tension is adjusted according to the manufacturer's specifications. A belt that is too loose may slip, while one that's too tight can cause damage to the pulleys and the belt itself.

## **Clean the Mower**

Keep the mower clean, especially around the drive belt and pulleys. Debris and grass clippings can interfere with the operation of the belt, causing it to wear out faster.

## **Replace Worn Components**

If you notice any signs of wear on the drive belt or pulleys during your inspections, replace them immediately to prevent further damage to the mower.

## **Troubleshooting Drive Belt Problems**

If you encounter issues with your Scag Turf Tiger drive belt, here are some troubleshooting steps you can take:

### **Step 1: Check for Visible Damage**

Look for any visible signs of damage on the drive belt, such as cracks or fraying. If you find any, it's time to replace the belt.

### **Step 2: Inspect Pulleys and Idlers**

Check the pulleys and idler for any signs of wear or misalignment. Ensure that they are free of debris and rotating smoothly.

## **Step 3: Verify Tension**

Use a tension gauge to verify that the drive belt is within the specified tension range. Adjust as necessary.

## **Step 4: Consult the Diagram**

Use the drive belt diagram as a reference to ensure that everything is assembled correctly. If the routing is incorrect, it can lead to further issues.

## **Conclusion**

Understanding the Scag Turf Tiger drive belt diagram is crucial for anyone looking to maintain or troubleshoot their mower. By familiarizing yourself with the drive belt system, its components, and common issues, you can ensure your mower operates at peak efficiency. Regular inspections, proper maintenance, and timely replacements will help extend the life of your mower and keep it performing at its best. Whether you're a professional landscaper or a homeowner, knowledge of your mower's drive belt system is invaluable for achieving a pristine lawn.

## **Frequently Asked Questions**

### **What is a drive belt diagram for a Scag Turf Tiger?**

A drive belt diagram for a Scag Turf Tiger is a visual representation that illustrates the routing and configuration of the drive belts in the mower, helping users understand how to install or replace them correctly.

### **Where can I find the drive belt diagram for my Scag Turf Tiger model?**

You can find the drive belt diagram in the owner's manual of your Scag Turf Tiger, on the Scag website, or by contacting an authorized Scag dealer.

### **How often should I check the drive belt on my Scag Turf Tiger?**

It's recommended to check the drive belt on your Scag Turf Tiger at least once a season or after every 50 hours of operation for signs of wear or damage.

## What are common issues that can arise with the drive belt on a Scag Turf Tiger?

Common issues include belt slippage, cracks or fraying of the belt, and misalignment, which can lead to reduced performance or mower failure.

## Can I replace the drive belt on my Scag Turf Tiger myself?

Yes, you can replace the drive belt on your Scag Turf Tiger yourself if you have the proper tools and follow the drive belt diagram for guidance, but it's important to ensure safety precautions are taken.

## What tools do I need to replace the drive belt on a Scag Turf Tiger?

You will typically need basic hand tools such as wrenches, sockets, and possibly a belt tension gauge, along with the drive belt diagram to assist in the replacement process.

## Are there any specific maintenance tips for the drive belt on a Scag Turf Tiger?

Yes, regular cleaning of the belt area, checking for debris, maintaining proper tension, and lubricating pulley bearings can help extend the life of the drive belt.

Find other PDF article:

<https://soc.up.edu.ph/40-trend/files?trackid=SMw85-5062&title=maths-for-middle-school-students.pdf>

## [Scag Turf Tiger Drive Belt Diagram](#)

**nsfw.monster**

nsfw.monster

*Reddit - Dive into anything*

We would like to show you a description here but the site won't allow us.

*Monster Fuckers - Reddit*

r/MonsterFucker: As the title say, monsterfucker here, Dragon, orc, ghost, slime, Eldrich Kraken, minotaure, ...

[Monster Ambassador \(Version 2.14\) - Newgrounds.com](#)

Jul 22, 2021 · Monsters of all shapes and sizes dwell across the land! Who will you find in the forests? The ...

### **Pleasure Monsters V0.1 - Newgrounds.com**

Aug 6, 2019 · In the Land of Mysteria, pleasure is the only currency that society is interested in. Will you take ...

#### Redes PAN: ¿Qué son? Características, ventajas y desventajas

Las redes de área personal (PAN) son redes inalámbricas, se basan en tecnologías como Bluetooth, Wi-Fi Direct o Near Field Communication (NFC). En una red PAN, los dispositivos ...

#### ¿Qué es una red de área personal (PAN)? | Cloudflare

Una red de área personal (PAN) conecta dispositivos dentro del área inmediata de un usuario. Descubre el funcionamiento de las redes PAN y compáralas con otros tipos de redes.

#### *Guía sobre Redes PAN: Qué son, como funcionan y para que sirven*

Las Redes PAN (Personal Area Network) conectan dispositivos personales como teléfonos, tablets y ordenadores. Se basan en tecnologías inalámbricas como Bluetooth y WiFi Direct. ...

### **Tipos de Redes LAN, WAN, MAN, PAN: Diferencias Clave**

La definición de las redes PAN (Personal Area Networks - Redes de área personal) es la más moderna de todas e incluye aquella red de comunicaciones de datos que abarcan el espacio ...

#### *Red PAN (red de área personal) - Qué es, concepto y definición*

Una red PAN (del inglés Personal Area Network) o Red de Área Personal es un protocolo de red para establecer conexión entre dispositivos de poco alcance orientado al uso personal, es ...

#### Definición de PAN (Personal Area Network - Red de Área ...

Jun 25, 2025 · Una Red de Área Personal (PAN) es una red informática que conecta dispositivos centrados en el espacio personal de un usuario. Permite la comunicación, sincronización y ...

#### *¿Qué es una red pan? - PcHardwarePro*

Una red de área personal (PAN) es una red de dispositivos que están conectados entre sí para compartir datos y recursos. Estos dispositivos suelen ser de una sola persona y su propósito ...

### **Pan red informática: qué es, ventajas y cómo implementarla**

En el entorno de la informática, existen diferentes tipos de redes que nos permiten compartir información y recursos entre dispositivos conectados. Una de estas redes es la PAN ...

#### *Tipos de redes BAN, PAN, LAN, CAM, MAN Y WAN (3); ¿Qué es una red PAN?*

Las PAN son redes pequeñas y privadas que están diseñadas para conectar dispositivos personales en un área reducida, generalmente dentro de un rango de 10 metros.

#### *Las diferencias entre una red PAN, LAN, WAN y MAN: todo lo que ...*

Mientras que una red PAN se utiliza para conectar dispositivos personales cercanos, una red LAN permite la conexión de dispositivos en un área limitada, una red WAN abarca grandes ...

Discover the Scag Turf Tiger drive belt diagram for easy maintenance and repairs. Ensure optimal performance of your mower. Learn more to keep your equipment running smoothly!

[Back to Home](#)