

Schlage Lock Parts Diagram

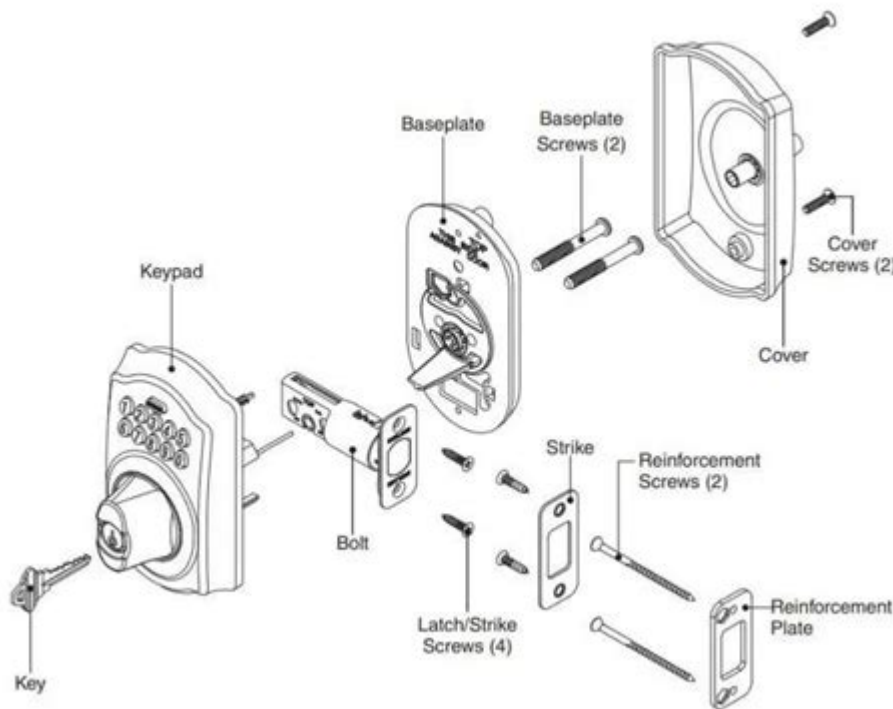

Schlage lock parts diagram is an essential resource for anyone looking to understand the intricacies of Schlage locks, their mechanisms, and how they function. Schlage is a reputable brand known for its high-quality locks and security products, and being familiar with the parts that make up these locks is crucial for installation, repair, or maintenance tasks. This article will delve into the various components of Schlage locks, their functions, and how they work together to provide reliable security.

Understanding Schlage Locks

Schlage locks are designed to offer a blend of durability, security, and aesthetic appeal. They come in various styles, including deadbolts, knob locks, lever locks, and smart locks. Each type has its own set of components, but many of the essential parts are common across different models. Understanding these components can help homeowners and professionals alike in their quest to maintain or upgrade their home security systems.

Types of Schlage Locks

1. Deadbolts:
 - Single Cylinder
 - Double Cylinder

- Keyless Deadbolts

2. Knob Locks:

- Entry Knobs
- Privacy Knobs
- Dummy Knobs

3. Lever Locks:

- Entry Levers
- Privacy Levers
- Dummy Levers

4. Smart Locks:

- Bluetooth Enabled
- Wi-Fi Enabled

Each type of lock has its own unique parts, but the underlying technology often shares several components.

Key Components of Schlage Locks

A Schlage lock parts diagram typically illustrates the following components, which work together to ensure the lock functions properly.

1. Cylinder

The cylinder is the heart of the lock. It is what the key interacts with to unlock or lock the door.

- Keyway: The part of the cylinder where the key is inserted.
- Pins: These are small metal pieces that move up and down when the correct key is inserted, allowing the cylinder to turn.
- Spring: Each pin is paired with a spring that pushes the pin back down into the cylinder when the key is removed.

2. Bolt Mechanism

The bolt is the part that physically secures the door.

- Deadbolt: In a deadbolt, the bolt extends into the door frame when locked, providing additional security.
- Spring Bolt: In a standard knob or lever lock, the bolt is spring-loaded and retracts when the knob or lever is turned.

3. Housing

The housing encloses the internal mechanisms of the lock.

- Exterior Housing: The outer part of the lock that is visible from outside the door.
- Interior Housing: The part of the lock that is visible from inside the house and houses the turn mechanism.

4. Trim Plates and Escutcheons

These components are designed for aesthetic purposes and to cover the mounting hardware.

- Trim Plate: Found on the exterior side of the door, it adds a finished look.
- Escutcheon: A decorative plate that surrounds the keyhole, providing a polished appearance.

5. Strike Plate

The strike plate is installed on the door frame and receives the bolt when the door is locked.

- Reinforcement: Some strike plates come with reinforced materials to withstand forceful entry.

6. Key

The key is the external component that interacts with the lock.

- **Shape and Size: Each Schlage lock has a specific key shape and size that corresponds to its cylinder.**

Common Issues and Troubleshooting

Understanding the Schlage lock parts diagram can also help in identifying common issues that may

arise with these locks. Here are some problems and their solutions:

1. Lock Won't Turn

- Possible Causes: Dirty or worn-out cylinder, broken key.
- Solutions: Clean the cylinder with graphite powder or replace the key.

2. Key Gets Stuck

- Possible Causes: Debris in the keyway, damaged pins.
- Solutions: Use compressed air to clean out the keyway or replace the lock if the pins are damaged.

3. Bolt Sticking

- Possible Causes: Misalignment or lack of lubrication.
- Solutions: Check alignment with the strike plate and lubricate the bolt mechanism with a silicone or graphite-based lubricant.

4. Exterior Housing Damage

- Possible Causes: Attempted break-in or wear and tear.
- Solutions: Replace the exterior housing if it is damaged beyond repair.

Installation and Maintenance Tips

Proper installation and regular maintenance can

extend the life of your Schlage lock. Here are some tips to keep in mind:

Installation Steps

1. **Gather Tools:** Ensure you have a screwdriver, measuring tape, and the lock installation kit.
2. **Prepare the Door:** If you're replacing a lock, remove the old hardware. If it's a new installation, drill the necessary holes according to the lock's specifications.
3. **Insert the Cylinder:** Place the cylinder into the door and secure it with the screws provided.
4. **Attach the Bolt:** Install the bolt mechanism and ensure it operates smoothly.
5. **Set the Trim Plate and Escutcheon:** Affix the trim plate and escutcheon to the exterior of the door.
6. **Test the Lock:** Use the key to ensure the lock operates smoothly before completing the installation.

Regular Maintenance

- **Lubricate:** Regularly lubricate the cylinder and bolt mechanism to keep them functioning smoothly.
- **Inspect:** Periodically inspect the lock for signs of wear, such as loose screws or damaged components.
- **Clean:** Keep the keyway clean from debris to prevent key sticking.

Conclusion

A Schlage lock parts diagram is a valuable tool for anyone looking to understand the components of Schlage locks, troubleshoot issues, or perform installations. By familiarizing yourself with the various parts and how they work together, you can effectively maintain and enhance your home security. Whether you're a homeowner or a professional locksmith, understanding these components is crucial in ensuring that your Schlage locks provide the security and reliability they are known for. With proper care and knowledge, you can enjoy the peace of mind that comes with a well-functioning lock system.

Frequently Asked Questions

What is a Schlage lock parts diagram?

A Schlage lock parts diagram is a visual representation that illustrates the various components of a Schlage lock, including the cylinder, latch, strike plate, and other essential parts.

Where can I find a Schlage lock parts diagram?

You can find a Schlage lock parts diagram on the official Schlage website, in the installation instructions provided with the lock, or through various hardware and home improvement retailers.

Why is it important to have a Schlage lock parts diagram?

Having a Schlage lock parts diagram is important for understanding the assembly and disassembly of the lock, which aids in maintenance, repairs, and troubleshooting issues.

How do I read a Schlage lock parts diagram?

To read a Schlage lock parts diagram, identify the labeled parts and their corresponding numbers or letters on the diagram, which correspond to descriptions in the accompanying text or legend.

Can I order replacement parts using a Schlage lock parts diagram?

Yes, you can use a Schlage lock parts diagram to identify the specific parts you need and order replacements through the Schlage website, authorized dealers, or hardware stores.

Are Schlage lock parts diagrams available for all models?

Most Schlage lock models have associated parts diagrams, but availability may vary. It's best to check the specific model's documentation or the Schlage website for the correct diagram.

What should I do if I lose my Schlage lock parts diagram?

If you lose your Schlage lock parts diagram, you can typically download a new copy from the Schlage website, contact customer service for assistance, or check with your local hardware store.

Do Schlage lock parts diagrams include installation instructions?

Many Schlage lock parts diagrams are included with installation instructions, providing step-by-step guidance on how to correctly install and assemble the lock parts.

Find other PDF article:

<https://soc.up.edu.ph/11-plot/files?trackid=HnZ47-4027&title=casamba-sample-documentation-for-occupational-therapy.pdf>

Schlage Lock Parts Diagram

Converting Schlage Encode Plus to Kwikset keys. :
r/Locksmith

Apr 14, 2024 · Re-assemble Schlage encode plus and enjoy your matching Kwikset keys around your home. I recommend you watch the YouTube video link above to get visuals of someone ...

Help with deciding on which Smart Lock to buy? Yale, Schlage

Feb 3, 2022 · I have the schlage connect (same thing as the encode but zwave instead of wifi). I have been very happy with it. I bought it because it was the only ANSI grade 1 smart lock that ...

Schlage Encode WiFi Solved : r/homeassistant -

Reddit

Feb 28, 2023 · Y'all, I'm so stoked right now. I've been looking for a way to get my preexisting Schlage Encode WiFi locks into Home Assistant and saw this post saying that there is a ...

Locksmith told me Schlage is bad? : r/Locksmith - Reddit

Jun 26, 2023 · Schlage has multiple product lines. All manufactures selling DIY products at big box stores cut quality to lower cost. Big difference between schlage B60, and B560, B660. ...

Changing the orientation of the lock button on knob : r/Locksmith ...

Jul 16, 2022 · I am installing new locks in our house and on the locks we bought, the locking button on the handle goes horizontal to lock and vertical to unlock. However both my wife and ...

Home app: multiple users and privileges, questions on Schlage

Aug 31, 2022 · I recently bought a Schlage Encode Plus and it's my first foray into Apple's Home app and HomeKit, other than the Apple TV. As a total newbie I just want to ask a few ...

What is the difference between a Kwikset and a Schlage key and ...

Aug 4, 2018 · The grooves cut along the blade of the key (called warding) are different from one another. Typically all lock manufacturers use a different warding pattern, meaning key blanks ...

Issues with Schlage keypad deadbolts (BE365)...any one else?

Jan 2, 2022 · Issues with Schlage keypad deadbolts (BE365)...any one else? I purchased two Schlage BE365 deadbolts, brand new and each at a different time and they both have the ...

Aqara U100 or Schlage Encode Plus? : r/HomeKit - Reddit

Jun 20, 2023 · I am looking to replace an old August Smart Lock Pro + Connect with a new HomeKit-friendly smart lock. I've narrowed it down to the Aqara U100 or the Schlage Encode ...

Kwikset vs. Schlage - The Great Debate : r/Locksmith - Reddit

Jun 29, 2017 · Schlage's deadbolts come with brass cylinders if you don't buy them from cheapo-depot. Use the longest wood screws you can find to make the door harder to kick in. ...

Converting Schlage Encode Plus to Kwikset keys. : r/Locksmith

Apr 14, 2024 · Re-assemble Schlage encode plus and enjoy your matching Kwikset keys around your home. I recommend you watch the YouTube ...

Help with deciding on which Smart Lock to buy? Yale, Schla...

Feb 3, 2022 · I have the schlage connect (same thing as the encode but zwave instead of wifi). I have been very happy with it. I bought it because it was the ...

**Schlage Encode WiFi Solved : r/homeassistant -
Reddit**

Feb 28, 2023 · Y'all, I'm so stoked right now. I've been looking for a way to get my preexisting Schlage Encode WiFi locks into Home Assistant and saw ...

**Locksmith told me Schlage is bad? : r/Locksmith -
Reddit**

Jun 26, 2023 · Schlage has multiple product lines. All manufactures selling DIY products at big box stores cut quality to lower cost. Big difference ...

**Changing the orientation of the lock button on knob
: r/Locks...**

Jul 16, 2022 · I am installing new locks in our house and on the locks we bought, the locking button on the handle goes horizontal to lock and vertical to ...

Explore our detailed Schlage lock parts diagram to understand your lock's components better. Learn more about installation and maintenance tips today!

[Back to Home](#)