

Savage Rifle Parts Diagram

Savage
Models 24V, 24V-A
Over-Under Rifle/Shotguns

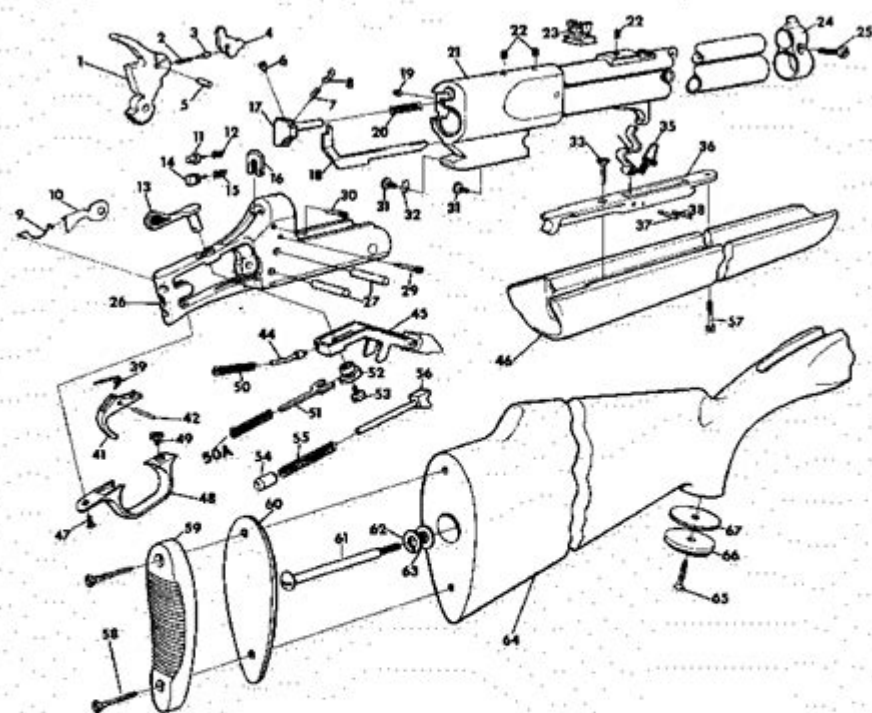

- | | | |
|-----------------------------------|---|--------------------------------|
| 1 Hammer Assembly | 21 Barrel | 46 Fore-end |
| 2 Selector Plunger Spring | 22 Dummy Screws (3) | 47 Trigger Guard Screw |
| 3 Selector Plunger | 23 Rear Sight | 48 Trigger Guard |
| 4 Selector | 24 Barrel Band and Front Sight | 49 Trigger Guard Screw (Front) |
| 5 Selector Pin | 25 Barrel Band Screw | 50 Locking Bolt Plunger Spring |
| 6 Extractor Plunger Screw | 26 Frame | 50A Top Snap Plunger Spring |
| 7 Extractor Plunger Spring | 27 Hammer and Locking Bolt Pins | 51 Top Snap Plunger |
| 8 Extractor Plunger (222 Caliber) | 29 Firing Pin Retaining Screw | 52 Top Snap Sleeve |
| 9 Yoke Stop Spring | 30 Firing Pin Retaining Plate Screw | 53 Top Snap Screw |
| 10 Yoke Stop | 31 Extractor Lever Retaining Screws (2) | 54 Mainspring Plunger Seat |
| 11 Firing Pin (Rifle) | 32 Extractor Lever Guide | 55 Mainspring |
| 12 Firing Pin Spring (Rifle) | 33 Fore-end Iron Screw | 56 Mainspring Plunger |
| 13 Top Snap | 34 Fore-end Spring | 57 Fore-end Screw |
| 14 Firing Pin (Shotgun) | 35 Fore-end Spring Spring | 58 Buttplate Screws (2) |
| 15 Firing Pin Spring (Shotgun) | 36 Fore-end Iron | 59 Buttplate |
| 16 Firing Pin Retaining Plate | 37 Fore-end Spring Pin | 60 Buttplate Liner |
| 17 Extractor Plate (222 Caliber) | 38 Fore-end Spring Spring Pin | 61 Stock Bolt |
| 18 Extractor Lever | 39 Trigger Spring | 62 Stock Bolt Lock Washer |
| 19 Extractor Screw | 41 Trigger | 63 Stock Bolt Washer |
| 20 Extractor Spring | 42 Trigger Pin | 64 Stock |
| | 44 Locking Bolt Plunger | 65 Pistol Grip Cap Screw |
| | 45 Locking Bolt Assembly | 66 Pistol Grip Cap |
| | | 67 Pistol Grip Cap Liner |

Savage rifle parts diagram serves as a crucial resource for gun enthusiasts, hobbyists, and gunsmiths alike. Understanding the components of a Savage rifle is essential for maintenance, repairs, and customization. Savage Arms has been recognized for producing reliable and accurate firearms since the late 19th century. Their rifles are popular among hunters, competitive shooters, and collectors, making it important to have a clear understanding of the parts that make up these fine firearms. In this article, we will explore the different components of a Savage rifle, their functions, and how they interact with one another, as well as the importance of having a parts diagram for repairs and maintenance.

Overview of Savage Rifles

Savage Arms produces a variety of rifles that cater to different needs and preferences. The most notable models include:

1. Savage 110: A versatile bolt-action rifle available in numerous calibers.
2. Savage Axis: A budget-friendly alternative that maintains quality and accuracy.
3. Savage Model 10: Known for its precision and tailored for tactical shooters.
4. Savage Model 12: Designed for varmint and predator hunting.

Each of these models has a unique configuration and various components that function together to ensure performance.

Importance of a Parts Diagram

A Savage rifle parts diagram is invaluable for several reasons:

- Identification: It helps identify each component of the rifle, which is essential for understanding its operation.
- Repairs: When a part fails or is damaged, having a diagram assists in locating the issue and determining the necessary replacement parts.
- Customization: For those looking to upgrade or customize their rifles, a parts diagram provides insight into which components can be modified or replaced.
- Maintenance: Regular maintenance is crucial for firearm longevity and performance. A parts diagram aids in understanding how to disassemble and reassemble the rifle correctly.

Main Components of a Savage Rifle

A Savage rifle consists of several key components, each playing a vital role in the firearm's operation. Below, we will break down these components into their respective categories.

Action

The action is the heart of any firearm. In Savage rifles, the action is typically a bolt-action mechanism, which includes:

- Bolt: The part that locks the cartridge into the chamber and is cycled to eject spent casings and load new rounds.
- Bolt Handle: The lever attached to the bolt that allows the shooter to operate the action.
- Receiver: The housing that holds the bolt and other internal components. It also serves as the attachment point for the stock and barrel.

Barrel

The barrel is where the bullet travels after firing, and its quality directly affects accuracy. Key features include:

- Chamber: The portion of the barrel that holds the cartridge before it is fired.
- Rifling: The grooves inside the barrel that spin the bullet for improved stability and accuracy.

Stock

The stock is the part of the rifle that the shooter holds. It provides stability and comfort during shooting.

Important features include:

- Pistol Grip: The portion of the stock that the shooter holds with their dominant hand.
- Forend: The front part of the stock that provides support and stability when aiming.
- Buttstock: The rear portion that rests against the shooter's shoulder.

Trigger Mechanism

The trigger mechanism is responsible for firing the rifle. It consists of several parts, such as:

- Trigger: The part that the shooter pulls to release the firing mechanism.
- Sear: A component that holds the firing pin in place until the trigger is pulled.
- Firing Pin: The part that strikes the primer of the cartridge, igniting the powder and firing the bullet.

Magazine

The magazine is where ammunition is stored and fed into the chamber. Types of magazines include:

- Detachable Magazine: Allows for quick reloading and can be removed from the rifle.
- Internal Magazine: Built into the rifle, requiring the shooter to load rounds directly into the action.

Safety Mechanism

The safety mechanism is a critical component for firearm safety. It prevents accidental discharges and includes:

- Safety Lever: A switch that blocks the trigger or firing mechanism when engaged.

- Indicator: Some models feature a visual indicator to show whether the rifle is in a safe or fire position.

Exploring the Savage Rifle Parts Diagram

A typical Savage rifle parts diagram provides a visual representation of the firearm's components. This diagram often labels each part clearly, allowing users to easily identify and understand the function of each component. Here are some common elements you might find in a parts diagram:

- Exploded View: Shows the rifle in an exploded format, illustrating how each component fits together.
- Part Numbers: Each component is often assigned a unique number for easy reference when ordering replacements.
- Description: Brief descriptions of each part's function may accompany the diagram for clarity.

Common Issues and Troubleshooting

Having a parts diagram at hand can significantly assist in troubleshooting common issues that may arise with Savage rifles. Some frequent problems include:

1. Failure to Feed: This can result from a dirty magazine or a worn-out feed lip. Inspect the magazine and clean it thoroughly.
2. Misfires: Often caused by a faulty firing pin or primer. Check the firing mechanism and replace any defective parts.
3. Accuracy Issues: This may stem from a dirty barrel or misaligned sights. Regular cleaning and proper sight alignment can help.

Conclusion

Understanding the components of a Savage rifle through a well-illustrated parts diagram is essential for effective maintenance, troubleshooting, and customization. Whether you are a seasoned gunsmith or a novice shooter, having this knowledge will empower you to take better care of your firearm. Regular maintenance, familiarity with the parts, and awareness of common issues will ensure that your Savage rifle remains a reliable companion for years to come. Investing time in learning about your rifle's parts will enhance your shooting experience and ensure you are always prepared for your next outing, whether it's hunting in the field or refining your skills at the range.

Frequently Asked Questions

What are the main components of a Savage rifle as depicted in the parts diagram?

The main components typically include the barrel, action, stock, trigger assembly, magazine, bolt assembly, and recoil pad.

How can I use a Savage rifle parts diagram for maintenance?

You can use the diagram to identify parts for cleaning, lubrication, and replacement, ensuring that you focus on the critical areas that require attention.

Where can I find a detailed Savage rifle parts diagram?

You can find detailed parts diagrams on the official Savage Arms website, in the owner's manual, or through authorized dealers and gunsmiths.

What is the purpose of the recoil pad in a Savage rifle parts diagram?

The recoil pad helps to absorb the shock from the rifle's recoil when fired, improving comfort and

stability for the shooter.

Are parts from different Savage rifle models interchangeable?

Not all parts are interchangeable; it's essential to refer to the specific parts diagram for your model to ensure compatibility.

Can I download a Savage rifle parts diagram for my personal use?

Yes, many websites provide downloadable PDF versions of Savage rifle parts diagrams for personal use and reference.

What tools are recommended for assembling or disassembling parts shown in the Savage rifle parts diagram?

Common tools include screwdrivers, wrenches, punches, and a torque wrench, depending on the specific parts and assembly requirements.

Find other PDF article:

<https://soc.up.edu.ph/22-check/Book?trackid=Kjv30-3735&title=fishing-basics-the-complete-illustrated.pdf>

[Savage Rifle Parts Diagram](#)

Savage Arms | Firearms, Rifles, Shotguns, Handguns

Savage Arms has been building firearms since 1894. Our rifles, shotguns and handguns are accurate, dependable and loaded with innovations for high performance.

Mounting a Scope to Your Savage REVEL

Mar 17, 2025 · Follow along with this step-by-step guide on how to properly mount and secure a scope to your Savage REVEL lever action rifle!

Rimfire | Hunting, Target, Competition | Savage Arms

Explore Savage's extensive rimfire rifle lineup in bolt action and semi-auto for plinking, hunting, and competition. Available in .22 LR, .17 HMR, and more.

Firearms | Explore All Savage Firearms | Savage Arms

Explore all Savage Arms firearms by type, usage, model name, and more. Find the ideal Savage

firearm purpose-built for your hunting and shooting needs.

Mark I and Mark II | Bolt Action 22 LR | Savage Arms

At Savage, bolt-action rifles are in our DNA. We know what it takes to build a truly reliable bolt gun, and we put all of it into our trusted Mark I and Mark II Series.

Firearms | Centerfire, Handgun, Rimfire, Shotgun | Savage

Explore the full range of Savage firearms by type, including centerfire, handgun, rimfire, and shotgun. Find the perfect Savage firearm for your needs today.

Revel | Modern Rimfire Lever Action Rifle | Savage Arms

The Savage Revel is a modern rimfire lever action rifle with a walnut stock, oversized finger loop. Ideal for small game or plinking with easy takedown..

17 WSM | Browse All Rimfire 17 WSM Rifles | Savage Arms

Explore our full lineup of Savage 17 WSM rifles, designed for rimfire accuracy, reliability, and performance. Hunt and shoot with precision and confidence.

Shotguns | Hunting, Competition, Tactical | Savage Arms

Savage offers shotguns for every need—hunting, competition, or tactical. From semi-auto and bolt action to pump and break action, Savage has a shotgun for you.

US and International Product Catalog - Savage Arms

Browse the latest Savage Arms Catalog for our newest firearms and accessories and their product specifications. US and International versions available.

Savage Arms | Firearms, Rifles, Shotguns, Handguns

Savage Arms has been building firearms since 1894. Our rifles, shotguns and handguns are accurate, dependable and loaded with innovations for high performance.

Mounting a Scope to Your Savage REVEL

Mar 17, 2025 · Follow along with this step-by-step guide on how to properly mount and secure a scope to your Savage REVEL lever action rifle!

Rimfire | Hunting, Target, Competition | Savage Arms

Explore Savage's extensive rimfire rifle lineup in bolt action and semi-auto for plinking, hunting, and competition. Available in .22 LR, .17 HMR, and more.

Firearms | Explore All Savage Firearms | Savage Arms

Explore all Savage Arms firearms by type, usage, model name, and more. Find the ideal Savage firearm purpose-built for your hunting and shooting needs.

Mark I and Mark II | Bolt Action 22 LR | Savage Arms

At Savage, bolt-action rifles are in our DNA. We know what it takes to build a truly reliable bolt gun, and we put all of it into our trusted Mark I and Mark II Series.

Firearms | Centerfire, Handgun, Rimfire, Shotgun | Savage

Explore the full range of Savage firearms by type, including centerfire, handgun, rimfire, and shotgun. Find the perfect Savage firearm for your needs today.

Revel | Modern Rimfire Lever Action Rifle | Savage Arms

The Savage Revel is a modern rimfire lever action rifle with a walnut stock, oversized finger loop. Ideal for small game or plinking with easy takedown..

17 WSM | Browse All Rimfire 17 WSM Rifles | Savage Arms

Explore our full lineup of Savage 17 WSM rifles, designed for rimfire accuracy, reliability, and performance. Hunt and shoot with precision and confidence.

Shotguns | Hunting, Competition, Tactical | Savage Arms

Savage offers shotguns for every need—hunting, competition, or tactical. From semi-auto and bolt action to pump and break action, Savage has a shotgun for you.

US and International Product Catalog - Savage Arms

Browse the latest Savage Arms Catalog for our newest firearms and accessories and their product specifications. US and International versions available.

Explore our comprehensive guide on the Savage rifle parts diagram. Understand your firearm better and enhance your shooting experience. Learn more now!

[Back to Home](#)