

Ruud Furnace Parts Diagram

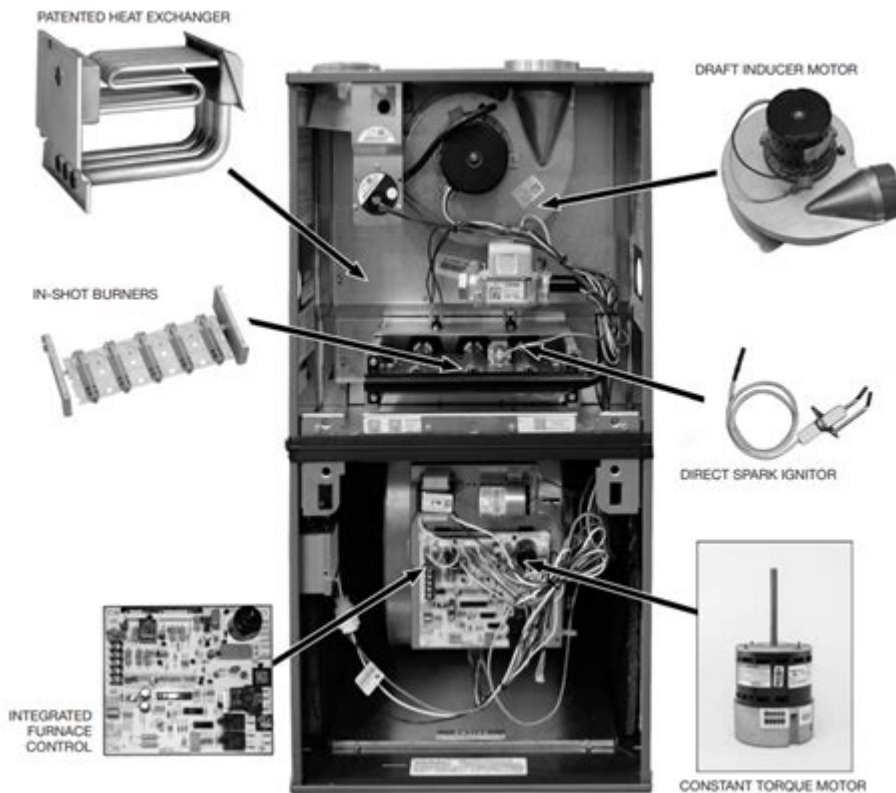

Ruud furnace parts diagram is an essential tool for homeowners and technicians alike when it comes to understanding the inner workings of Ruud furnaces. These diagrams provide a visual representation of the various components, helping users identify parts for maintenance, troubleshooting, and repairs. In this article, we will explore the various parts of a Ruud furnace, their functions, and how they work together to provide efficient heating to your home.

Understanding the Basics of Ruud Furnaces

Ruud furnaces are known for their durability and efficiency in residential heating. They feature advanced technology and design that enhance performance and energy savings. However, like any mechanical system, they can experience issues that require attention. Familiarizing yourself with the parts of your Ruud furnace can empower you to maintain it better and understand potential problems.

Key Components of a Ruud Furnace

A typical Ruud furnace consists of several critical parts, each playing a significant role in the overall operation. Below are the main components

commonly found in a Ruud furnace:

1. Burner Assembly: Responsible for igniting the gas and producing heat.
2. Heat Exchanger: Transfers heat from the combustion process to the air that circulates through your home.
3. Blower Motor: Powers the blower fan that circulates warm air throughout your living space.
4. Control Board: Acts as the brain of the furnace, managing all operations and safety functions.
5. Thermostat: Measures the temperature in your home and signals the furnace to turn on or off as needed.
6. Flue Pipe: Expels exhaust gases outside the home.
7. Filter: Cleans the air entering the furnace, preventing dust and debris from accumulating in the system.
8. Inducer Motor: Helps expel combustion gases from the furnace to ensure efficient operation.

The Importance of the Ruud Furnace Parts Diagram

A Ruud furnace parts diagram serves several purposes:

- Identification: It allows homeowners and technicians to identify specific parts quickly and accurately.
- Maintenance: Understanding where each component is located can simplify routine maintenance tasks like filter changes or cleaning.
- Troubleshooting: If your furnace is malfunctioning, knowing the layout can help you pinpoint the issue more effectively.
- Repair: A diagram provides a reference for the correct positioning and installation of parts during repairs or replacements.

How to Read a Ruud Furnace Parts Diagram

Reading a Ruud furnace parts diagram may seem daunting at first, but it becomes easier with practice. Here are the steps to help you interpret the diagram efficiently:

1. Familiarize Yourself with Symbols: The diagram will use specific symbols to represent different components. Make sure to review the legend or key that accompanies the diagram.
2. Locate the Main Sections: Identify major areas on the diagram, such as the combustion chamber, blower assembly, and electrical components.
3. Trace the Flow: Follow the flow of air and gas through the system, noting how each part interacts with others.
4. Highlight Critical Components: Use the diagram to focus on parts that are most relevant to your current needs, whether it's maintenance or

troubleshooting.

Common Ruud Furnace Parts and Their Functions

Understanding each component's function helps in grasping how the entire system operates. Below are some of the common parts found in a Ruud furnace along with their roles:

Burner Assembly

The burner assembly is crucial for the combustion process. Here's what you should know:

- Ignition: The burner assembly includes an ignition system (either a pilot light or electronic ignition) to start the combustion process.
- Burner Tubes: These tubes deliver gas to the burners, where it mixes with air and ignites.
- Safety Features: Many burners come with safety components that shut off gas flow if a malfunction is detected.

Heat Exchanger

The heat exchanger is where the heat from the combustion process is transferred to the air circulating through the home.

- Material: Typically made from high-quality metal that can withstand high temperatures.
- Design: The design may vary, but its efficiency is crucial for heating effectiveness and energy conservation.

Blower Motor and Fan

The blower motor and fan work together to circulate heated air throughout your home.

- Speed Settings: Most modern Ruud furnaces feature variable-speed blower motors for improved efficiency and comfort.
- Maintenance: Regularly checking the blower motor and fan for dust and debris buildup is essential to keep the system operating efficiently.

Control Board

The control board is the heart of the furnace's operation.

- **Functionality:** It controls ignition, blower motor operation, and safety devices.
- **Diagnostic Capabilities:** Many control boards come equipped with diagnostic lights that help identify issues quickly.

Maintenance Tips for Ruud Furnace Parts

To keep your Ruud furnace running smoothly, regular maintenance is essential. Here are some tips to maintain key components:

1. **Replace Filters Regularly:** Change the air filter every 1-3 months, depending on usage, to maintain airflow and efficiency.
2. **Clean the Burner Assembly:** Ensure that the burners are free from debris and that the ignition system is functioning properly.
3. **Inspect the Heat Exchanger:** Look for any signs of wear or cracks, as a damaged heat exchanger can be a significant safety hazard.
4. **Check the Blower Motor:** Ensure the blower motor is operating quietly and efficiently. Clean any dust buildup from the fan blades.
5. **Test the Thermostat:** Ensure the thermostat is calibrated correctly and functioning as intended. Replace batteries if applicable.
6. **Schedule Professional Inspections:** At least once a year, have a professional technician inspect and service your furnace to catch any potential issues early.

Conclusion

A Ruud furnace parts diagram is an invaluable resource for anyone involved in the maintenance or repair of these heating systems. By understanding the various components and their functions, homeowners can take proactive steps to ensure their furnaces operate efficiently and effectively. Regular maintenance and familiarization with the parts will not only extend the life of your furnace but also enhance your comfort during the colder months. Whether you are a homeowner looking to understand your system better or a technician needing a reference, a parts diagram can help demystify the components of your Ruud furnace.

Frequently Asked Questions

What is a Ruud furnace parts diagram used for?

A Ruud furnace parts diagram is used to identify and locate various components within a Ruud furnace, aiding in troubleshooting, repairs, and maintenance.

Where can I find a Ruud furnace parts diagram?

You can find a Ruud furnace parts diagram in the furnace's user manual, on the manufacturer's website, or through HVAC supply stores and online forums.

What are the common parts labeled in a Ruud furnace parts diagram?

Common parts labeled in a Ruud furnace parts diagram include the blower motor, heat exchanger, gas valve, ignitor, and control board.

How can I use a Ruud furnace parts diagram for troubleshooting?

You can use a Ruud furnace parts diagram to identify specific components that may be malfunctioning or require replacement, making it easier to diagnose issues.

Is it safe to replace parts in a Ruud furnace using the parts diagram?

Yes, it is generally safe to replace parts in a Ruud furnace using the parts diagram, but it's important to follow safety precautions and, if unsure, consult a professional technician.

What should I do if the parts diagram is missing?

If the parts diagram is missing, you can contact Ruud customer support, check online resources, or consult an HVAC technician for assistance.

Can I find aftermarket parts that match the Ruud furnace parts diagram?

Yes, many aftermarket suppliers offer compatible parts that match the specifications provided in the Ruud furnace parts diagram, but ensure they meet quality standards.

Find other PDF article:

<https://soc.up.edu/ph/30-read/files?ID=Fct85-5608&title=how-to-find-a-career-that-you-love.pdf>

[Ruud Furnace Parts Diagram](#)

RUUD - MEGAMU Mu Online

Jul 7, 2025 · MEGAMU Mu Online Forum Fórum Dúvidas [Dúvida] RUUD 1 2 3 4 5 ... Usuários visualizando este tópico: 1 Visitante (s)

Ruud - MEGAMU Mu Online

Jul 20, 2020 · Usuários visualizando este tópico: 1 Visitante (s)Subir Lite mode

[TUTORIAL] - DROP SKILL (2023) - MEGAMU Mu Online

Dec 1, 2021 · MEGAMU Mu Online Forum Fórum Tutoriais [TUTORIAL] - DROP SKILL (2023)

skill de ruud - MEGAMU Mu Online

Nov 8, 2024 · [Dúvida] skill de ruud1 2 3 4 5

Box Ruud N funciona - MEGAMU Mu Online

Feb 15, 2025 · MEGAMU Mu Online Forum Nova Geração Sugestões / Correções / Bug Tracking Box Ruud N funciona 1 2 3 4 5 ... Usuários visualizando este tópico: 1 Visitante (s)

MEGAMU Mu Online Forum - Set Ruuds e compra de Rudds

Jun 7, 2021 · To fazendo uma Elf e gostaria de saber quanto custa cada item do Set Ruud dela e se vale apenas comprá-lo e se a set melhores se possível em ordem. Quanto e a conversão de ...

Itens RUUD Ancient - MEGAMU Mu Online

Feb 26, 2022 · Usuários visualizando este tópico: 1 Visitante (s)Contate-nos

MEGAMU Mu Online Forum - skill de ruud

Aug 11, 2024 · Olá, as skill de Ruud funciona como skill normal do jogo, dos seus personagens, elas simplesmente são as melhores da sua classe. A diferença da skill de drop e as básicas ...

Set Ruuds e compra de Rudds - MEGAMU Mu Online

Jul 6, 2021 · Usuários visualizando este tópico: 2 Visitante (s)Subir Lite mode

Box Ruud - MEGAMU Mu Online

Aug 6, 2024 · Usuários visualizando este tópico: 1 Visitante (s)Subir Lite mode Contate-nos

RUUD - MEGAMU Mu Online

Jul 7, 2025 · MEGAMU Mu Online Forum Fórum Dúvidas [Dúvida] RUUD 1 2 3 4 5 ... Usuários visualizando este tópico: 1 Visitante (s)

Ruud - MEGAMU Mu Online

Jul 20, 2020 · Usuários visualizando este tópico: 1 Visitante (s)Subir Lite mode

[TUTORIAL] - DROP SKILL (2023) - MEGAMU Mu Online

Dec 1, 2021 · MEGAMU Mu Online Forum Fórum Tutoriais [TUTORIAL] - DROP SKILL (2023)

skill de ruud - MEGAMU Mu Online

Nov 8, 2024 · [Dúvida] skill de ruud1 2 3 4 5

Box Ruud N funciona - MEGAMU Mu Online

Feb 15, 2025 · MEGAMU Mu Online Forum Nova Geração Sugestões / Correções / Bug Tracking Box Ruud N funciona 1 2 3 4 5 ... Usuários visualizando este tópico: 1 Visitante (s)

MEGAMU Mu Online Forum - Set Ruuds e compra de Rudds

Jun 7, 2021 · To fazendo uma Elf e gostaria de saber quanto custa cada item do Set Ruud dela e se vale apenas comprá-lo e se a set melhores se possível em ordem. Quanto e a conversão de ...

Itens RUUD Ancient - MEGAMU Mu Online

Feb 26, 2022 · Usuários visualizando este tópico: 1 Visitante (s)Contate-nos

MEGAMU Mu Online Forum - skill de ruud

Aug 11, 2024 · Olá, as skill de Ruud funciona como skill normal do jogo, dos seus personagens, elas simplesmente são as melhores da sua classe. A diferença da skill de drop e as básicas ...

Set Ruuds e compra de Rudds - MEGAMU Mu Online

Jul 6, 2021 · Usuários visualizando este tópico: 2 Visitante (s)Subir Lite mode

Box Ruud - MEGAMU Mu Online

Aug 6, 2024 · Usuários visualizando este tópico: 1 Visitante (s)Subir Lite mode Contate-nos

Explore our comprehensive guide on Ruud furnace parts diagrams. Understand your system better and find the parts you need. Learn more to keep your furnace running smoothly!

[Back to Home](#)