

Redmax Trimmer Parts Diagram

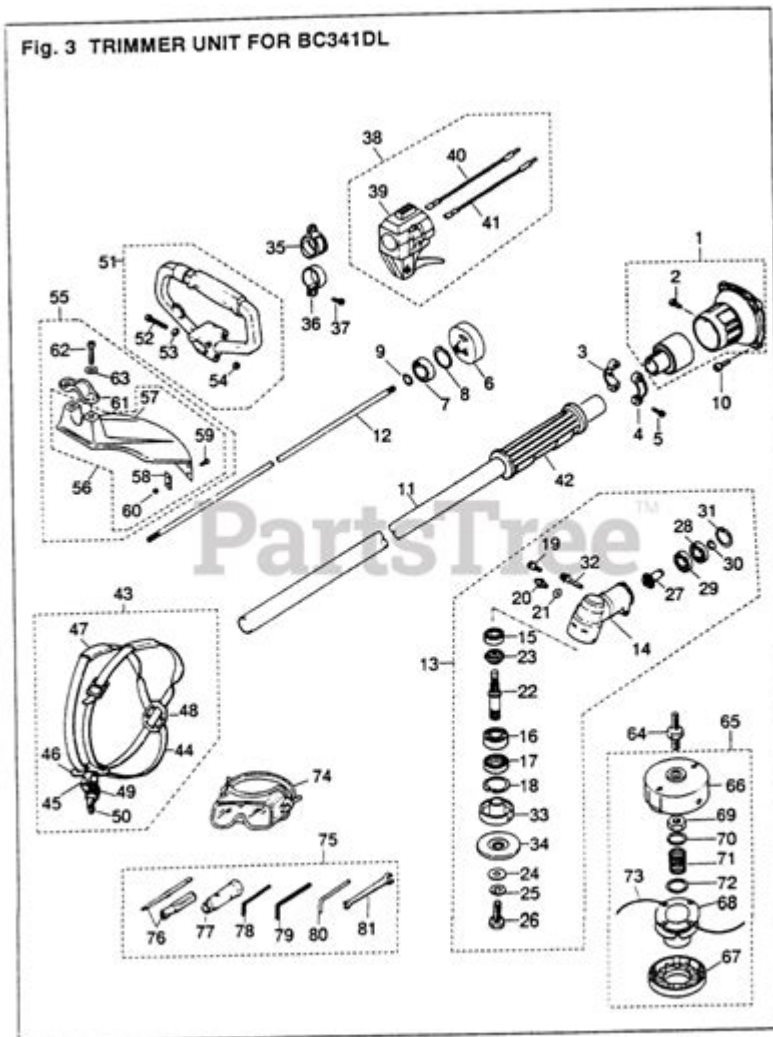

[14]

Redmax trimmer parts diagram is an essential tool for anyone who owns a Redmax trimmer or is involved in its maintenance and repair. Understanding the various components of your trimmer can help you troubleshoot issues, perform regular maintenance, and ensure optimal performance. This article delves into the intricacies of the Redmax trimmer parts diagram, providing insights into each component, its function, and how it contributes to the overall operation of the trimmer.

Understanding the Redmax Trimmer Parts Diagram

A Redmax trimmer parts diagram serves as a visual guide that depicts the various

components of the trimmer. It is an invaluable resource for both new users and seasoned professionals. The diagram outlines each part, making it easier for users to identify, locate, and understand the function of each component in the assembly.

Importance of the Parts Diagram

The parts diagram is crucial for several reasons:

- **Ease of Repair:** When you know the parts of your trimmer, you can easily identify which component is malfunctioning, allowing for targeted repairs.
- **Maintenance:** Regular maintenance is vital for the longevity of your equipment. The diagram helps you understand which parts require routine checks and servicing.
- **Parts Replacement:** If you need to replace a part, having a diagram handy ensures you order the correct component.
- **Assembly and Disassembly:** The diagram aids in assembling and disassembling the trimmer, making it a valuable resource during repairs.

Key Components of a Redmax Trimmer

Understanding the major components of your Redmax trimmer can help you better navigate the parts diagram. Here are some of the key components typically found in a Redmax trimmer:

1. Engine

The engine is the heart of the trimmer, providing the necessary power to operate the cutting head. It is important to ensure that the engine is well-maintained to avoid performance issues. Key parts of the engine include:

- Piston
- Cylinder
- Crankshaft
- Fuel System

2. Fuel Tank

The fuel tank holds the gasoline that powers the engine. A clean and properly sealed fuel tank is crucial for optimal performance. Common issues with the fuel tank can lead to difficulty in starting or running the trimmer.

3. Cutting Head

The cutting head is responsible for trimming grass and weeds. It typically consists of:

- Trimmer Line
- Spool
- Guard

Regularly checking and replacing the trimmer line is essential for effective cutting.

4. Shaft

The shaft connects the engine to the cutting head. It transfers power from the engine to the head, enabling it to rotate. Ensure that the shaft is free of debris and damage for smooth operation.

5. Handle and Controls

The handle and controls allow the operator to maneuver the trimmer and control its functions. Key components include:

- Throttle Control
- Stop Switch
- Handle Grips

Proper handling and maintenance of these components enhance user experience and safety.

Common Issues and Troubleshooting

Even with regular maintenance, you may encounter issues with your Redmax trimmer. Understanding the parts diagram can help you diagnose common problems. Here are some frequent issues and their potential solutions:

1. Engine Won't Start

If your engine fails to start, consider checking the following components:

- Fuel Tank: Ensure it is filled with fresh gasoline.
- Spark Plug: Inspect for damage or carbon buildup.
- Air Filter: A clogged air filter can hinder engine performance.

2. Poor Cutting Performance

If the trimmer is not cutting effectively, it may be time to check:

- Trimmer Line: Ensure it is properly installed and not worn out.
- Cutting Head: Inspect for any damage or blockage.
- Engine Power: Verify that the engine is running smoothly.

3. Vibration or Noise

Excessive vibration or noise can indicate several issues:

- Shaft Alignment: Ensure the shaft is properly aligned.
- Loose Parts: Check for any loose screws or components.
- Worn Bearings: Inspect bearings in the cutting head for wear.

Where to Find Redmax Trimmer Parts Diagrams

Finding a reliable parts diagram for your Redmax trimmer is crucial for effective maintenance and repairs. Here are some resources where you can locate these diagrams:

1. Manufacturer's Website

The official Redmax website often provides parts diagrams for various models. You can search for your specific model to access the relevant diagram.

2. Authorized Dealers

Authorized Redmax dealers and service centers typically have access to parts diagrams and can assist you in identifying the correct components.

3. Online Parts Retailers

Many online retailers offer parts diagrams along with the ability to purchase replacement parts. Websites like Amazon, eBay, or specialized outdoor equipment retailers are good places to start.

Conclusion

In conclusion, understanding the **Redmax trimmer parts diagram** is vital for effective maintenance and repair. Knowing the key components and their functions enables users to troubleshoot issues efficiently, perform regular maintenance, and ensure the longevity of their equipment. Whether you're a DIY enthusiast or a professional landscaper, having access to this valuable resource will enhance your experience with Redmax trimmers. By familiarizing yourself with the parts, you can keep your trimmer in top condition and tackle any landscaping task with confidence.

Frequently Asked Questions

What is a Redmax trimmer parts diagram?

A Redmax trimmer parts diagram is a visual representation that illustrates the various components and parts of a Redmax trimmer, helping users understand how to assemble, disassemble, or repair their equipment.

Where can I find a Redmax trimmer parts diagram?

You can find a Redmax trimmer parts diagram on the official Redmax website, in the user manual of your trimmer, or through authorized dealers and aftermarket parts suppliers.

Why is it important to refer to a parts diagram for my Redmax trimmer?

Referring to a parts diagram is important for identifying specific parts, ensuring proper assembly and maintenance, and facilitating easier troubleshooting and repairs.

Are parts diagrams the same for all Redmax trimmer models?

No, parts diagrams can vary significantly between different models of Redmax trimmers. It's crucial to refer to the diagram specific to your model for accurate information.

Can I order replacement parts using the diagram?

Yes, you can use the Redmax trimmer parts diagram to identify the necessary parts and then order them from a dealer or online retailer that sells Redmax parts.

What should I do if I can't find the parts diagram for my specific Redmax trimmer model?

If you can't find the parts diagram for your specific model, consider contacting Redmax customer support, visiting an authorized dealer, or searching online forums and communities for assistance.

How do I read a Redmax trimmer parts diagram?

To read a Redmax trimmer parts diagram, familiarize yourself with the legend or key that explains the symbols used, and then follow the labeled parts in relation to the overall assembly of the trimmer.

Find other PDF article:

<https://soc.up.edu.ph/14-blur/Book?docid=fen53-5644&title=college-football-strength-and-conditioning-summer-manual.pdf>

Redmax Trimmer Parts Diagram

RedMax Mowers, Blowers, Trimmers, Edgers

Buy RedMax pre-mixed fuel or oil and extend the standard consumer warranty up to 5 years! Learn more

Welcome to redmax.ca

This is the home of redmax.ca The story Cormidi was founded in 1995 by brothers Armando, Antonio, Massimiliano and Sandro Cormidi. Built in Italy, the Cormidi brothers have revolutionized the development and production of versatile tracked mini loaders and dumpers with self loading capabilities that are compatible with a wide range of attachments that make this the perfect ...

RedMax - Equipements ESF

Your trusted Canadian source for parts, engines, and outdoor equipment. Featuring top brands like Honda, Husqvarna, BE Power Equipment, and Stiga.

Red Max Mowers - Hawkeye Equipment Inc.

RedMax allows the homeowner to "mow like a pro" with a residential unit featured like a professional mower. With high performance engines and 10 gage fabricated decks, the RZTs are up to the task season after season.

RedMax Products - dsmotors.ca

RedMax One of the world's first outdoor power equipment manufacturers to take steps toward improving the environment.

RedMax SGCZ2460S Reciprocator Trimmer - Canadian Equipment ...

RedMax SGCZ2460S Reciprocator Trimmer Product Code: SGCZ2460S - EST 103900 Manufacturer: RedMax - \$699.99 \$949.99 Quantity:

RedMax Parts by Equipment | PartsTree

The best way to buy repair parts for your RedMax is to begin by searching for your RedMax model number on PartsTree and use the OEM RedMax parts diagrams to find the parts that fit exactly like the originals from the RedMax factory.

Trimmers - REDMAX - Mowers at Jacks

Get Your Trimmers (REDMAX) with Mowers at Jacks! Free freight shipping. Order online or by phone.

Commercial Weed & Grass String Trimmers | RedMax

RedMax's line of heavy-duty, commercial grade trimmers can clear, trim or edge large areas of unwanted grass and weeds with ease.

REDMAX Zero Turn Lawn Mowers For Sale in Canada

Search REDMAX Zero Turn Lawn Mowers for sale at MarketBook Canada. Find REDMAX RZT54X, CZT60+, CZT60X, and more.

RedMax Mowers, Blowers, Trimmers, Edgers

Buy RedMax pre-mixed fuel or oil and extend the standard consumer warranty up to 5 years! Learn more

Welcome to redmax.ca

This is the home of redmax.ca The story Cormidi was founded in 1995 by brothers Armando, Antonio, ...

RedMax - Equipements ESF

Your trusted Canadian source for parts, engines, and outdoor equipment. Featuring top brands like Honda, ...

Red Max Mowers - Hawkeye Equipment Inc.

RedMax allows the homeowner to “mow like a pro” with a residential unit featured like a professional mower. ...

RedMax Products - dsmotors.ca

RedMax One of the world’s first outdoor power equipment manufacturers to take steps toward ...

Explore our comprehensive Redmax trimmer parts diagram to identify components easily. Keep your trimmer running smoothly. Learn more about maintenance tips today!

[Back to Home](#)