

Purell Es8 Dispenser Instructions



PURELL® ES8 Soap & Sanitizer Touch Free Dispenser Installation and Use Instructions

Please read all instructions carefully before installing and using the dispenser.
Do not install in locations where dispensers may be exposed to wet environments such as showers or areas where walls are washed down.

Dispenser Installation



Open dispenser by pressing release buttons on side of dispenser and slide the front cover down.

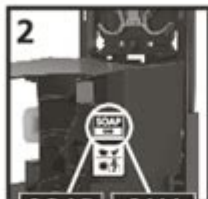

Check label inside dispenser before installing.
ES8 SOAP = soap dispenser
ES8 SAN = hand sanitizer dispenser



Install dispenser with at least 2" free space above counter top to allow routine service.

If installing with wall fasteners

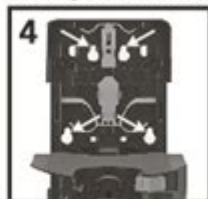

Using the dispenser as a template, place the tape on the back plate to mark and drill four holes using 1/16" drill bit. Use the supplied wall anchor and #10 x 1" screws to secure the dispenser in place, being careful not to over tighten. It is recommended to use 4 screws. If only two are possible, the top two holes should be used. Recommended holes shown.

If installing with tape

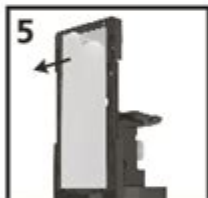

Clean installation surface with an alcohol pad. Allow surface to dry for 60 seconds then peel paper off installation tape and press firmly on back plate for 10 seconds. For maximum adhesion, wait 24 hours before loading refill or using dispenser.



Attach the back plate by pressing on the top two corners and the bottom middle section.
Audible clicks will confirm proper installation.



Install the 54x102" Floor and Wall Protector into the bottom of the dispenser by aligning plastic tabs on the 54x102 with slots on the dispenser and sliding up until the tabs snap into place. 54x102 is included with Sanitizer Systems and can be ordered for Soap systems. 2745-4045 10 White 54x102 Floor and Wall Protector. 2745-0245 10 Graphite 54x102 Floor and Wall Protector.



Attach label on refill with label on dispenser.

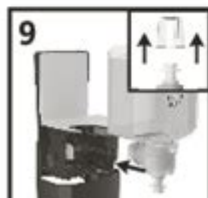

Remove refill cap and push the new refill into dispenser until it clicks in place.



Close dispenser cover. The green status light will blink after closing, indicating the dispenser is ready to use.



Place palm approximately 2" below dispenser, product will dispense within 1 second of sensor activation.

PURELL ES8 DISPENSER INSTRUCTIONS ARE ESSENTIAL FOR ANYONE LOOKING TO MAINTAIN HYGIENE STANDARDS IN THEIR WORKPLACE OR HOME. THE PURELL ES8 DISPENSER IS DESIGNED TO PROVIDE A CONVENIENT AND EFFECTIVE WAY TO DISPENSE HAND SANITIZER, MAKING IT EASIER FOR INDIVIDUALS TO PRACTICE PROPER HAND HYGIENE. IN THIS ARTICLE, WE WILL COVER EVERYTHING YOU NEED TO KNOW ABOUT USING, MAINTAINING, AND TROUBLESHOOTING THE PURELL ES8 DISPENSER, ENSURING THAT IT REMAINS AN EFFECTIVE TOOL IN YOUR SANITIZATION EFFORTS.

OVERVIEW OF THE PURELL ES8 DISPENSER

THE PURELL ES8 DISPENSER IS A TOUCH-FREE HAND SANITIZER DISPENSER THAT IS IDEAL FOR HIGH-TRAFFIC AREAS SUCH AS OFFICES, SCHOOLS, AND HEALTHCARE FACILITIES. IT IS DESIGNED TO HOLD PURELL ADVANCED HAND SANITIZER REFILLS, ENSURING THAT USERS CAN QUICKLY AND EASILY SANITIZE THEIR HANDS.

KEY FEATURES OF THE PURELL ES8 DISPENSER

- **TOUCH-FREE OPERATION:** THE DISPENSER USES INFRARED SENSOR TECHNOLOGY TO PROVIDE A TOUCH-FREE EXPERIENCE, REDUCING THE RISK OF CROSS-CONTAMINATION.
- **LARGE CAPACITY:** THE ES8 DISPENSER HOLDS 1200 mL OF HAND SANITIZER, MAKING IT SUITABLE FOR HIGH-USAGE ENVIRONMENTS.
- **VERSATILE MOUNTING OPTIONS:** IT CAN BE WALL-MOUNTED OR PLACED ON A COUNTERTOP, OFFERING FLEXIBILITY IN PLACEMENT.
- **MODERN DESIGN:** THE SLEEK LOOK FITS WELL IN ANY SETTING, WHETHER IT'S AN OFFICE, HOSPITAL, OR RESTAURANT.

INSTALLATION INSTRUCTIONS FOR THE PURELL ES8 DISPENSER

INSTALLING THE PURELL ES8 DISPENSER IS A STRAIGHTFORWARD PROCESS THAT CAN BE ACCOMPLISHED WITH MINIMAL TOOLS. FOLLOW THESE STEPS TO ENSURE A SUCCESSFUL INSTALLATION:

1. **GATHER REQUIRED TOOLS:** YOU WILL NEED A DRILL, SCREWDRIVER, LEVEL, AND MEASURING TAPE.
2. **SELECT LOCATION:** CHOOSE A LOCATION THAT IS EASILY ACCESSIBLE AND VISIBLE TO EVERYONE. A HEIGHT OF 42-48 INCHES FROM THE FLOOR IS RECOMMENDED FOR OPTIMAL USE.
3. **MARK THE MOUNTING HOLES:** HOLD THE DISPENSER AGAINST THE WALL AND USE A LEVEL TO ENSURE IT IS STRAIGHT. MARK THE SPOTS WHERE THE SCREWS WILL GO.
4. **DRILL HOLES:** USE A DRILL TO MAKE HOLES IN THE MARKED SPOTS. BE SURE TO USE THE APPROPRIATE DRILL BIT FOR THE WALL TYPE (DRYWALL, CONCRETE, ETC.).
5. **ATTACH THE MOUNTING BRACKET:** SECURE THE MOUNTING BRACKET TO THE WALL USING THE PROVIDED SCREWS AND ANCHORS.
6. **HANG THE DISPENSER:** ALIGN THE BACK OF THE DISPENSER WITH THE MOUNTING BRACKET AND PRESS IT INTO PLACE UNTIL YOU HEAR A CLICK.
7. **CHECK STABILITY:** GENTLY PULL ON THE DISPENSER TO ENSURE IT IS SECURELY MOUNTED.

LOADING THE PURELL ES8 DISPENSER

ONCE THE DISPENSER IS INSTALLED, THE NEXT STEP IS TO LOAD IT WITH HAND SANITIZER. HERE'S HOW TO DO IT PROPERLY:

1. **OPEN THE DISPENSER:** LOCATE THE UNLOCK BUTTON AT THE BOTTOM OF THE DISPENSER AND PRESS IT TO OPEN THE FRONT COVER.
2. **REMOVE EMPTY CARTRIDGE:** IF THERE IS AN EMPTY CARTRIDGE INSIDE, PULL IT OUT AND DISPOSE OF IT RESPONSIBLY.
3. **INSERT NEW CARTRIDGE:** TAKE A NEW PURELL ES8 REFILL CARTRIDGE AND REMOVE THE PROTECTIVE SEAL. ALIGN THE CARTRIDGE WITH THE DISPENSER SLOT AND SLIDE IT IN UNTIL IT CLICKS INTO PLACE.
4. **CLOSE THE DISPENSER:** GENTLY PUSH THE FRONT COVER BACK INTO PLACE UNTIL IT LOCKS SECURELY.

CHOOSING THE RIGHT PURELL REFILL

IT'S IMPORTANT TO USE THE CORRECT TYPE OF REFILL FOR YOUR PURELL ES8 DISPENSER. HERE ARE SOME OPTIONS:

- PURELL ADVANCED HAND SANITIZER: THIS IS THE MOST COMMON REFILL AND IS EFFECTIVE AGAINST A WIDE RANGE OF GERMS.
- PURELL ADVANCED GEL: A GEL-BASED OPTION THAT IS IDEAL FOR HEAVY USE AND PROVIDES A MOISTURIZING EFFECT.
- PURELL ADVANCED FOAMING HAND SANITIZER: THIS IS A FOAM OPTION THAT IS GENTLE ON THE SKIN AND SUITABLE FOR FREQUENT USE.

OPERATING THE PURELL ES8 DISPENSER

USING THE PURELL ES8 DISPENSER IS SIMPLE AND INTUITIVE. FOLLOW THESE STEPS FOR OPTIMAL USAGE:

1. **STAND IN FRONT OF THE DISPENSER:** POSITION YOURSELF ABOUT 6 INCHES AWAY FROM THE DISPENSER.
2. **ACTIVATE THE SENSOR:** MOVE YOUR HANDS UNDER THE DISPENSER. THE INFRARED SENSOR WILL DETECT YOUR HANDS AND AUTOMATICALLY DISPENSE THE SANITIZER.
3. **RUB HANDS TOGETHER:** ENSURE THAT YOU RUB YOUR HANDS TOGETHER FOR AT LEAST 20 SECONDS, COVERING ALL SURFACES, INCLUDING BETWEEN THE FINGERS AND UNDER THE NAILS.
4. **ALLOW TO DRY:** LET THE SANITIZER AIR DRY COMPLETELY BEFORE TOUCHING ANY SURFACES.

MAINTENANCE OF THE PURELL ES8 DISPENSER

TO ENSURE THE LONGEVITY AND EFFICIENCY OF YOUR PURELL ES8 DISPENSER, REGULAR MAINTENANCE IS ESSENTIAL. HERE ARE SOME TIPS:

REGULAR CLEANING

- WIPE DOWN THE EXTERIOR: USE A DAMP CLOTH WITH MILD SOAP TO CLEAN THE OUTSIDE OF THE DISPENSER REGULARLY.
- AVOID HARSH CHEMICALS: DO NOT USE ABRASIVE CLEANERS OR SOLVENTS, AS THESE CAN DAMAGE THE DISPENSER'S FINISH.

CHECK FOR REFILLS

- MONITOR LEVELS: REGULARLY CHECK THE SANITIZER LEVELS AND REPLACE CARTRIDGES AS NEEDED TO ENSURE USERS ALWAYS HAVE ACCESS TO HAND SANITIZER.

TROUBLESHOOTING COMMON ISSUES

IF YOU ENCOUNTER ANY ISSUES WITH YOUR PURELL ES8 DISPENSER, REFER TO THESE COMMON TROUBLESHOOTING TIPS:

DISPENSER NOT WORKING

- CHECK POWER SOURCE: ENSURE THAT THE DISPENSER HAS FRESH BATTERIES INSTALLED OR IS PROPERLY PLUGGED IN.
- SENSOR OBSTRUCTION: MAKE SURE THERE ARE NO OBJECTS BLOCKING THE SENSOR.

INSUFFICIENT SANITIZER DISPENSED

- CHECK CARTRIDGE INSTALLATION: ENSURE THAT THE REFILL CARTRIDGE IS PROPERLY INSTALLED AND NOT EXPIRED.
- CLEAN THE SENSOR AREA: DUST OR DEBRIS MAY BE OBSTRUCTING THE SENSOR. CLEAN THE AREA GENTLY.

CONCLUSION

THE PURELL ES8 DISPENSER IS AN ESSENTIAL TOOL FOR PROMOTING HAND HYGIENE IN VARIOUS SETTINGS. BY FOLLOWING THESE **PURELL ES8 DISPENSER INSTRUCTIONS**, YOU CAN ENSURE THAT THE DISPENSER IS INSTALLED CORRECTLY, LOADED WITH THE RIGHT REFILL, AND MAINTAINED FOR OPTIMAL PERFORMANCE. REGULAR USAGE AND MAINTENANCE OF THIS DISPENSER WILL CONTRIBUTE SIGNIFICANTLY TO THE HEALTH AND SAFETY OF YOUR ENVIRONMENT, ULTIMATELY REDUCING THE SPREAD OF GERMS AND ILLNESSES.

FREQUENTLY ASKED QUESTIONS

WHAT ARE THE INITIAL STEPS TO SET UP THE PURELL ES8 DISPENSER?

TO SET UP THE PURELL ES8 DISPENSER, FIRST REMOVE IT FROM THE PACKAGING. NEXT, LOCATE THE MOUNTING HARDWARE AND CHOOSE A SUITABLE LOCATION ON THE WALL. USE THE PROVIDED TEMPLATE TO MARK THE DRILL HOLES, THEN SECURE THE DISPENSER TO THE WALL USING SCREWS.

HOW DO I REFILL THE PURELL ES8 DISPENSER WITH HAND SANITIZER?

TO REFILL THE PURELL ES8 DISPENSER, OPEN THE FRONT COVER BY PRESSING THE LATCH. REMOVE THE EMPTY CARTRIDGE AND REPLACE IT WITH A NEW PURELL ES8 REFILL CARTRIDGE. ENSURE IT CLICKS INTO PLACE, THEN CLOSE THE FRONT COVER SECURELY.

WHAT TYPE OF PURELL REFILL CARTRIDGES ARE COMPATIBLE WITH THE ES8 DISPENSER?

THE PURELL ES8 DISPENSER IS COMPATIBLE WITH PURELL 1200 ML REFILL CARTRIDGES, SPECIFICALLY DESIGNED FOR THE ES8 SYSTEM. MAKE SURE TO USE ONLY PURELL BRAND REFILLS TO ENSURE OPTIMAL PERFORMANCE.

HOW CAN I TROUBLESHOOT THE PURELL ES8 DISPENSER IF IT IS NOT DISPENSING SANITIZER?

IF THE PURELL ES8 DISPENSER IS NOT DISPENSING SANITIZER, CHECK IF THE CARTRIDGE IS PROPERLY INSTALLED. ENSURE THAT THE BATTERY IS CHARGED AND FUNCTIONAL. IF THE PROBLEM PERSISTS, TRY CLEANING THE DISPENSER'S NOZZLE AND ENSURE THERE ARE NO BLOCKAGES.

WHAT TYPE OF BATTERIES DOES THE PURELL ES8 DISPENSER REQUIRE?

THE PURELL ES8 DISPENSER REQUIRES 4 D-CELL ALKALINE BATTERIES FOR OPERATION. MAKE SURE TO REPLACE THE BATTERIES WHEN THE LOW BATTERY INDICATOR ALERTS YOU.

How do I clean the PURELL ES8 dispenser?

TO CLEAN THE PURELL ES8 DISPENSER, USE A DAMP CLOTH WITH MILD SOAP. AVOID USING ABRASIVE CLEANERS. CLEAN THE EXTERIOR AND ANY VISIBLE AREAS, BUT DO NOT IMMERSE THE DISPENSER IN WATER OR ATTEMPT TO CLEAN INTERNAL COMPONENTS.

Is the PURELL ES8 dispenser suitable for outdoor use?

THE PURELL ES8 DISPENSER IS DESIGNED PRIMARILY FOR INDOOR USE. IF USED OUTDOORS, ENSURE IT IS PROTECTED FROM EXTREME WEATHER CONDITIONS TO MAINTAIN ITS FUNCTIONALITY AND CLEANLINESS.

Find other PDF article:

<https://soc.up.edu.ph/57-chart/pdf?trackid=Ijc55-0065&title=teacher-pay-raise-in-georgia.pdf>

Purell Es8 Dispenser Instructions

PURELL® Hand Sanitizer: Trusted and Preferred by Hospitals

PURELL® hand sanitizers are formulated to be effective against germs in the most demanding situations and contain moisturizers and skin conditioners to help hands feel soft, even with ...

PURELL - Walmart Canada

Purell Advanced Hand Sanitizer Refreshing Gel, Canada's #1 hand sanitizer! Shop for PURELL | Walmart Canada at Walmart.ca. Save money. Live better.

Purell Advanced Instant Pump Hand Sanitizer Gel, Unscented, 236 ...

This countertop bottle of Hand Sanitizer Gel by Purell Advanced kills 99.99% of most common germs that may cause illness in as little as 15 seconds, without soap, water or towels - perfect ...

Our PURELL® Brand Products | PURELL® Online Shop

PURELL® Hand Sanitiser was invented in 1988 by GOJO in the USA to meet the needs of healthcare providers and restaurant operators looking for ways to reduce the spread of germs. ...

Purell - Wikipedia

Purell is an American brand of hand sanitizer invented in 1988, and introduced to the consumer market in 1997, by GOJO Industries. [1] Its primary component is ethyl alcohol (70% v/v), and ...

GOJO Canada: PURELL® Brand Products

PURELL® brand touch-free floor stands or PURELL Wipes stations allow you to create a custom hand hygiene solution for your facility. With the freedom to move and position a dispenser ...

PURELL® - ww2.gojo.com

No Harsh Chemicals. Powerful Germ Kill. Disinfecting your facility shouldn't be complicated. So we've brought the trusted germ-killing power of the PURELL ® brand to a suite of gentle, ...

Buy Purell Product Online in Canada | United Canada Inc.

Find Purell sanitizer dispenser, wipes, and bottles for sale in Canada at United Canada. Keep your hands clean and safe with our range of Purell products.

Gel désinfectant pour les mains Purell Advanced Instant Pump, ...

Cette bouteille de gel désinfectant de comptoir de Purell Advanced pour les mains élimine 99,99 % des germes les plus courants pouvant causer des maladies en seulement 15 secondes, ...

GOJO - Fight Germs on Hands and Surfaces | #1 Brand of Hand ...

We're GOJO, Makers of PURELL®, and we help make the world a healthier place through scientific innovation, research, and education. GOJO Industries helps people everywhere ...

PURELL® Hand Sanitizer: Trusted and Preferred by Hospitals

PURELL® hand sanitizers are formulated to be effective against germs in the most demanding situations and contain moisturizers and skin conditioners to help hands feel soft, even with ...

PURELL - Walmart Canada

Purell Advanced Hand Sanitizer Refreshing Gel, Canada's #1 hand sanitizer! Shop for PURELL | Walmart Canada at Walmart.ca. Save money. Live better.

Purell Advanced Instant Pump Hand Sanitizer Gel, Unscented, ...

This countertop bottle of Hand Sanitizer Gel by Purell Advanced kills 99.99% of most common germs that may cause illness in as little as 15 seconds, without soap, water or towels - perfect ...

Our PURELL® Brand Products | PURELL® Online Shop

PURELL® Hand Sanitiser was invented in 1988 by GOJO in the USA to meet the needs of healthcare providers and restaurant operators looking for ways to reduce the spread of germs. ...

Purell - Wikipedia

Purell is an American brand of hand sanitizer invented in 1988, and introduced to the consumer market in 1997, by GOJO Industries. [1] Its primary component is ethyl alcohol (70% v/v), and ...

GOJO Canada: PURELL® Brand Products

PURELL® brand touch-free floor stands or PURELL Wipes stations allow you to create a custom hand hygiene solution for your facility. With the freedom to move and position a dispenser ...

PURELL® - ww2.gojo.com

No Harsh Chemicals. Powerful Germ Kill. Disinfecting your facility shouldn't be complicated. So we've brought the trusted germ-killing power of the PURELL ® brand to a suite of gentle, ...

Buy Purell Product Online in Canada | United Canada Inc.

Find Purell sanitizer dispenser, wipes, and bottles for sale in Canada at United Canada. Keep your hands clean and safe with our range of Purell products.

Gel désinfectant pour les mains Purell Advanced Instant Pump, ...

Cette bouteille de gel désinfectant de comptoir de Purell Advanced pour les mains élimine 99,99 % des germes les plus courants pouvant causer des maladies en seulement 15 secondes, ...

GOJO - Fight Germs on Hands and Surfaces | #1 Brand of Hand ...

We're GOJO, Makers of PURELL®, and we help make the world a healthier place through scientific innovation, research, and education. GOJO Industries helps people everywhere ...

"Discover how to use your Purell ES8 dispenser with our step-by-step instructions. Ensure optimal

performance and hygiene. Learn more today!"

[Back to Home](#)