

Prentice Loader Parts Manual

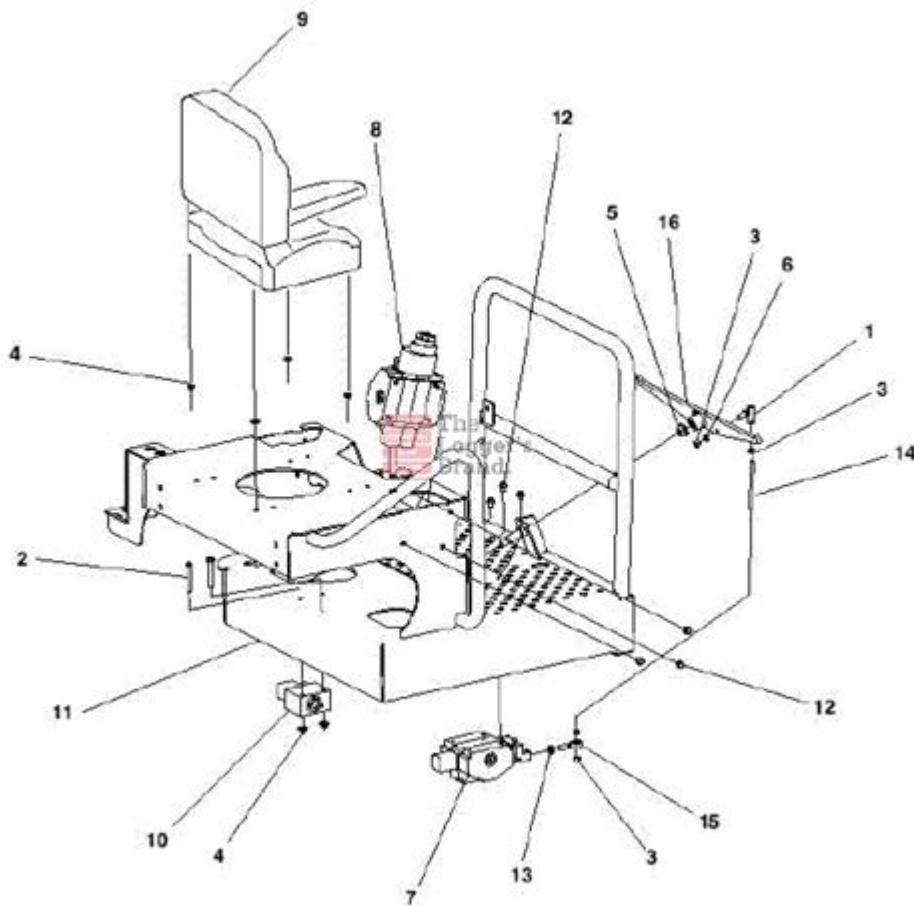

Prentice Loader Parts Manual is an essential resource for anyone working with or maintaining Prentice loaders. These machines are renowned for their durability and efficiency in various applications, including forestry, construction, and landscaping. Having a comprehensive parts manual at your disposal can significantly enhance your understanding of the machine, aid in troubleshooting, and streamline maintenance and repairs. This article delves into the significance of the Prentice loader parts manual, discusses its components, and provides insights into effectively using this critical resource.

Importance of the Prentice Loader Parts Manual

The Prentice Loader Parts Manual serves several vital functions that contribute to the longevity and

performance of the equipment. Understanding these functions can help operators and maintenance personnel utilize the manual effectively.

1. Identification of Parts

One of the primary benefits of a parts manual is the ability to identify specific components of the loader. Each loader model may have unique parts, and the manual provides detailed diagrams and part numbers that facilitate:

- Accurate identification of parts to ensure proper replacement.
- Understanding the relationships between different components.
- Recognizing wear and tear on parts that may require maintenance or replacement.

2. Troubleshooting Aid

Loader operators often encounter issues that require immediate attention. The parts manual can assist in diagnosing problems by providing:

- Common issues associated with specific parts.
- Step-by-step troubleshooting guides.
- Flowcharts that outline the repair process for various malfunctions.

3. Maintenance Guidance

Routine maintenance is crucial for the performance and lifespan of Prentice loaders. The parts manual typically includes:

- Scheduled maintenance intervals.
- Recommended practices for lubricating, cleaning, and inspecting components.
- Checklists to ensure all necessary maintenance tasks are completed.

Components of the Prentice Loader Parts Manual

Understanding the structure of the Prentice Loader Parts Manual can enhance its usability. The manual generally contains several key sections, including:

1. Table of Contents

The table of contents provides an overview of the manual's organization. It lists all sections and subsections, making it easy to locate specific parts or information.

2. Exploded Diagrams

Exploded diagrams are one of the most critical features of the parts manual. These illustrations show the loader's components in a disassembled view, allowing users to see how parts fit together. Key points include:

- Each part is labeled with a corresponding part number.
- Different views may be provided for complex assemblies.
- It helps visualize the assembly and disassembly process.

3. Parts Listings

Following the diagrams, the manual usually includes comprehensive parts listings. This section typically contains:

- Part numbers for easy ordering.
- Descriptions of each part, including size and material.
- Stock availability information.

4. Specifications

Specifications are critical for understanding the operational parameters of the loader. This section may include:

- Engine specifications.
- Hydraulic system details.
- Weight and dimensions of the loader.

5. Maintenance Procedures

This section outlines detailed maintenance procedures, including:

- Daily, weekly, and monthly maintenance tasks.
- Step-by-step instructions for replacing specific parts.
- Safety precautions to consider during maintenance.

Using the Prentice Loader Parts Manual Effectively

To maximize the benefits of the Prentice Loader Parts Manual, users should adopt best practices for its use. Here are some tips for effective utilization:

1. Keep It Accessible

Always have the parts manual readily available in the maintenance area or operator's cabin. Consider:

- Printing a hard copy for quick reference.
- Saving a digital copy on a tablet or smartphone.

2. Familiarize Yourself with the Manual

Take time to understand the layout and content of the manual. Familiarization will enable you to:

- Quickly locate necessary information when needed.
- Understand the terminology used in the manual.

3. Regularly Update the Manual

Manufacturers may release updates or revisions to parts manuals. Ensure that you:

- Obtain the latest version of the manual.
- Keep track of any changes in part numbers or specifications.

4. Use the Manual in Conjunction with Other Resources

While the parts manual is invaluable, using it alongside other resources can enhance your knowledge.

Consider:

- Consulting the operator's manual for operational guidelines.
- Engaging with online forums or communities of Prentice loader users for shared experiences and advice.

Common Parts and Their Functions in Prentice Loaders

The Prentice Loader Parts Manual details numerous components, each playing a specific role in the loader's function. Here are some common parts typically covered:

1. Engine Components

The engine is the heart of the loader, and its components include:

- Air Filters: Ensure clean air intake for efficient combustion.
- Fuel Injectors: Deliver fuel to the combustion chamber.
- Oil Filters: Maintain engine lubrication by filtering contaminants.

2. Hydraulic System Parts

The hydraulic system is crucial for the loader's lifting and steering capabilities. Key parts include:

- Hydraulic Pump: Generates flow and pressure to operate hydraulic circuits.

- Cylinders: Convert hydraulic energy into mechanical force for lifting and moving.
- Hoses and Fittings: Facilitate fluid transfer between components.

3. Transmission Components

The transmission system is responsible for power transfer from the engine to the wheels. Important parts include:

- Transmission Gears: Enable speed variations and torque multiplication.
- Clutch Assemblies: Engage and disengage power transmission.

4. Chassis and Body Parts

The chassis supports the loader's structure and includes:

- Frame: Provides stability and strength to the loader.
- Axles: Allow for movement and distribute weight across the loader.
- Wheels and Tires: Ensure traction and mobility on various terrains.

Conclusion

In conclusion, the Prentice Loader Parts Manual is a vital tool for anyone involved in the operation and maintenance of Prentice loaders. Understanding its components, utilizing it effectively, and familiarizing oneself with common parts can lead to improved performance and longevity of these powerful machines. Whether you are a seasoned operator or a newcomer to the world of heavy machinery, having access to a comprehensive parts manual is invaluable for keeping your loader in top condition.

Frequently Asked Questions

What is a Prentice loader parts manual used for?

A Prentice loader parts manual provides detailed information about the components and parts of Prentice loaders, including diagrams, part numbers, and maintenance guidelines.

Where can I find a digital copy of the Prentice loader parts manual?

Digital copies of the Prentice loader parts manual can often be found on the manufacturer's website, authorized dealer sites, or specialized equipment manuals websites.

Are there different parts manuals for different models of Prentice loaders?

Yes, each model of Prentice loader typically has its own specific parts manual to address the unique components and specifications of that model.

How can I identify the correct parts for my Prentice loader using the parts manual?

You can identify the correct parts by matching the part numbers and descriptions in the manual with the components on your loader, using diagrams for reference.

Is a Prentice loader parts manual essential for maintenance?

Yes, having a parts manual is essential for proper maintenance as it helps in understanding the parts, their functions, and how to replace or repair them effectively.

Can I request a printed version of the Prentice loader parts manual?

Yes, many suppliers and dealers offer printed versions of the parts manual upon request, although availability may vary.

What should I do if I can't find the parts manual for my specific Prentice loader model?

If you can't find the parts manual, you can contact Prentice customer support, authorized dealers, or search online forums and communities dedicated to heavy machinery.

Do Prentice loader parts manuals include troubleshooting information?

While the primary focus is on parts and components, many Prentice loader parts manuals may also include basic troubleshooting information and maintenance tips.

Find other PDF article:

<https://soc.up.edu.ph/35-bold/Book?docid=YJk87-1789&title=kazumi-family-therapy-full-video.pdf>

Prentice Loader Parts Manual

YouTube Help - Google Help

Learn more about YouTube YouTube help videos Browse our video library for helpful tips, feature overviews, and step-by-step tutorials. YouTube Known Issues Get information on reported ...

Sign in and out of YouTube - Computer - YouTube Help

Signing in to YouTube allows you to access features like subscriptions, playlists and purchases, and history.

Download the YouTube app

Check device requirements The YouTube app is available on a wide range of devices, but there are some minimum system requirements and device-specific limitations: Android: Requires ...

NFL Sunday Ticket pricing, billing, & purchase options - YouTube ...

In this article, you'll learn about pricing on YouTube TV and YouTube Primetime Channels, ways to purchase, and billing for NFL Sunday Ticket. To learn about game availability and package ...

Get help signing in to YouTube - Google Help

To make sure you're getting the directions for your account, select from the options below.

Utiliser YouTube Studio - Ordinateur - Aide YouTube

Utiliser YouTube Studio YouTube Studio est la plate-forme des créateurs. Elle rassemble tous les outils nécessaires pour gérer votre présence en ligne, développer votre chaîne, interagir avec ...

Use automatic dubbing - YouTube Help - Google Help

Automatic dubbing generates translated audio tracks in different languages to make your videos more accessible to viewers around the world. Videos with these audio tracks are marked as ...

Use your Google Account for YouTube

After signing up for YouTube, signing in to your Google account on another Google service will automatically sign you in to YouTube. Deleting your Google Account will delete your YouTube ...

Descargar la aplicación YouTube - Android - Ayuda de YouTube

La aplicación YouTube está disponible en una gran variedad de dispositivos, pero hay algunos requisitos mínimos del sistema y limitaciones específicas para los dispositivos: Android: se ...

Understand three-minute YouTube Shorts - Google Help

Oct 15, 2024 · Understand three-minute YouTube Shorts You can soon start creating YouTube Shorts up to three minutes in length. This gives you more time to tell your stories, showcase ...

Aitum Vertical | OBS Forums

May 10, 2023 · Make content for TikTok, YouTube Shorts, Instagram Live, and more without the fuss. Use a separate ...

Download | OBS

Download OBS Studio for Windows, Mac or Linux

Multiple RTMP outputs plugin | OBS Forums

May 17, 2020 · homepage: <https://sorayuki.github.io/obs-multi-rtmp/> The page is written in Japanese ...

Open Broadcaster Software | OBS

OBS (Open Broadcaster Software) is free and open source software for video recording and live streaming. Stream ...

OBS Studio Plugins | OBS Forums

Jul 16, 2025 · Plugins for use with OBS StudioVST3 plugin host, audio device IO (incl. ASIO) and patch bay, audio ...

Unlock the full potential of your Prentice loader with our comprehensive parts manual. Discover how to find and maintain the right parts today!

[Back to Home](#)