

Polaris 4500 Winch Parts Diagram

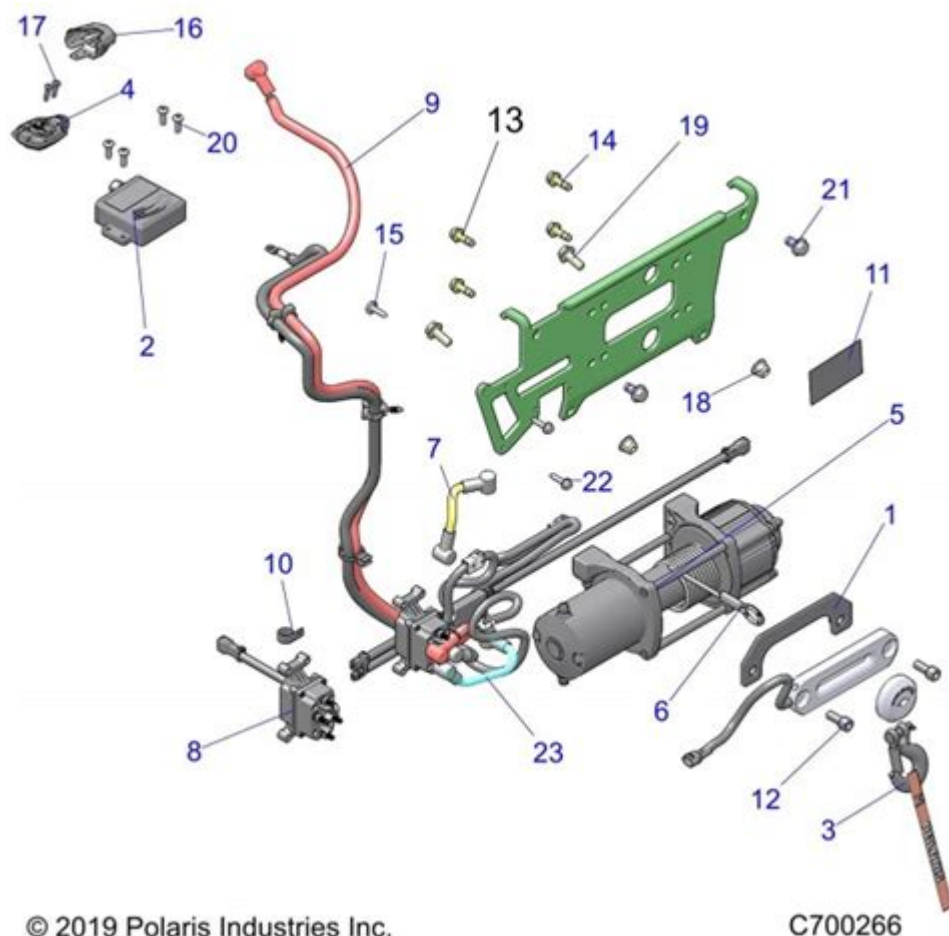

© 2019 Polaris Industries Inc.

C700266

Polaris 4500 winch parts diagram is essential for anyone looking to maintain, repair, or understand the workings of their Polaris winch. A well-maintained winch is crucial for off-road enthusiasts, especially when traversing rugged terrains or for those who may find themselves in challenging situations. Understanding the components of your winch through a detailed parts diagram can save time, money, and enhance your overall experience. In this article, we will delve into the key components of the Polaris 4500 winch, provide insights on how to interpret the parts diagram, and share some tips for maintenance and repair.

Understanding the Polaris 4500 Winch

The Polaris 4500 winch is a powerful tool designed to assist with pulling heavy loads, whether it's for off-road adventures or recovery operations. With a robust construction and high pulling capacity, this winch is a favorite among ATV and UTV users.

Key Specifications

Before we dive into the parts diagram, let's look at some important

specifications of the Polaris 4500 winch:

- Pulling Capacity: 4500 lbs
- Motor Type: Permanent magnet motor
- Gear Ratio: 153:1
- Cable Type: Steel cable (or synthetic rope in some models)
- Remote Control: Wireless remote control option available

Components of the Polaris 4500 Winch

Understanding the various parts of the Polaris 4500 winch is crucial for effective maintenance and troubleshooting. Here's a breakdown of the main components you will find in the parts diagram.

Main Components

1. Winch Motor
 - Provides the necessary power to pull heavy loads.
 - Typically a permanent magnet motor for efficient operation.
2. Gearbox
 - Reduces the motor speed while increasing torque.
 - Contains multiple gears to facilitate smooth operations.
3. Drum
 - The cylindrical part where the winch cable is wound.
 - Can be made of steel or aluminum.
4. Cable/Rope
 - The actual pulling mechanism, usually made of steel cable or synthetic rope.
 - Length and diameter vary based on winch specifications.
5. Fairlead
 - Guides the cable/rope as it winds onto the drum.
 - Prevents tangling and wear on the cable.
6. Remote Control
 - Allows the operator to control the winch from a distance.
 - Can be wired or wireless.
7. Mounting Plate
 - Secures the winch to the ATV or UTV.
 - Provides stability and support during operation.
8. Switch
 - Controls the winch's power and operation.
 - Can be a toggle switch or part of the remote control system.
9. Braking System
 - Prevents the drum from unwinding when not in use.
 - Essential for safety during operation.

Polaris 4500 Winch Parts Diagram

A parts diagram is an invaluable resource for understanding the Polaris 4500 winch. It visually represents the different components and how they fit together. While we can't provide an actual diagram here, you can find one in the owner's manual or on the Polaris website. However, here's how to interpret a typical parts diagram:

- **Labeling:** Each part is usually numbered or labeled for easy identification.
- **Sections:** Diagrams are often divided into sections showing the winch assembly, motor assembly, and electrical components.
- **Exploded View:** Many diagrams provide an exploded view, showing how parts fit together, which is particularly helpful for reassembly after repairs.

Maintenance Tips for Your Polaris 4500 Winch

Proper maintenance of your Polaris 4500 winch ensures longevity and optimal performance. Here are some essential maintenance tips to keep your winch in top shape:

Regular Inspections

- **Check for Wear and Tear:** Periodically inspect the cable/rope for frays or damage.
- **Inspect Electrical Connections:** Ensure that all electrical connections are secure and free from corrosion.

Lubrication

- **Motor and Gearbox:** Regularly lubricate the motor and gearbox to reduce friction and wear.
- **Drum and Fairlead:** Apply a light oil to the drum and fairlead to ensure smooth operation.

Cable/Rope Maintenance

- **Rewind Properly:** Always rewind the cable/rope evenly onto the drum to prevent tangling.
- **Replace When Necessary:** If the cable shows significant wear, replace it immediately to avoid breakage during use.

Seasonal Maintenance

- **Winterization:** In colder months, check the winch for any signs of rust or ice.
- **Pre-Use Checks:** Before heading out, inspect the winch to ensure it is functioning correctly.

Troubleshooting Common Issues

Even with regular maintenance, you may encounter some common issues with your Polaris 4500 winch. Here are a few troubleshooting steps:

Winch Won't Operate

- Check the Power Supply: Ensure the battery is charged and connections are secure.
- Inspect the Remote Control: Test the remote control batteries or try using the manual switch.

Slow Winching Speed

- Inspect for Overloading: Ensure the winch is not overloaded beyond its capacity.
- Check the Gearbox: If the gearbox is damaged, it may need to be repaired or replaced.

Cable Tangling

- Rewind the Cable: Manually rewind the cable onto the drum to correct tangling.
- Inspect Fairlead: Ensure the fairlead is not damaged and is aligned correctly.

Conclusion

Understanding the **Polaris 4500 winch parts diagram** is vital for any owner looking to get the most out of their winch. Whether you are performing routine maintenance, troubleshooting issues, or simply wanting to familiarize yourself with your equipment, a detailed parts diagram serves as an essential tool. By taking care of your winch and understanding its components, you can ensure that it remains a reliable ally during your off-road adventures.

Frequently Asked Questions

What are the key components shown in a Polaris 4500 winch parts diagram?

A Polaris 4500 winch parts diagram typically includes components such as the motor, gearbox, drum, solenoid, remote control, and wire harness.

How can I use a Polaris 4500 winch parts diagram for

linux office -

Xubuntu linux bluepoint redhat centos windows linux ...

Polaris 4 x 4 in India - Team-BHP

Jul 11, 2011 · Hi Guys, I have been recently seeing teaser advertisements (on cricket channels) of Polaris 4x4 vehicles to be sold in India. These 4x4 2 seaters have the potential to open some ...

2020

2020 2020.zip / 1.1GB : 2022-09-07 2020 HWP Windows 7 / 8 / 10 / 11 v2020 ...

AMD RX 590 -

RX 590 RX 590 GME GCN4.0 AMD 12nm 2 ...

?

May 30, 2020 · BMTH,Polaris,WSS, kingdom of gaint, emmure, life awaits, immi... ...

macbookair hwp -

Mar 22, 2020 · Polaris Office for Mac App Store google drive hwp ...

(Polaris Office) -

v9.103.88 PolarisOfficeSetup.exe / 186MB : 2021-08-12 Polaris Office Corp OS, , ...

Team-BHP - India's Most Trusted Car Reviews & News

Team-BHP takes ZERO advertising money from the auto industry, hence provides the most trusted, detailed and unbiased Car Reviews & News in India.

Polaris?

Polaris? Polaris Polarism? 14

Asia D,JAMMERC Polaris -

2011 1 ...

linux office -

Xubuntu linux bluepoint redhat centos windows linux ...

Polaris 4 x 4 in India - Team-BHP

Jul 11, 2011 · Hi Guys, I have been recently seeing teaser advertisements (on cricket channels) of Polaris 4x4 vehicles to be sold in India. These 4x4 2 seaters have the potential to open some ...

2020

2020 2020.zip / 1.1GB : 2022-09-07 2020 HWP Windows 7 / 8 / 10 / 11 v2020 ...

AMD RX 590 12nm - 12nm

AMD RX 590 12nm GME 12nm GCN4.0 12nm AMD 12nm 2 ...

May 30, 2020 · 12nm 12nm? - 12nm

May 30, 2020 · 12nm 12nm? 12nm BMTH, Polaris, WSS, kingdom of gaint, emmure, 12nm life awaits, immi... 12nm 12nm 30 ...

Mar 22, 2020 · macbookair 12nm hwp 12nm - 12nm

Mar 22, 2020 · 12nm Polaris Office for Mac 12nm App Store 12nm 12nm 12nm google drive 12nm hwp ...

Explore our detailed Polaris 4500 winch parts diagram to easily identify components and simplify your repairs. Learn more about maintaining your winch today!

[Back to Home](#)