

Outdoor Home Security Camera Placement Diagram

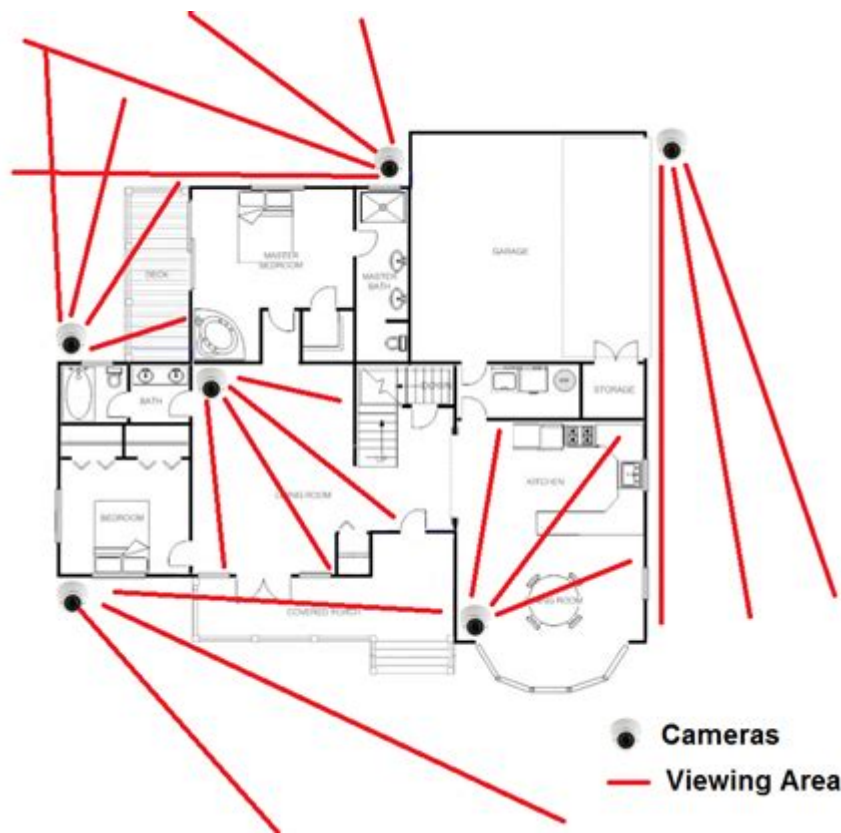

Outdoor home security camera placement diagram is crucial for ensuring the safety and security of your property. With the increasing instances of burglary and vandalism, the need for effective surveillance cannot be overstated. Properly placing your security cameras enhances visibility while minimizing blind spots, making it difficult for intruders to compromise your home. In this article, we will explore the key principles of outdoor camera placement, the factors to consider, and provide a comprehensive guide on how to create an effective security camera placement diagram.

Understanding the Importance of Camera Placement

When it comes to outdoor home security, camera placement can significantly impact the effectiveness of your surveillance. A well-placed camera not only deters potential intruders but also ensures that you capture clear images and footage of any suspicious activity. Here's why it is important:

- **Deterrent Effect:** Visible security cameras can discourage potential criminals from targeting your home.
- **Comprehensive Coverage:** Proper placement provides a complete view of your property, capturing all angles and entry points.
- **Evidence Collection:** A strategically placed camera increases the likelihood of capturing clear evidence in the event of a crime.

Factors to Consider for Camera Placement

Before you start placing your outdoor security cameras, consider the following factors:

1. **Coverage Area:** Identify all entry points, including doors and windows, as well as other vulnerable areas such as garages, driveways, and backyards.
2. **Camera Type:** The type of camera you choose (fixed, PTZ, or dome) will influence placement. For instance, PTZ cameras can cover a larger area and may require fewer units.
3. **Lighting Conditions:** Consider how lighting conditions change throughout the day. Ensure that cameras have night vision capabilities for low-light situations.
4. **Weather Resistance:** Outdoor cameras should be weatherproof and positioned to mitigate exposure to rain, snow, or extreme temperatures.
5. **Height and Angle:** Cameras should be placed high enough to avoid tampering, but angled properly to capture details like facial features or license plates.
6. **Network Connectivity:** If using wireless cameras, ensure that they are within range of your Wi-Fi network to maintain a stable connection.

Creating Your Outdoor Security Camera Placement Diagram

A well-structured diagram can serve as a visual guide for your security camera installation. Here are the steps to create an effective diagram:

Step 1: Assess Your Property Layout

Start by sketching a basic layout of your property, including:

- The main structure (house)
- Driveways and pathways
- Fences and gates
- Landscaping features (trees, bushes)
- Neighboring properties (for understanding potential blind spots)

Step 2: Identify Key Entry Points

Mark the following entry points on your diagram:

- **Front Door:** The main entry point for most homes.
- **Back Door:** Often less visible but frequently targeted.
- **Side Entrances:** Any additional doors leading into the home.
- **Windows:** Ground-level windows are particularly vulnerable.
- **Garage:** If attached, ensure visibility of the garage door.

Step 3: Determine Camera Locations

Based on your assessment, choose camera locations. Here's a guideline for placement:

1. Front Door:

- Place a camera facing the front door, ideally above eye level.
- Ensure it captures the entire entry area, including any packages left on the porch.

2. Back Door:

- Position a camera to cover the back entrance and any side windows.
- This area is often overlooked by intruders.

3. Driveways:

- Install a camera that captures the entire driveway, monitoring approaching vehicles and pedestrians.
- Consider motion detection features for alerts.

4. Side Gates and Fences:

- If applicable, place cameras to monitor side gates or open fences.
- This reduces the chance of an intruder entering unnoticed.

5. Outdoor Areas:

- For homes with backyards, consider cameras overlooking patios, pools, or play areas.
- These cameras can help monitor any gatherings or activities.

6. Garage:

- If you have a garage, ensure that the door is visible from a camera.
- A wide-angle camera can provide additional coverage of the driveway.

Step 4: Consider Additional Features

Think about incorporating the following features into your camera setup:

- Pan-Tilt-Zoom (PTZ) Cameras: These allow you to remotely control the camera's movement for better coverage.
- Infrared Night Vision: Essential for monitoring in low-light conditions.
- Two-Way Audio: This feature enables communication with visitors or intruders through the camera.

Finalizing Your Security Camera Placement Diagram

After determining optimal camera locations, finalize your diagram by:

- Labeling Camera Types: Indicate what type of camera is placed where (e.g., fixed, PTZ).
- Adding Coverage Zones: Use colored lines or shading to represent the coverage area of each camera.
- Documenting Features: Note any special features of each camera, such as resolution or night vision capabilities.

Example Diagram Placement

To give you a visual reference, here's a simplified example of how you might structure your diagram:

- Front Camera: Facing the front door, covering the porch area.
- Back Camera: Overlooking the back door and patio.
- Driveway Camera: Positioned to monitor vehicles entering and exiting.
- Garage Camera: Focused on the garage door.

Testing and Adjusting Your Setup

Once your cameras are placed and the system is set up, it's essential to test their effectiveness:

1. Check Coverage: Walk around the property to ensure all critical areas are covered without blind spots.
2. Adjust Angles: Fine-tune the camera angles as necessary to capture the best views.
3. Review Footage: Regularly check the recorded footage to ensure that cameras are functioning correctly and capturing clear images.

Conclusion

In conclusion, an outdoor home security camera placement diagram is an invaluable tool for protecting your home. By carefully assessing your property, identifying key entry points, and strategically placing cameras, you can significantly enhance your security. Remember to regularly review and adjust your camera placements as needed to adapt to changes in your environment or security needs. With the right setup, you can gain peace of mind knowing that your home is well-monitored and secure.

Frequently Asked Questions

What are the best locations for installing outdoor home security cameras?

The best locations for outdoor security cameras include entry points like doors and windows, driveways, garages, and backyards, as well as areas with high foot traffic.

How high should outdoor security cameras be mounted?

Outdoor security cameras should generally be mounted at a height of 8 to 10 feet to avoid tampering while still capturing clear images.

Should I place security cameras in hidden spots?

While hidden cameras can catch intruders off guard, it's often more effective to install cameras in visible locations as a deterrent.

How can I ensure my outdoor security cameras have a clear view?

Ensure that cameras are positioned to avoid obstructions like trees or buildings, and angle them to cover wide areas, focusing on critical entry points.

Is it necessary to have outdoor security cameras with night vision?

Yes, having night vision capabilities is essential for monitoring areas in low light conditions, ensuring full coverage 24/7.

What should I consider regarding camera range and resolution?

Choose cameras with appropriate range to cover desired areas and ensure they have high resolution (1080p or higher) for clear image quality.

How can I protect my outdoor cameras from weather conditions?

Select weatherproof cameras and install them in sheltered areas or use protective housing to shield them from rain, snow, and extreme temperatures.

What is the role of lighting in camera placement?

Good lighting improves image quality; consider placing cameras near motion-activated lights to enhance visibility during nighttime.

How do I create a camera placement diagram?

To create a camera placement diagram, sketch your property layout, mark key entry points, and indicate where each camera will be placed for maximum coverage.

Should I consult a professional for camera placement?

While DIY placement is possible, consulting a professional can provide expert insights on optimal camera locations and system configurations.

Find other PDF article:

<https://soc.up.edu.ph/62-type/Book?dataid=Ztj84-7733&title=this-ugly-yet-beautiful-world-manga.pdf>

Outdoor Home Security Camera Placement Diagram

PACK FOR LIFE **OUTDOOR PRODUCTS**

OUTDOOR PRODUCTS 452U 4052 ...

ITEM LIST - PACK FOR LIFE

OUTDOOR PRODUCTS 452U4052 ...

outdoor_outdoors

1 outdoor Having outdoor activities in winter is a good way to prevent diseases. ...

Shoplist - PACK FOR LIFE

GLOBAL SITE HONG KONG TAIWAN KOREA MYANMAR CHINA CAMBODIA

The Recreation Store | PACK FOR LIFE

OUTDOOR PRODUCTS 452U4052 ...

PACK FOR LIFE

OUTDOOR PRODUCTS 452U4052 ...

ITEM LIST - PACK FOR LIFE

OUTDOOR PRODUCTS 452U4052 ...

outdoor_outdoors

1 outdoor Having outdoor activities in winter is a good way to prevent diseases. ...
2 outdoors Though it is ...

Shoplist - PACK FOR LIFE

GLOBAL SITE HONG KONG TAIWAN KOREA MYANMAR CHINA CAMBODIA

The Recreation Store | PACK FOR LIFE

OUTDOOR PRODUCTS 452U4052 ...

OUTDOOR products

OUTDOOR products ...

vol.1 L'ECHOPPE

OUTDOOR PRODUCTS 452U4052 ...

OUTDOOR

OUTDOOR ProductsforOutdoor OutdoorProducts® 1973 40 ...

Features | PACK FOR LIFE

...
...

OUTDOOR

Nov 8, 2024 · OUTDOOR 1. OUTDOOR 1973 2. ...

Discover the best outdoor home security camera placement diagram to maximize your safety. Optimize your surveillance strategy today! Learn more for expert tips.

[Back to Home](#)