

New Holland 451 Sickle Bar Mower Parts Diagram

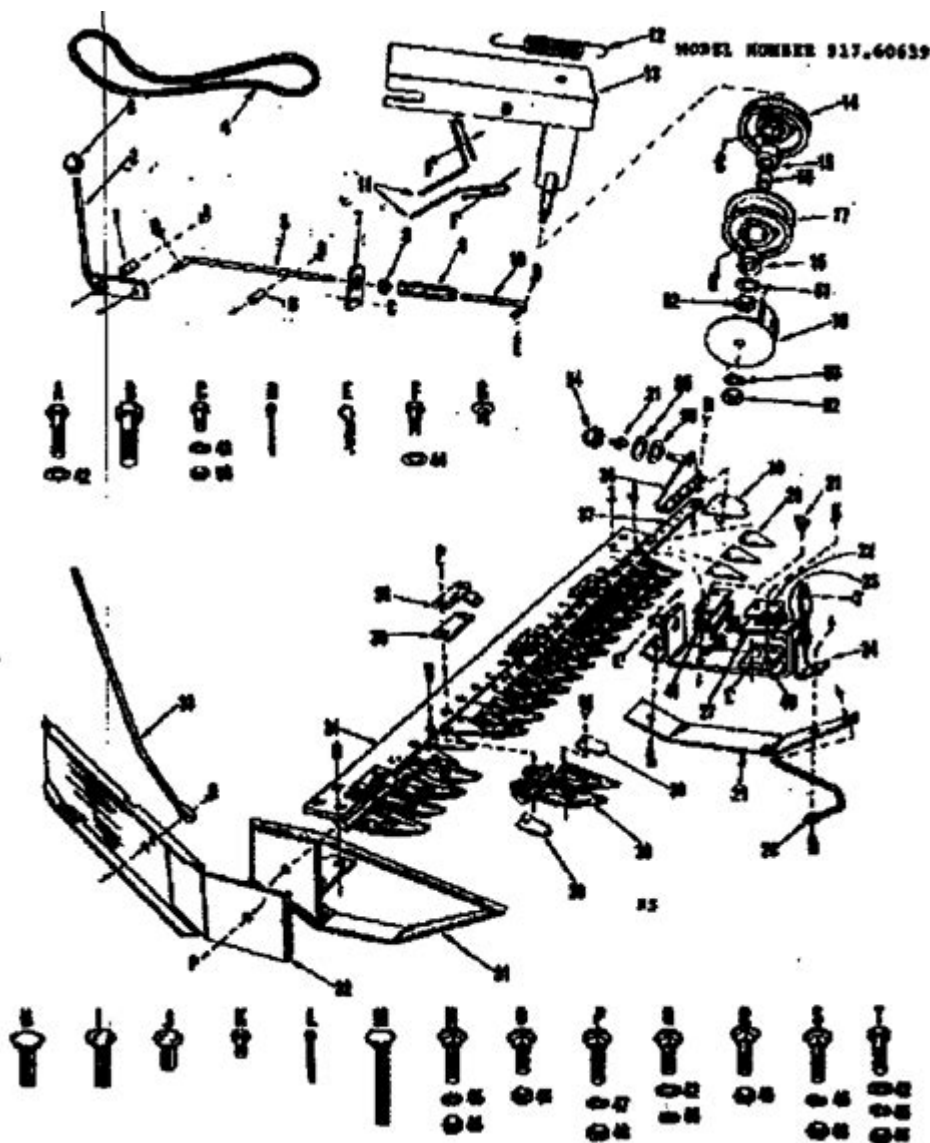

New Holland 451 sickle bar mower parts diagram is a crucial aspect for anyone who owns or operates this type of equipment. Understanding how these parts work together can save time and money on repairs while ensuring the mower performs optimally. In this article, we will delve into the various components of the New Holland 451 sickle bar mower, their functions, and the importance of having a reliable parts diagram for maintenance and repairs.

Overview of the New Holland 451 Sickle Bar Mower

The New Holland 451 sickle bar mower is designed for cutting grass, hay, and other

forage materials efficiently. Its design includes a long, serrated blade that uses a back-and-forth motion to slice through vegetation. This mower is particularly favored by farmers and landowners due to its reliability and ease of use.

Key Features of the New Holland 451

- **Durability:** Built to withstand tough agricultural conditions.
- **Efficiency:** Features a high-speed cutting mechanism for faster mowing.
- **Versatility:** Can be used in various terrains and with different types of vegetation.
- **Ease of Maintenance:** Designed to allow for straightforward repairs and part replacements.

Understanding the Parts of the New Holland 451 Sickle Bar Mower

To maintain and repair the New Holland 451 sickle bar mower effectively, it's essential to understand the various parts. Below is a comprehensive breakdown of its components.

Major Components

1. **Sickle Bar:** The main cutting component, consisting of a series of sharp blades mounted on a horizontal frame.
2. **Cutter Bar:** Supports the sickle blades and provides stability during operation.
3. **Pitman Arm:** Connects the power source to the sickle bar, converting rotational motion into linear motion.
4. **Drive Assembly:** Transfers power from the tractor to the mower.
5. **Gearbox:** Reduces speed while increasing torque to the sickle bar.
6. **Mounting Frame:** Attaches the mower to the tractor and provides structural support.
7. **Skid Shoes:** Help maintain the proper height of the mower during operation.
8. **Safety Guards:** Protect against debris and ensure safe operation.

Additional Components

- **Belts and Pulleys:** Facilitate power transmission throughout the mower.
- **Hydraulic Cylinder:** Used for raising and lowering the mower.
- **Wheels:** Provide mobility and support when transporting the mower.
- **Tensioners:** Maintain appropriate tension in belts and chains.

Importance of the Parts Diagram

A parts diagram is an invaluable tool for anyone working with the New Holland 451 sickle bar mower. Here are several reasons why having access to a detailed parts diagram is important:

1. Simplifies Repairs

Understanding the layout and function of each component allows for more straightforward identification of issues. This can reduce the time spent troubleshooting problems and assist in finding the correct replacement parts.

2. Prevents Mistakes

A clear diagram reduces the likelihood of errors during assembly or disassembly. Knowing where each part fits in helps prevent misalignment or improper installation, which can lead to more significant issues down the line.

3. Facilitates Maintenance

Regular maintenance is crucial for keeping the mower in good working condition. A parts diagram can help identify which components require regular checks and when certain parts may need to be replaced.

4. Increases Efficiency

With a thorough understanding of the mower's parts, operators can work more efficiently. This knowledge can lead to quicker repairs, allowing for less downtime during the mowing season.

Where to Find the Parts Diagram

Locating a parts diagram for the New Holland 451 sickle bar mower can be done through various sources:

1. Owner's Manual: The first place to check should always be the owner's manual provided with the mower. This document often contains detailed diagrams and specifications for all parts.
2. Manufacturer's Website: New Holland's official website usually has resources, including

parts diagrams, downloadable manuals, and technical support.

3. **Agricultural Equipment Dealers:** Local dealers often have parts catalogs that include diagrams. They can assist in identifying parts and may offer repair services.
4. **Online Forums and Communities:** There are numerous online platforms where farmers and equipment operators share information. Websites like TractorByNet or specific Facebook groups can provide valuable insights and often have shared diagrams.
5. **Parts Supply Websites:** Websites specializing in agricultural machinery parts often have diagrams available for reference, making it easy to find what you need.

Common Replacement Parts for the New Holland 451

Understanding which parts are commonly replaced can help you prepare for maintenance and repairs. Here are some frequently needed replacement parts for the New Holland 451 sickle bar mower:

1. **Blades:** Over time, the sickle blades can become dull or damaged and need to be replaced for optimal cutting performance.
2. **Pitman Arms:** These can wear out and may need replacement if they show signs of bending or breakage.
3. **Belts:** Worn or frayed belts can affect the mower's performance, making them necessary to replace regularly.
4. **Hydraulic Components:** Seals and cylinders may wear out with use, requiring replacement to ensure proper functioning.
5. **Gearbox Components:** Gears and bearings within the gearbox may need to be replaced if they show signs of wear.

Maintenance Tips

To extend the life of your New Holland 451 sickle bar mower, consider the following maintenance tips:

- **Regular Inspection:** Check the mower before each use for any signs of wear or damage.
- **Keep Blades Sharp:** Ensure that sickle blades are sharpened regularly for efficient cutting.
- **Lubricate Moving Parts:** Regularly lubricate all moving parts to reduce friction and wear.
- **Clean After Use:** Remove debris and grass from the mower after each use to prevent rust and buildup.
- **Store Properly:** When not in use, store the mower in a dry, sheltered area to protect it

from the elements.

Conclusion

Understanding the components of the New Holland 451 sickle bar mower and having access to a detailed parts diagram is essential for effective maintenance and repairs. By familiarizing yourself with the parts and their functions, you can ensure your mower operates efficiently, ultimately saving time and money. Whether you're a seasoned operator or a new owner, knowing where to find resources and how to maintain your equipment can lead to a more productive mowing season.

Frequently Asked Questions

What is a sickle bar mower and how does it work?

A sickle bar mower is a type of agricultural equipment used for cutting grass or crops. It utilizes a series of sharp blades mounted on a bar that oscillate back and forth to cut through vegetation efficiently.

Where can I find a parts diagram for the New Holland 451 sickle bar mower?

You can find a parts diagram for the New Holland 451 sickle bar mower on the official New Holland website, in the owner's manual, or through agricultural equipment parts retailers.

What are the common replacement parts for the New Holland 451 sickle bar mower?

Common replacement parts for the New Holland 451 sickle bar mower include sickle sections, guards, drive belts, and bearings.

How can I identify the parts I need from the New Holland 451 parts diagram?

You can identify parts by matching the part numbers listed in the diagram with those in the parts catalog or by consulting with a dealer for assistance.

What maintenance should I perform on my New Holland 451 sickle bar mower?

Regular maintenance includes checking and sharpening the blades, lubricating moving parts, inspecting belts for wear, and ensuring proper tension on the drive system.

Is there a user manual available for the New Holland 451 sickle bar mower?

Yes, a user manual for the New Holland 451 sickle bar mower can typically be found online through the New Holland website or from authorized dealers.

What tools do I need to replace parts on the New Holland 451 sickle bar mower?

Tools commonly needed include wrenches, sockets, pliers, and possibly a torque wrench for specific bolt specifications.

Can I use aftermarket parts for my New Holland 451 sickle bar mower?

Yes, aftermarket parts are available for the New Holland 451 sickle bar mower, but it's important to ensure they meet quality standards to maintain performance.

What should I do if I can't find the part I need for the New Holland 451?

If you can't find the part, consider contacting a New Holland dealer for assistance, checking online marketplaces, or looking for salvage parts from older mowers.

Find other PDF article:

<https://soc.up.edu.ph/47-print/Book?trackid=aqR62-4412&title=plot-of-harry-potter-and-the-goblet-of-fire.pdf>

[New Holland 451 Sickle Bar Mower Parts Diagram](#)

Create a Gmail account - Google Help

Important: Before you set up a new Gmail account, make sure to sign out of your current Gmail account. Learn how to sign out of Gmail. From your device, go to the Google Account sign in ...

What is the 'new' keyword in JavaScript? - Stack Overflow

The new keyword in JavaScript can be quite confusing when it is first encountered, as people tend to think that JavaScript is not an object-oriented programming language. What is it? What ...

byrut.rog byrut.rog byrut.rog

May 1, 2025 · byrut.rog byrut.rog byrut.rog

wland -

Sep 6, 2024 · wland Wland 1. **

bigbang - ...

Aug 15, 2014 · bigbang BigBang Ye the finally I realize that I'm nothing without you I was so ...

How to recover your Google Account or Gmail

To find your username, follow these steps. You need to know: A phone number or the recovery email address for the account. The full name on your account. Follow the instructions to ...

- ...

Dec 10, 2024 · 1. AlabamaAL2. AlaskaAK3. ArizonaAZ4. Arkansas ...

edge,?_

Nov 22, 2024 · edge? Edge ...

Download and install Google Chrome

How to install Chrome Important: Before you download, you can check if Chrome supports your operating system and other system requirements.

Sign in to Gmail - Computer - Gmail Help - Google Help

Sign in to Gmail Tip: If you sign in to a public computer, make sure to sign out before you leave the computer. Learn how to sign in on a device that's not yours.

Create a Gmail account - Google Help

Important: Before you set up a new Gmail account, make sure to sign out of your current Gmail account. Learn how to sign out of Gmail. From your device, go to the Google Account sign in ...

What is the 'new' keyword in JavaScript? - Stack Overflow

The new keyword in JavaScript can be quite confusing when it is first encountered, as people tend to think that JavaScript is not an object-oriented programming language. What is it? What ...

byrut.rog byrut_

May 1, 2025 · byrut.rog byrut

wland - ...

Sep 6, 2024 · wlandWland1. ** ...

bigbang - ...

Aug 15, 2014 · bigbang BigBang Ye the finally I realize that I'm nothing without you I was so ...

How to recover your Google Account or Gmail

To find your username, follow these steps. You need to know: A phone number or the recovery email address for the account. The full name on your account. Follow the instructions to ...

- ...

Dec 10, 2024 · 1. AlabamaAL2. AlaskaAK3. ArizonaAZ4. Arkansas ...

edge,?_

Download and install Google Chrome

How to install Chrome Important: Before you download, you can check if Chrome supports your operating system and other system requirements.

Sign in to Gmail - Computer - Gmail Help - Google Help

Sign in to Gmail Tip: If you sign in to a public computer, make sure to sign out before you leave the computer. Learn how to sign in on a device that's not yours.

Discover the complete New Holland 451 sickle bar mower parts diagram. Find detailed information and enhance your mower's performance. Learn more today!

[Back to Home](#)