

New Idea 5209 Parts Manual

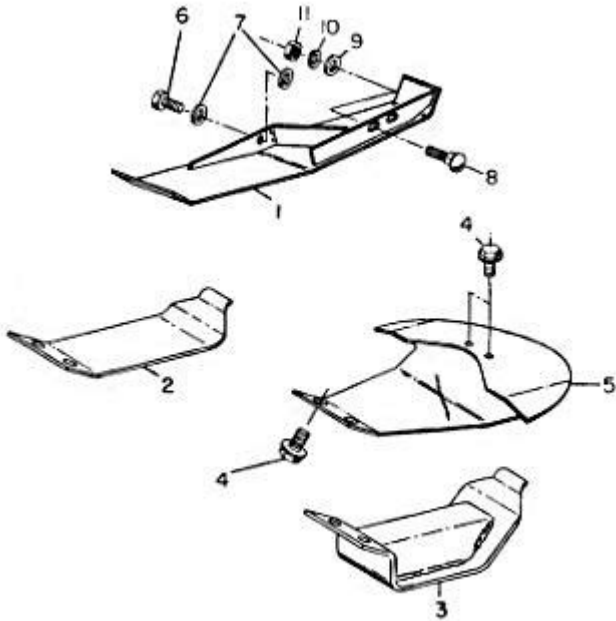

New Idea 5209 Parts Manual is an essential resource for owners and operators of the New Idea 5209 hay conditioner, a piece of agricultural equipment known for its efficiency and durability in hay production. This parts manual serves as a comprehensive guide to the various components of the machine, providing detailed information that helps users maintain, repair, and optimize the performance of their equipment. In this article, we will delve into the significance of the parts manual, its structure, and how to effectively utilize it for maintenance and repair purposes.

Understanding the New Idea 5209 Hay Conditioner

The New Idea 5209 is a versatile hay conditioner designed for farmers seeking to improve the drying process of hay. It utilizes a unique conditioning system that crushes and fluffs the hay, allowing for faster drying times and improved quality of the final product. The machine's design and functionality are geared towards maximizing efficiency and reducing the time required for hay production.

Key Features of the New Idea 5209

- **Heavy-Duty Construction:** Built with robust materials to withstand the rigors of agricultural work.
- **Adjustable Conditioning Rollers:** Allows operators to customize the conditioning process according to the type of hay being processed.
- **Easy-to-Use Controls:** Simplifies operation for both experienced and novice users.
- **Wide Cutting Width:** Increases the amount of hay processed in a single pass, enhancing productivity.
- **Efficient Power Use:** Designed to work effectively with various tractor models, optimizing fuel consumption.

The Importance of the Parts Manual

The parts manual for the New Idea 5209 is more than just a list of components; it is an invaluable tool for anyone involved in the operation and maintenance of the machine. Here are several key reasons why this manual is critical:

- Identifies Components: The manual provides detailed diagrams and descriptions of every part, ensuring users can easily identify components that need maintenance or replacement.
- Guides Repairs: Step-by-step instructions on how to perform repairs help users address issues efficiently, reducing downtime.
- Maintenance Schedule: The manual outlines routine maintenance tasks, helping to prolong the life of the machine and prevent costly repairs.
- Compatibility Information: Users can find information on compatible parts, which is essential for making informed purchasing decisions.

Structure of the Parts Manual

The New Idea 5209 parts manual is organized into several sections, each designed to provide specific information:

1. Introduction:
 - Overview of the machine and its applications.
 - Importance of proper maintenance and parts replacement.
2. Parts Identification:
 - Comprehensive list and diagrams of all parts.
 - Reference numbers for easy ordering.
3. Maintenance Procedures:
 - Routine maintenance tasks.
 - Troubleshooting common issues.
4. Repair Instructions:
 - Step-by-step guides for common repairs.
 - Safety precautions to follow during repairs.
5. Parts Ordering Information:
 - Guidelines on how to order replacement parts.
 - Contact information for parts suppliers.

How to Use the Parts Manual Effectively

To get the most out of the New Idea 5209 parts manual, follow these guidelines:

1. Familiarize Yourself with the Manual

Before diving into repairs or maintenance, take the time to read through the manual. Understanding its layout will make it easier to find information when you need it.

2. Keep the Manual Accessible

Store the manual in a location that is easy to access, such as your workshop or equipment shed. This ensures that you can refer to it whenever necessary.

3. Use Diagrams for Reference

When working on the machine, utilize the diagrams provided in the manual. These visuals can help you locate parts quickly and understand how they fit together.

4. Follow Maintenance Schedules

Adhere to the maintenance schedules outlined in the manual. Regular maintenance can help prevent mechanical failures and extend the life of your equipment.

5. Document Repairs and Replacements

Keep a log of repairs and parts replacements. This documentation can be useful for tracking the machine's history and for future reference.

Common Issues and Troubleshooting

Despite its reliable design, the New Idea 5209 may experience some common issues. The parts manual offers troubleshooting tips to help operators diagnose and resolve these problems effectively.

1. Poor Conditioning of Hay

- Potential Causes:
 - Worn or misaligned conditioning rollers.
 - Incorrect adjustments on the machine.
- Solutions:

- Inspect rollers for wear and replace if necessary.
- Ensure proper alignment and adjustments according to the manual.

2. Machine Not Cutting Properly

- Potential Causes:
 - Dull blades or improper blade height.
 - Obstructions in the cutting mechanism.
- Solutions:
 - Sharpen or replace blades as needed.
 - Clear any debris or obstructions that may impede cutting.

3. Excessive Vibration During Operation

- Potential Causes:
 - Imbalance in the rotor assembly.
 - Loose or damaged parts.
- Solutions:
 - Check and balance the rotor assembly.
 - Tighten or replace any loose or damaged components.

Conclusion

The New Idea 5209 Parts Manual is an indispensable resource for anyone operating or maintaining this hay conditioner. By providing detailed information on parts, maintenance procedures, and troubleshooting tips, the manual empowers users to keep their equipment running smoothly and efficiently. Regularly consulting the parts manual and following its guidelines can significantly enhance the longevity and performance of the New Idea 5209, ultimately contributing to a more productive hay production process. Whether you are an experienced farmer or a newcomer to the industry, understanding and utilizing the parts manual is essential for achieving the best results with your equipment.

Frequently Asked Questions

What is the purpose of the New Idea 5209 Parts Manual?

The New Idea 5209 Parts Manual serves as a comprehensive guide for identifying and ordering replacement parts for the New Idea 5209 equipment, ensuring proper maintenance and repair.

Where can I find the New Idea 5209 Parts Manual?

The New Idea 5209 Parts Manual can typically be found through agricultural equipment dealers, online retailers specializing in tractor parts, or official manufacturer websites.

Are there digital versions of the New Idea 5209 Parts Manual available?

Yes, many websites offer downloadable PDF versions of the New Idea 5209 Parts Manual, making it easier to access and reference the information on various devices.

What kind of parts are included in the New Idea 5209 Parts Manual?

The manual includes a variety of parts such as gears, belts, bearings, and other essential components necessary for the operation and maintenance of the New Idea 5209 machinery.

How can I use the New Idea 5209 Parts Manual to troubleshoot issues?

You can use the New Idea 5209 Parts Manual to identify specific components that may be malfunctioning, locate part numbers for replacements, and follow diagrams for troubleshooting steps.

Is the New Idea 5209 Parts Manual suitable for beginners?

Yes, the New Idea 5209 Parts Manual is designed to be user-friendly, with clear diagrams and descriptions that can assist beginners in understanding their equipment and finding the right parts.

Find other PDF article:

<https://soc.up.edu.ph/23-write/pdf?dataid=PcU53-2401&title=free-online-hazmat-training-for-firefighthers.pdf>

[New Idea 5209 Parts Manual](#)

Create a Gmail account - Google Help

Important: Before you set up a new Gmail account, make sure to sign out of your current Gmail account. Learn how to sign out of Gmail. From your device, go to the Google Account ...

What is the 'new' keyword in JavaScript? - Stack Overflow

The new keyword in JavaScript can be quite confusing when it is first encountered, as people tend to think that JavaScript is not an object-oriented programming language. ...

byrut.rog byrut

May 1, 2025 · byrut.rog byrut

wland -

Sep 6, 2024 · wlandWland1. **

bigbang _

Aug 15, 2014 · bigbangBigBang Ye the finally I realize that I'm nothing without you I was so wrong forgive ...

Create a Gmail account - Google Help

Important: Before you set up a new Gmail account, make sure to sign out of your current Gmail account. Learn how to sign out of Gmail. From your device, go to the Google Account sign in page. Click Create account. In the drop down, select if the account is for your: Personal use Child Work or business To set up your account, follow the steps on the screen.

What is the 'new' keyword in JavaScript? - Stack Overflow

The new keyword in JavaScript can be quite confusing when it is first encountered, as people tend to think that JavaScript is not an object-oriented programming language. What is it? What problems ...

byrut.rog byrut_

May 1, 2025 · byrut.rog byrut

wland -

Sep 6, 2024 · wlandWland1. **

bigbang _ ...

Aug 15, 2014 · bigbangBigBang Ye the finally I realize that I'm nothing without you I was so wrong forgive me ah ah ah ah- [V

How to recover your Google Account or Gmail

To find your username, follow these steps. You need to know: A phone number or the recovery email address for the account. The full name on your account. Follow the instructions to confirm it's your account. You'll find a list of usernames that match your account.

-

Dec 10, 2024 · 1. AlabamaAL2. AlaskaAK3. ArizonaAZ4. ArkansasAR5. CaliforniaCA6.

edge,?

Nov 22, 2024 · edge? Edge

Download and install Google Chrome

How to install Chrome Important: Before you download, you can check if Chrome supports your operating system and other system requirements.

Sign in to Gmail - Computer - Gmail Help - Google Help

Sign in to Gmail Tip: If you sign in to a public computer, make sure to sign out before you leave the computer. Learn how to sign in on a device that's not yours.

Unlock the full potential of your equipment with the New Idea 5209 parts manual. Discover how to

optimize performance and maintenance today!

[Back to Home](#)