

Murray M155 42 Belt Diagram

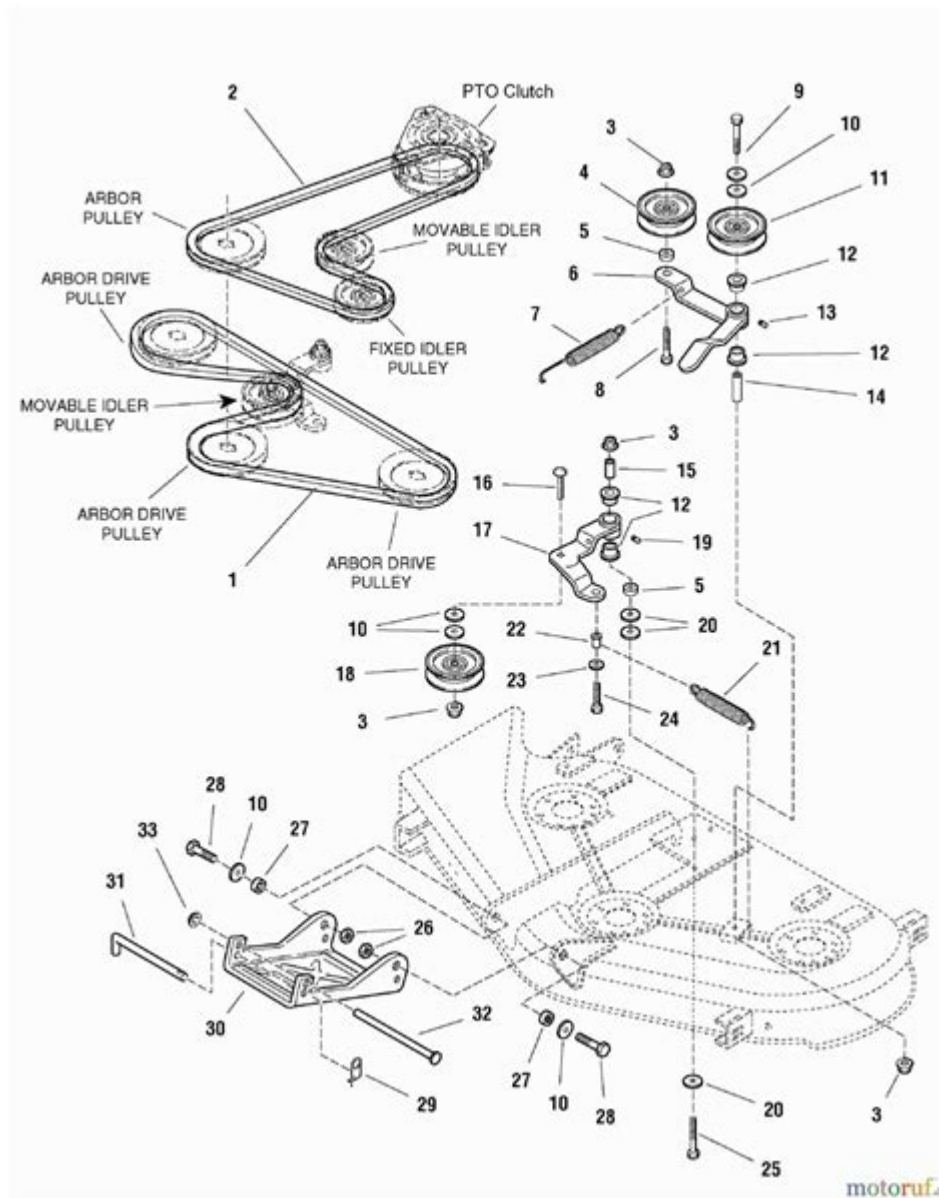

Murray M155 42 Belt Diagram is an essential component for understanding the functionality and maintenance of your Murray lawnmower. The M155 model, designed for efficiency and ease of use, features a range of mechanisms that rely on belts to operate smoothly. This article will explore the nuances of the M155 42 belt diagram, including its components, maintenance tips, and troubleshooting techniques that can help you keep your mower in optimal condition.

Understanding the Murray M155 42 Lawn Mower

The Murray M155 42 is a riding lawn mower equipped with a 42-inch cutting deck, designed to tackle medium to large lawns effectively. This mower features a powerful engine and a user-friendly design, making it a popular choice among homeowners. Understanding the belt system is crucial for ensuring that the mower operates efficiently and that you can maintain it properly.

Components of the M155 Belt System

The belt system in the Murray M155 consists of several critical components:

1. Drive Belt: This belt connects the engine to the transmission and allows the mower to move.
2. Deck Belt: This belt runs from the engine to the mower's cutting deck, enabling the blades to rotate.
3. Idler Pulley: The idler pulley helps maintain tension on the belts, ensuring they do not slip during operation.
4. Spindle Pulleys: These are attached to the mower blades and help transfer power from the deck belt to the blades.
5. Brake Components: These include the brake pads and levers that ensure the mower can stop safely.

Understanding each of these components is essential for proper maintenance and troubleshooting when issues arise.

The Importance of the Belt Diagram

The Murray M155 42 belt diagram serves as a visual representation of how the belts are arranged and interact with other components within the mower. This diagram is invaluable for several reasons:

- Installation: It provides a clear reference when installing or replacing belts, ensuring they are routed correctly.
- Maintenance: By understanding how the belts fit together, you can identify wear and tear or other issues that may arise over time.
- Troubleshooting: If the mower experiences performance issues, the diagram can help you pinpoint potential problems within the belt system.

Where to Find the Belt Diagram

The belt diagram for the Murray M155 can typically be found in several places:

- Owner's Manual: The first place to check is the owner's manual, which often contains detailed diagrams and instructions.
- Manufacturer's Website: You can often download a PDF version of the owner's manual or find the diagram specifically on the Murray website.
- Local Dealers: Authorized Murray dealers can provide diagrams and may even have printed copies available for customers.
- Online Forums and Communities: Many lawn care enthusiasts share diagrams and tips in online forums, which can be a valuable resource.

Replacing the Belts on the Murray M155

When it comes time to replace the belts on your Murray M155, following a methodical approach is essential to ensure proper installation and function. Here's a step-by-step guide:

Tools Required

- Socket wrench set
- Screwdrivers (Phillips and flathead)
- Replacement belts
- Belt diagram (for reference)

Steps for Replacing the Belts

1. **Safety First:** Disconnect the spark plug wire to prevent accidental starting while you work on the mower.
2. **Remove the Deck:** Depending on your model, you may need to detach the mower deck to access the belts. This usually involves removing bolts and releasing tension on the deck lift.
3. **Inspect Existing Belts:** Before installing new belts, inspect the old ones for wear and tear. Take note of how they are routed for your reference.
4. **Remove Old Belts:** Carefully remove the old belts from the pulleys and idler. Make sure to release any tension before attempting to remove them.
5. **Install New Belts:** Using the Murray M155 42 belt diagram as a guide, install the new belts into the correct positions. Ensure they are seated properly in all pulleys.
6. **Reattach the Deck:** If you removed the mower deck, reattach it securely, ensuring all bolts are tightened.
7. **Reconnect Spark Plug:** Finally, reconnect the spark plug wire and perform a test run to ensure everything is functioning correctly.

Maintenance Tips for the Belt System

Regular maintenance of the belt system is crucial for the longevity and performance of your Murray M155. Here are some tips to keep your mower in top shape:

- **Regular Inspections:** Check the belts regularly for signs of wear, such as cracks, fraying, or stretching. Replace them as needed.
- **Clean the Area:** Keep the area around the pulleys and belts free from debris and grass clippings, which can cause overheating and wear.
- **Check Tension:** Periodically check the tension of the belts to ensure they are tight enough to function properly but not so tight that they cause undue strain on the components.
- **Lubricate Pulleys:** Ensure the pulleys and idler are lubricated periodically to minimize friction and wear.
- **Follow the Manual:** Always refer to the owner's manual for specific maintenance intervals and guidelines for your model.

Troubleshooting Common Belt Issues

Even with regular maintenance, you may encounter issues with the belt system on your Murray M155. Here are some common problems and how to troubleshoot them:

Slipping Belts

- Symptoms: The mower may lose power, and you might hear a squealing noise.
- Solution: Check belt tension and adjust or replace if necessary. Ensure that all pulleys are clean and free from debris.

Broken Belts

- Symptoms: The mower will not operate, and you may find a broken belt when inspecting.
- Solution: Replace the broken belt following the diagram for proper routing.

Uneven Cutting

- Symptoms: The mower may leave uncut patches or cut unevenly.
- Solution: Inspect the deck belt and spindle pulleys for proper function and alignment. Ensure that the blades are sharp and properly attached.

Conclusion

The Murray M155 42 belt diagram is a vital tool for any owner of this reliable mower. Understanding how the belt system works and how to maintain it can significantly enhance the performance and longevity of your equipment. Regular inspections, timely replacements, and adherence to maintenance tips will ensure that your Murray M155 operates smoothly, allowing you to keep your lawn looking pristine. Whether you are a seasoned lawn care professional or a homeowner just starting, being informed about your mower's belt system will empower you to tackle maintenance confidently.

Frequently Asked Questions

What is the purpose of the belt diagram for the Murray M155 42 mower?

The belt diagram shows the correct routing of the drive belt in the Murray M155 42 mower, ensuring proper operation of the cutting deck and drive system.

Where can I find the belt diagram for the Murray M155 42?

The belt diagram can typically be found in the owner's manual, or it can be accessed online through Murray's official website or various lawn care forums.

What are common issues related to the belt on the Murray M155 42?

Common issues include belt slippage, breakage, or improper routing, which can lead to poor cutting performance or damage to the mower.

How often should the drive belt be replaced on the Murray M155 42?

The drive belt should be inspected regularly and replaced when signs of wear, fraying, or damage are evident, usually every 1-2 years depending on usage.

Can I use a generic belt diagram for the Murray M155 42?

It is recommended to use the specific belt diagram for the Murray M155 42 to ensure proper fit and function, as generic diagrams may not match the exact routing required.

What tools do I need to replace the belt on the Murray M155 42?

You will typically need basic hand tools such as wrenches, sockets, and possibly a screwdriver to remove covers and access the belt.

What are the steps to follow when installing a new belt using the diagram?

Follow the belt diagram to route the new belt around the pulleys, ensuring it is properly seated and tensioned; refer to the manual for specific installation steps.

Is it necessary to remove the deck to replace the belt on the Murray M155 42?

In many cases, it is easier to remove the mower deck to access the belt, but it may be possible to replace it without removing the deck depending on your skill level.

What are the signs that my Murray M155 42 belt needs replacing?

Signs include visible wear, cracks, fraying, or if the mower fails to drive or cut efficiently.

Are there any safety precautions to take when working with the belt on the Murray M155 42?

Always disconnect the spark plug before starting any maintenance, wear gloves, and ensure the

mower is on a stable surface to prevent accidents.

Find other PDF article:

<https://soc.up.edu.ph/52-snap/pdf?ID=RKs70-0075&title=sat-subject-test-biology-practice-questions.pdf>

Murray M155 42 Belt Diagram

Cambridge Murray Edwards Mathematics - 100% offer

Cambridge Murray Edwards Mathematics 100% offer

Gordon Murray T50 - 100%

Gordon Murray, F1 T50 Gordon Murray T50 Gordon Murray "Gordon Murray T50" Gordon Murray T50

Murray Edwards - 100%

Sep 16, 2021 · Homerton College 28.2% 1976 Girton College Murray Edwards College Murray Edwards

12 - 100%

2015 Jim Murray 2013 SUNTORY NIKKA

Andy Murray - 100%

Andy Murray - Top 10 Only Sir Andy Murray Moments (HD) 13 BBC (Sports personality of 2013) Adidas "Not bad for a man with no personality"

iPhone 16 Pro Max - 100%

iPhone 16 Pro Max

- 100%

(first name), (last name). first name last name Sheldon Cooper) Cooper Sheldon. ...

Murray Perahia - 100%

Murray Perahia 25

Andy Murray - 100%

07 ...

- 100%

Mathematics - Murray Edwards University of Cambridge ...

Mathematics - Murray Edwards University of Cambridge

Cambridge Murray Edwards Mathematics offer

Gordon Murray T50 -

Gordon Murray, F1 T.50 Gordon Murray ...

Murray Edwards -

Sep 16, 2021 · Homerton College 28.2% 1976 ...

12 -

2015 Jim Murray ...

(Andy Murray) -

Andy Murray - Top 10 Only Sir Andy Murray Moments (HD) 13 ...

Discover the essential Murray M155 42 belt diagram for efficient maintenance. Ensure optimal performance and longevity of your mower. Learn more now!

[Back to Home](#)