

Miller Mobile Home Furnace Parts Diagram

Coleman 7900A Series Gas Furnace

HVACpartstore.com 605-229-2627

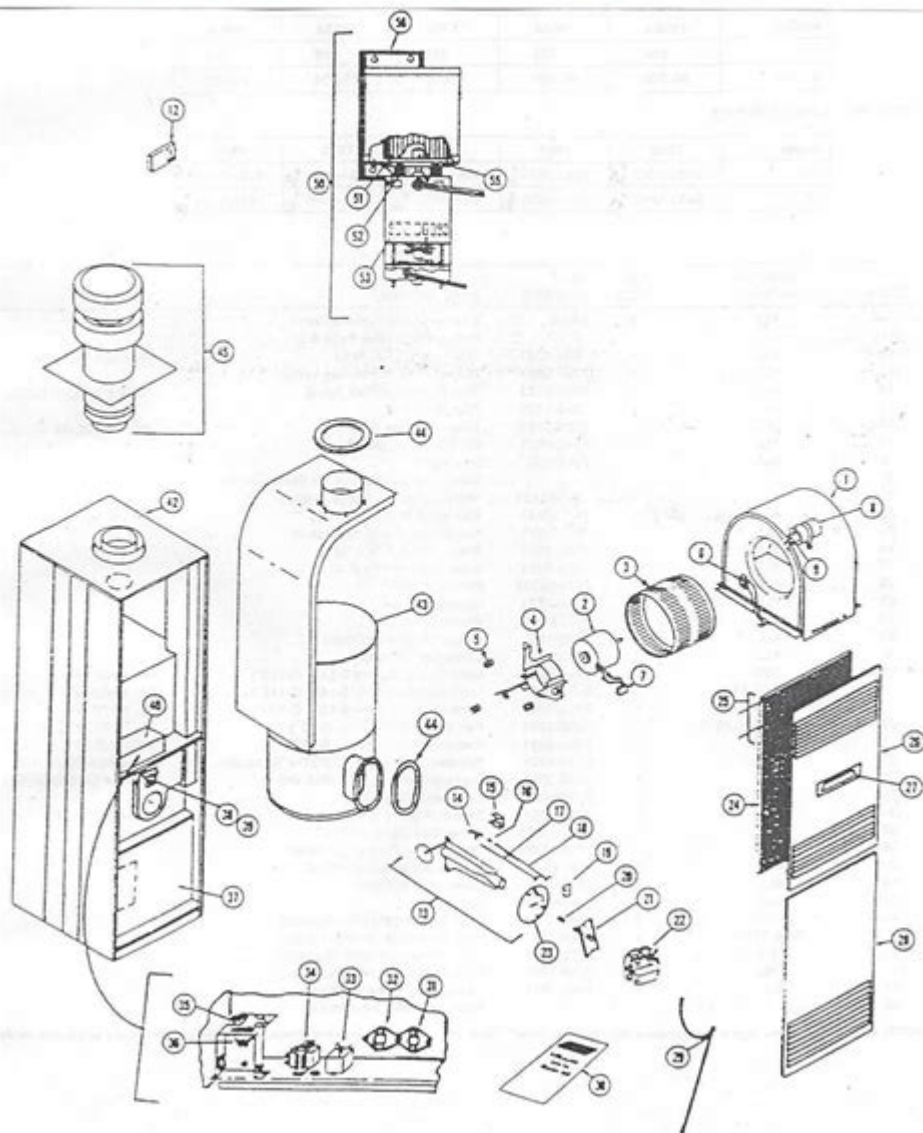

Miller mobile home furnace parts diagram is an essential resource for homeowners and technicians alike, providing a visual representation of the various components that make up a Miller mobile home furnace. Understanding how these parts fit together and function can be crucial for maintenance, troubleshooting, and repairs. This article will delve into the key components of a Miller mobile home furnace, their functions, and tips for proper maintenance, ensuring that your heating system operates efficiently and effectively.

Overview of Miller Mobile Home Furnaces

Miller mobile home furnaces are designed specifically for the unique heating needs of mobile homes. They are compact and efficient, providing reliable warmth during colder months. These furnaces are typically fueled by natural gas, propane, or electricity, making them versatile options for homeowners. Understanding the parts of these furnaces allows users to perform routine maintenance, troubleshoot issues, and ensure longevity.

Key Components of a Miller Mobile Home Furnace

The functionality of a Miller mobile home furnace relies on various components working together. Here's a breakdown of the key parts you'll find in a typical furnace:

1. Blower Assembly

- Fan Motor: The motor drives the blower fan, circulating warm air throughout the mobile home.
- Blower Wheel: This component is attached to the fan motor and helps move air.

2. Heat Exchanger

- Primary Heat Exchanger: This is where the combustion process occurs, transferring heat to the air.
- Secondary Heat Exchanger: In some models, this component allows for additional heat recovery, improving efficiency.

3. Combustion Chamber

- Burners: These components mix fuel and air to create a flame for heating.
- Ignitor: Responsible for lighting the burners; it can be a pilot light or electronic ignition system.

4. Gas Valve

- Main Gas Valve: Regulates the flow of gas to the burners.
- Safety Shutoff: Automatically closes the gas supply in case of a malfunction.

5. Venting System

- Flue Pipe: Channels exhaust gases outside the home.
- Draft Inducer: Helps ensure proper airflow through the furnace and prevents backdrafts.

6. Thermostat

- Temperature Sensor: Monitors the indoor temperature and signals the furnace to turn on or off.
- Control Board: The brain of the furnace, coordinating functions between various components.

7. Filters

- Air Filter: Traps dust and debris, ensuring that only clean air circulates through the furnace.
- Oil Filter: In oil-fired models, this filters impurities from the oil supply.

8. Access Panels

- Front Access Panel: Allows easy access to the blower and heat exchanger for maintenance.
- Side Access Panels: Provide access to the burners and combustion chamber.

Understanding the Miller Mobile Home Furnace Parts Diagram

A Miller mobile home furnace parts diagram is a visual representation that labels and illustrates each of the components discussed above. This diagram is invaluable for anyone looking to understand their furnace better or perform maintenance. Here are key features you'll find in a typical parts diagram:

- Labels: Each part is clearly labeled, making it easy to identify components.
- Connections: Arrows may indicate how parts connect or interact with each other.
- Exploded View: Some diagrams provide an exploded view, showing how parts fit together in a three-dimensional perspective.

Common Issues and Troubleshooting Tips

Understanding the parts of your Miller mobile home furnace can help you troubleshoot common problems. Here are a few issues and tips for resolving them:

1. No Heat

- Check the Thermostat: Ensure it's set to the desired temperature and is functioning correctly.
- Inspect the Blower Motor: If it doesn't turn on, the motor may need replacement.
- Examine the Gas Valve: Ensure it's open and gas is flowing to the burners.

2. Unusual Noises

- Rattling or Banging: This could indicate loose components; check the blower assembly and heat exchanger.
- Squealing: Often a sign of a worn-out blower motor bearing.

3. Poor Airflow

- Clogged Filters: Replace or clean air filters regularly to ensure proper airflow.
- Blocked Vents: Check supply and return vents for obstructions.

4. Frequent Cycling

- Thermostat Issues: A malfunctioning thermostat can cause the furnace to cycle on and off frequently.
- Dirty Air Filters: Clogged filters can restrict airflow, causing overheating and cycling.

Maintenance Tips for Miller Mobile Home Furnaces

Regular maintenance is crucial for the efficient operation of your Miller mobile home furnace. Here are some tips to keep your furnace in top shape:

1. Change Filters Regularly

- Frequency: Replace or clean air filters every 1-3 months, depending on usage and air quality.
- Type: Use the correct filter type as specified by the manufacturer.

2. Schedule Professional Inspections

- Annual Checkup: Have a qualified technician inspect your furnace at least once a year.
- Clean the System: Ensure that the combustion chamber, heat exchanger, and blower assembly are clean.

3. Monitor Thermostat Settings

- Temperature Settings: Make sure your thermostat is set to a comfortable level and is functioning correctly.
- Calibration: If your thermostat is not accurate, consider having it calibrated.

4. Inspect Ventilation

- Check Flue and Vent Pipes: Ensure they are clear of obstructions and in good condition.
- Look for Signs of Damage: Inspect for rust or corrosion, especially at joints.

Conclusion

Understanding the Miller mobile home furnace parts diagram can empower homeowners and technicians to manage their heating systems effectively. By familiarizing themselves with the key components, users can perform routine maintenance, troubleshoot common issues, and ensure their furnace operates efficiently. Regular inspections and proper care will extend the lifespan of the furnace, ensuring comfort during the cold months. Always consult the manufacturer's manual for specific information related to your model, and consider hiring a professional for repairs and maintenance when necessary.

Frequently Asked Questions

What are the main components of a Miller mobile home furnace?

The main components include the burner assembly, heat exchanger, blower motor, control board, and limit switch.

Where can I find a parts diagram for a Miller mobile home furnace?

Parts diagrams can typically be found in the owner's manual, on the manufacturer's website, or by contacting a licensed HVAC technician.

How can I identify the specific model of my Miller mobile home furnace?

You can identify the model by checking the label located on the furnace, usually on the side or door, which includes the model and serial number.

What should I do if I can't find the parts diagram for my Miller furnace?

If you can't find the diagram, consider reaching out to Miller customer support or a local HVAC supplier for assistance.

Are there common repair parts for Miller mobile home furnaces?

Yes, common repair parts include the blower motor, ignitor, flame sensor, and thermostats, which are often easy to replace.

How do I read a Miller mobile home furnace parts diagram?

To read the diagram, familiarize yourself with the symbols representing each component and follow the lines that indicate connections between them.

What is the function of the limit switch in a Miller mobile home furnace?

The limit switch is a safety device that shuts off the furnace if it overheats, preventing potential damage or fire hazards.

Can I get a replacement parts diagram for older

Miller mobile home furnace models?

Yes, replacement diagrams for older models may be available through online forums, vintage HVAC parts suppliers, or directly from Miller.

What safety precautions should I take when working on a Miller mobile home furnace?

Always turn off the power and gas supply, use appropriate tools, and consider consulting a professional if you're unsure about any repairs.

Find other PDF article:

<https://soc.up.edu.ph/41-buzz/pdf?docid=vjV86-7411&title=mithun-technologies-devops-fees.pdf>

Miller Mobile Home Furnace Parts Diagram

Welding A356-T6 Aluminum - Miller Welding Discussion Forums

A place to talk about how-to, techniques, troubleshooting, welding processes, welders, plasma cutters or other metalworking tools.

Flux core versus 7018 stick - Miller Welding Discussion Forums

A place to talk about how-to, techniques, troubleshooting, welding processes, welders, plasma cutters or other metalworking tools.

welding 410 stainless steel - Miller Welding Discussion Forums

Aug 11, 2009 · A place to talk about how-to, techniques, troubleshooting, welding processes, welders, plasma cutters or other metalworking tools.

Argon bottle pressure... - Miller Welding Discussion Forums

A place to talk about how-to, techniques, troubleshooting, welding processes, welders, plasma cutters or other metalworking tools.

Miller Welding Discussion Forums

Miller Welding Discussion Forums Statistics Collapse Topics: 36,346 Posts: 360,383 Members: 74,885 Active Members: 90

Oxy/Acet. aluminum welding - Miller Welding Discussion Forums

Mar 29, 2010 · A place to talk about how-to, techniques, troubleshooting, welding processes, welders, plasma cutters or other metalworking tools.

Welding bearing damage - Miller Welding Discussion Forums

Nov 30, 2011 · A place to talk about how-to, techniques, troubleshooting, welding processes, welders, plasma cutters or other metalworking tools.

aluminum and spatter - Miller Welding Discussion Forums

Whether you want to build it or fix it - share advice, ideas, plans and photos.

Welding Aluminum with Oxy/Acetylene - Miller Welding ...

Miller Millermatic Passport Miller Spot Welder Motor-Guard stud welder Smith, Meco, Oxweld , Cronatron, Harris, Victor, National, Prest-o-weld, Prest-o-lite, Marquette, Century Aircraft, ...

How far should tungsten stick out? - Miller Welding Discussion ...

May 14, 2009 · A place to talk about how-to, techniques, troubleshooting, welding processes, welders, plasma cutters or other metalworking tools.

Welding A356-T6 Aluminum - Miller Welding Discussion Forums

A place to talk about how-to, techniques, troubleshooting, welding processes, welders, plasma cutters or other metalworking tools.

Flux core versus 7018 stick - Miller Welding Discussion Forums

A place to talk about how-to, techniques, troubleshooting, welding processes, welders, plasma cutters or other metalworking tools.

welding 410 stainless steel - Miller Welding Discussion Forums

Aug 11, 2009 · A place to talk about how-to, techniques, troubleshooting, welding processes, welders, plasma cutters or other metalworking tools.

Argon bottle pressure... - Miller Welding Discussion Forums

A place to talk about how-to, techniques, troubleshooting, welding processes, welders, plasma cutters or other metalworking tools.

Miller Welding Discussion Forums

Miller Welding Discussion Forums Statistics Collapse Topics: 36,346 Posts: 360,383 Members: 74,885 Active Members: 90

Oxy/Acet. aluminum welding - Miller Welding Discussion Forums

Mar 29, 2010 · A place to talk about how-to, techniques, troubleshooting, welding processes, welders, plasma cutters or other metalworking tools.

Welding bearing damage - Miller Welding Discussion Forums

Nov 30, 2011 · A place to talk about how-to, techniques, troubleshooting, welding processes, welders, plasma cutters or other metalworking tools.

aluminum and spatter - Miller Welding Discussion Forums

Whether you want to build it or fix it - share advice, ideas, plans and photos.

Welding Aluminum with Oxy/Acetylene - Miller Welding ...

Miller Millermatic Passport Miller Spot Welder Motor-Guard stud welder Smith, Meco, Oxweld , Cronatron, Harris, Victor, National, Prest-o-weld, Prest-o-lite, Marquette, Century Aircraft, Craftsman, Goss, Uniweld, Purox, Linde, Eutectic, and Dillon welding torches from 1909 to Present. (58 total) Portable Welder Senior Member Join Date: Aug 2004 ...

How far should tungsten stick out? - Miller Welding Discussion ...

May 14, 2009 · A place to talk about how-to, techniques, troubleshooting, welding processes, welders, plasma cutters or other metalworking tools.

Explore our comprehensive guide on the Miller mobile home furnace parts diagram. Discover essential components and troubleshooting tips. Learn more today!

[Back to Home](#)