

Mercury Outboard Shift Linkage Diagram

GEAR SHIFT LINKAGE

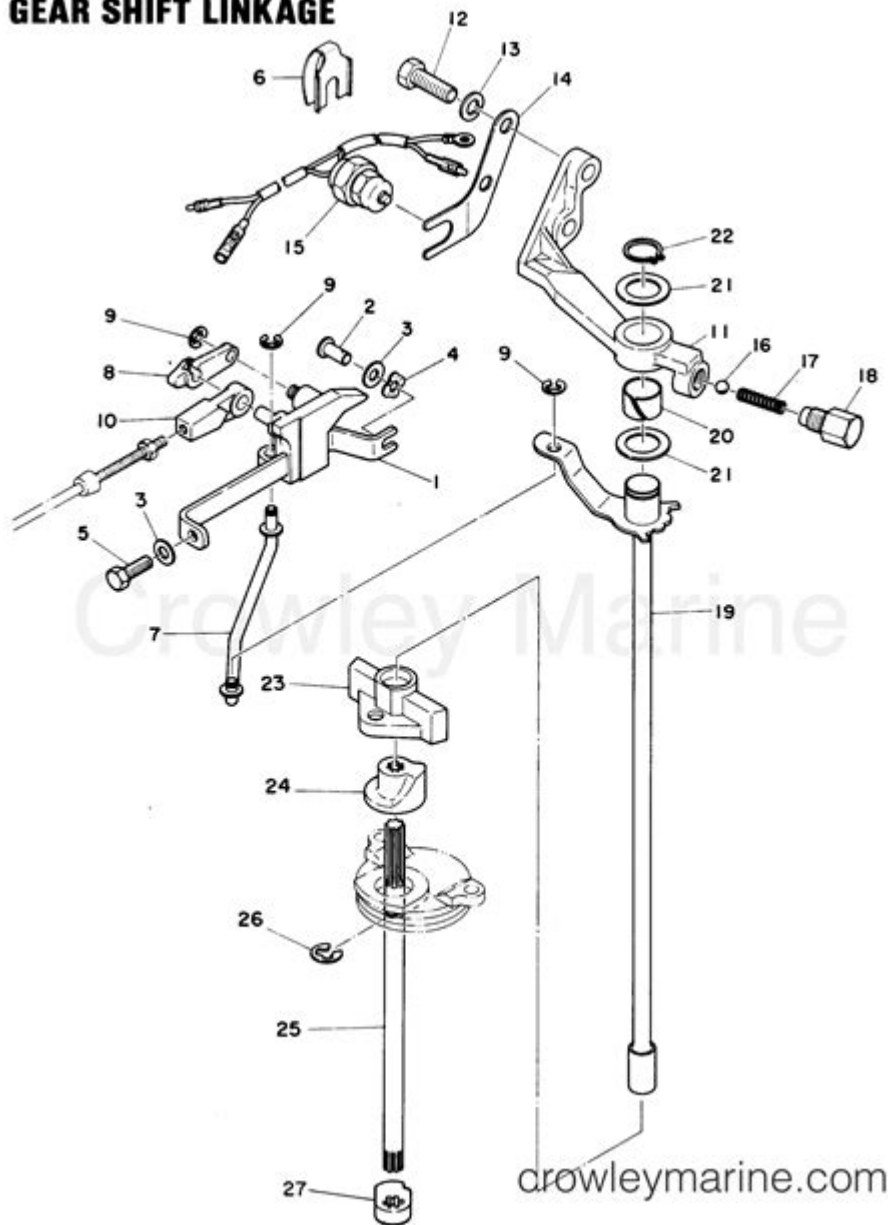

Mercury outboard shift linkage diagram is a crucial component for understanding how to operate and maintain Mercury outboard motors. Shift linkages play an essential role in the functionality of these motors, affecting shifting precision, performance, and overall reliability. This article aims to provide an in-depth look at the shift linkage system, its components, how to interpret the diagrams, and tips for maintenance.

Understanding the Shift Linkage System

The shift linkage system in a Mercury outboard motor connects the gear shifting mechanism to the throttle, allowing the operator to change gears effectively. This system is made up of several components that work together to ensure smooth operation when shifting between forward, neutral,

and reverse gears.

Key Components of the Shift Linkage

To understand the shift linkage system, it's important to familiarize yourself with its key components. Here's a list of the essential parts:

1. Shift Lever: The control that the operator manipulates to change gears.
2. Shift Cables: Flexible cables that transmit movement from the shift lever to the lower unit.
3. Shift Rod: A metal rod that connects the shift cables to the gear mechanism in the lower unit.
4. Lower Unit: The part of the outboard that houses the gears and propeller.
5. Shift Linkage Bracket: A mounting point for the shift rod and other linkage components.
6. Pinion Gear: Engages with the gear mechanism to shift between forward, neutral, and reverse.

Mercury Outboard Shift Linkage Diagram Overview

A Mercury outboard shift linkage diagram visually represents how these components connect and interact. It provides a schematic that can help troubleshoot issues, perform maintenance, or replace parts. Understanding this diagram is vital for any outboard motor owner or technician.

Interpreting the Diagram

When looking at a shift linkage diagram, you will typically see:

- Lines and Arrows: Indicate the direction of movement for various components.
- Labels: Identify each part, often with part numbers for easy reference.
- Connections: Show how the different components are linked, often depicting the mechanical motion involved.

For instance, the diagram may illustrate how the shift lever moves the shift cables, which in turn adjusts the position of the shift rod in the lower unit, engaging the appropriate gear.

Common Issues with Shift Linkages

Understanding potential issues with the shift linkage can help in maintenance and repairs. Here are some common problems that may arise:

- **Sticking or Binding:** This can occur when the shift cables are not properly lubricated or are damaged.
- **Misalignment:** If the shift rod is not aligned correctly, it may lead to difficulty in shifting gears.

- **Worn Components:** Over time, components such as the shift lever or cables may wear out, causing inefficient gear changes.
- **Corrosion:** Exposure to water and salt can cause rust and corrosion, affecting the performance of the shift linkage.

Maintenance Tips for Shift Linkage

Proper maintenance of the shift linkage system is essential for ensuring smooth operation and longevity. Here are some valuable tips:

1. **Regular Inspection:** Periodically check all components for wear and tear, ensuring that nothing is loose or damaged.
2. **Lubrication:** Apply appropriate marine-grade lubricant to the shift cables and joints to prevent sticking and corrosion.
3. **Alignment Check:** Ensure that the shift rod and other components are properly aligned for optimal functioning.
4. **Cleanliness:** Keep the area around the shift linkage clean to prevent dirt and debris from causing issues.
5. **Replacement of Worn Parts:** Don't hesitate to replace any worn or damaged components to maintain proper functionality.

Conclusion

Understanding the **Mercury outboard shift linkage diagram** is vital for anyone who operates or maintains a Mercury outboard motor. Knowledge of the components, how they interact, and the common issues that may arise will empower users to troubleshoot problems effectively. Regular maintenance and inspections can prevent many common issues, ensuring that the outboard motor operates smoothly and reliably.

By taking the time to familiarize yourself with the shift linkage system and implementing a routine maintenance schedule, you can extend the life of your Mercury outboard motor and enhance your boating experience. Whether you are a seasoned boater or a newcomer, understanding this aspect of your outboard will serve you well on the water.

Frequently Asked Questions

What is the purpose of a shift linkage diagram for a Mercury outboard?

The shift linkage diagram provides a visual representation of the components that connect the gear shift lever to the outboard's transmission, helping users understand how to properly adjust or repair the shifting mechanism.

Where can I find the shift linkage diagram for my specific Mercury outboard model?

You can find the shift linkage diagram in the service manual for your specific Mercury outboard model, or you can download it from Mercury Marine's official website or authorized dealer sites.

What are common issues that can be diagnosed using the shift linkage diagram?

Common issues include misalignment of the linkage, difficulty shifting gears, or the gear not engaging properly, all of which can be diagnosed by referencing the shift linkage diagram.

How do I adjust the shift linkage on my Mercury outboard?

To adjust the shift linkage, refer to the shift linkage diagram, locate the adjustment points, and follow the manufacturer's instructions to ensure proper alignment and function.

Can I repair the shift linkage without a professional mechanic?

Yes, many homeowners can perform basic repairs on the shift linkage by following the shift linkage diagram and using common tools, but for complex issues, consulting a professional is recommended.

What tools are needed to work on the shift linkage of a Mercury outboard?

You typically need basic hand tools like wrenches, screwdrivers, and pliers, along with any specific tools mentioned in the shift linkage diagram or service manual.

Is the shift linkage design consistent across all Mercury outboard models?

No, the shift linkage design can vary between different models and years of Mercury outboards, so it is essential to refer to the specific diagram for your model.

What should I do if I can't find the shift linkage diagram for

my Mercury outboard?

If you can't find the diagram, consider contacting Mercury Marine customer support, visiting a local dealer, or checking online forums where other users may have shared diagrams.

Find other PDF article:
<https://soc.up.edu.ph/29-scan/files?ID=ITN49-9339&title=how-tall-is-mark-wahlberg.pdf>

Mercury Outboard Shift Linkage Diagram

mercury -
mercury ['mɜ:kjəri] n.; Mercury has a much greater density than water. 1mercury vapor 2mercury ...

Mercury -
Mercury1Mercury2Venus ...

Mercury -
Aug 12, 2024 · MercuryMercuryxyz ...

MERCURYUSB -
Mar 17, 2018 · Windows10 MERCURY MERCURY USB ...

mercari -
Jul 22, 2024 · Mercari https://www.mercari.com Mercari ...

Mercury -
Apr 2, 2025 · MercuryMercuryxyz ...

Mercury -
Mercury (Mercurius)JupiterMaia MaiestasTurmsHermes ...

300M -
2admin ...

wifiT:WPA PSMERCURY-265A...
wifiT:WPA PSMERCURY-265AWifiREWifi1RE
WifiROOT ...

Россельхознадзор / Федеральная государственная ...

Компонент eCert Компонент eCert предназначен для ветеринарной сертификации поднадзорных госветнадзору грузов, экспортируемых из Российской Федерации в ...

mercury -

mercury ['mɜːkjəri] n.; Mercury has a much greater density than water. 1 mercury vapor 2 mercury ...

-

1 Mercury 2 Venus ...

Mercury -

Aug 12, 2024 · Mercury Mercury xyz ...

MERCURY USB -

Mar 17, 2018 · Windows10 MERCURY USB ...

mercari -

Jul 22, 2024 · Mercari https://www.mercari.com Mercari ...

Mercury -

Apr 2, 2025 · Mercury xyz ...

Mercury -

Mercury (Mercurius) Jupiter Maia Maiestas Turms Hermes ...

300M -

2 admin ...

wifi T:WPA P S MERCURY-265A ...

wifi T:WPA P S MERCURY-265A Wifi RE Wifi 1 RE Wifi ROOT ...

Россельхознадзор / Федеральная государственная ...

Компонент eCert Компонент eCert предназначен для ветеринарной сертификации поднадзорных госветнадзору грузов, экспортируемых из Российской Федерации в ...

Explore our detailed mercury outboard shift linkage diagram to enhance your boating experience. Learn more about installation and troubleshooting today!

[Back to Home](#)