

Long 360 Tractor Parts Diagram

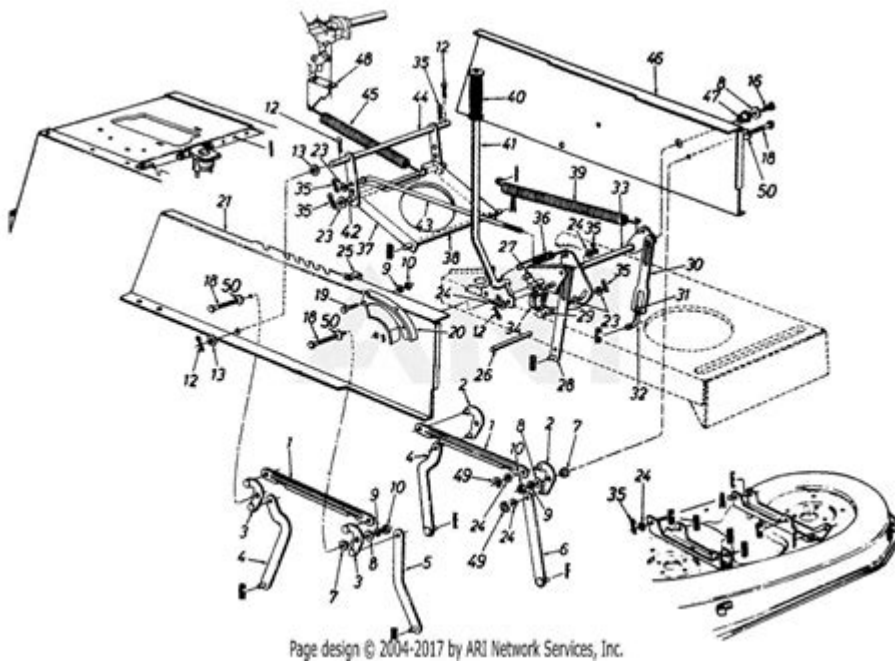

Long 360 tractor parts diagram is essential for understanding the various components of this powerful agricultural machine. Whether you're a farmer, a mechanic, or simply someone interested in tractors, having access to a detailed parts diagram can help you maintain, repair, or upgrade your Long 360 tractor. This article will explore the significance of the Long 360 tractor parts diagram, the main components of the tractor, and tips for using the diagram effectively for maintenance and repairs.

Understanding the Long 360 Tractor

The Long 360 tractor is a versatile piece of equipment known for its robust performance and reliability in the field. With a powerful engine and a range of attachments, this tractor is suitable for various agricultural tasks, including plowing, planting, and hauling. Understanding its parts is crucial for anyone looking to maximize its efficiency and lifespan.

Importance of a Parts Diagram

Having a Long 360 tractor parts diagram offers several advantages:

1. **Easy Identification:** A parts diagram allows you to easily identify and locate individual components within the tractor.
2. **Streamlined Repairs:** When you know the names and locations of parts, you can perform repairs more efficiently.

3. **Accurate Ordering:** If you need to replace a part, having a diagram helps you order the correct replacement part without confusion.
4. **Better Maintenance:** Regular maintenance becomes easier when you can see how different parts interact and function together.

Main Components of the Long 360 Tractor

To fully appreciate the Long 360 tractor parts diagram, it's important to familiarize yourself with its main components. Here are some of the key areas of the tractor:

1. Engine and Transmission

The engine and transmission are the heart of the Long 360 tractor. They work together to provide the power needed for various tasks.

- Engine: Typically a diesel engine, known for its durability and efficiency.
- Transmission: The transmission system converts the engine's power into usable speed and torque for the tractor.

2. Electrical System

The electrical system is crucial for starting the tractor and powering various components.

- Battery: Provides the necessary power to start the engine.
- Wiring Harness: Connects different electrical components throughout the tractor.
- Alternator: Charges the battery and powers electrical systems while the tractor is running.

3. Hydraulic System

The hydraulic system is essential for operating attachments and performing heavy lifting.

- Hydraulic Pump: Generates the hydraulic pressure necessary for operation.
- Hydraulic Cylinders: Actuators that move or lift attachments.
- Fluid Reservoir: Stores hydraulic fluid required for the system.

4. Chassis and Frame

The chassis and frame provide the structural support for the tractor.

- Frame: The backbone of the tractor, supporting all other components.
- Axles: Connect the wheels to the tractor and allow for movement.
- Suspension System: Provides stability and comfort while operating the tractor.

5. Wheels and Tires

Wheels and tires play a significant role in the tractor's mobility and performance.

- Front Tires: Typically smaller and used for steering.
- Rear Tires: Larger and designed to handle heavy loads and provide traction.

6. PTO (Power Take-Off) System

The PTO system is used to transfer power from the tractor to various attachments.

- PTO Shaft: Connects the tractor's power output to the implement.
- PTO Clutch: Engages or disengages the PTO system as needed.

How to Use a Long 360 Tractor Parts Diagram

Using a Long 360 tractor parts diagram can make maintenance and repairs much simpler. Here are some tips on how to utilize the diagram effectively:

1. Familiarize Yourself with the Diagram

Before diving into repairs, take some time to study the parts diagram. Understand how the various components are labeled and arranged. This will help you quickly locate parts when needed.

2. Identify Problem Areas

If you're experiencing issues with the tractor, refer to the parts diagram to identify the components related to the problem. For instance, if the hydraulic system is malfunctioning, look at the hydraulic pump and cylinders in the diagram.

3. Cross-Reference with Manuals

For detailed information on specific parts, cross-reference the parts diagram with the tractor's service manual. This can provide insights into maintenance schedules and troubleshooting tips.

4. Keep It Accessible

Print out a copy of the Long 360 tractor parts diagram and keep it in your workshop or maintenance area. Having it readily available will save you time when working on the tractor.

5. Use Online Resources

There are many online resources and forums dedicated to Long tractors. Joining these communities can provide additional insights and tips on using the parts diagram effectively.

Common Issues and Maintenance Tips

Like any machinery, the Long 360 tractor may face common issues that require attention. Here are a few tips for maintenance and troubleshooting:

1. Regular Oil Changes

Changing the engine oil regularly is crucial for maintaining engine health. Refer to the parts diagram for the oil filter's location and ensure you replace it during oil changes.

2. Check Hydraulic Fluid Levels

Regularly check the hydraulic fluid levels in the reservoir. Low fluid levels can lead to poor performance in hydraulic components.

3. Inspect Tires for Wear

Inspect the tires frequently for signs of wear and tear. Proper tire maintenance ensures optimal traction and stability.

4. Clean the Battery Terminals

Corroded battery terminals can lead to electrical issues. Use the parts diagram to locate the battery and ensure the terminals are clean and secure.

5. Monitor the Electrical System

Keep an eye on the wiring and electrical components. Look for frayed wires or loose connections that could cause problems.

Conclusion

In summary, having a **Long 360 tractor parts diagram** at your disposal is invaluable for anyone involved with this reliable agricultural machine. Understanding its components and how to use the diagram effectively can lead to better maintenance practices, quicker repairs, and ultimately, a more efficient tractor. Whether you're a seasoned mechanic or a novice farmer, investing time in learning about your Long 360 tractor will pay off in the long run. Happy farming!

Frequently Asked Questions

What is a long 360 tractor parts diagram?

A long 360 tractor parts diagram is a detailed illustration that shows the various components and parts of the Long 360 tractor, helping users identify and understand the tractor's structure and function.

Where can I find a long 360 tractor parts diagram?

You can find a long 360 tractor parts diagram in the owner's manual, from the manufacturer's website, or through various online forums and agricultural equipment websites.

Why is a parts diagram important for tractor maintenance?

A parts diagram is important for tractor maintenance as it helps owners and mechanics locate specific components, understand their functions, and facilitate repairs or replacements.

Are there different versions of the long 360 tractor parts diagram?

Yes, there may be different versions of the long 360 tractor parts diagram, depending on the model year and specific configurations of the tractor.

Can I download a long 360 tractor parts diagram for free?

Yes, some websites and forums may offer downloadable long 360 tractor parts diagrams for free, but it's essential to ensure they are accurate and up to date.

What key components are typically shown in a long 360

tractor parts diagram?

Key components typically shown include the engine, transmission, hydraulic system, steering assembly, and electrical system.

How can I use a long 360 tractor parts diagram for troubleshooting?

You can use a long 360 tractor parts diagram for troubleshooting by identifying the location of specific parts that may be malfunctioning and understanding how they connect to the overall system.

Is it necessary to have a long 360 tractor parts diagram for repairs?

While not strictly necessary, having a long 360 tractor parts diagram greatly aids in repairs by providing clarity on part locations and assembly instructions.

What common issues can be diagnosed with a long 360 tractor parts diagram?

Common issues that can be diagnosed include hydraulic leaks, electrical faults, and mechanical failures by pinpointing the exact parts involved.

How often should I refer to the long 360 tractor parts diagram?

It's advisable to refer to the long 360 tractor parts diagram whenever you perform maintenance, troubleshooting, or repairs to ensure accuracy and proper handling of components.

Find other PDF article:

<https://soc.up.edu.ph/43-block/files?ID=Nst50-1369&title=nm-driving-test-answers.pdf>

Long 360 Tractor Parts Diagram

long -

long long [lɒŋ] [lɑːŋ] adj. ...

as long as **so long as** -

Jul 13, 2015 · as long as [æz lɒŋ æz] [æz lɒŋ æz] so long as [səʊ lɒŋ æz] [sou lɒŋ æz] ...

AS LONG AS -

AS LONG AS... AS LONG AS [əz lɒŋ æz] As long as

needed as long again as As long as Hello As ...

□□□□-as long as you love me□□ - □□□□

Mar 24, 2006 · as long as you love me as long as u love me. although loneliness has always been a friend of mine. i'm leaving my life in ur hands. ...

as long as $\square\square\square\square\square - \square\square\square\square$

as long as [æz lɒŋ æz] [æz lɔ:ŋ æz] 1
As long as I

long□□□□□ - □□□□□

Aug 3, 2012 · long longer , longest 1 measuring or covering a great length or distance, or a greater length or distance than usual She had long dark hair. ...

□□□□□□□□□□□□□□□□/□□□□□□-□□□□

Mar 15, 2015 · [A4](#) “ ” “ ”
...

Taylor swift LONG LIVE - *album*

Taylor swift LONG LIVE Long Live · · · I said
remember this moment In ...

How long $\square\square\square\square - \square\square\square\square$

Feb 9, 2011 · How long how long “ for+ “since+ “since+ ...

long_____ - _____

long [lɒŋ] adj. long [lɔ:ŋ] adv. long [lɒŋ] v. n. long [lɒŋ]
long [lɒŋ] She was slender and ...

long□□□□□ - □□□□

long [lɒŋ] adj. 长的
long [lɒŋ] adv. 长的
n. ...

as long as □ so long as □ □ □ □ □ - □ □ □ □

Jul 13, 2015 · as long as [æz lɔŋ æz] so long as [səʊ lɔŋ æz] as long as [æz lɔŋ æz] so long as [səʊ lɔŋ æz]
as long as [æz lɔŋ æz] so long as [səʊ lɔŋ æz] He paused enough to consider the options but ...

AS LONG AS -

AS LONG AS... AS LONG AS [əz lɒŋ əz] As long as needed as long again as As long as Hello As Long As Useful As Long As Life 1 As long as your competitor is up for the challenge, you might as well go for it ...

□□□□-as long as you love me□□ - □□□□

Mar 24, 2006 · as long as you love me as long as u love me. although loneliness has always been a friend of mine. i'm leaving my life in ur hands. people say i'm crazy that i am blind. risking it all in a glance. how you got me blind is still a mystery. ...

as long as $\square\square\square\square\square - \square\square\square\square$

as long as as long as [æz lɒŋ æz] [æz lɔ:ŋ æz] 1
As long as I

long□□□□ - □□□□

Aug 3, 2012 · long longer , longest 1 measuring or covering a great length or distance, or a greater length or distance than usual She had long dark hair. He walked down the long corridor. It was the world's longest bridge. ...

□□□□□□□□□□□□□□□□/□□□□□□-□□□□

Mar 15, 2015 ·

Taylor swift LONG LIVE -

Taylor swift LONG LIVE Long Live · · · I said
remember this moment In the back of my

How long -

Feb 9, 2011 · How long how long " for+ " "since+ " "since+ how long "It's+ " "About+ " how long 1 ...

long□□□□□□ - □□□□

long [lɒŋ] adj. [lɔ:ŋ] adv. [lɒŋ] v. [lɒŋ] n. [lɒŋ]
 She was slender and had long dark hair. [lɒŋ] 1 ...

Explore our comprehensive long 360 tractor parts diagram to identify components easily. Learn more about maintenance and repairs to keep your tractor running smoothly!

[Back to Home](#)