

# Lutron 3 Way Dimmer Wiring Diagram

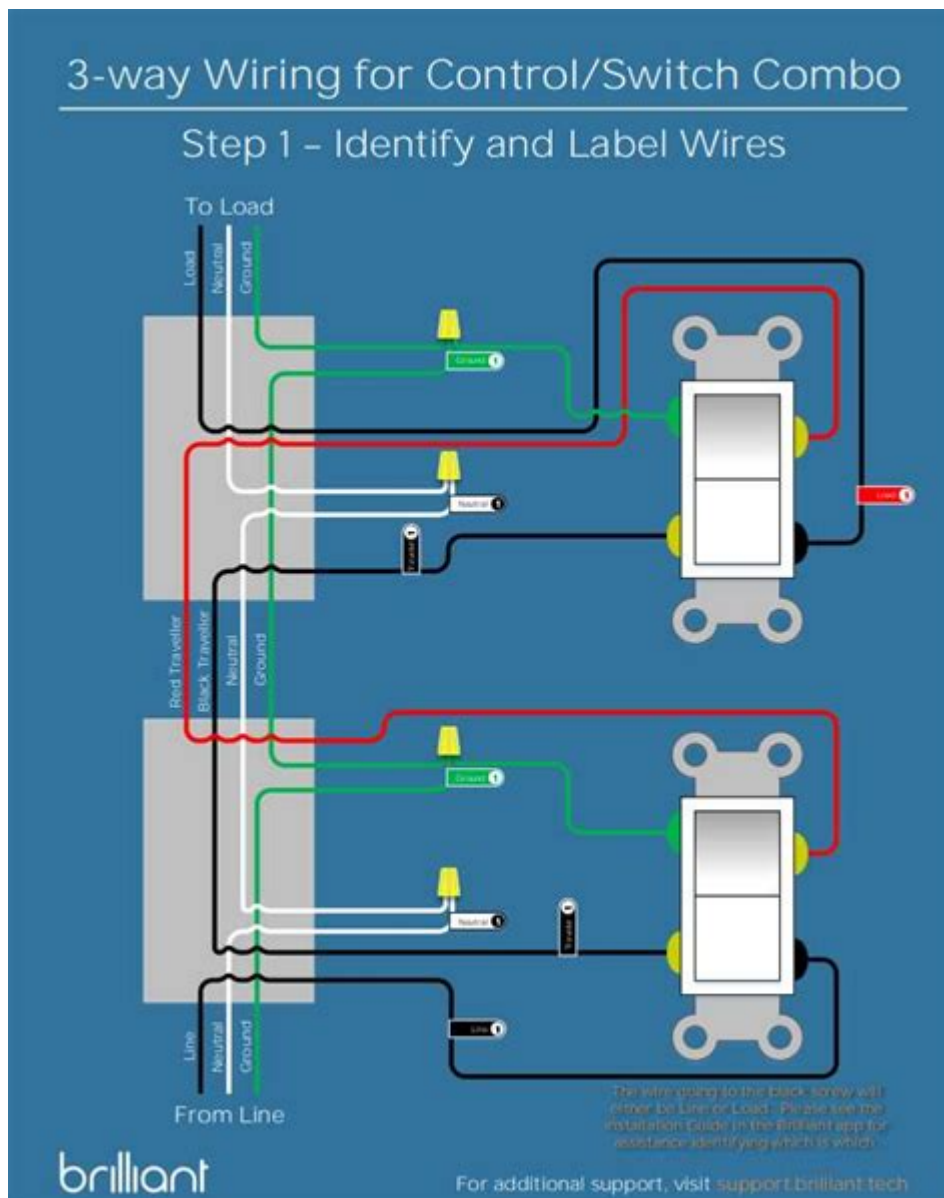

**Lutron 3 way dimmer wiring diagram** is an essential aspect for homeowners and electricians who want to enhance their lighting experience while ensuring safety and efficiency. Understanding how to wire a Lutron 3-way dimmer switch correctly can significantly improve the ambiance of any space, allowing you to adjust the brightness of your lights according to your preferences. In this article, we will delve into the details of the Lutron 3-way dimmer wiring diagram, including the necessary components, step-by-step installation instructions, troubleshooting tips, and safety considerations.

## Understanding Lutron 3-Way Dimmers

Lutron is a well-known brand in the lighting control industry, offering a range of products that include dimmers, switches, and smart lighting solutions. A 3-way dimmer allows you to control the same light fixture from two different locations. This is particularly useful in large rooms, hallways, or staircases where access to light control from multiple points is desired.

# Components of a Lutron 3-Way Dimmer

Before diving into the wiring process, it's crucial to understand the components involved. Here's what you will need:

- Lutron 3-way dimmer switch
- Standard 3-way switch
- Light fixture
- Electrical wires (typically 14/2 or 12/2 wire, depending on the circuit)
- Wire nuts
- Electrical tape
- Screwdriver
- Voltage tester

## Wiring Diagram Overview

A typical Lutron 3-way dimmer wiring diagram consists of the following key elements:

- Power Source: The line voltage that supplies power to the dimmer switch.
- Traveler Wires: These carry the current between the two switches.
- Load: The light fixture that will be controlled by the dimmer.

Understanding the layout of these elements is vital for a successful installation.

## Step-by-Step Installation Guide

Follow these steps to wire your Lutron 3-way dimmer switch properly:

1. **Turn Off Power:** Before starting any electrical work, turn off the power at the circuit breaker to ensure safety.
2. **Remove Existing Switch:** Use a screwdriver to remove the cover plate and unscrew the existing switch from the electrical box. Carefully pull it out to expose the wiring.

3. **Identify Wires:** Take note of how the existing switch is wired. Typically, you will find a common wire (often black), two traveler wires (usually red and black), and a ground wire (green or bare copper).
4. **Connect the Lutron Dimmer:**
  - Connect the common wire from the power source to the black wire of the Lutron dimmer.
  - Attach the two traveler wires to the corresponding terminals on the dimmer (usually marked as "Traveler").
  - Connect the ground wire to the green terminal on the dimmer.
5. **Wiring the 3-Way Switch:** At the second switch location, connect the traveler wires to the terminals on the standard 3-way switch. The common terminal on the 3-way switch will connect to the load (light fixture).
6. **Connect the Load:** Ensure that the light fixture is connected to the correct wires. The load wire should connect to the common terminal of the second switch, while the traveler wires should go to their respective terminals.
7. **Secure Connections:** Use wire nuts to secure all connections, and wrap them in electrical tape for added safety. Push the wires back into the electrical boxes carefully.
8. **Close the Switches:** Reattach the switches to the electrical boxes and put on the cover plates.
9. **Turn Power On:** Finally, restore power at the circuit breaker and test the dimmer and switch to ensure everything is functioning correctly.

## Troubleshooting Common Issues

If your Lutron 3-way dimmer is not functioning as expected, here are common issues and their solutions:

### Dimmer Not Working

- Check Power Supply: Ensure that the circuit breaker is turned on and there is power to the dimmer.

- **Verify Connections:** Double-check all wire connections for tightness and proper placement.
- **Inspect Wires:** Look for any frayed or damaged wires that may need replacement.

## **Flickering Lights**

- **Incompatible Bulbs:** Ensure you are using compatible LED or CFL bulbs with your dimmer.
- **Overloaded Circuit:** Make sure that the total wattage of the connected lights does not exceed the dimmer's rating.

## **Dimmer Not Dimming**

- **Check Load Requirements:** Confirm that the load is within the acceptable range for the dimmer.
- **Faulty Dimmer:** If all else fails, consider replacing the dimmer switch as it may be defective.

## **Safety Considerations**

When working with electrical wiring, safety should always be your top priority. Here are some key considerations:

- Always turn off the power before starting any electrical work.
- Use insulated tools to prevent electrical shock.
- Follow local electrical codes and regulations to ensure compliance.
- If unsure, consult a licensed electrician for assistance.

## **Conclusion**

Installing a Lutron 3-way dimmer switch can greatly enhance the lighting control in your home, providing both convenience and ambiance. By following the wiring diagram and step-by-step instructions outlined in this article, you can successfully install your dimmer switch. Remember to prioritize safety and troubleshoot any issues that may arise. With the right approach, you can enjoy a well-lit space tailored to your preferences.

## **Frequently Asked Questions**

### **What is a Lutron 3-way dimmer switch?**

A Lutron 3-way dimmer switch is a device that allows you to control the brightness of lights from two different locations, providing flexibility and convenience in lighting control.

## **How do I wire a Lutron 3-way dimmer switch?**

To wire a Lutron 3-way dimmer, you typically connect the common terminal of the dimmer to the load (light fixture), the traveler terminals to the existing traveler wires, and the ground wire to the ground terminal.

## **What is the difference between a single pole and a 3-way dimmer switch?**

A single pole dimmer controls a light from one location, while a 3-way dimmer allows control from two different locations, making it ideal for larger spaces like hallways or staircases.

## **Can I use a Lutron 3-way dimmer with LED lights?**

Yes, many Lutron 3-way dimmers are compatible with LED lights, but it's important to check the specifications for compatibility to avoid flickering or dimming issues.

## **What tools do I need to install a Lutron 3-way dimmer?**

You'll need a screwdriver, wire strippers, a voltage tester, and possibly pliers to secure connections when installing a Lutron 3-way dimmer.

## **Is it necessary to turn off the power before wiring a Lutron 3-way dimmer?**

Yes, it is crucial to turn off the power at the circuit breaker to ensure safety while wiring the dimmer switch.

## **What color wires are typically used in a 3-way dimmer wiring diagram?**

In a typical 3-way dimmer wiring diagram, you will usually find black (hot), red and white (traveler wires), and green or bare (ground) wires.

## **Can I replace an existing 3-way switch with a Lutron 3-way dimmer?**

Yes, you can replace an existing 3-way switch with a Lutron 3-way dimmer, but ensure that the wiring configuration is compatible and follow the manufacturer's instructions.

## **What are the common issues when wiring a Lutron 3-way dimmer?**

Common issues include incorrect wiring, using incompatible bulbs, or not properly securing wire connections, which can lead to flickering lights or the dimmer not working.

Find other PDF article:

<https://soc.up.edu.ph/33-gist/files?trackid=OUUp18-2966&title=introduction-to-contemporary-special-education.pdf>

# [Lutron 3 Way Dimmer Wiring Diagram](#)

## **Lutron Support Community**

Aug 26, 2024 · Connect and collaborate with other Lutron customers in the Lutron Support Community to discover solutions and share tips on Lutron products and systems.

## **Activity Stream - Lutron Support Community**

Aug 13, 2024 · Connect and collaborate with other Lutron customers in the Lutron Support Community to discover solutions and share tips on Lutron products and systems.

## [Welcome to the Lutron Support Community](#)

Welcome to the Lutron Support Community Residential Systems HomeWorks QSX RadioRA 3 RadioRA 2 Caseta Wireless Shading Solutions Shading Solutions - Shades LED Solutions ...

## **Forum: Troubleshooting - RA3 - forums.lutron.com**

Aug 12, 2024 · Sticky: How to OOB or Change a Picos Frequency Started by Austin P., 06-14-2022 04:47 PM Replies: 3 Views: 13,048 miked212 08-17-2022, 09:51 PM

## *Search Results - Lutron Support Community*

Aug 13, 2024 · Connect and collaborate with other Lutron customers in the Lutron Support Community to discover solutions and share tips on Lutron products and systems.

## [Forum: Troubleshooting - RA2 - forums.lutron.com](#)

Oct 13, 2024 · Sticky: How to OOB or Change a Picos Frequency Started by Austin P., 06-14-2022 04:47 PM Replies: 0 Views: 11,132 Austin P. 06-14-2022, 04:47 PM

## [Forum: Troubleshooting - RA2 - forums.lutron.com](#)

Oct 13, 2024 · Sticky: Main repeater LED blink codes Started by Ty W., 07-03-2013 11:42 AM 2 Pages • 1 2 Replies: 19 Views: 271,930 Kilowatt 10-21-2019, 05:44 PM

## **Programming - Vive - forums.lutron.com**

Feb 2, 2024 · Quick Navigation Programming - Vive Top HomeWorks QSX RadioRA 3 RadioRA 2 Caseta Wireless Shading Solutions - Shades LED Solutions Quantum Vive Standalone Energi ...

## [RadioRA 3 - forums.lutron.com](#)

Oct 14, 2024 · Discuss RadioRA 3, the wireless total home control system that gives you the ability to control lighting and shades throughout your home.

## **HomeWorks QSX - forums.lutron.com**

Sep 20, 2024 · Discuss HomeWorks QSX, capable of RF as well as wired system communication for new construction and retrofit applications.

## [Lutron Support Community](#)

Aug 26, 2024 · Connect and collaborate with other Lutron customers in the Lutron Support Community to discover solutions and share tips on Lutron products and systems.

## **Activity Stream - Lutron Support Community**

Aug 13, 2024 · Connect and collaborate with other Lutron customers in the Lutron Support Community to discover solutions and share tips on Lutron products and systems.

## Welcome to the Lutron Support Community

Welcome to the Lutron Support Community Residential Systems HomeWorks QSX RadioRA 3  
RadioRA 2 Caseta Wireless Shading Solutions Shading Solutions - Shades LED Solutions ...

### Forum: Troubleshooting - RA3 - [forums.lutron.com](https://forums.lutron.com)

Aug 12, 2024 · Sticky: How to OOB or Change a Picos Frequency Started by Austin P., 06-14-2022  
04:47 PM Replies: 3 Views: 13,048 miked212 08-17-2022, 09:51 PM

### Search Results - Lutron Support Community

Aug 13, 2024 · Connect and collaborate with other Lutron customers in the Lutron Support  
Community to discover solutions and share tips on Lutron products and systems.

### *Forum: Troubleshooting - RA2 - [forums.lutron.com](https://forums.lutron.com)*

Oct 13, 2024 · Sticky: How to OOB or Change a Picos Frequency Started by Austin P., 06-14-2022  
04:47 PM Replies: 0 Views: 11,132 Austin P. 06-14-2022, 04:47 PM

### *Forum: Troubleshooting - RA2 - [forums.lutron.com](https://forums.lutron.com)*

Oct 13, 2024 · Sticky: Main repeater LED blink codes Started by Ty W., 07-03-2013 11:42 AM 2  
Pages • 1 2 Replies: 19 Views: 271,930 Kilowatt 10-21-2019, 05:44 PM

### Programming - Vive - [forums.lutron.com](https://forums.lutron.com)

Feb 2, 2024 · Quick Navigation Programming - Vive Top HomeWorks QSX RadioRA 3 RadioRA 2  
Caseta Wireless Shading Solutions - Shades LED Solutions Quantum Vive Standalone Energi ...

### *RadioRA 3 - [forums.lutron.com](https://forums.lutron.com)*

Oct 14, 2024 · Discuss RadioRA 3, the wireless total home control system that gives you the ability to  
control lighting and shades throughout your home.

### **HomeWorks QSX - [forums.lutron.com](https://forums.lutron.com)**

Sep 20, 2024 · Discuss HomeWorks QSX, capable of RF as well as wired system communication for  
new construction and retrofit applications.

"Discover how to easily install your Lutron 3 way dimmer with our comprehensive wiring diagram.  
Get step-by-step instructions and tips—learn more today!"

[Back to Home](#)