

# Lennox Rooftop Unit Manual

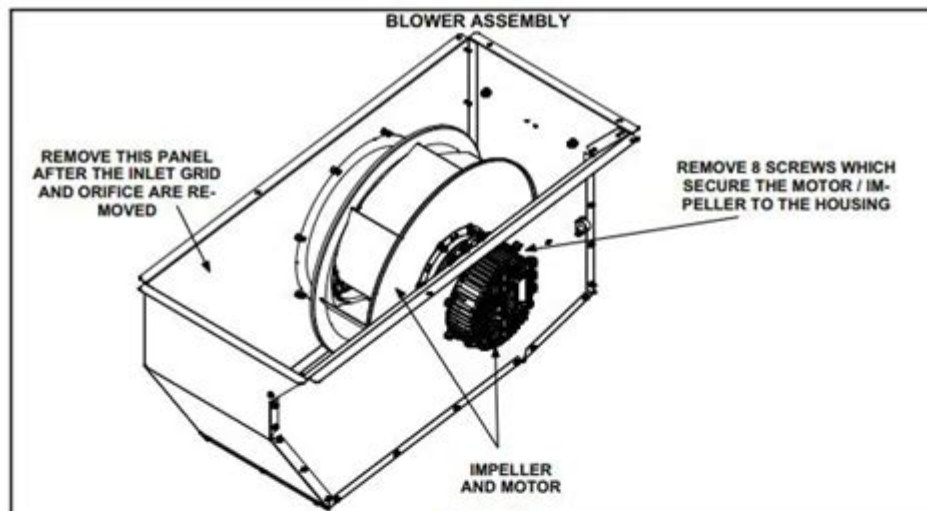

FIGURE 6

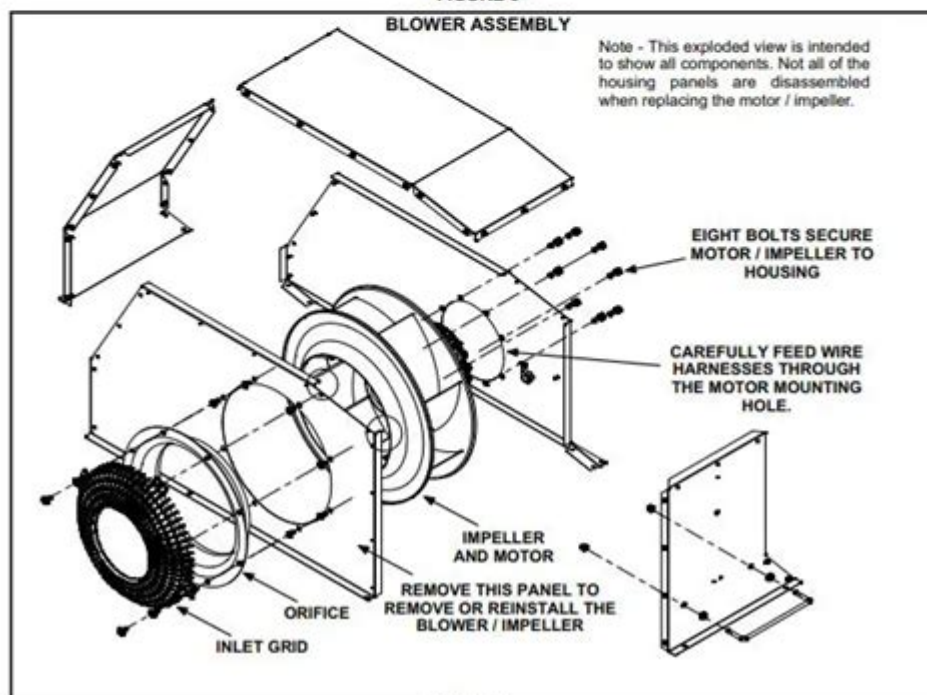

FIGURE 7

**Lennox rooftop unit manual** provides essential information for the installation, operation, and maintenance of Lennox rooftop air conditioning and heating systems. These units are designed for commercial buildings and provide efficient climate control while maximizing space. Understanding the manual can help facility managers and technicians ensure optimal performance and longevity of these HVAC systems. In this article, we will delve into the key components of the Lennox rooftop unit manual, how to navigate it, and the importance of adhering to its guidelines.

# Understanding the Lennox Rooftop Unit

Lennox rooftop units are versatile HVAC systems that offer both heating and cooling capabilities. They are particularly popular in commercial settings due to their ability to maintain comfortable indoor climates while being energy efficient. Here are some essential features of Lennox rooftop units:

- **Design:** Compact and designed for roof installation, freeing up ground space.
- **Energy Efficiency:** Many models are equipped with advanced technology that enhances energy efficiency, which can help reduce utility costs.
- **Multi-Functionality:** Capable of providing both heating and cooling through a single unit.
- **Ease of Maintenance:** Designed for easy access to internal components for regular service and upkeep.

## Navigating the Lennox Rooftop Unit Manual

The Lennox rooftop unit manual is a vital resource for anyone working with these systems. It contains detailed information that can help technicians troubleshoot issues, perform regular maintenance, and understand the unit's specifications. Here's how to navigate the manual effectively:

### 1. Table of Contents

The manual typically begins with a table of contents that outlines the structure and sections included. This section allows the reader to quickly find specific topics of interest, such as installation instructions, troubleshooting tips, or maintenance schedules.

### 2. Safety Information

Before diving into operational details, the manual will often include important safety information. This section may cover:

- Electrical safety precautions

- Proper use of personal protective equipment (PPE)
- Guidelines for handling refrigerants

Understanding safety protocols is crucial for preventing accidents and ensuring a safe working environment.

### **3. Installation Instructions**

Installation is one of the most critical components covered in the Lennox rooftop unit manual. This section provides step-by-step instructions, including:

1. Site preparation: Ensuring the roof can support the unit's weight and that there's proper drainage.
2. Electrical connections: Guidelines for safe and effective wiring.
3. Ventilation requirements: Ensuring adequate airflow for optimal unit performance.
4. Testing protocols: Steps to ensure the unit operates correctly after installation.

Following these installation instructions closely is vital to avoid operational issues and ensure the warranty remains valid.

## **Operating the Lennox Rooftop Unit**

Once the unit is installed, understanding its operation is key to maximizing its efficiency. The manual provides detailed information about:

### **1. Control Systems**

Lennox rooftop units often come equipped with advanced control systems. This section will outline:

- Thermostat settings: How to adjust temperature settings for optimal comfort.

- **Programming features:** Information on scheduling and programming for energy savings.
- **Remote monitoring options:** Details on connecting the unit to building management systems.

## **2. Seasonal Operation**

The manual will also include guidelines for seasonal operation, such as:

1. **Winter setups:** Adjustments needed for heating modes.
2. **Summer operations:** Tips for maximizing cooling efficiency.
3. **Transition periods:** Guidance for switching between heating and cooling modes.

By understanding seasonal operation, users can enhance the unit's performance and energy efficiency.

## **Maintenance Guidelines**

Regular maintenance is essential for ensuring the longevity and efficiency of Lennox rooftop units. The manual will provide a comprehensive maintenance schedule, which typically includes:

### **1. Routine Inspections**

Regular inspections are crucial for identifying potential issues before they become major problems. The manual may suggest:

- Checking for unusual noises or vibrations.
- Inspecting electrical connections for wear and tear.
- Monitoring refrigerant levels.

## **2. Cleaning Procedures**

Maintaining cleanliness is vital for optimal performance. The manual will likely include:

1. Cleaning or replacing air filters regularly.
2. Removing debris from the unit's exterior and surrounding area.
3. Inspecting and cleaning the condensate drain line to prevent clogs.

## **3. Professional Servicing**

While some maintenance tasks can be performed by facility staff, others may require professional servicing. The manual may recommend scheduling regular professional inspections, typically on an annual basis, to ensure the unit operates efficiently and safely.

## **Troubleshooting Common Issues**

Even with regular maintenance, issues can arise. The Lennox rooftop unit manual provides a troubleshooting section that can help users diagnose and resolve common problems. Typical issues and their potential solutions might include:

### **1. Unit Not Cooling/Heating**

- Check the thermostat settings.
- Inspect the air filters for clogs.
- Ensure that the power supply is connected.

### **2. Unusual Noises**

- Inspect for loose components or debris within the unit.
- Check the fan motor for wear.

### **3. Water Leaks**

- Inspect the condensate drain for clogs.
- Check refrigerant levels and connections.

Having this troubleshooting information readily available can save time and money by quickly resolving issues without requiring extensive service calls.

## **Conclusion**

A comprehensive understanding of the **Lennox rooftop unit manual** is essential for anyone involved in the installation, operation, and maintenance of these HVAC systems. By familiarizing yourself with the manual's structure and the information it contains, you can ensure that your Lennox rooftop unit operates efficiently, safely, and effectively for years to come. Regular maintenance, adherence to safety protocols, and prompt troubleshooting can significantly enhance the performance and lifespan of your rooftop unit, ultimately contributing to a comfortable and productive indoor environment.

## **Frequently Asked Questions**

### **Where can I find the Lennox rooftop unit manual for my specific model?**

You can find the Lennox rooftop unit manual for your specific model on the official Lennox website under the 'Product Manuals' section, or by contacting your local Lennox dealer.

### **What are the key maintenance tips outlined in the Lennox rooftop unit manual?**

Key maintenance tips include regularly cleaning or replacing air filters, checking and cleaning the condensate drain, inspecting the ductwork for leaks, and scheduling professional maintenance at least once a year.

### **How can I troubleshoot common issues using the Lennox rooftop unit manual?**

The manual provides troubleshooting steps for common issues such as insufficient cooling or heating, unusual noises, and system lockouts, including checking power supply, thermostat settings, and inspecting for any visible blockages.

# Does the Lennox rooftop unit manual include installation instructions?

Yes, the Lennox rooftop unit manual typically includes detailed installation instructions, including electrical connections, ductwork setup, and environmental requirements for optimal performance.

# What safety precautions are mentioned in the Lennox rooftop unit manual?

The manual emphasizes safety precautions such as turning off power before servicing, using personal protective equipment, ensuring proper ventilation during maintenance, and following local codes and regulations.

Find other PDF article:  
<https://soc.up.edu.ph/40-trend/Book?trackid=PpT05-3076&title=mathematical-notation-a-guide-for-engineers-and-scientists.pdf>

## Lennox Rooftop Unit Manual

**Goodman lennox** -   
Goodman lennox Energy.gov 67  
...

**LB** -   
Mar 15, 2016 · LB  
out Posted on ...

...  
NaCl LB - Miller LB - Lennox LB - LB  
DNA DNA ...

**Adam (Adaptive Moment Estimation)** -   
Adam  
...

**lb** -   
lb Lennox broth without salt (LB-NS)  
2

**BBC** -   
Mr. Henry Lennox stood leaning against the chimney-piece, amused with the family scene. He was close by his handsome brother; he was the plain one in a singularly good-looking family; ...

-

Lennox, Ian Lennox McHarg (1920--2001) 1969, ...

Lennox? -

Oct 22, 2022 · 1 Lennox 2 Carrier 3 AirStow 4 Whirlpool 5 Rheem

3 Into the West -

Into the West Song by Annie Lennox Lay down Your sweet and weary head Night is falling ...

Goodwood Festival of Speed ...

Charles Gordon-Lennox, the Earl of March and Kinrara 2.2/ 1993 Charles, the Earl of March and Kinrara ...

Goodman lennox -

Goodman lennox ...

LB -

Mar 15, 2016 · ...

SS LB ...

NaCl LB - Miller LB - Lennox LB - LB ...

Adam (Adaptive Moment Estimation) -

Adam ...

lb -

lb Lennox broth without salt (LB-NS) ...

Find the complete Lennox rooftop unit manual here! Access installation

[Back to Home](#)