

Lg Dishwasher Troubleshooting Manual

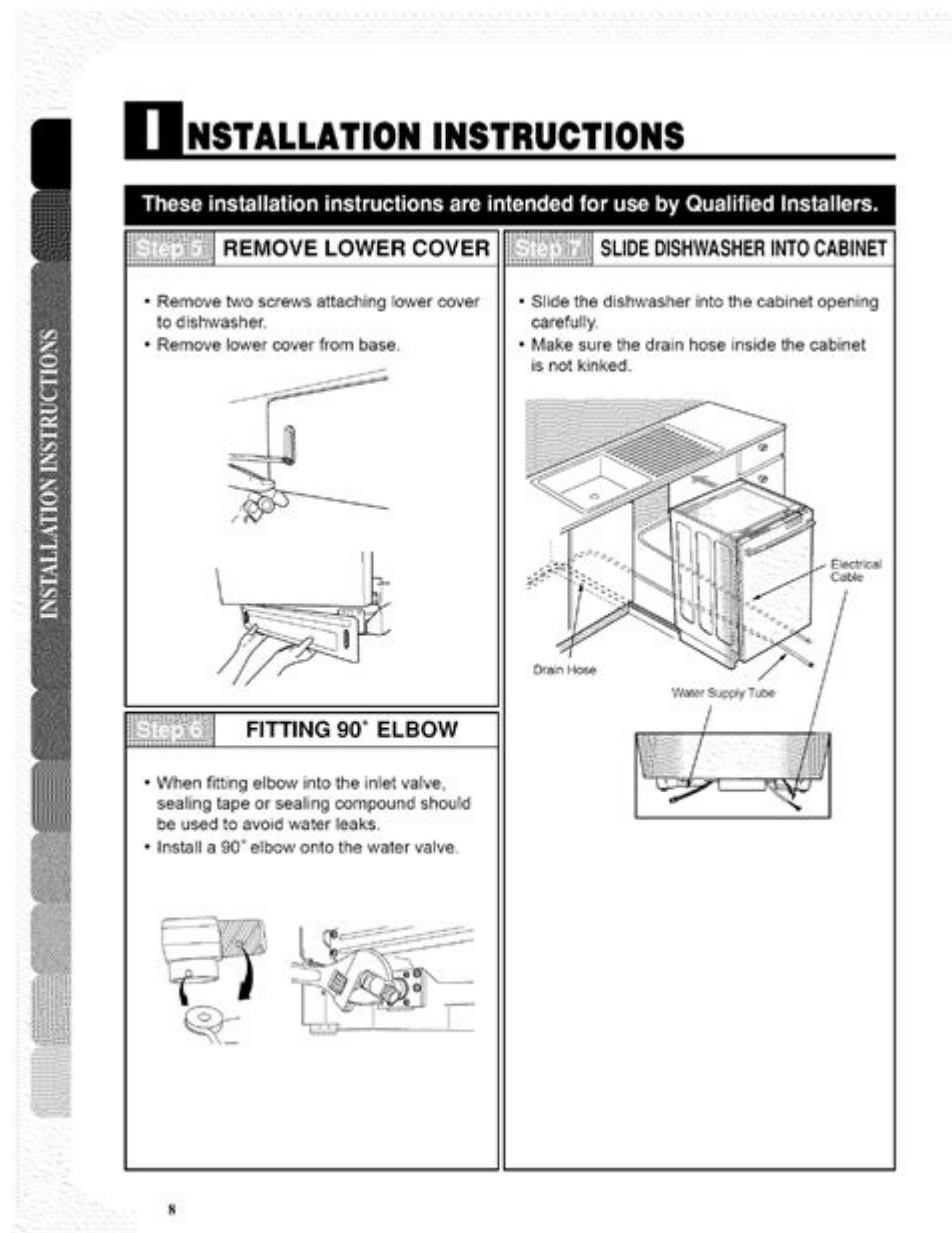

LG Dishwasher Troubleshooting Manual

When your LG dishwasher encounters issues, it can be frustrating and inconvenient. However, understanding common problems and their solutions can help you restore functionality and ensure your dishes come out sparkling clean. This comprehensive troubleshooting manual is designed to guide you through various issues, providing step-by-step solutions and insights into maintaining your appliance effectively.

Common LG Dishwasher Problems

While LG dishwashers are known for their efficiency and reliability, they can still experience occasional problems. Here are some of the most common issues you might encounter:

1. Dishwasher Won't Start

If your LG dishwasher refuses to start, it can be due to several reasons:

- Door Latch Issue: Ensure that the door is fully closed and the latch is functioning correctly.
- Power Supply: Check if the dishwasher is plugged in and that the circuit breaker has not tripped.
- Control Settings: Make sure the correct cycle has been selected and that any delay start features are not activated.

2. Water Not Filling

If your dishwasher is not filling with water, consider the following:

- Water Supply: Ensure the water supply valve is open.
- Hose Kinks: Check the inlet hose for any kinks or blockages.
- Float Assembly: Inspect the float assembly for debris that may be preventing it from moving freely.

3. Dishes Not Cleaning Properly

When dishes come out dirty, it can be frustrating. Here are some potential causes:

- Blocked Spray Arms: Ensure that the spray arms can rotate freely and are not blocked by large items or debris.
- Improper Loading: Make sure dishes are loaded correctly, allowing water to reach all surfaces.
- Detergent Issues: Verify that you are using the right type of detergent and that it is stored properly.

4. Dishwasher Leaks

Leakage can lead to water damage and should be addressed immediately:

- Door Seals: Inspect the door seals for cracks or wear that may cause leaks.
- Hoses and Connections: Check the hoses for any signs of damage or loose connections.

- **Float Switch:** A malfunctioning float switch can cause overfilling, leading to leaks.

5. Unpleasant Odors

If your dishwasher emits unpleasant odors, consider these solutions:

- **Food Debris:** Clean out any food debris from the filter and drain area.
- **Cleaning Cycle:** Run a cleaning cycle using a dishwasher cleaner to eliminate built-up residue.
- **Check for Mold:** Inspect rubber gaskets and hidden areas for mold and clean them thoroughly.

Step-by-Step Troubleshooting Guide

Here's a detailed troubleshooting guide to help you diagnose and fix common issues with your LG dishwasher.

1. Diagnostic Mode

Many LG dishwashers have a diagnostic mode that can help identify issues. To enter diagnostic mode:

1. Turn off the dishwasher.
2. Press and hold the "Start" button, then turn the dishwasher on.
3. Release the "Start" button, and the display should indicate diagnostic mode.

Refer to your specific model's manual for additional instructions on interpreting diagnostic codes.

2. Cleaning the Filter

A dirty filter can cause various issues, including poor cleaning performance and unpleasant odors. Here's how to clean it:

1. Open the dishwasher and remove the bottom rack.
2. Locate the filter, usually at the bottom of the tub.
3. Twist and pull to remove the filter.
4. Rinse the filter under warm water, scrubbing gently with a soft brush if necessary.
5. Reinsert the filter and the bottom rack.

3. Checking the Spray Arms

To ensure proper cleaning, check the spray arms:

1. Remove the bottom rack to access the spray arms.
2. Inspect the spray arms for clogs or debris.
3. If blocked, remove the spray arms by unscrewing them and rinse them under water.
4. Reattach the spray arms securely.

4. Inspecting the Door Seal

A proper door seal is crucial for preventing leaks. To inspect it:

1. Open the dishwasher door and check the rubber gasket around the perimeter.
2. Look for cracks, tears, or signs of wear.
3. If damaged, consider replacing the door seal.

5. Resetting the Dishwasher

Sometimes simply resetting the dishwasher can resolve errors. To reset:

1. Turn off the dishwasher and unplug it from the electrical outlet.
2. Wait for about 5 minutes.
3. Plug the dishwasher back in and turn it on.

Maintenance Tips for Your LG Dishwasher

Regular maintenance can help prevent common problems and extend the life of your dishwasher.

1. Regular Cleaning

Perform regular cleanings by:

- Wiping down the exterior and control panel.
- Running an empty cycle with a dishwasher cleaner every month.
- Cleaning the filter and spray arms as needed.

2. Proper Loading Techniques

Load your dishwasher correctly to enhance cleaning efficiency:

- Place larger items on the bottom rack and smaller items on the top rack.
- Avoid overcrowding to ensure water circulation.
- Tilt items at an angle to allow water to drain.

3. Use the Right Detergent

Always use high-quality dishwasher detergent designed for automatic dishwashers. Follow the manufacturer's recommendations for the right amount to use.

4. Inspect Hoses and Connections

Periodically check hoses for signs of wear, leaks, or kinks. Ensure all connections are tight to prevent water leaks.

When to Call a Professional

If you've tried troubleshooting your LG dishwasher and are still experiencing issues, it may be time to call a professional technician. Some problems can require specialized tools or knowledge, such as:

- Electrical issues that may pose a safety risk.
- Internal component failures, such as the motor or pump.
- Persistent leaks that could indicate a more severe problem.

Conclusion

Troubleshooting your LG dishwasher doesn't have to be a daunting task. By understanding common problems and how to address them, you can save both time and money. Regular maintenance, proper usage, and prompt attention to issues will keep your dishwasher running smoothly for years to come. Remember, when in doubt, consult your user manual or reach out to a professional for assistance.

Frequently Asked Questions

How can I reset my LG dishwasher?

To reset your LG dishwasher, press and hold the 'Start/Stop' button for about 3 seconds. This will reset the settings and clear any error codes.

What should I do if my LG dishwasher is not draining?

First, check the filter and drain hose for clogs. Remove any debris and ensure the drain hose is properly installed. If the issue persists, consult the troubleshooting section of your manual for further steps.

Why does my LG dishwasher display an error code?

Error codes indicate specific issues with the dishwasher. Refer to the troubleshooting manual to identify the meaning of the error code displayed and follow the recommended solutions.

How can I fix a leaking LG dishwasher?

Inspect the door seal for damage, ensure the door is closing properly, and check for any loose connections in the water supply line. If the problem continues, consult the manual for detailed troubleshooting steps.

What should I do if my LG dishwasher is making unusual noises?

Unusual noises may indicate a foreign object in the spray arm or a malfunctioning part. Check for obstructions and refer to the troubleshooting manual to identify and resolve the noise issue.

How often should I clean my LG dishwasher filter?

It's recommended to clean your LG dishwasher filter every month to ensure optimal performance and prevent clogs. Refer to the manual for specific cleaning instructions.

Find other PDF article:

<https://soc.up.edu.ph/32-blog/Book?dataid=UjS30-5206&title=ian-clayton-son-of-thunder.pdf>

[Lg Dishwasher Troubleshooting Manual](#)

Test telewizora LG OLED C4. Produkt idealny w dobrej cenie?

Sep 24, 2024 · Nie ma chyba osoby, która choć raz nie usłyszała o LG i ich telewizorach OLED. Nie tak dawno producent świętował swój okrągły jubileusz wypuszczenia na rynek ...

lg20255lg

Dec 28, 2024 · lg 27 2K 4K 144Hz 1ms ...

LG gram Pro 2025 -

LG gram Pro 2025 LG gram Pro 2025 LG

hdmi2.1dp1.4dp -

hdmi2.1dp1.4dp LG 4K 144hz 27gp95u lgjd dp [] [] ...

Fragen zum neuen LG C4 (Bildeinstellungen,Bildqualität)

Nov 24, 2024 · Bin vor einer Woche von einem Samsung UE50J6289SUXZG auf einen LG C4 55" umgestiegen. Hab aber immer noch Probleme mit den richtigen Bildeinstellungen bzw. der ...

HDMI ...

" " -- " -HDMI ...

WOLEDQD-OLED

May 29, 2024 · LG 34GS95QE 1500R PC LG 34GS95QE 800R ...

-

HDMI

GHUB -

G HUB RGB (logitechg.com.cn)

LG UltraFine 4K / 5K

LG UltraFine 4K 5K LG UltraFine 4K LG UltraFine 5K U2720iMac 3800 ...

Test telewizora LG OLED C4. Produkt idealny w dobrej cenie?

Sep 24, 2024 · Nie ma chyba osoby, która choć raz nie usłyszała o LG i ich telewizorach OLED. Nie tak dawno producent świętował swój okrągły jubileusz wypuszczenia na rynek konsumencki pierwszego telewizora z matrycą organiczną. Modelem C4 producent chce kontynuować tradycję dostarczania najwyższej jakości obrazu dla jak największej liczby odbiorców w jak najlepszej ...

lg20255lg

Dec 28, 2024 · lg 27 2K 4K 144Hz 1ms IPS VA

LG gram Pro 2025 -

LG gram Pro 2025 LG gram Pro 2025

LG gram Pro 2025

hdmi2.1dp1.4dp -

hdmi2.1dp1.4dp LG 4K 144hz27gp95u lgjd dp
 [] [] ... 99

Fragen zum neuen LG C4 (Bildeinstellungen,Bildqualität)

Nov 24, 2024 · Bin vor einer Woche von einem Samsung UE50J6289SUXZG auf einen LG C4 55" umgestiegen. Hab aber immer noch Probleme mit den richtigen Bildeinstellungen bzw. der Bildqualität mancher Sender. Hab zu Anfang erstmal bei YouTube ein paar Bildeinstellungen von TechTec übernommen und damit etwas herumgespielt.

HDMI ...

“”-- -- “ ”-HDMI
HDMI

WOLEDQD-OLED

May 29, 2024 · LG 34GS95QE 1500RPC LG 34GS95QE800R0.8

-

HDMI

GHUB -

G HUB RGB
(logitechg.com.cn)

LG UltraFine 4K / 5K

LG UltraFine 4K LG UltraFine 5K

U2720iMac 3800 1. LG UltraFine 4K ...

Struggling with your LG dishwasher? Our comprehensive LG dishwasher troubleshooting manual offers step-by-step solutions to common issues. Learn more now!

[Back to Home](#)