

Jeep Jk Evap System Diagram

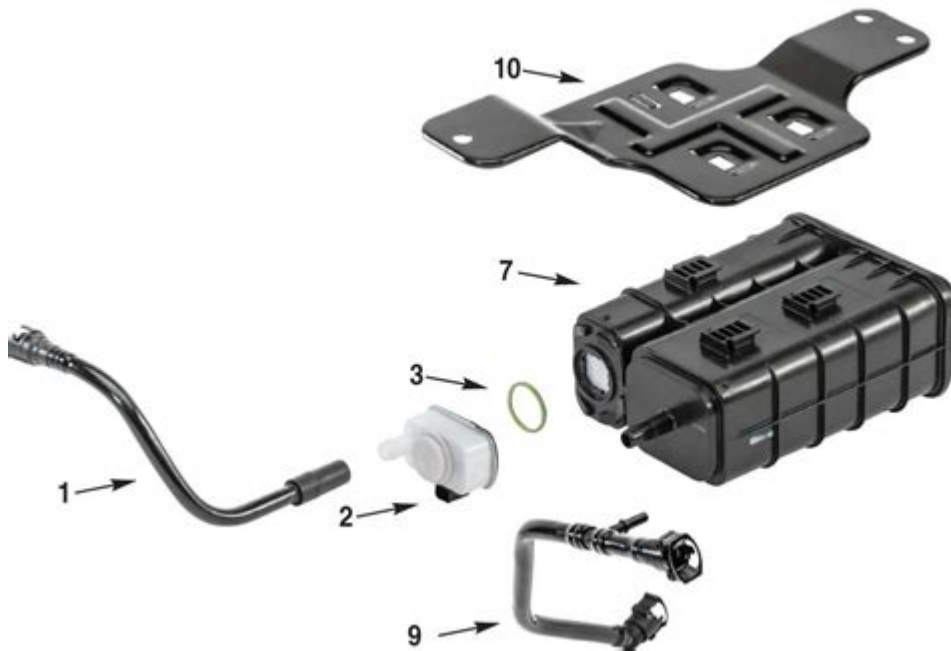

Jeep JK EVAP SYSTEM DIAGRAM IS A CRUCIAL ASPECT OF UNDERSTANDING THE EMISSION CONTROL SYSTEM IN THE JEEP WRANGLER JK MODELS PRODUCED BETWEEN 2007 AND 2018. THIS SYSTEM IS DESIGNED TO PREVENT HARMFUL FUEL VAPORS FROM ESCAPING INTO THE ATMOSPHERE, THEREBY HELPING TO MEET ENVIRONMENTAL REGULATIONS. IN THIS ARTICLE, WE WILL DELVE INTO THE COMPONENTS OF THE EVAPORATIVE (EVAP) SYSTEM, ITS SIGNIFICANCE, POTENTIAL ISSUES, AND HOW TO INTERPRET THE EVAP SYSTEM DIAGRAM.

UNDERSTANDING THE EVAP SYSTEM

THE EVAP SYSTEM IS AN INTEGRAL PART OF A VEHICLE'S EMISSIONS CONTROL SYSTEM. IT CAPTURES FUEL VAPORS FROM THE FUEL TANK AND PREVENTS THEM FROM BEING RELEASED INTO THE ATMOSPHERE. THE JEEP JK, LIKE MANY MODERN VEHICLES, IS EQUIPPED WITH AN EVAP SYSTEM TO ENHANCE ITS ENVIRONMENTAL PERFORMANCE AND COMPLY WITH EMISSION STANDARDS.

COMPONENTS OF THE JEEP JK EVAP SYSTEM

THE JEEP JK EVAP SYSTEM CONSISTS OF SEVERAL KEY COMPONENTS:

1. **FUEL TANK:** THIS IS WHERE THE GASOLINE IS STORED. THE FUEL TANK IS DESIGNED TO MINIMIZE VAPOR EMISSIONS.
2. **FUEL PUMP:** LOCATED INSIDE THE FUEL TANK, THE PUMP DELIVERS FUEL TO THE ENGINE WHILE ALSO CREATING A VACUUM THAT HELPS DRAW VAPORS INTO THE SYSTEM.
3. **CHARCOAL CANISTER:** THIS COMPONENT ABSORBS FUEL VAPORS FROM THE FUEL TANK. THE CHARCOAL INSIDE THE CANISTER STORES THE VAPORS UNTIL THEY CAN BE PURGED INTO THE ENGINE FOR COMBUSTION.
4. **VAPOR LINES:** THESE ARE HOSES THAT CONNECT THE FUEL TANK, CHARCOAL CANISTER, AND ENGINE. THEY TRANSPORT FUEL VAPORS BETWEEN THESE COMPONENTS.
5. **PURGE SOLENOID:** THIS ELECTRICALLY CONTROLLED VALVE OPENS TO ALLOW THE STORED VAPORS IN THE CHARCOAL CANISTER TO FLOW INTO THE ENGINE INTAKE DURING SPECIFIC CONDITIONS, TYPICALLY WHEN THE ENGINE IS RUNNING AND UNDER

CERTAIN LOAD CONDITIONS.

6. VENT VALVE: THIS VALVE ALLOWS OUTSIDE AIR TO ENTER THE CHARCOAL CANISTER AND THE FUEL TANK DURING THE PURGE PROCESS AND PREVENTS VAPORS FROM ESCAPING WHEN THE SYSTEM IS NOT IN USE.

IMPORTANCE OF THE EVAP SYSTEM

THE EVAP SYSTEM IS ESSENTIAL FOR SEVERAL REASONS:

- ENVIRONMENTAL PROTECTION: BY CONTROLLING FUEL VAPOR EMISSIONS, THE EVAP SYSTEM HELPS PREVENT AIR POLLUTION AND CONTRIBUTES TO CLEANER AIR QUALITY.
- FUEL EFFICIENCY: A PROPERLY FUNCTIONING EVAP SYSTEM CAN IMPROVE FUEL EFFICIENCY BY ENSURING THAT FUEL VAPOR IS UTILIZED RATHER THAN WASTED.
- VEHICLE PERFORMANCE: AN EFFICIENT EVAP SYSTEM CAN ENHANCE OVERALL VEHICLE PERFORMANCE BY ALLOWING THE ENGINE TO OPERATE SMOOTHLY WITHOUT THE INTERFERENCE OF VAPOR LEAKS.

COMMON ISSUES WITH THE JEEP JK EVAP SYSTEM

WHILE THE EVAP SYSTEM IS DESIGNED TO BE DURABLE, IT CAN ENCOUNTER PROBLEMS OVER TIME. HERE ARE SOME COMMON ISSUES THAT JEEP JK OWNERS MAY FACE:

- CHARCOAL CANISTER FAILURE: OVER TIME, THE CHARCOAL IN THE CANISTER CAN BECOME SATURATED OR DAMAGED, REDUCING ITS ABILITY TO ABSORB FUEL VAPORS.
- LEAKING VAPOR LINES: CRACKS OR DISCONNECTIONS IN THE VAPOR LINES CAN LEAD TO VAPOR LEAKS, CAUSING A DROP IN SYSTEM EFFICIENCY.
- FAULTY PURGE OR VENT VALVES: IF THESE VALVES MALFUNCTION, THEY MAY NOT OPEN OR CLOSE PROPERLY, RESULTING IN INCORRECT VAPOR FLOW AND AFFECTING ENGINE PERFORMANCE.
- CHECK ENGINE LIGHT (CEL): A MALFUNCTIONING EVAP SYSTEM CAN TRIGGER THE CEL, INDICATING THAT THERE IS AN ISSUE THAT NEEDS TO BE ADDRESSED.

DIAGNOSING EVAP SYSTEM ISSUES

IF YOU SUSPECT THAT YOUR JEEP JK'S EVAP SYSTEM IS NOT FUNCTIONING CORRECTLY, FOLLOW THESE DIAGNOSTIC STEPS:

1. CHECK FOR DTCs (DIAGNOSTIC TROUBLE CODES): USE AN OBD-II SCANNER TO CHECK FOR ANY STORED TROUBLE CODES RELATED TO THE EVAP SYSTEM.
2. VISUAL INSPECTION: INSPECT THE EVAP SYSTEM COMPONENTS, INCLUDING THE CHARCOAL CANISTER AND VAPOR LINES, FOR ANY VISIBLE CRACKS OR DAMAGE.
3. SMOKE TESTING: A SMOKE TEST CAN HELP IDENTIFY LEAKS IN THE SYSTEM. SMOKE IS INTRODUCED INTO THE EVAP SYSTEM, AND ANY ESCAPING SMOKE INDICATES A LEAK.
4. VALVE FUNCTIONALITY TESTS: TESTING THE PURGE AND VENT VALVES CAN HELP DETERMINE IF THEY OPERATE CORRECTLY. THIS MAY INVOLVE APPLYING VOLTAGE TO THE VALVES TO SEE IF THEY OPEN AND CLOSE AS INTENDED.

READING THE JEEP JK EVAP SYSTEM DIAGRAM

UNDERSTANDING THE EVAP SYSTEM DIAGRAM IS ESSENTIAL FOR DIAGNOSING AND REPAIRING ISSUES. HERE IS HOW TO INTERPRET THE DIAGRAM EFFECTIVELY:

1. IDENTIFY COMPONENTS: FAMILIARIZE YOURSELF WITH THE SYMBOLS AND LINES USED TO REPRESENT VARIOUS COMPONENTS LIKE THE FUEL TANK, CHARCOAL CANISTER, AND VALVES.
2. FOLLOW THE FLOW: THE DIAGRAM WILL TYPICALLY SHOW THE FLOW OF FUEL VAPORS FROM THE FUEL TANK TO THE CHARCOAL CANISTER AND THEN TO THE ENGINE. FOLLOW THIS FLOW TO UNDERSTAND HOW THE SYSTEM OPERATES.
3. CHECK CONNECTIONS: PAY ATTENTION TO THE CONNECTIONS BETWEEN COMPONENTS, AS THESE ARE POTENTIAL AREAS FOR LEAKS OR MALFUNCTIONS.
4. REFER TO THE SERVICE MANUAL: FOR DETAILED DIAGRAMS AND SPECIFIC TROUBLESHOOTING STEPS, REFER TO THE JEEP SERVICE MANUAL FOR YOUR JK MODEL YEAR.

MAINTENANCE TIPS FOR THE EVAP SYSTEM

TO KEEP YOUR JEEP JK'S EVAP SYSTEM IN GOOD CONDITION, CONSIDER THE FOLLOWING MAINTENANCE TIPS:

- REGULAR INSPECTIONS: PERIODICALLY CHECK THE FUEL LINES, CHARCOAL CANISTER, AND VALVES FOR SIGNS OF WEAR OR DAMAGE.
- FUEL QUALITY: USE HIGH-QUALITY FUEL TO MINIMIZE THE RISK OF CLOGGING THE EVAP COMPONENTS WITH CONTAMINANTS.
- ADDRESS CEL PROMPTLY: IF THE CHECK ENGINE LIGHT COMES ON, DO NOT IGNORE IT. INVESTIGATE AND RESOLVE THE ISSUE TO PREVENT FURTHER COMPLICATIONS.
- PROFESSIONAL SERVICING: IF YOU ARE UNSURE ABOUT DIAGNOSING OR REPAIRING THE EVAP SYSTEM, CONSIDER SEEKING HELP FROM A QUALIFIED MECHANIC.

CONCLUSION

THE JEEP JK EVAP SYSTEM DIAGRAM IS A VITAL TOOL FOR ANY JEEP OWNER LOOKING TO UNDERSTAND AND MAINTAIN THEIR VEHICLE'S EMISSION CONTROL SYSTEM. BY FAMILIARIZING YOURSELF WITH THE COMPONENTS, DIAGNOSING POTENTIAL ISSUES, AND FOLLOWING MAINTENANCE TIPS, YOU CAN ENSURE THAT YOUR JEEP JK REMAINS ENVIRONMENTALLY FRIENDLY WHILE DELIVERING OPTIMAL PERFORMANCE. UNDERSTANDING THE EVAP SYSTEM NOT ONLY HELPS IN COMPLIANCE WITH EMISSIONS STANDARDS BUT ALSO CONTRIBUTES TO THE LONGEVITY AND EFFICIENCY OF YOUR VEHICLE. WHETHER YOU ARE A SEASONED MECHANIC OR A DIY ENTHUSIAST, A SOLID GRASP OF THE EVAP SYSTEM'S WORKINGS WILL EMPOWER YOU TO KEEP YOUR JEEP IN TOP SHAPE.

FREQUENTLY ASKED QUESTIONS

WHAT IS THE PURPOSE OF THE EVAP SYSTEM IN A JEEP JK?

THE EVAP SYSTEM IN A JEEP JK IS DESIGNED TO PREVENT FUEL VAPORS FROM ESCAPING INTO THE ATMOSPHERE, CAPTURING THEM IN A CHARCOAL CANISTER UNTIL THEY CAN BE PURGED AND BURNED IN THE ENGINE.

WHERE CAN I FIND A DETAILED EVAP SYSTEM DIAGRAM FOR A JEEP JK?

A DETAILED EVAP SYSTEM DIAGRAM FOR A JEEP JK CAN TYPICALLY BE FOUND IN THE VEHICLE'S SERVICE MANUAL, ONLINE FORUMS, OR WEBSITES DEDICATED TO JEEP REPAIRS AND MODIFICATIONS.

WHAT ARE COMMON ISSUES WITH THE JEEP JK EVAP SYSTEM?

COMMON ISSUES WITH THE JEEP JK EVAP SYSTEM INCLUDE LEAKS IN THE HOSES, A FAULTY GAS CAP, A MALFUNCTIONING PURGE VALVE, OR A DAMAGED CHARCOAL CANISTER, WHICH CAN TRIGGER THE CHECK ENGINE LIGHT.

HOW CAN I DIAGNOSE A PROBLEM WITH THE EVAP SYSTEM IN MY JEEP JK?

TO DIAGNOSE A PROBLEM WITH THE EVAP SYSTEM, YOU CAN USE AN OBD-II SCANNER TO CHECK FOR RELATED TROUBLE CODES, VISUALLY INSPECT THE HOSES AND CONNECTIONS FOR DAMAGE, AND PERFORM A SMOKE TEST TO LOCATE LEAKS.

WHAT COMPONENTS ARE INCLUDED IN THE JEEP JK EVAP SYSTEM DIAGRAM?

THE JEEP JK EVAP SYSTEM DIAGRAM TYPICALLY INCLUDES COMPONENTS SUCH AS THE FUEL TANK, CHARCOAL CANISTER, PURGE VALVE, VENT VALVE, AND VARIOUS HOSES CONNECTING THESE PARTS.

HOW OFTEN SHOULD I INSPECT THE EVAP SYSTEM IN MY JEEP JK?

IT'S RECOMMENDED TO INSPECT THE EVAP SYSTEM DURING REGULAR MAINTENANCE CHECKS, ESPECIALLY IF YOU NOTICE A FUEL ODOR, A CHECK ENGINE LIGHT, OR BEFORE EMISSIONS TESTING.

CAN I REPLACE EVAP SYSTEM COMPONENTS MYSELF ON A JEEP JK?

YES, MANY JEEP JK OWNERS CAN REPLACE EVAP SYSTEM COMPONENTS THEMSELVES WITH BASIC TOOLS AND MECHANICAL KNOWLEDGE, ALTHOUGH IT'S ADVISABLE TO CONSULT A SERVICE MANUAL FOR SPECIFIC PROCEDURES AND SAFETY PRECAUTIONS.

Find other PDF article:

<https://soc.up.edu.ph/36-tag/pdf?docid=wGB89-3974&title=kwikset-smart-lock-888-manual.pdf>

[Jeep Jk Evap System Diagram](#)

Why your steering wanders or seems loose. - Jeep Enthusiast Forums

Oct 6, 2023 · Why your steering wanders or seems loose One of the biggest issues with Jeeps and a topic that almost repeats itself in a new thread each week is "wandering or loose ...

Jeep Wrangler Forums

Jun 13, 2025 · The Jeep Wrangler (JL) is the fourth generation of the Wrangler off-road vehicle, available in two- and four-door bodies starting in 2017. Forum sponsored by: Quadratic

AUX Battery Location | Jeep Enthusiast Forums

Dec 5, 2024 · Here it is for anyone that stumbles onto this post: (11) Jeep Grand Cherokee Stop / Start Unavailable Service Fix Auxiliary Battery location & Replacement - YouTube EDIT: In ...

Starting System Diagnostics - Jeep Enthusiast Forums

Dec 27, 2010 · Jeep Enthusiast Forums provides answers from our community and over 22 other related forums.

All Marketplace Listings - Jeep Enthusiast Forums

Jun 14, 2025 · For Sale Jeep CJ5 CJ7 CJ8 Whitco soft top frame parts & hardware, rods, plastic trim, brackets \$240.00 mattt181 Apr 28, 2025 Body & Interior Parts Anaheim, California 0 196

Anyone tow a camper with the Gladiator? - Jeep Enthusiast Forums

Dec 18, 2024 · Looking into getting a gladiator within the next 6 months or so. Mostly looking at used but who knows. May eventually want to tow a small camper less than 20 ft long. Has ...

YJ Wrangler Technical Forum - Jeep Enthusiast Forums

Jul 12, 2007 · Second generation of the classic Jeep - manufactured from 1987 till 1995. Known by their square headlights.

2025 Grand Cherokee - Jeep Enthusiast Forums

Jul 13, 2025 · Jeep Enthusiast Forums provides answers from our community and over 22 other related forums.

1984 Jeep CJ-7 (May Sell, No Clue On Value)

Jul 15, 2025 · 304-Powered 1984 Jeep CJ-7 Bid for the chance to own a 304-Powered 1984 Jeep CJ-7 at auction with Bring a Trailer, the home of the best vintage and classic cars online. Lot ...

2024 grand cherokee intermittent issues - Jeep Enthusiast Forums

Dec 16, 2024 · Jeep Enthusiast Forums provides answers from our community and over 22 other related forums.

Why your steering wanders or seems loose. - Jeep Enthusiast Forums

Oct 6, 2023 · Why your steering wanders or seems loose One of the biggest issues with Jeeps and a topic that almost repeats itself in ...

Jeep Wrangler Forums

Jun 13, 2025 · The Jeep Wrangler (JL) is the fourth generation of the Wrangler off-road vehicle, available in two- and four-door bodies ...

AUX Battery Location | Jeep Enthusiast Forums

Dec 5, 2024 · Here it is for anyone that stumbles onto this post: (11) Jeep Grand Cherokee Stop / Start Unavailable Service Fix Auxiliary Battery ...

Starting System Diagnostics - Jeep Enthusiast Forums

Dec 27, 2010 · Jeep Enthusiast Forums provides answers from our community and over 22 other related forums.

All Marketplace Listings - Jeep Enthusiast Forums

Jun 14, 2025 · For Sale Jeep CJ5 CJ7 CJ8 Whitco soft top frame parts & hardware, rods, plastic trim, brackets \$240.00 mattt181 Apr 28, 2025 ...

Explore our detailed Jeep JK evap system diagram to understand its components and function. Learn more about maintenance tips and troubleshooting solutions today!

[Back to Home](#)