

Istim Ev 805 Manual

iStim EV-805 - 4 Channels Rechargeable TENS/EMS Combo Unit with 24 Preset Programs



- Users could easily operate and customize the most comfortable setting for their treatment.
- Large Backlit LCD clearly shows the selected mode, setting stats and the treatment remaining time even in the dark night.
- Portable Size of iStim EV-805 can be used in the office or travel on the go. For the purpose of pain relief, muscle relaxing and muscle strengthening, iStim EV-805 is the best choice for the users to start their pain free healthy life!!

- ✓ Adjustable Pulse Rate
- ✓ Adjustable Intensity
- ✓ Adjustable Pulse Width
- ✓ Adjustable Treatment Time

- 4 Channels
- 5 TENS Modes
- 3 EMS Modes
- 24 Preset Programs
- Rechargeable
- Backlit LCD Display

Note:
All the parameters and treatment time are flexible. Please find the most comfortable settings to start your treatment.

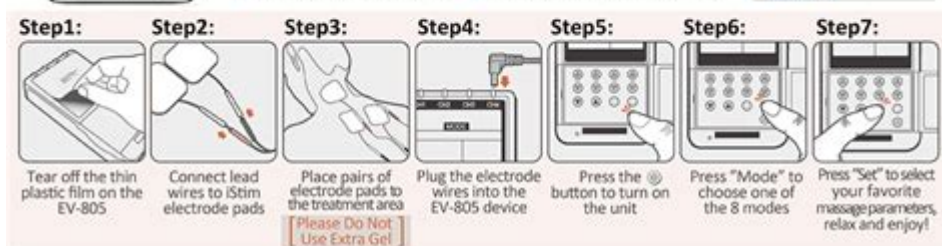

ISTIM EV 805 MANUAL IS AN ESSENTIAL GUIDE FOR USERS OF THE ISTIM EV 805, A VERSATILE AND SOPHISTICATED ELECTROTHERAPY DEVICE COMMONLY USED IN PHYSICAL THERAPY AND REHABILITATION SETTINGS. THIS DEVICE IS DESIGNED TO DELIVER VARIOUS ELECTRICAL STIMULATION MODALITIES, AIDING IN PAIN RELIEF, MUSCLE STRENGTHENING, AND REHABILITATION OF INJURIES. IN THIS ARTICLE, WE WILL EXPLORE THE FEATURES AND FUNCTIONS OF THE ISTIM EV 805, HOW TO USE IT EFFECTIVELY, TROUBLESHOOTING TIPS, AND SAFETY CONSIDERATIONS.

OVERVIEW OF THE ISTIM EV 805

THE ISTIM EV 805 IS A PORTABLE ELECTROTHERAPY UNIT EQUIPPED WITH ADVANCED TECHNOLOGY TO SUPPORT A RANGE OF THERAPEUTIC APPLICATIONS. DESIGNED FOR BOTH CLINICAL AND HOME USE, IT IS FAVORED BY PHYSICAL THERAPISTS, CHIROPRACTORS, AND PATIENTS SEEKING SELF-MANAGEMENT OPTIONS FOR PAIN AND MUSCLE RECOVERY.

KEY FEATURES

- **MULTIPLE MODES OF TREATMENT:** THE DEVICE OFFERS VARIOUS STIMULATION MODES, INCLUDING TENS (TRANSCUTANEOUS ELECTRICAL NERVE STIMULATION), EMS (ELECTRICAL MUSCLE STIMULATION), AND INTERFERENTIAL THERAPY. EACH MODE TARGETS SPECIFIC CONDITIONS AND PROVIDES DISTINCT BENEFITS.
- **ADJUSTABLE INTENSITY LEVELS:** USERS CAN FINE-TUNE THE INTENSITY OF THE ELECTRICAL IMPULSES, ALLOWING FOR PERSONALIZED THERAPY BASED ON INDIVIDUAL COMFORT LEVELS AND TREATMENT REQUIREMENTS.
- **USER-FRIENDLY INTERFACE:** THE ISTIM EV 805 IS EQUIPPED WITH AN INTUITIVE CONTROL PANEL FEATURING A DIGITAL DISPLAY, MAKING IT EASY TO NAVIGATE THROUGH SETTINGS AND MODES.
- **PORTABILITY:** WITH ITS COMPACT DESIGN AND BATTERY-OPERATED FUNCTIONALITY, THE DEVICE CAN BE USED ANYWHERE, MAKING IT CONVENIENT FOR USERS ON THE GO.
- **SAFETY FEATURES:** THE DEVICE INCLUDES BUILT-IN SAFETY MECHANISMS TO PREVENT OVER-STIMULATION AND ENSURE A SECURE USER EXPERIENCE.

How to Use the Istim EV 805

UNDERSTANDING HOW TO OPERATE THE Istim EV 805 IS CRUCIAL FOR MAXIMIZING ITS THERAPEUTIC BENEFITS. HERE'S A STEP-BY-STEP GUIDE TO USING THE DEVICE EFFECTIVELY:

STEP 1: PREPARATION

1. **READ THE MANUAL:** BEFORE USING THE Istim EV 805, IT IS ESSENTIAL TO READ THE **Istim EV 805 MANUAL** THOROUGHLY TO FAMILIARIZE YOURSELF WITH THE DEVICE'S FEATURES AND FUNCTIONS.
2. **GATHER NECESSARY SUPPLIES:** ENSURE YOU HAVE THE DEVICE, ELECTRODE PADS, GEL (IF REQUIRED), AND ANY ADDITIONAL ACCESSORIES SUGGESTED IN THE MANUAL.

STEP 2: SETTING UP THE DEVICE

1. **CHARGE THE DEVICE:** IF THE DEVICE IS RECHARGEABLE, ENSURE IT IS FULLY CHARGED BEFORE USE. IF IT OPERATES ON BATTERIES, CHECK THAT THEY ARE INSTALLED CORRECTLY AND HAVE SUFFICIENT POWER.
2. **APPLY ELECTRODE PADS:** CLEAN THE SKIN AREA WHERE THE ELECTRODES WILL BE PLACED. ADHERE THE ELECTRODE PADS SECURELY TO THE SKIN ACCORDING TO THE RECOMMENDED PLACEMENT IN THE **Istim EV 805 MANUAL**. COMMON PLACEMENTS INCLUDE:
 - FOR TENS: OVER THE PAINFUL AREA, ON BOTH SIDES OF THE PAIN, OR ALONG THE NERVE PATHWAYS.
 - FOR EMS: ON THE MUSCLE GROUPS YOU INTEND TO STIMULATE.

STEP 3: SELECTING TREATMENT MODE

1. **POWER ON:** TURN ON THE DEVICE USING THE POWER BUTTON.
2. **CHOOSE MODE:** USE THE CONTROL PANEL TO SELECT THE DESIRED TREATMENT MODE (TENS, EMS, ETC.).
3. **ADJUST SETTINGS:** SET THE FREQUENCY, PULSE WIDTH, AND INTENSITY ACCORDING TO THE GUIDELINES PROVIDED IN THE **Istim EV 805 MANUAL**. START WITH LOWER INTENSITY AND GRADUALLY INCREASE IT TO A COMFORTABLE LEVEL.

STEP 4: DURING TREATMENT

1. **MONITOR COMFORT:** KEEP TRACK OF YOUR COMFORT LEVEL THROUGHOUT THE TREATMENT. IF YOU EXPERIENCE ANY DISCOMFORT, REDUCE THE INTENSITY OR ADJUST THE PAD PLACEMENT.
2. **TREATMENT DURATION:** FOLLOW THE RECOMMENDED TREATMENT DURATION AS OUTLINED IN THE MANUAL, TYPICALLY RANGING FROM 15 TO 30 MINUTES.

STEP 5: POST-TREATMENT CARE

1. **POWER OFF:** ONCE THE TREATMENT SESSION IS COMPLETE, TURN OFF THE DEVICE.
2. **REMOVE ELECTRODE PADS:** CAREFULLY REMOVE THE ELECTRODE PADS FROM YOUR SKIN. CLEAN THE PADS AND STORE THEM ACCORDING TO THE INSTRUCTIONS IN THE **Istim EV 805 MANUAL**.
3. **ASSESS RESULTS:** AFTER TREATMENT, TAKE NOTE OF ANY CHANGES IN PAIN OR MUSCLE TENSION. KEEPING A JOURNAL MAY HELP TRACK PROGRESS OVER TIME.

COMMON APPLICATIONS OF THE ISTM EV 805

THE ISTM EV 805 IS EFFECTIVE FOR A VARIETY OF CONDITIONS. HERE ARE SOME COMMON APPLICATIONS:

- **PAIN MANAGEMENT:** IDEAL FOR CHRONIC PAIN CONDITIONS SUCH AS ARTHRITIS, BACK PAIN, AND NEUROPATHIC PAIN.
- **MUSCLE REHABILITATION:** EFFECTIVE IN MUSCLE STRENGTHENING AND RECOVERY AFTER INJURY OR SURGERY.
- **IMPROVING CIRCULATION:** CAN HELP ENHANCE BLOOD FLOW TO AFFECTED AREAS, PROMOTING HEALING.
- **REDUCING MUSCLE SPASMS:** ALLEVIATES TENSION AND INVOLUNTARY MUSCLE CONTRACTIONS.

TROUBLESHOOTING TIPS

DESPITE ITS USER-FRIENDLY DESIGN, USERS MAY ENCOUNTER SOME ISSUES WHILE OPERATING THE ISTM EV 805. HERE ARE SOME COMMON PROBLEMS AND THEIR SOLUTIONS:

1. **NO POWER:** ENSURE THE DEVICE IS CHARGED OR THAT THE BATTERIES ARE FUNCTIONING. CHECK THE POWER CONNECTION IF APPLICABLE.
2. **WEAK STIMULATION:** CHECK THE ELECTRODE PADS FOR DEGRADATION OR MISPLACEMENT. ENSURE THEY ARE SECURELY ATTACHED TO THE SKIN.
3. **DEVICE MALFUNCTION:** IF THE DEVICE IS NOT RESPONDING, TURN IT OFF AND RESTART. REFER TO THE **ISTIM EV 805 MANUAL** FOR RESET INSTRUCTIONS IF NECESSARY.
4. **SKIN IRRITATION:** IF IRRITATION OCCURS, DISCONTINUE USE AND CONSULT A HEALTHCARE PROFESSIONAL. CONSIDER CHANGING THE ELECTRODE PLACEMENT OR USING A SKIN BARRIER GEL.

SAFETY CONSIDERATIONS

USING THE ISTM EV 805 SAFELY IS PARAMOUNT TO ACHIEVING EFFECTIVE TREATMENT. HERE ARE SOME IMPORTANT SAFETY TIPS:

- CONSULT A HEALTHCARE PROFESSIONAL: BEFORE STARTING THERAPY, ESPECIALLY FOR THOSE WITH PRE-EXISTING MEDICAL CONDITIONS OR PREGNANCY, CONSULT WITH A HEALTHCARE PROVIDER.
- FOLLOW INSTRUCTIONS: ADHERE STRICTLY TO THE GUIDELINES OUTLINED IN THE **ISTIM EV 805 MANUAL** TO AVOID MISUSE.
- AVOID SENSITIVE AREAS: DO NOT PLACE ELECTRODE PADS OVER AREAS WITH OPEN WOUNDS, INFECTIONS, OR ON THE FRONT OF THE NECK OR THE HEAD.
- REGULARLY INSPECT EQUIPMENT: CHECK THE DEVICE AND ELECTRODES FOR ANY SIGNS OF WEAR OR DAMAGE BEFORE EACH USE.

CONCLUSION

THE ISTM EV 805 IS A POWERFUL TOOL IN THE REALM OF ELECTROTHERAPY, OFFERING A RANGE OF BENEFITS FOR PAIN MANAGEMENT AND REHABILITATION. BY UNDERSTANDING HOW TO OPERATE THE DEVICE EFFECTIVELY AND SAFELY, USERS CAN

HARNESS ITS FULL POTENTIAL FOR THERAPEUTIC PURPOSES. THE **ISTIM EV 805 MANUAL** SERVES AS AN INVALUABLE RESOURCE, GUIDING USERS THROUGH SETUP, OPERATION, AND TROUBLESHOOTING. WITH PROPER USE, THE ISTIM EV 805 CAN SIGNIFICANTLY IMPROVE THE QUALITY OF LIFE FOR THOSE DEALING WITH PAIN AND MUSCLE RECOVERY CHALLENGES.

FREQUENTLY ASKED QUESTIONS

WHAT IS THE PURPOSE OF THE ISTIM EV 805 MANUAL?

THE ISTIM EV 805 MANUAL PROVIDES DETAILED INSTRUCTIONS FOR THE OPERATION, MAINTENANCE, AND TROUBLESHOOTING OF THE ISTIM EV 805 ELECTROTHERAPY DEVICE, ENSURING SAFE AND EFFECTIVE USE.

WHERE CAN I FIND THE ISTIM EV 805 MANUAL?

THE ISTIM EV 805 MANUAL CAN TYPICALLY BE FOUND ON THE MANUFACTURER'S OFFICIAL WEBSITE, OR IT MAY BE INCLUDED IN THE PACKAGING OF THE DEVICE. ADDITIONALLY, SOME MEDICAL EQUIPMENT SUPPLIERS MAY OFFER DOWNLOADABLE VERSIONS.

ARE THERE ANY SAFETY PRECAUTIONS MENTIONED IN THE ISTIM EV 805 MANUAL?

YES, THE ISTIM EV 805 MANUAL INCLUDES ESSENTIAL SAFETY PRECAUTIONS SUCH AS ENSURING THE DEVICE IS USED ON CLEAN, DRY SKIN, AVOIDING THE APPLICATION OVER OPEN WOUNDS, AND ADHERING TO RECOMMENDED SESSION DURATIONS.

WHAT TYPES OF TREATMENTS DOES THE ISTIM EV 805 MANUAL COVER?

THE ISTIM EV 805 MANUAL COVERS VARIOUS TYPES OF ELECTROTHERAPY TREATMENTS, INCLUDING PAIN MANAGEMENT, MUSCLE STIMULATION, AND REHABILITATION PROTOCOLS FOR DIFFERENT CONDITIONS.

IS THERE TROUBLESHOOTING ADVICE IN THE ISTIM EV 805 MANUAL?

YES, THE ISTIM EV 805 MANUAL CONTAINS A TROUBLESHOOTING SECTION THAT ADDRESSES COMMON ISSUES USERS MAY ENCOUNTER, ALONG WITH STEPS TO RESOLVE THEM FOR OPTIMAL DEVICE PERFORMANCE.

Find other PDF article:

<https://soc.up.edu.ph/55-pitch/pdf?dataid=ibM30-9897&title=spice-hub-chipotle-training.pdf>

Istim Ev 805 Manual

How do you send high priority emails in yahoo? - Answers

Dec 27, 2024 · In Yahoo Mail, you can send high priority emails by marking them as "High Importance." When composing a new email, click on the three dots in the toolbar at the bottom of the email composition ...

"Too Many Failed attempts" in yahoo email : r/yahoo - Reddit

Jun 30, 2023 · Yahoo is an absolute shitshow Apparently my account is blocked because of too many attempts (repeatedly over the past month), which unless a bot/hacker somewhere is trying to access my account, is untrue.

How can you find out the correct URL of Yahoo Mail? - Answers

Feb 3, 2025 · Can you access Yahoo without using a yahoo.com URL? You could forward your Yahoo mail to another webmail account that you can access (AOL, Gmail, Hotmail and many others).

Yahoo doesn't even allow me to Block Senders : r/yahoo - Reddit

Jul 6, 2022 · The spam is already bad enough. I constantly move spam from my main inbox to my spam inbox everyday, and select all and block senders. Now, when I click block senders, my inbox empties for a second, then EVERY spam email reappears back in it. Yahoo, this is just sad. Not even allowing me to block spam emails now. It's pathetic how far you guys go to keep the ...

How do I get rid of the category system? : r/yahoo - Reddit

Nov 30, 2023 · The fact we can't select a classic view or anything is even more bullshit. I've been transitioning out of yahoo but still have some shit I can't figure out how to change. Idk what's going on over there but clearly more than one person higher up thought this was cool idea and decide not to give people an option.

how much is yahoo premium support before I call? : r/yahoo

Jan 12, 2023 · Hi. Our phone support agents will provide you information about the support subscription. In case they can assist you and you decide to get this subscription, you can always manage it online.

Can anyone Help me with my email? : r/yahoo - Reddit

Jan 16, 2023 · Identify the percentage of storage used in Yahoo Mail You have 1TB of storage available in Yahoo Mail. That's equal to 1000GBs! You can find out how much storage you're using and what percentage is left. Click the Settings menu icon Image of the Settings icon. | select More Settings. Go to the bottom of the left menu panel.

PSA: email log in loop fix for yahoo/att problems : r/yahoo - Reddit

Apr 30, 2022 · I appear to have gotten this. I have an At&t email address and a Yahoo email address. Antytime i try to log into Yahoo mail, it automatically redirects me to AT&T mail.

Does anyone know why Yahoo! mail is now so slow & terrible

Nov 3, 2022 · I contacted Yahoo! Support, which was a joke, because after several weeks it became clear that they were only interested in pointing fingers at other things that might be causing it, instead of acknowledging the clear design flaw in Yahoo! Mail. I don't see the pop-up in Firefox, but it's still horrifically slow -- worse than in Chrome.

Can't Login, "Rate Limited" error : r/yahoo - Reddit

Aug 8, 2021 · I can't get into my Yahoo mail account that I created in 1998 - because it says "rate limited" when I try to login. I have been using this yahoo mail account daily for decades. I use this email account for dozens and dozens of accounts including financial accounts. This ...

QUERY function - Google Docs Editors Help

QUERY(A2:E6,F2,FALSE) Syntax QUERY(data, query, [headers]) data - The range of cells to perform the query on. Each column of data can only hold boolean, numeric (including ...

Función QUERY - Ayuda de Editores de Documentos de Google

Función QUERY Ejecuta una consulta sobre los datos con el lenguaje de consultas de la API de visualización de Google. Ejemplo de uso QUERY(A2:E6,"select avg(A) pivot B") ...

QUERY - Справка - Редакторы Google Документов

Выполняет запросы на базе языка запросов API визуализации Google. Пример использования

QUERY (A2:E6; "select avg (A) pivot B") QUERY (A2:E6; F2; ЛОЖЬ) ...

[video] [GOOGLE SHEETS] FUNCIÓN QUERY: FUNCIONES DE ...

Ver en [GOOGLE SHEETS] FUNCIÓN QUERY: FUNCIONES DE AGREGACIÓN: SUM, AVG, COUNT, MIN y MAX 652 visualizaciones 4 votos a favor

Set default search engine and site search shortcuts

Set your default search engine On your computer, open Chrome. At the top right, select More Settings. Select Search engine. Next to "Search engine used in the address bar," select the ...

Scrivere e modificare una query

Per creare query in Fogli connessi, puoi accedere alle query salvate dai progetti BigQuery. Scopri di più sulle query salvate. Nel menu, nella parte superiore del foglio di lavoro, fai clic su Dati ...

[GOOGLE SHEETS] FUNCIÓN QUERY: USO DE LA CLÁUSULA SELECT

[GOOGLE SHEETS] FUNCIÓN QUERY: USO DE LA CLÁUSULA SELECT Compartir Si la reproducción no empieza en breve, prueba a reiniciar el dispositivo. Los vídeos que veas ...

BigQuery - Google Cloud Platform Console Help

Use datasets to organize and control access to tables, and construct jobs for BigQuery to execute (load, export, query, or copy data). Find BigQuery in the left side menu of the Google Cloud ...

QUERY - Guida di Editor di documenti Google

QUERY(dati; query; [intestazioni]) dati - L'intervallo di celle su cui eseguire la query. Ogni colonna di dati può contenere solo valori booleani, numerici (inclusi i tipi data/ora) o valori stringa. In ...

Refine searches in Gmail - Computer - Gmail Help - Google Help

Use a search operator On your computer, go to Gmail. At the top, click the search box. Enter a search operator. Tips: After you search, you can use the results to set up a filter for these ...

Discover the comprehensive Istim EV 805 manual for expert guidance and troubleshooting tips. Learn more to enhance your experience with this cutting-edge device!

[Back to Home](#)