

# Jeep Wrangler Emergency Brake Diagram

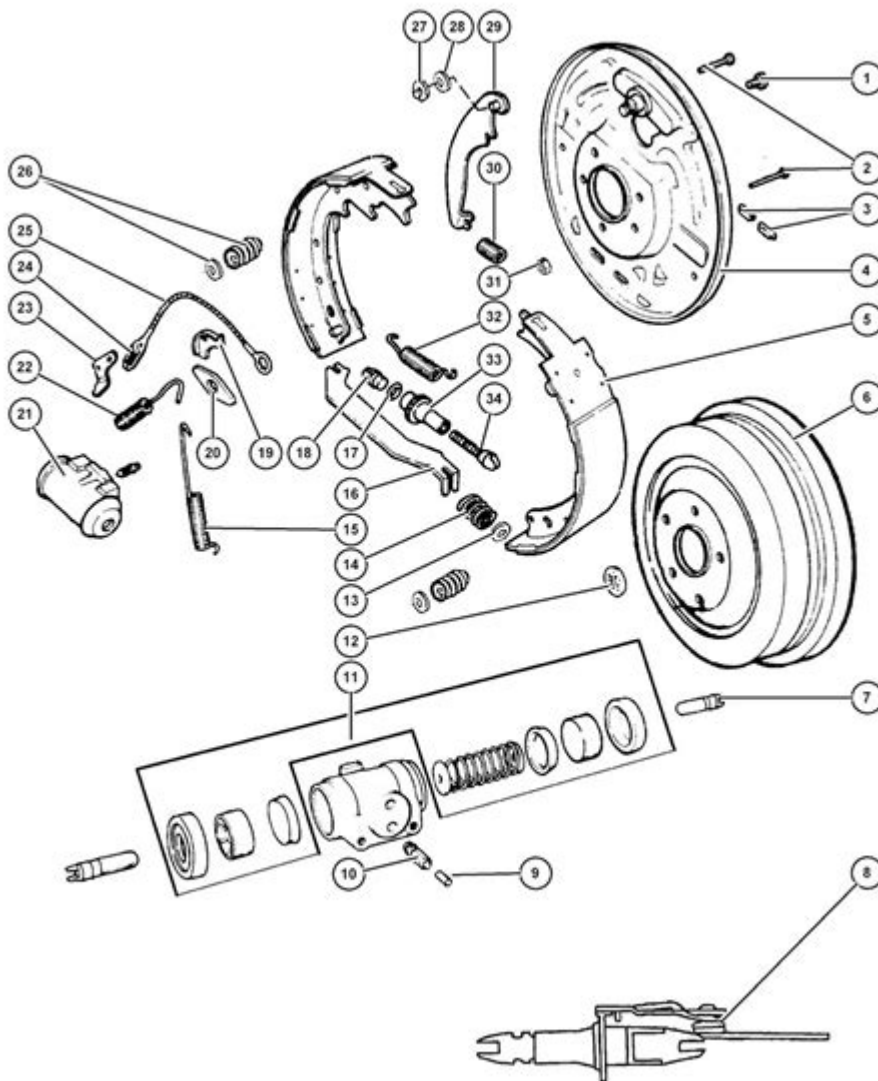

**Jeep Wrangler emergency brake diagram** is an essential resource for Jeep owners and enthusiasts who want to understand the mechanics of their vehicle's braking system. The emergency brake, also known as the parking brake, is a critical safety feature that helps prevent the vehicle from rolling when parked. In this article, we will explore the components of the Jeep Wrangler emergency brake system, how it works, common issues, and tips for maintenance. Additionally, we will provide a detailed overview of the emergency brake diagram to help you visualize the system.

## Understanding the Emergency Brake System in Jeep Wranglers

The emergency brake is a secondary braking system designed to keep the vehicle stationary when parked. It operates independently of the primary braking system and can be engaged manually. In

Jeep Wranglers, the emergency brake typically consists of several key components, including:

- Parking brake lever
- Cables
- Brake shoes or pads
- Brake drum or rotor

## **The Function of Each Component**

1. **Parking Brake Lever:** This is the lever located between the front seats (in most models) that the driver pulls to engage the emergency brake. It is connected to the brake cables and applies force to the brake shoes or pads.
2. **Cables:** The parking brake cables run from the lever to the rear brakes. They transmit the force from the lever to the brake shoes or pads, engaging the braking mechanism when pulled.
3. **Brake Shoes or Pads:** Depending on whether your Jeep has a drum or disc braking system in the rear, the emergency brake will use either brake shoes (in drum systems) or brake pads (in disc systems) to create friction and hold the vehicle in place.
4. **Brake Drum or Rotor:** The brake drum or rotor is the component against which the brake shoes or pads press to create the necessary friction to stop the wheels from turning.

## **How the Jeep Wrangler Emergency Brake Works**

The operation of the emergency brake system can be summarized in the following steps:

1. **Engagement:** When the driver pulls the parking brake lever, it pulls the cables connected to the rear brake assembly. This action causes the brake shoes or pads to press against the brake drum or rotor.
2. **Friction Creation:** As the shoes or pads press against the drum or rotor, friction is generated, which prevents the wheels from turning. This is crucial when parked on an incline or uneven surface.
3. **Release:** To disengage the emergency brake, the driver pushes the lever down, which releases the tension on the cables, allowing the brake shoes or pads to retract from the drum or rotor.

## **Jeep Wrangler Emergency Brake Diagram**

A detailed emergency brake diagram illustrates the components and their arrangement within the system. While we cannot provide a visual representation here, we can describe the typical layout you would find in such a diagram:

- Parking Brake Lever: Positioned between the front seats.
- Cables: Running from the lever to the rear wheels, often split into two cables for each side.
- Brake Assembly: Located at each rear wheel, showing the connection of the cables to the brake shoes or pads.
- Drum or Rotor: Placed around the brake shoes or pads, indicating how they engage to stop the vehicle.

This diagram serves as a helpful reference for understanding how the components work together to create a reliable emergency brake system.

## Common Issues with the Jeep Wrangler Emergency Brake

While the emergency brake system in Jeep Wranglers is generally reliable, several common issues can arise:

1. Cable Stretching: Over time, the parking brake cables can stretch, leading to reduced effectiveness. This may require adjustment or replacement of the cables.
2. Worn Brake Shoes or Pads: As with any braking system, the brake shoes or pads can wear out. If you notice the emergency brake not holding effectively, it may be time to inspect and replace these components.
3. Corrosion: In Jeep Wranglers exposed to harsh conditions, such as saltwater or mud, corrosion can affect the cables and braking components, leading to failure.
4. Improper Adjustment: If the emergency brake system is not properly adjusted, it may not engage fully, resulting in a lack of braking power when needed.

## Maintenance Tips for Your Jeep Wrangler Emergency Brake

To keep your emergency brake system functioning optimally, consider the following maintenance tips:

- **Regular Inspections:** Periodically check the condition of the cables, brake shoes, and pads for signs of wear or damage.
- **Adjust as Needed:** If you notice that the emergency brake lever pulls up higher than usual or does not hold the vehicle effectively, it may need adjustment.

- **Keep It Clean:** Ensure that the brake components are free from dirt, mud, and road salt that can cause corrosion.
- **Consult the Manual:** Refer to your Jeep Wrangler owner's manual for specific maintenance schedules and recommendations for your model year.

## Conclusion

The **Jeep Wrangler emergency brake diagram** is a valuable tool for understanding the intricacies of the emergency brake system. By familiarizing yourself with the components and their functions, you can better maintain your vehicle and address any issues that may arise. Regular inspections and proper maintenance will ensure that your emergency brake remains reliable, providing peace of mind when parking on inclines or uneven surfaces. Whether you're a seasoned Jeep enthusiast or a new owner, knowledge of your emergency brake system is crucial for safe driving and vehicle longevity.

## Frequently Asked Questions

### What is the purpose of the emergency brake in a Jeep Wrangler?

The emergency brake, also known as the parking brake, is designed to keep the vehicle stationary when parked, especially on inclines, and can also be used in emergencies to stop the vehicle if the main brakes fail.

### Where can I find the emergency brake diagram for a Jeep Wrangler?

The emergency brake diagram can typically be found in the Jeep Wrangler's owner's manual, service manuals, or online forums and repair websites dedicated to Jeep modifications and repairs.

### How do I interpret the emergency brake diagram for my Jeep Wrangler?

To interpret the emergency brake diagram, familiarize yourself with the symbols and lines used, which represent various components like cables, levers, and adjusters. Each part will have labels to identify its function.

### What are common issues with the emergency brake in a Jeep Wrangler?

Common issues include a loose or ineffective brake cable, worn brake pads, misalignment of components, or a failure in the brake lever mechanism, which can prevent the emergency brake from engaging properly.

## **How do I adjust the emergency brake on a Jeep Wrangler?**

To adjust the emergency brake, locate the adjustment mechanism, usually found near the lever or under the vehicle. Follow the manufacturer's instructions to tighten or loosen the cable to achieve the desired tension.

## **Can I replace the emergency brake components myself?**

Yes, many Jeep Wrangler owners can replace emergency brake components themselves if they have basic mechanical skills and the right tools. However, it's essential to follow a repair manual for guidance.

## **What tools do I need to repair the emergency brake on a Jeep Wrangler?**

Typically, you'll need basic hand tools such as wrenches, pliers, screwdrivers, and possibly a jack and jack stands to safely lift the vehicle for access.

## **Is there a specific emergency brake diagram for different Jeep Wrangler models?**

Yes, the emergency brake diagram can vary between different Jeep Wrangler models and years. It's important to reference the diagram specific to your vehicle's model and year for accurate information.

## **How can I troubleshoot an emergency brake that won't hold on my Jeep Wrangler?**

To troubleshoot an emergency brake that won't hold, check for loose cables, inspect the brake pads for wear, ensure the lever is functioning correctly, and verify the adjustment mechanism is properly set.

Find other PDF article:

<https://soc.up.edu.ph/14-blur/files?trackid=YjP96-6479&title=compliance-training-email-template.pdf>

## **[Jeep Wrangler Emergency Brake Diagram](#)**

### **Why your steering wanders or seems loose. - Jeep Enthusiast Forums**

Oct 6, 2023 · Why your steering wanders or seems loose One of the biggest issues with Jeeps and a topic that almost repeats itself in a new thread each week is "wandering or loose ...

### **Jeep Wrangler Forums**

Jun 13, 2025 · The Jeep Wrangler (JL) is the fourth generation of the Wrangler off-road vehicle, available in two- and four-door bodies starting in 2017. Forum sponsored by: Quadratic

### **AUX Battery Location | Jeep Enthusiast Forums**

Dec 5, 2024 · Here it is for anyone that stumbles onto this post: (11) Jeep Grand Cherokee Stop / Start Unavailable Service Fix Auxiliary Battery location & Replacement - YouTube EDIT: In ...

### **Starting System Diagnostics - Jeep Enthusiast Forums**

Dec 27, 2010 · Jeep Enthusiast Forums provides answers from our community and over 22 other related forums.

### All Marketplace Listings - Jeep Enthusiast Forums

Jun 14, 2025 · For Sale Jeep CJ5 CJ7 CJ8 Whitco soft top frame parts & hardware, rods, plastic trim, brackets \$240.00 mattt181 Apr 28, 2025 Body & Interior Parts Anaheim, California 0 196

### *Anyone tow a camper with the Gladiator? - Jeep Enthusiast Forums*

Dec 18, 2024 · Looking into getting a gladiator within the next 6 months or so. Mostly looking at used but who knows. May eventually want to tow a small camper less than 20 ft long. Has ...

### **YJ Wrangler Technical Forum - Jeep Enthusiast Forums**

Jul 12, 2007 · Second generation of the classic Jeep - manufactured from 1987 till 1995. Known by their square headlights.

### *2025 Grand Cherokee - Jeep Enthusiast Forums*

Jul 13, 2025 · Jeep Enthusiast Forums provides answers from our community and over 22 other related forums.

### **1984 Jeep CJ-7 (May Sell, No Clue On Value)**

Jul 15, 2025 · 304-Powered 1984 Jeep CJ-7 Bid for the chance to own a 304-Powered 1984 Jeep CJ-7 at auction with Bring a Trailer, the home of the best vintage and classic cars online. Lot ...

### **2024 grand cherokee intermittent issues - Jeep Enthusiast Forums**

Dec 16, 2024 · Jeep Enthusiast Forums provides answers from our community and over 22 other related forums.

### Why your steering wanders or seems loose. - Jeep Enthusiast F...

Oct 6, 2023 · Why your steering wanders or seems loose One of the biggest issues with Jeeps and a topic that almost ...

### **Jeep Wrangler Forums**

Jun 13, 2025 · The Jeep Wrangler (JL) is the fourth generation of the Wrangler off-road vehicle, available in two- and four ...

### **AUX Battery Location | Jeep Enthusiast Forums**

Dec 5, 2024 · Here it is for anyone that stumbles onto this post: (11) Jeep Grand Cherokee Stop / Start Unavailable ...

### Starting System Diagnostics - Jeep Enthusiast Forums

Dec 27, 2010 · Jeep Enthusiast Forums provides answers from our community and over 22 other related forums.

### **All Marketplace Listings - Jeep Enthusiast Forums**

Jun 14, 2025 · For Sale Jeep CJ5 CJ7 CJ8 Whitco soft top frame parts & hardware, rods, plastic trim, brackets \$240.00 ...

Discover a detailed Jeep Wrangler emergency brake diagram to help you understand its components and functionality. Learn more to keep your vehicle safe!

[Back to Home](#)