

Into The Backrooms Guide

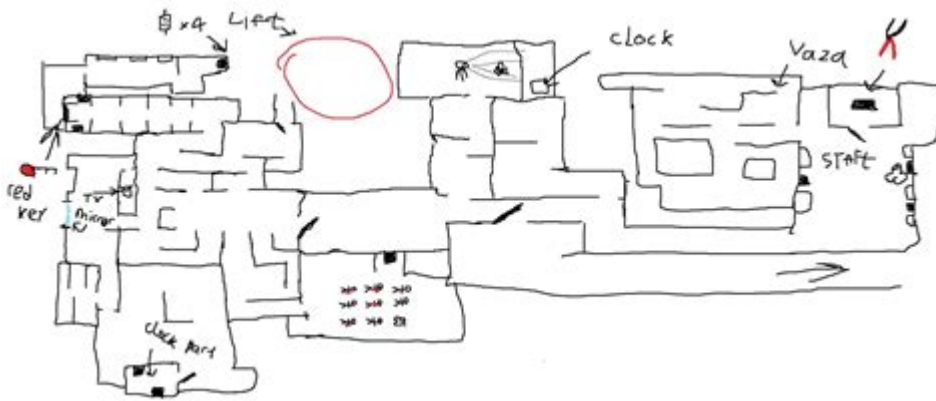

Into the Backrooms Guide: A Journey Through the Infinite Maze of the Unknown

The concept of the "Backrooms" originates from an internet creepypasta that has gained popularity in various online communities. This eerie and surreal alternate reality is often depicted as an endless series of monotonous rooms and hallways, filled with unsettling sounds and a sense of disorientation. In this guide, we will explore the origins of the Backrooms, how to navigate them, and the various layers and entities that may inhabit this unsettling dimension.

Understanding the Backrooms

The Backrooms are often described as a liminal space, a term used in psychology to describe transitional or in-between spaces that evoke feelings of unease or nostalgia. The most common depiction of the Backrooms features:

- Yellowed, stained walls
- Humid and musty carpeting
- The incessant buzz of fluorescent lights
- A seemingly infinite expanse of empty rooms and hallways

This environment can lead to feelings of isolation and paranoia, making it a popular setting for horror stories, games, and art.

Origins of the Backrooms

The Backrooms were first introduced to the internet in a post on 4chan in 2019. The original post described a strange experience of "noclipping" out of reality and finding oneself in a seemingly endless series of yellow rooms. This concept quickly evolved into a shared narrative, prompting users to expand upon the idea, creating a rich lore filled with various layers and entities.

Navigating the Backrooms

For those who find themselves in the Backrooms—whether in a dream, a game, or through imagination—navigating this bizarre space can be both thrilling and terrifying. Here are some tips to help you survive your journey into the Backrooms.

1. Stay Calm

The first and most crucial tip is to remain calm. Panic can lead to poor decision-making, which may result in getting lost or encountering hostile entities. Remember, the Backrooms are a manifestation of fear; maintaining composure can help you think clearly.

2. Familiarize Yourself with the Environment

Understanding the layout of the Backrooms can be beneficial. While the structure may seem chaotic, there are some common features:

- Rooms: Typically, the rooms are small and feature flickering lights, damp carpets, and a musty odor.
- Hallways: Long and winding, hallways can lead to other rooms or deeper levels of the Backrooms.
- Exits: Some exits may lead you back to reality, while others may plunge you into more complex layers.

3. Use Your Senses

Your senses can be your best allies in the Backrooms. Pay attention to:

- Sounds: The buzzing of lights, distant footsteps, or unsettling whispers can indicate the presence of entities or other explorers.
- Smells: The scent of dampness, decay, or something burning can signal danger or a nearby exit.
- Visual Cues: Look for patterns on the walls or changes in lighting, which may hint at nearby exits or entities.

Layers of the Backrooms

The Backrooms are often depicted as having multiple layers, each with its own unique characteristics and challenges. Here are some of the most commonly referenced layers:

Level 0: The Entrance

Level 0 is the starting point for most explorers. It consists of the familiar yellow rooms, endless hallways, and the constant hum of fluorescent lights. This level can evoke feelings of nostalgia, but it is also where many get trapped due to its familiarity.

Level 1: The Warehouse

Upon venturing deeper, explorers may find themselves in Level 1, a vast, industrial space resembling an abandoned warehouse. This level features:

- Larger rooms and more complex layouts
- Pools of water that can lead to flooding
- The presence of hostile entities

Level 2: The Maintenance Tunnels

Level 2 is characterized by dark, narrow passages and the sounds of machinery. This level's oppressive atmosphere can be disorienting, and the risk of encountering hostile entities increases significantly. Survivors often report:

- A feeling of being watched
- Sudden drops in temperature
- The presence of strange machinery

Entities of the Backrooms

The Backrooms are not empty; they are inhabited by various entities, many of which can pose a threat to explorers. Understanding these entities can help you navigate safely.

Common Entities

- Hounds: These are aggressive, dog-like creatures that stalk the hallways. They are attracted to sound, so it's best to move quietly.
- Facelings: Humanoid figures with featureless faces. They may be benign or hostile, and their intentions are often unclear.
- The Smilers: These entities are known for their eerie, toothy grins and are usually found in darker areas. They can be dangerous, especially when provoked.

Survival Strategies

To survive encounters with these entities, consider the following strategies:

- Avoid Noise: Many entities are attracted to sound. Move quietly and avoid sudden movements.
- Blend In: If you encounter humanoid entities, try to mimic their behavior to avoid drawing attention to yourself.
- Know When to Run: If you feel threatened, don't hesitate to flee. Rely on your instincts to determine when it's time to escape.

Escaping the Backrooms

While the Backrooms may seem endless, there are potential exits that can lead you back to reality. Here are some tips for finding an escape:

1. Look for Doors and Windows

While rare, some rooms may contain doors or windows that can lead you back to reality. Examine these carefully, as they may not always be visible.

2. Follow the Sounds

If you hear voices or the sounds of movement, follow them cautiously. They may lead you to other explorers or potential exits.

3. Trust Your Instincts

Your intuition can be your guide. If something feels wrong or off, trust that feeling and change your course.

Conclusion

The Backrooms represent a unique blend of horror, nostalgia, and the unknown. While navigating this surreal environment can be daunting, understanding its layers, entities, and survival strategies can enhance your journey. Whether you encounter it through a story, a game, or your imagination, the Backrooms will continue to captivate and terrify those brave enough to explore its depths. Remember, the key to surviving the Backrooms lies in remaining calm, being observant, and trusting your instincts as you traverse this unsettling labyrinth.

Frequently Asked Questions

What are the backrooms in the context of internet lore?

The backrooms are a popular urban legend and internet meme that depict an endless maze of yellow, monotonous rooms, characterized by the smell of damp carpet and buzzing fluorescent lights. They are often described as a liminal space, representing a sense of being lost in an infinite, unsettling environment.

What is the primary objective of the 'Into the Backrooms' guide?

The 'Into the Backrooms' guide aims to provide players with tips, strategies, and lore-related information to navigate the backrooms safely, avoid dangers, and uncover the mysteries hidden within this surreal environment.

What are some common entities found in the backrooms?

Common entities encountered in the backrooms include Hounds, Facelings, Smilers, and the infamous 'wretches,' each with unique behaviors and characteristics that pose various threats to explorers.

How can players effectively navigate the backrooms?

Players can effectively navigate the backrooms by memorizing landmarks, using audio cues to detect nearby entities, and staying aware of their surroundings to avoid getting lost or encountering dangers.

Are there any safe zones in the backrooms?

Yes, there are certain areas considered safe zones, often referred to as 'safe rooms' or 'hubs,' where players can rest, gather supplies, and plan their next moves without the immediate threat of entities.

What items are recommended to carry in the backrooms?

Recommended items include flashlights, food supplies, first-aid kits, and maps of the backrooms, if available, to help players sustain themselves and navigate the layout more effectively.

Is there a specific exit strategy for escaping the backrooms?

While there is no guaranteed exit strategy, players are encouraged to look for exits that may appear as doors or windows, and to always keep moving and exploring to find potential pathways leading out.

How does the lore of the backrooms evolve in community interpretations?

The lore of the backrooms evolves through community contributions, fan theories, and gameplay experiences, leading to diverse interpretations and expanded narratives that enrich the overall mythos.

Where can I find more resources or community discussions about the backrooms?

More resources and community discussions can be found on platforms like Reddit, Discord, and various gaming forums, where enthusiasts share experiences, artwork, and strategies related to the backrooms.

Find other PDF article:

<https://soc.up.edu.ph/18-piece/Book?dataid=rIH32-6511&title=don-t-look-back-karin-fossum.pdf>

[Into The Backrooms Guide](#)

[Shell Credit Card: Log In or Apply](#)

Manage your Shell credit card account online, any time, using any device. Submit an application for a Shell credit card now.

[Shell Global](#)

Shell is a global group of energy and petrochemical companies. Learn more about Shell on our global website.

[Shell USA, Inc.](#)

Discover Shell in the United States: fuels, oil, natural gas, lubricants, chemicals; with major projects in the Gulf of Mexico, and refineries and manufacturing in Texas and Pennsylvania.

Shell plc - Wikipedia

Shell was formed in April 1907 through the merger of Royal Dutch Petroleum Company of the Netherlands and The "Shell" Transport and Trading Company of the United Kingdom.

Shell | Station Locator | Find the Nearest Station | Shell USA, Inc.

Use the map filter below to find different fuel types available in your area. Plan your route and find a Shell station with our Station Locator tool, where you can quickly find the location and ...

Shell Credit Card - Sign On or Apply Online

Sign on and manage your credit card account. Don't have an account? Apply online today.

[How to get in touch | About Us - Shell USA, Inc.](#)

Via this page you can find the website and contact details for most Shell offices and businesses around the world.

Who we are - Shell Global

Mar 25, 2025 · Shell is a global group of energy and petrochemical companies, employing 96,000 people across more than 70 countries.

Shell for business

Shell Energy provides innovative, reliable, cleaner energy solutions through a portfolio of natural gas, wholesale and retail power, environmental products and energy efficiency offers to ...

Shell subsidiary Savion to streamline five U.S. solar projects ...

1 day ago · Shell plans to continue developing other onshore renewable power generation assets through Savion's development pipeline. "The investment by Ares is a testament to Savion's ...

What bone protects the brain? - Answers

Jun 8, 2024 · The bone in our head is called the skull. It protects the brain and provides structure for the face. The skull is the bony structure of the head that protects the brain and supports the face.

What is the bony covering that protects the brain called?

Jun 11, 2024 · The bony covering that protects the brain is called the skull. It is made up of several bones, including the frontal, parietal, temporal, and occipital bones, which together form a sturdy and ...

What bones protects certain internal organs of the body?

Jun 21, 2024 · The skeleton protects internal organs. Head The skull protects the brain. Spine The spinal vertebral bodies protect the spinal cord. Chest The clavicle on each side helps protect the neck, major ...

What structures protect the brain? - Answers

Jun 13, 2024 · The frontal bone forms the forehead and part of the eye socket. It helps protect the brain and supports important structures like the frontal lobe of the brain.

What bone protects our brain? - Answers

It is made up of fused bones; the frontal bone, the temporal bones, the parietal bones and the occipital bone; and other minor bones are also involved in protecting the brain, such as the sphenoid ...

What is the name of the part of the human skeleton which ...

Jun 21, 2024 · The other name for "brain box" is cranium. It is the part of the skull that encloses and protects the brain. The scientific name for a human skeleton is Homo sapiens skeletal system.

What bone protects your brain? - Answers

Nov 14, 2022 · a skeleton that is why head is hard skull bones the Frontal Bone, parietal bone, temporal bone, occipital bone and the temporal bone are the bones that protect your brain. =D

The bone that protects the brain is the? - Answers

The bone that protects the brain is called the skull. Without this bone, the brain is easily be harmed or damaged.

How many bones are in the brain? - Answers

Jun 12, 2024 · There are no bones in the human brain. The human skull protects the brain, which is made up of soft tissue. The collective name for the skull bones that encase the brain is the cranium.

What bone protects the lungs? - Answers

Jun 9, 2024 · The rib cage is the bone that protects the lungs. The ribs are connected to the thoracic vertebrae at the back and the sternum at the front to form a protective enclosure around the lungs and ...

Explore our comprehensive "Into the Backrooms Guide" for tips

[Back to Home](#)