

How To Use Revit Architecture

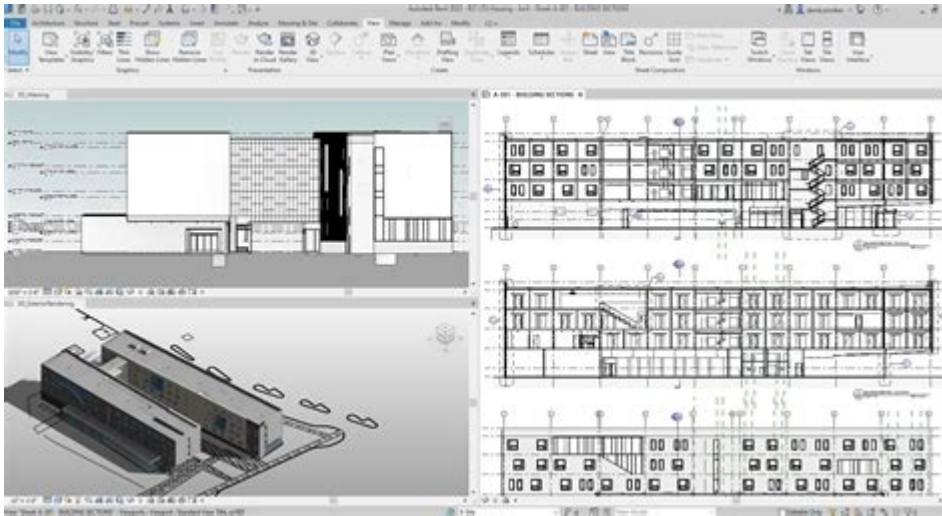

How to use Revit Architecture is a crucial skill for architects and building design professionals. Revit Architecture is a Building Information Modeling (BIM) software developed by Autodesk, allowing architects to design, visualize, and manage building projects effectively. This article will guide you through the essential features and functionalities of Revit Architecture, helping you to harness its full potential for your projects.

Understanding Revit Architecture

Before diving into how to use Revit Architecture, it's important to understand what it is and how it differs from traditional CAD software.

Revit is built on the concept of BIM, where a digital representation of physical and functional characteristics of a building is created. Unlike CAD, which focuses on 2D drawings, Revit enables users to create 3D models that are embedded with data, allowing for more efficient design, collaboration, and management throughout the lifecycle of a building.

Getting Started with Revit Architecture

To effectively use Revit Architecture, you need to set up your environment and familiarize yourself with its interface.

Installation and Setup

1. **Acquire the Software:** Purchase or download a trial version of Revit

Architecture from the Autodesk website.

2. System Requirements: Ensure your computer meets the minimum system requirements to run Revit efficiently.

3. Installation: Follow the installation instructions provided by Autodesk, ensuring you install any necessary plugins or updates.

Interface Overview

Once installed, launch Revit Architecture. The interface consists of several key components:

- Ribbon: Contains various tabs such as Home, Architecture, Structure, and Systems, each housing relevant tools and commands.
- Project Browser: Displays the structure of your project, including views, sheets, families, and schedules.
- Properties Palette: Shows properties of selected elements, allowing for modifications.
- Drawing Area: The workspace where you will create and manipulate your model.

Familiarizing yourself with these components will streamline your workflow as you begin to use Revit.

Creating Your First Project

To start using Revit Architecture, you need to create a new project.

Starting a New Project

1. Select a Template: Open Revit and choose a project template based on the type of building you are designing (e.g., architectural, structural).
2. Define Project Settings: Set up units, levels, and grids according to your project needs. This includes:
 - Units: Go to the Manage tab and select Project Units to set your preferred measurement system.
 - Levels: Create levels to define the vertical extent of your building.
 - Grids: Establish grids for alignment and organization.

Modeling the Building

Now that your project is set up, you can start modeling your building.

1. Creating Walls:

- Use the Wall tool from the Architecture tab.
 - Choose the wall type and draw the walls in the drawing area.
2. Adding Doors and Windows:
- Use the Door and Window tools to place openings in your walls.
 - Select the appropriate family type and click to place them.
3. Creating Floors and Roofs:
- Use the Floor tool to sketch out floor plans.
 - For roofs, select the Roof tool and choose the appropriate roof type, then sketch the outline.
4. Adding Components:
- Insert furniture, fixtures, and other components using the Component tool. Revit comes with a library of families, or you can load custom ones.
5. Using Annotations:
- Add dimensions, text notes, and tags to provide clarity to your drawings. Access these tools from the Annotate tab.

Working with Views

Views in Revit Architecture are crucial for visualizing and presenting your design.

Creating Different Views

1. Floor Plans: Automatically generated based on levels you've defined.
2. 3D Views: Generate 3D representations of your model by selecting the 3D View option from the View tab.
3. Sections and Elevations: Create sections and elevation views to analyze different aspects of your building.

Customizing Views

You can customize views by applying visibility settings, applying filters, and creating view templates. This enhances clarity and focus on specific design elements.

Collaboration and Documentation

One of the strengths of Revit Architecture is its ability to facilitate collaboration among team members.

Collaboration Tools

1. Worksharing: Enable worksharing to allow multiple users to work on the same project simultaneously.
2. Linked Models: Collaborate with other disciplines by linking their Revit models into your project.

Creating Construction Documents

Once your design is complete, you need to generate construction documents.

1. Sheets: Create sheets to organize your drawings. Go to the View tab and select Sheet.
2. Place Views: Drag and drop your views onto the sheets.
3. Add Notes and Legends: Use annotations and legends to provide additional information on the sheets.

Using Families in Revit

Families are essential components in Revit Architecture, allowing you to create and manage different elements within your project.

Types of Families

1. System Families: Built-in elements such as walls, floors, and roofs.
2. Loadable Families: Custom components that can be created or imported, like furniture and fixtures.
3. In-Place Families: Custom elements created directly in the project environment.

Creating Custom Families

1. Open the Family Editor from the Application menu.
2. Choose a family template that suits your requirements.
3. Model the family using 3D tools and parameters.
4. Save and load the family into your project.

Advanced Features and Tips

To further enhance your use of Revit Architecture, consider exploring

advanced features.

Parametric Design

Revit allows for parametric design, meaning you can create relationships between elements. For example, if you change the height of a wall, adjacent elements will automatically adjust based on defined parameters.

Rendering and Visualization

Utilize the rendering features in Revit to create realistic images of your design. Adjust lighting, materials, and settings to produce high-quality visualizations.

Learning Resources

To master Revit Architecture, consider the following resources:

- Online Courses: Websites like Udemy, LinkedIn Learning, and Coursera offer courses on Revit.
- YouTube Tutorials: Many experienced users share tips and tutorials on YouTube.
- User Forums: Engage with the Revit community through forums such as Autodesk's own community or RevitCity.

Conclusion

Using Revit Architecture can greatly enhance your design workflow, allowing you to create detailed, data-rich models. By following the steps outlined in this article, you can begin to harness the power of Revit for your architectural projects. With continued practice and exploration of its features, you'll find that Revit is an invaluable tool in the field of architecture.

Frequently Asked Questions

What are the basic steps to start a project in Revit Architecture?

To start a project in Revit Architecture, open the software, select 'New Project' from the home screen, choose a template that suits your project

type, and set up your project units and levels before beginning your design.

How can I create and manage views in Revit Architecture?

You can create views in Revit Architecture by navigating to the 'View' tab, selecting 'Plan Views' or 'Section Views' as needed. To manage views, use the Project Browser to organize, rename, and duplicate views for better workflow.

What is the purpose of families in Revit Architecture and how do I use them?

Families in Revit Architecture are parametric objects that can represent building components like doors, windows, and furniture. You can use them by loading existing families from the library, creating new ones, or modifying existing families to fit your project requirements.

How can I collaborate with others while using Revit Architecture?

To collaborate in Revit Architecture, you can use worksets to divide the project into manageable sections, enabling multiple users to work simultaneously. You can also use the 'Collaborate' tab to initiate a central file and synchronize changes with your team.

What are the best practices for organizing my Revit Architecture project?

Best practices for organizing your Revit Architecture project include using a consistent naming convention for views and families, categorizing elements logically, utilizing worksets effectively, and regularly cleaning up unused elements and views to maintain project efficiency.

Find other PDF article:

<https://soc.up.edu.ph/43-block/files?trackid=WPu53-6272&title=nj-lee-exam-results.pdf>

How To Use Revit Architecture

Create a Gmail account - Google Help

Create an account Tip: To use Gmail for your business, a Google Workspace account might be better for you than a personal Google Account. With Google Workspace, you get increased ...

Chat Support Help

Official Chat Support Help Center where you can find tips and tutorials on using Chat Support and

other answers to frequently asked questions.

Download and install Google Chrome

To use Chrome on Mac, you need macOS Big Sur 11 and up. If you don't know the admin password, drag Chrome to a place on your computer where you can make edits, like your ...

Make Google your default search engine - Google Search Help

To get results from Google each time you search, you can make Google your default search engine. Set Google as your default on your browser If your browser isn't listed below, check its ...

Get started with Google Play

What you can do with Google Play Get games for Android devices and Chromebooks. Download Google Play Games Mobile App. Rent or buy movies and TV shows. Download the Google TV ...

Printer keeps going "offline" Windows 11 - Microsoft Community

Feb 18, 2024 · My printer has worked fine until a month or two. Since then it keeps going offline. I have updated software drivers etc. I need to poke around with troubleshooters etc every time ...

M365 Copilot-created file placed at unreachable URL: - Microsoft ...

Jun 25, 2025 · When I asked M365 Copilot to generate a PPT for me, it said it had done so and placed it at a link beginning with "sandbox:/mnt/data". However, this is not a clickable link and I ...

Microsoft Support and Recovery Assistant for Office 365

Doesn't support MFA. Tried to diagnose Outlook 2016 (with ADAL enabled) that keeps asking for authentication, but the tool says I need to use an app password. Enabling ADAL means you ...

Someone sent me a contact group as an attachment. I want to ...

Someone sent me a contact group as an attachment. I want to save it in my contacts. How do I do this?

Get started with Google Photos - Computer - Google Photos Help

The activity-based personalization setting allows Google Photos to show you even more personalized memories based on how you interact with features in Photos. To further ...

Create a Gmail account - Google Help

Create an account Tip: To use Gmail for your business, a Google Workspace account might be better for you than a personal Google Account. With Google Workspace, you get increased ...

Chat Support Help

Official Chat Support Help Center where you can find tips and tutorials on using Chat Support and other answers to frequently asked questions.

Download and install Google Chrome

To use Chrome on Mac, you need macOS Big Sur 11 and up. If you don't know the admin password, drag Chrome to a place on your computer where you can make edits, like your ...

Make Google your default search engine - Google Search Help

To get results from Google each time you search, you can make Google your default search engine. Set Google as your default on your browser If your browser isn't listed below, check its ...

Get started with Google Play

What you can do with Google Play Get games for Android devices and Chromebooks. Download Google Play Games Mobile App. Rent or buy movies and TV shows. Download the Google TV ...

Printer keeps going "offline" Windows 11 - Microsoft Community

Feb 18, 2024 · My printer has worked fine until a month or two. Since then it keeps going offline. I have updated software drivers etc. I need to poke around with troubleshooters etc every time ...

M365 Copilot-created file placed at unreachable URL: - Microsoft ...

Jun 25, 2025 · When I asked M365 Copilot to generate a PPT for me, it said it had done so and placed it at a link beginning with "sandbox:/mnt/data". However, this is not a clickable link and I ...

Microsoft Support and Recovery Assistant for Office 365

Doesn't support MFA. Tried to diagnose Outlook 2016 (with ADAL enabled) that keeps asking for authentication, but the tool says I need to use an app password. Enabling ADAL means you ...

Someone sent me a contact group as an attachment. I want to ...

Someone sent me a contact group as an attachment. I want to save it in my contacts. How do I do this?

Get started with Google Photos - Computer - Google Photos Help

The activity-based personalization setting allows Google Photos to show you even more personalized memories based on how you interact with features in Photos. To further ...

Unlock the full potential of your designs with our guide on how to use Revit Architecture. Learn how to streamline your workflow and enhance your projects. Discover how!

[Back to Home](#)