

# Hobart Handler 140 Parts Diagram

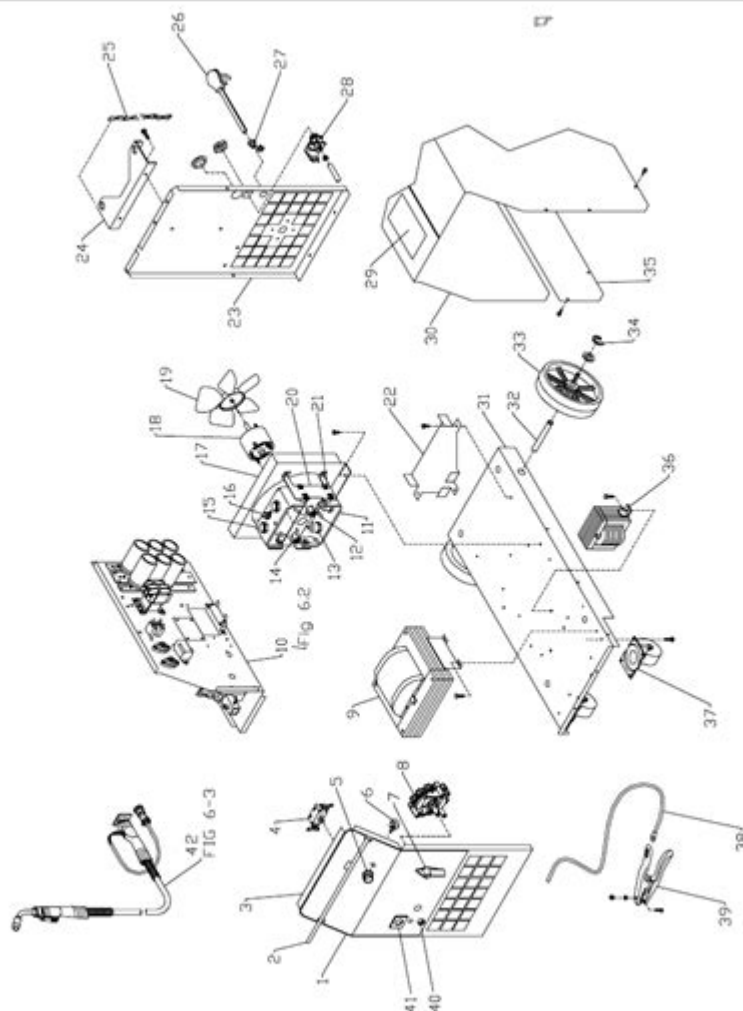

**Hobart Handler 140 Parts Diagram** is an essential tool for anyone who owns or operates a Hobart Handler 140 MIG welder. Understanding the parts and their functions will not only help users maintain the equipment but also facilitate repairs and troubleshooting when issues arise. In this comprehensive article, we will delve into the various components of the Hobart Handler 140, offering insights into their functions, maintenance tips, and how they fit into the overall welding process.

## Overview of the Hobart Handler 140

The Hobart Handler 140 is a versatile and user-friendly MIG welder designed for light to medium welding tasks. It is suitable for a variety of materials,

including mild steel, stainless steel, and aluminum. Its portability and ease of use make it a favorite among hobbyists and professionals alike.

## **Key Features of the Hobart Handler 140**

1. **Welding Capacity:** The Handler 140 can weld materials from 24 gauge up to 1/4 inch thick.
2. **Voltage:** It operates on standard 115V household current, making it accessible for most users.
3. **Wire Feed Speed:** The welder features an adjustable wire feed speed for optimal control.
4. **Built-in Gas Regulator:** This feature simplifies the use of gas shielding for MIG welding.
5. **Portability:** Weighing only 57 pounds, it is easy to move and transport.

## **Understanding the Parts Diagram**

The parts diagram of the Hobart Handler 140 provides a visual representation of all the components, making it easier for users to identify and understand each part's role.

## **Key Components of the Hobart Handler 140**

The following sections will break down the various components of the Hobart Handler 140, categorized by their function.

### **1. Power Supply Components**

- **Transformer:** Converts the incoming electrical voltage to a usable level for welding.
- **Rectifier:** Converts AC to DC, essential for MIG welding.
- **Control Panel:** Houses the settings for voltage and wire feed speed.
- **Power Cord:** Connects the welder to the power source.

### **2. Wire Feed System**

- **Wire Feed Motor:** Powers the feed mechanism that pushes the welding wire.
- **Drive Rollers:** Grip and propel the welding wire through the gun.
- **Wire Spool:** Holds the welding wire, ensuring a continuous supply during operation.
- **Contact Tip:** This part is where the welding wire exits and makes contact with the workpiece.

### **3. Cooling System**

- Fan: Circulates air to cool the internal components of the welder.
- Cooling Vents: Allow airflow and prevent overheating.

### **4. Welding Gun Assembly**

- Gun Handle: The ergonomic part of the gun that the welder holds.
- Nozzle: Directs the shielding gas and protects the contact tip.
- Trigger: Activates the wire feed and the electrical arc when pressed.

### **5. Safety Features**

- Thermal Overload Protection: Shuts down the machine if it overheats.
- Ground Clamp: Establishes a secure electrical connection to the workpiece for safety.

## **Parts Maintenance and Troubleshooting**

Proper maintenance of the Hobart Handler 140 is crucial for its longevity and performance. Here are some maintenance tips and common troubleshooting steps:

### **Routine Maintenance Tips**

1. Clean the Welding Gun: Regularly check and clean the nozzle and contact tip to prevent clogging.
2. Inspect Cables: Look for any signs of wear or damage on the power cord and gas hoses.
3. Check Drive Rollers: Ensure that the drive rollers are clean and properly adjusted to grip the welding wire without slipping.
4. Keep the Unit Dry: Store the welder in a dry place to prevent rust and corrosion.

### **Troubleshooting Common Issues**

- Problem: The Welder Won't Start
  - Solution: Check the power source, ensuring that it is plugged in and functioning.
- Problem: Uneven Welds
  - Solution: Adjust the wire feed speed and voltage settings; also check for correct gas flow.

- Problem: Wire Jamming
- Solution: Inspect the wire feed mechanism for obstructions and ensure that the wire spool is properly installed.
- Problem: Overheating
- Solution: Allow the welder to cool down and ensure that the cooling fan is operational.

## Where to Find the Parts Diagram

The parts diagram for the Hobart Handler 140 can typically be found in the owner's manual that comes with the welder. However, for those who may have misplaced the manual or require a digital copy, several resources are available:

- Hobart Official Website: The manufacturer often provides downloadable manuals and diagrams.
- Welding Supply Stores: Many suppliers that sell Hobart products also have parts diagrams available for customers.
- Online Forums and Communities: Websites like Reddit and welding forums may have user-shared diagrams and maintenance tips.

## Ordering Replacement Parts

When it comes to ordering replacement parts for the Hobart Handler 140, it is essential to ensure you are getting the correct components. Here are some steps to follow:

1. Identify the Part Needed: Use the parts diagram to locate the specific part number.
2. Check Availability: Visit the Hobart website or authorized dealers to check stock availability.
3. Consider OEM Parts: Opt for original equipment manufacturer (OEM) parts for the best compatibility and performance.
4. Compare Prices: Look at multiple suppliers to ensure you are getting the best deal.

## Final Thoughts

Understanding the Hobart Handler 140 parts diagram is crucial for any user looking to maintain or repair their MIG welder effectively. By familiarizing yourself with the various components, performing routine maintenance, and knowing how to troubleshoot common issues, you can ensure that your welding projects are completed efficiently and safely. With proper care, the Hobart

Handler 140 can be a reliable partner in your welding endeavors for years to come.

## **Frequently Asked Questions**

### **What is a Hobart Handler 140?**

The Hobart Handler 140 is a MIG (Metal Inert Gas) welder designed for home and light industrial use, known for its versatility and ease of use.

### **Where can I find a parts diagram for the Hobart Handler 140?**

A parts diagram for the Hobart Handler 140 can typically be found on the official Hobart website or through the user manual, which may be available for download.

### **What are the common parts listed in the Hobart Handler 140 parts diagram?**

Common parts include the welding gun, contact tips, gas nozzle, drive rolls, and the power cord, among other components.

### **How do I interpret the parts diagram for my Hobart Handler 140?**

The parts diagram usually includes labeled images that correspond to each part, along with part numbers which can help in ordering replacements.

### **Can I order replacement parts for the Hobart Handler 140 online?**

Yes, replacement parts for the Hobart Handler 140 can be purchased online through various retailers, including the official Hobart website and other welding supply stores.

### **What should I do if I can't find a specific part on the Hobart Handler 140 parts diagram?**

If a specific part is not listed, contact Hobart customer service for assistance or consult with a local welding supply store for potential alternatives.

### **Is there a community or forum for Hobart Handler 140**

## users?

Yes, there are several online forums and communities, such as welding forums on Reddit and dedicated welding websites, where users share tips and advice about the Hobart Handler 140.

## How often should I check the parts of my Hobart Handler 140?

It's a good practice to inspect the parts of your Hobart Handler 140 before each use and perform maintenance checks regularly to ensure optimal performance.

## Are there any modifications I can make to the Hobart Handler 140?

Some users modify the Hobart Handler 140 for better performance, such as upgrading the welding gun or adjusting the drive roll settings, but ensure any modifications are safe and compatible.

## What is the warranty on parts for the Hobart Handler 140?

Hobart typically offers a warranty on parts and equipment; check the user manual or the official website for specific warranty details related to the Handler 140.

Find other PDF article:

<https://soc.up.edu.ph/37-lead/Book?dataid=FtM13-3130&title=let-the-holy-spirit-guide.pdf>

## [Hobart Handler 140 Parts Diagram](#)

*Hobart Canada - Premier Foodservice Equipment*

Hobart Canada provides a complete line of equipment for the foodservice industry including baking, cooking, food machines, ...

### **Hobart - Wikipedia**

Founded in 1804 as a British penal colony, [17] Hobart is Australia's second-oldest capital city after Sydney, New South Wales. Whaling ...

*Premier Foodservice Equipment | Hobart*

Hobart's heavy duty slicers provide consistent and precision slicing – every single time. From your department manger to operations and ...

*Hobart - Must See Attractions & Things To Do*

Hobart is Tasmania's lively capital that retains an old town salty-air feel; where you can have early morning sand between your toes, ...

### **Travel Guide to Hobart, Tasmania - Tourism Australia**

5 days ago · Explore our guide to Hobart, Tasmania. Dine at the freshest restaurants and discover modern art, rich history and ...

### **Hobart Canada - Premier Foodservice Equipment**

Hobart Canada provides a complete line of equipment for the foodservice industry including baking, cooking, food machines, warewashers, refrigeration and ventilation.

#### *Hobart - Wikipedia*

Founded in 1804 as a British penal colony, [17] Hobart is Australia's second-oldest capital city after Sydney, New South Wales. Whaling quickly emerged as a major industry in the area, and for a time Hobart served as the Southern Ocean 's main whaling port.

### **Premier Foodservice Equipment | Hobart**

Hobart's heavy duty slicers provide consistent and precision slicing - every single time. From your department manager to operations and into the hands of your customer, Hobart's weigh wrap ...

#### Hobart - Must See Attractions & Things To Do

Hobart is Tasmania's lively capital that retains an old town salty-air feel; where you can have early morning sand between your toes, wander city streets, eat world class food, head to a mountain summit and be back in time for cocktails on the waterfront.

### **Travel Guide to Hobart, Tasmania - Tourism Australia**

5 days ago · Explore our guide to Hobart, Tasmania. Dine at the freshest restaurants and discover modern art, rich history and unsurpassed natural setting. Tasmania's capital has it all.

#### Home - Hobart City

Nestled on the stunning Derwent River, Hobart, the capital of Tasmania, is a city that charms with its blend of natural beauty and historic significance. It sits in the shadow of Mount Wellington, a majestic backdrop that adds to the city's picturesque landscape.

### **25 Best Things to Do in Hobart (Australia) - The Crazy Tourist**

Jan 23, 2022 · Many of Hobart's big attractions are right here, accompanied by cafes and art galleries. You won't have to search long for restaurant with ultra-fresh fish and seafood, from sushi to oysters to fish and chips.

#### Hobart - Wikitravel

Dec 12, 2024 · Founded in 1804 by Colonel David Collins, Hobart is the second oldest city in Australia. It grew out of the penal settlement on the island at Risdon Cove, eight kilometres up river, which was founded in 1803 and abandoned five months later for the present site of Hobart.

### **What to do in Hobart - Tasmania Explorer**

Explore Tasmania's capital, Hobart and surrounds with this comprehensive guide on what to do in Hobart, including top attractions, places to stay and more.

#### Service - Hobart Canada

If you require service over a broad geographic area, Hobart is your single point of contact. We coordinate the service calls for you through our national computer network.

Explore the Hobart Handler 140 parts diagram to identify components easily. Enhance your welding experience—learn more about maintenance and repairs today!

[Back to Home](#)