

Hibbeler Structural Analysis 6th Edition Solution

002.qxd 6/24/08 2:19 PM Page 11

© 2009 by R.C. Hibbeler. Published by Pearson Prentice Hall, Pearson Education, Inc., Upper Saddle River, NJ. All rights reserved. This material is protected under all copyright laws as they currently exist. No portion of this material may be reproduced, in any form or by any means, without permission in writing from the publisher.

2-1. The frame is used to support a wood deck (not shown) that is to be subjected to a uniform load of 130 lb/ft^2 . Sketch the loading that acts along members BG and $ABCD$. Take $b = 10 \text{ ft}$, $a = 5 \text{ ft}$.

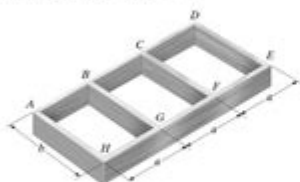

$$b/a = 10/5 = 2 > 1.5 \text{ (one-way slab)}$$

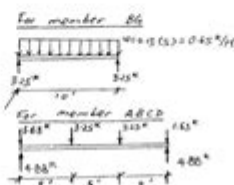
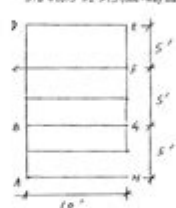

For BG , $w = 0.65 \text{ k/ft}$

Ans

For $ABCD$, reactions are 4.88 k

Ans

2-2. The roof deck of the single story building is subjected to a dead plus live load of 125 lb/ft^2 . If the purlins are spaced 4 ft and the bents are spaced 25 ft apart, determine the distributed loading that acts along the purlin DF , and the loadings that act on the bent at A , B , C , D , and E .



$$\frac{L_2}{L_1} = \frac{25}{4} = 6.25 > 2$$

One-way slab.

Tributary load along $DF = (125 \text{ lb/ft}^2)(4 \text{ ft}) = 500 \text{ lb/ft}$

Ans

This load is also transferred to the bent from the other side of AE . Half the tributary loading acts at A and E .

At A and E :

$$F = 6250 \text{ lb} = 6.25 \text{ k}$$

Ans

At B , C , D :

$$F = 2(6250) = 12500 \text{ lb} = 12.5 \text{ k}$$

Ans

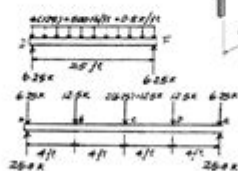

Hibbeler Structural Analysis 6th Edition Solution is a crucial resource for engineering students and professionals alike, providing in-depth knowledge and methodologies necessary for analyzing complex structures. This textbook, authored by Russell C. Hibbeler, is widely recognized for its comprehensive coverage of the fundamental principles of structural analysis. The 6th edition builds upon previous editions by incorporating new problems, updated examples, and innovative pedagogical tools that enhance the learning experience. In this article, we will explore the significance of Hibbeler's work, the core concepts of structural analysis, and the solutions provided in the textbook.

Understanding Structural Analysis

Structural analysis is a branch of civil engineering that focuses on determining the effects of loads on physical structures and their components. It involves calculating internal forces, moments, and displacements to ensure that structures can safely support the loads applied to them. Here are some essential aspects of structural analysis:

Key Concepts in Structural Analysis

1. **Load Types:** Understanding the different types of loads that structures may encounter is fundamental. These include:
 - **Dead Loads:** Permanent static forces acting on a structure, such as the weight of the structure itself.
 - **Live Loads:** Temporary dynamic forces, such as the weight of occupants or furniture.
 - **Environmental Loads:** Forces from natural events, including wind, snow, and seismic activity.
2. **Equilibrium:** Structural systems must satisfy the conditions of equilibrium. This means that the sum of forces and moments acting on a structure must equal zero.
3. **Support Reactions:** Supports are critical in structural systems, as they provide resistance to loads. Understanding how to calculate support reactions is essential for accurate analysis.
4. **Internal Forces:** Analyzing how external loads affect internal forces within members is crucial. This includes shear forces and bending moments.
5. **Displacement:** The deformation of structures under load is also a significant consideration. Understanding how structures deform helps in ensuring that they remain serviceable throughout their lifespan.

Importance of Hibbeler's Textbook

The "Hibbeler Structural Analysis 6th Edition" is particularly notable for several reasons:

Comprehensive Coverage

The textbook offers a thorough treatment of both classical and contemporary methods of structural analysis. It covers:

- Statically determinate structures
- Statically indeterminate structures
- Influence lines
- Energy methods
- Matrix methods of analysis

Each chapter builds upon the previous one, ensuring a logical progression of topics.

Problem-Solving Approach

Hibbeler emphasizes a problem-solving approach that encourages critical thinking and application of concepts. The book includes numerous example problems and exercises that challenge students to apply the principles learned.

Visual Aids and Illustrations

The use of diagrams, illustrations, and clear explanations enhances the understanding of complex concepts. Visual aids help students to visualize the behavior of structures under different loading conditions.

Solutions Manual: Hibbeler Structural Analysis 6th Edition

The solutions manual for the 6th edition of Hibbeler's Structural Analysis is a valuable companion for students. It provides step-by-step solutions to the problems presented in the textbook, facilitating comprehension and mastery of the subject matter.

Benefits of Using the Solutions Manual

1. **Clarification of Concepts:** Solutions manuals break down complex problems into manageable steps, making it easier for students to grasp difficult concepts.
2. **Self-Assessment:** Students can verify their answers against those in the solutions manual, helping them identify areas where they may need additional study.
3. **Diverse Problem Sets:** The manual includes a variety of problems, from basic to advanced, allowing students to progressively challenge themselves.
4. **Effective Study Tool:** The solutions manual can serve as an essential study aid during exam preparations, offering a resource for quick reference and review.

Using Hibbeler's Structural Analysis for Academic Success

To maximize the benefits of Hibbeler's Structural Analysis, students should consider the following strategies:

Active Learning Techniques

1. **Practice Regularly:** Consistent practice is key in mastering structural analysis. Work through problems daily to reinforce learning.
2. **Study Groups:** Collaborating with peers can enhance understanding as different perspectives can clarify challenging concepts.
3. **Seek Help When Needed:** Don't hesitate to consult instructors or utilize online forums when facing difficulties. Engaging with the material actively can provide deeper insights.
4. **Utilize Additional Resources:** Supplement the textbook with other resources, such as online lectures, video tutorials, and additional textbooks, to gain varied perspectives on the subject matter.

Real-World Applications

Understanding the principles of structural analysis is essential for future engineers, as it has direct applications in various fields, such as:

- **Building Design:** Ensuring that buildings can withstand various loads and environmental conditions.
- **Bridges and Infrastructure:** Analyzing and designing bridges and other critical infrastructure to ensure safety and reliability.
- **Industrial Structures:** Designing structures that support heavy equipment and processes in manufacturing.

Conclusion

Hibbeler's Structural Analysis 6th Edition and its accompanying solutions manual are invaluable tools for students and professionals in the field of civil engineering. By providing a solid foundation in the principles of structural analysis, the textbook equips learners with the knowledge and skills necessary to tackle real-world engineering challenges. Emphasizing a problem-solving approach, comprehensive coverage, and effective learning strategies, Hibbeler's work remains a cornerstone in engineering education. Whether for coursework or professional reference, the insights gained from this textbook are essential for anyone involved in the analysis and design of structures.

Frequently Asked Questions

What is the primary focus of Hibbeler's 'Structural Analysis' 6th edition?

The primary focus is on the methods of analyzing structures such as beams, trusses, and frames, emphasizing both classical and modern techniques.

Where can I find solutions for the problems in Hibbeler's 'Structural Analysis' 6th edition?

Solutions can be found in official solution manuals, online educational platforms, or study groups dedicated to structural engineering.

Are the solutions in Hibbeler's 6th edition comprehensive?

Yes, the solutions are designed to be comprehensive, providing step-by-step explanations for various types of structural analysis problems.

Is Hibbeler's 'Structural Analysis' 6th edition suitable for beginners?

Yes, the book is structured to gradually introduce concepts, making it suitable for students new to structural analysis.

How does the 6th edition of Hibbeler's 'Structural Analysis' improve upon previous editions?

The 6th edition includes updated examples, clearer explanations, and new problem sets to enhance understanding and application of structural analysis.

What software tools are recommended alongside Hibbeler's 'Structural Analysis' 6th edition?

Software tools like SAP2000, ANSYS, and RISA are commonly recommended for practical applications of structural analysis concepts.

Can I use Hibbeler's 'Structural Analysis' 6th edition for exam preparation?

Yes, it includes numerous practice problems and examples that are beneficial for exam preparation in structural engineering courses.

Are there any online resources or forums discussing Hibbeler's 'Structural Analysis' 6th edition solutions?

Yes, platforms like Chegg, Reddit, and various engineering forums have discussions and resources related to Hibbeler's solutions.

What level of mathematics is required to understand Hibbeler's 'Structural Analysis' 6th edition?

A solid understanding of calculus, linear algebra, and differential equations is essential to fully grasp the concepts presented in the book.

Find other PDF article:

<https://soc.up.edu.ph/39-point/files?dataid=nCE51-6906&title=map-labeling-spanish-speaking-capitals-answer-key.pdf>

Hibbeler Structural Analysis 6th Edition Solution

Cómo establecer la hora, la fecha y la zona horaria

Cómo cambiar la configuración del temporizador Abre la app Reloj del dispositivo . Presiona Más Configuración. En "Temporizadores", podrás hacer lo siguiente: Elegir el tono que suena ...

timer - Crear temporizador en C# - Stack Overflow en español

Estoy creando un programa en C# que me ayude a recordar cuando tomar mis medicinas. Para ello me pregunta si he tomado la pastilla y si es sí reinicial el programa 48 horas después. De ...

Poner y gestionar temporizadores y temporizadores de ...

Poner un temporizador general El sonido de alerta del temporizador solo se reproducirá en el altavoz o la pantalla que hayas usado para configurarlo. Puedes poner, gestionar y eliminar ...

Limita el tiempo de uso en YouTube Kids - Google Help

Limita el tiempo de uso en YouTube Kids Nuestro temporizador incorporado les permite a las madres y los padres limitar el tiempo de uso avisándoles a los niños cuando deben dejar de ...

Temporizador para cada palestrante - Microsoft Community

Como eu gerencio as reuniões, o meu gestor sempre fala para cronometrar o tempo do palestrante. Na ferramenta do teams existe esse recurso de cronometrar o tempo que o ...

Administra el tiempo que usas tu teléfono Android con Bienestar ...

Importante: Es posible que algunas cuentas de trabajo o instituciones educativas no funcionen con el temporizador de aplicaciones. Junto a la app que quieres limitar, presiona Establecer ...

El temporizador de foco solo sonará cuando el equipo esté activo ...

Hola, hoy estuve teniendo problemas con las sesiones de concentración, cuando le doy a la opción de iniciar una sesión, en la parte de abajo me sale "el temporizador de foco solo ...

Puedo poner temporizador en los formularios para exámenes y ...

Puedo poner temporizador en los formularios para exámenes y que se envíen automáticamente al acabar? - Comunidad de Editores de Documentos de Google Centro de asistencia ...

Cómo pongo un temporizador en una celda? - Google Help

Jun 29, 2019 · Yo en lo personal veo poco práctico tu solicitud, sobre todo por que quieres un temporizador que se actualice segundo a segundo y mas sobre las celdas, recordemos que el ...

Cómo establecer y administrar temporizadores generales y de ...

Establecer un temporizador general El sonido de alerta del temporizador solo se reproducirá en la bocina o pantalla que usaste para establecerlo. Puedes establecer, administrar y borrar ...

[US] Test your smarts [01-07-22] : r/MicrosoftRewards - Reddit

Jan 7, 2022 · AmySueF [US] Test your smarts [01-07-22] Quiz and Answers News this week quiz answers Pittsburgh 119 Little Caesars Hot and Ready Pizza Is also a solar panel 21 Dogs ...

BingHomepageQuiz - Reddit

Microsoft Bing Homepage daily quiz questions and their answers

[US] 30 Point Quiz Replaced With 10 Point Single Click - Reddit

Logged on to do my dailies only to find the normal 30 point quiz has been replaced with a 10 point single click option. Checked the one for tomorrow and it's the same way. It's showing this on ...

[US] Microsoft Rewards Bing - Supersonic Quiz - Reddit

Mar 21, 2023 · Posted by u/Phillip228 - 10 votes and 3 comments

+100 points daily - Read and You Shall Be Rewarded - Reddit

Jan 20, 2022 · Summary: 100 points daily for clicking on 10 news articles in the Edge browser on your computer. On the New Tab page, make sure you have it set to Informational (settings ...

Quiz Answers for today : r/MicrosoftRewards - Reddit

Aug 29, 2019 · Quiz Answers for today Which of these is searched more on Bing? The correct answer is highlighted in BOLD 2019 NFL Draft or Fortnite Chicago or California Empire State ...

New Year new you - Monthly punch card & Quiz for January 2022 ...

New Year new you - Monthly punch card & Quiz for January 2022 +150 MR points Punch Card Reward: 50 MR points for completing the punch card. 100 MR points for completing the quiz. ...

[US] Bing Weekly News Quiz (12-17-2021) : r/MicrosoftRewards

Dec 17, 2021 · This week marked the one-year anniversary of the COVID-19 vaccine rollout. Which vaccine became available first? Answer: A) Pfizer-BioNTech Elon Musk announced ...

Bing News Quiz (2-24-2023) : r/MicrosoftRewards - Reddit

Feb 24, 2023 · trueHere's all the answers. I binged them manually which also helped with points, lol. Hopefully it will someone some time from having to manually search. Enjoy! What's ...

Microsoft Bing - Reddit

A subreddit for news, tips, and discussions about Microsoft Bing. Please only submit content that is helpful for others to better use and understand Bing services. Not actively monitored by ...

Unlock the secrets of Hibbeler's Structural Analysis 6th Edition with our comprehensive solutions. Learn more to master your understanding and ace your coursework!

[Back to Home](#)