

Graber Motorized Shades Manual

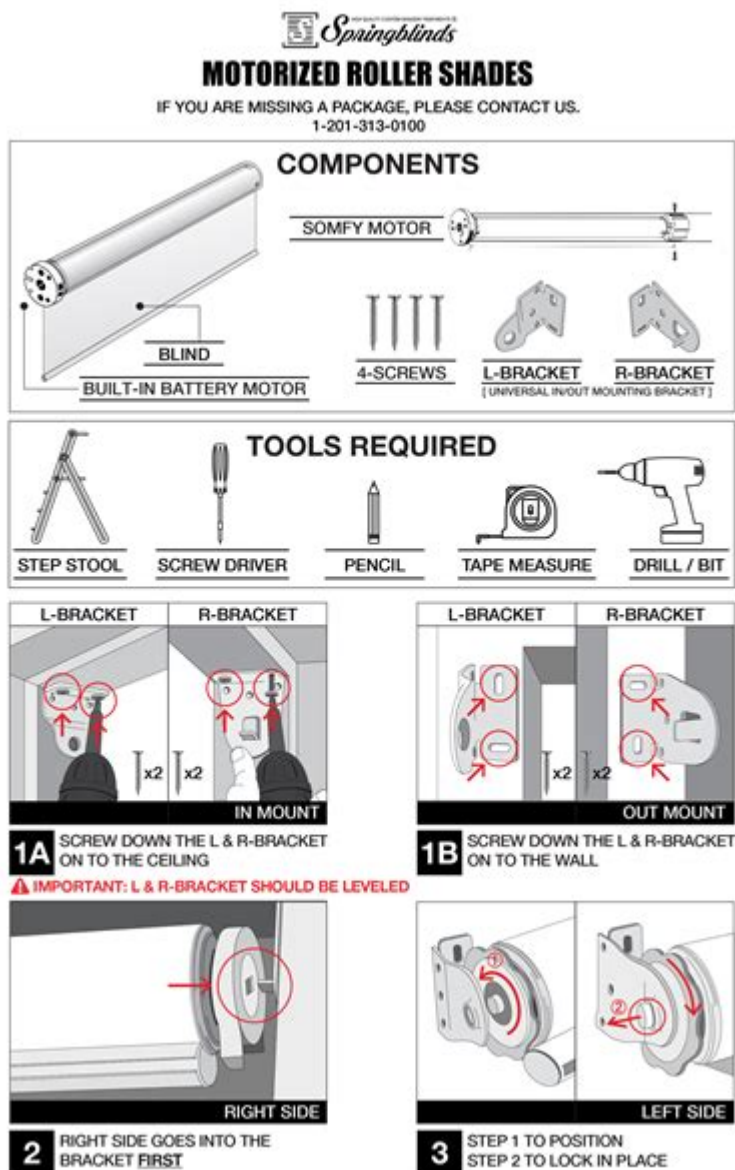

Graber motorized shades manual is an essential guide for anyone looking to enhance their home's comfort and aesthetics. Graber, a well-respected name in the window treatment industry, offers a variety of motorized shades that provide convenience, style, and functionality. This article delves into the features, installation process, operation, maintenance, and troubleshooting of Graber motorized shades, ensuring you have all the information needed to enjoy your new window treatments.

Understanding Graber Motorized Shades

Graber motorized shades are designed to offer the perfect blend of elegance and technology. These shades can be controlled with the touch of a button or through a mobile app, allowing users to adjust their window treatments without the need for manual labor. Below are some of the key features that

make Graber motorized shades a popular choice among homeowners:

Features of Graber Motorized Shades

- **Convenience:** The ability to operate shades remotely or through automated schedules enhances comfort.
- **Energy Efficiency:** These shades can help reduce energy bills by regulating sunlight and heat entering your home.
- **Customization:** Graber offers a wide range of materials, colors, and styles, allowing for personalized aesthetics.
- **Smart Home Integration:** Many Graber motorized shades can be integrated with smart home systems, such as Google Assistant and Amazon Alexa.
- **Quiet Operation:** The motorized mechanism operates quietly, ensuring no disturbance when adjusting the shades.

Installation of Graber Motorized Shades

Installing Graber motorized shades can be a straightforward process if you follow the instructions carefully. The installation process can vary slightly based on the type of shades you choose, but here is a general guide to help you through the setup.

Tools and Materials Required

Before starting the installation, gather the following tools and materials:

- Drill with appropriate drill bits
- Level
- Measuring tape
- Screwdriver
- Pencil
- Ladder (if installing on high windows)
- Graber motorized shades kit (including brackets and screws)

Step-by-Step Installation Process

1. **Measure Your Windows:**
 - Measure the width and height of your window to determine the size of shades you need. Ensure to account for any obstructions such as handles or locks.
2. **Select Mounting Type:**
 - Decide whether you'll mount the shades inside the window frame (inside mount) or outside the frame (outside mount).
3. **Mark Bracket Placement:**

- Use a pencil to mark where the brackets will be installed. Ensure they are level and at the right height.

4. Install the Brackets:

- Use a drill to attach the brackets securely to the wall or window frame using the provided screws.

5. Attach the Shade:

- Lift the motorized shade into the installed brackets and ensure it is secure.

6. Connect Power Supply:

- Plug in the power supply and ensure any wiring is neatly tucked away. If your model uses batteries, insert the batteries as directed.

7. Test the Operation:

- Use the remote control or app to test the shades. Ensure they open and close smoothly without any obstructions.

Operating Graber Motorized Shades

Once installed, operating your Graber motorized shades is simple and intuitive. Here are the main methods of control:

Remote Control

Graber motorized shades typically come with a remote control that allows you to:

- Open and close the shades with a single button press.
- Set specific positions for your shades (e.g., halfway open).
- Group multiple shades to operate simultaneously.

Mobile App Control

For those who prefer smart technology, the Graber app allows you to control your shades remotely from your smartphone. You can:

- Program schedules to open and close shades at specific times.
- Integrate with voice control systems like Amazon Alexa or Google Assistant.
- Control shades from anywhere, even when you are not at home.

Maintaining Graber Motorized Shades

Proper maintenance of your Graber motorized shades will ensure they remain in excellent condition for years to come. Here are some tips for maintaining your shades:

Regular Cleaning

- Use a soft, dry cloth to dust the shades regularly.
- For stains, use a damp cloth and mild detergent. Avoid harsh chemicals that may damage the fabric.
- If your shades are made of a material that can be vacuumed, use a soft brush attachment to gently remove dust.

Check Mechanisms and Components

- Periodically check the motor and remote control for any signs of wear or malfunction.
- Ensure that the brackets are securely fastened and that the shades move smoothly.

Battery Maintenance

- If your shades use batteries, check the battery level regularly and replace batteries as needed to avoid any interruption in operation.

Troubleshooting Common Issues

While Graber motorized shades are designed for reliability, you may encounter some common issues. Here are troubleshooting tips for resolving these problems:

Shade Won't Move

- **Check Power Source:** Ensure that the power supply is connected and that the batteries are charged.
- **Remote Control Issues:** Replace the remote control batteries and ensure you are within range of the shades.

Irregular Movement or Jamming

- **Obstructions:** Check for any physical obstructions that may be blocking the shades from moving.
- **Alignment:** Ensure the shades are properly aligned in the brackets for smooth operation.

Connectivity Problems with Smart Devices

- **Reboot Devices:** Restart your smart device and the Graber app.
- **Check Wi-Fi Connection:** Make sure your Wi-Fi network is working and that the shades are within range.

Conclusion

Graber motorized shades are an excellent investment for modern homes, providing convenience, style, and energy efficiency. By following the guidelines outlined in this **Graber motorized shades manual**, you can successfully install, operate, maintain, and troubleshoot your shades with ease. Enjoy the comfort and sophistication these window treatments bring to your living space!

Frequently Asked Questions

How do I manually operate Graber motorized shades in case of a power outage?

To manually operate Graber motorized shades during a power outage, locate the manual override feature, usually found on the motor. This may involve using a cord or a button on the motor itself to lower or raise the shades manually.

Where can I find the manual for my Graber motorized shades?

You can find the manual for your Graber motorized shades on the official Graber website under the 'Support' or 'Product Manuals' section. You may also contact customer service for assistance in locating the specific manual for your model.

What should I do if my Graber motorized shades are not responding to the remote?

If your Graber motorized shades aren't responding to the remote, check the battery in the remote, ensure that the shades are within range of the remote, and verify that there are no obstructions. If issues persist, try resetting the shades according to the manual's troubleshooting section.

Can I program my Graber motorized shades to operate on a schedule?

Yes, you can program your Graber motorized shades to operate on a schedule using the compatible app or remote control that comes with the shades. Refer to the manual for detailed instructions on setting up schedules.

What is the best way to clean my Graber motorized shades?

To clean your Graber motorized shades, use a soft, dry cloth or a vacuum with a brush attachment to remove dust. For stains, refer to the manual for specific cleaning solutions recommended for the fabric type.

Find other PDF article:

<https://soc.up.edu.ph/41-buzz/pdf?ID=vmT77-8285&title=microsoft-risk-assessment-template.pdf>

[Graber Motorized Shades Manual](#)

[Carlos Baleba - Spielerprofil 25/26 | Transfermarkt](#)

Carlos Baleba, 21, aus Kamerun Brighton & Hove Albion, seit 2023 Defensives Mittelfeld Marktwert: 40,00 Mio. € * 03.01.2004 in Douala, Kamerun

Carlos Baleba Statistiken und Bewertungen | Sofascore

Wenn Carlos Baleba spielt, können Sie auch seine Sofascore-Bewertung, Statistiken und Heatmap live verfolgen. Das Fußballspielerprofil von Carlos Baleba zeigt alle Spiele und ...

Football Statistics | Football Live Scores | WhoScored.com

Carlos Baleba statistics - check out his latest detailed stats including goals, assists, strengths & weaknesses and match ratings.

Carlos Baleba | Laufbahn | Spielerprofil - kicker

Jan 3, 2004 · Laufbahn © imago images 20 Carlos Baleba Position: Mittelfeld Geboren: 03.01.2004 (21) Nation:

Carlos Baleba stats and ratings | Sofascore

Carlos Baleba football player profile displays all matches and competitions with statistics for all the matches Carlos Baleba played in. Most important stats for each competition, including average ...

Carlos Baleba - Leistungsdaten 24/25 | Transfermarkt

Jan 3, 2004 · Diese Seite enthält eine Statistik über die detaillierten Leistungsdaten eines Spielers. In der Info-Box kann ausgewählt werden, auf welchen Zeitraum, welchen Verein, ...

[Carlos Baleba \(Brighton & Hove Albion\) Statistiken - Spielerprofil ...](#)

Zeige das Spielerprofil von Carlos Baleba (Brighton & Hove Albion) auf Flashscore.de. Karriere (Spiele, Tore, Karten) und die Transferhistorie.

Carlos Baleba - Wikipedia

Baleba made his debut for the Cameroon national team on 8 June 2024 in a World Cup qualifier 4-1 victory against Cape Verde at the Ahmadou Ahidjo Stadium. He started the game and ...

Carlos Baleba - Player profile 25/26 | Transfermarkt

Jan 3, 2004 · Carlos Baleba, 21, from Cameroon Brighton & Hove Albion, since 2023 Defensive Midfield Market value: €40.00m * Jan 3, 2004 in Douala, Cameroon

[Carlos Baleba - Career stats | Transfermarkt](#)

Jan 3, 2004 · In the info box, you can filter by period, club, type of league and competition. The "Detailed stats" tab shows a player's total appearances, goals, cards and cumulative minutes ...

QUERY function - Google Docs Editors Help

QUERY(A2:E6,F2,FALSE) Syntax QUERY(data, query, [headers]) data - The range of cells to perform the query on. Each column of data can only hold boolean, numeric (including ...

Función QUERY - Ayuda de Editores de Documentos de Google

Función QUERY Ejecuta una consulta sobre los datos con el lenguaje de consultas de la API de visualización de Google. Ejemplo de uso QUERY(A2:E6,"select avg(A) pivot B") ...

QUERY - Справка - Редакторы Google Документов

Выполняет запросы на базе языка запросов API визуализации Google. Пример использования QUERY (A2:E6; "select avg (A) pivot B") QUERY (A2:E6; F2; ЛОЖЬ) ...

[video] [GOOGLE SHEETS] FUNCIÓN QUERY: FUNCIONES DE ...

Ver en [GOOGLE SHEETS] FUNCIÓN QUERY: FUNCIONES DE AGREGACIÓN: SUM, AVG, COUNT, MIN y MAX 652 visualizaciones 4 votos a favor

QUERY - Google

QUERY Google Visualization API QUERY(A2:E6,"select avg(A) pivot B") QUERY(A2:E6,F2,FALSE) ...

Set default search engine and site search shortcuts

Set your default search engine On your computer, open Chrome. At the top right, select More Settings. Select Search engine. Next to "Search engine used in the address bar," select the ...

Search by latitude & longitude in Google Maps

On your computer, open Google Maps. On the map, right-click the place or area. A pop-up window appears. At the top, you can find your latitude and longitude in decimal format. To ...

BigQuery - Google Cloud Platform Console Help

Use datasets to organize and control access to tables, and construct jobs for BigQuery to execute (load, export, query, or copy data). Find BigQuery in the left side menu of the Google Cloud ...

[GOOGLE SHEETS] FUNCIÓN QUERY: USO DE LA CLÁUSULA SELECT

[GOOGLE SHEETS] FUNCIÓN QUERY: USO DE LA CLÁUSULA SELECT Compartir Si la reproducción no empieza en breve, prueba a reiniciar el dispositivo. Los vídeos que veas ...

Fonction QUERY - Aide Éditeurs Google Docs

Fonction QUERY Exécute sur toutes les données une requête écrite dans le langage de requête de l'API Google Visualization. Exemple d'utilisation QUERY(A2:E6,"select avg(A) pivot B") ...

"Discover how to effectively use your Graber motorized shades manual for optimal setup and maintenance. Learn more about enhancing your home's comfort today!"

[Back to Home](#)