

# Ge Profile Gas Stove Manual

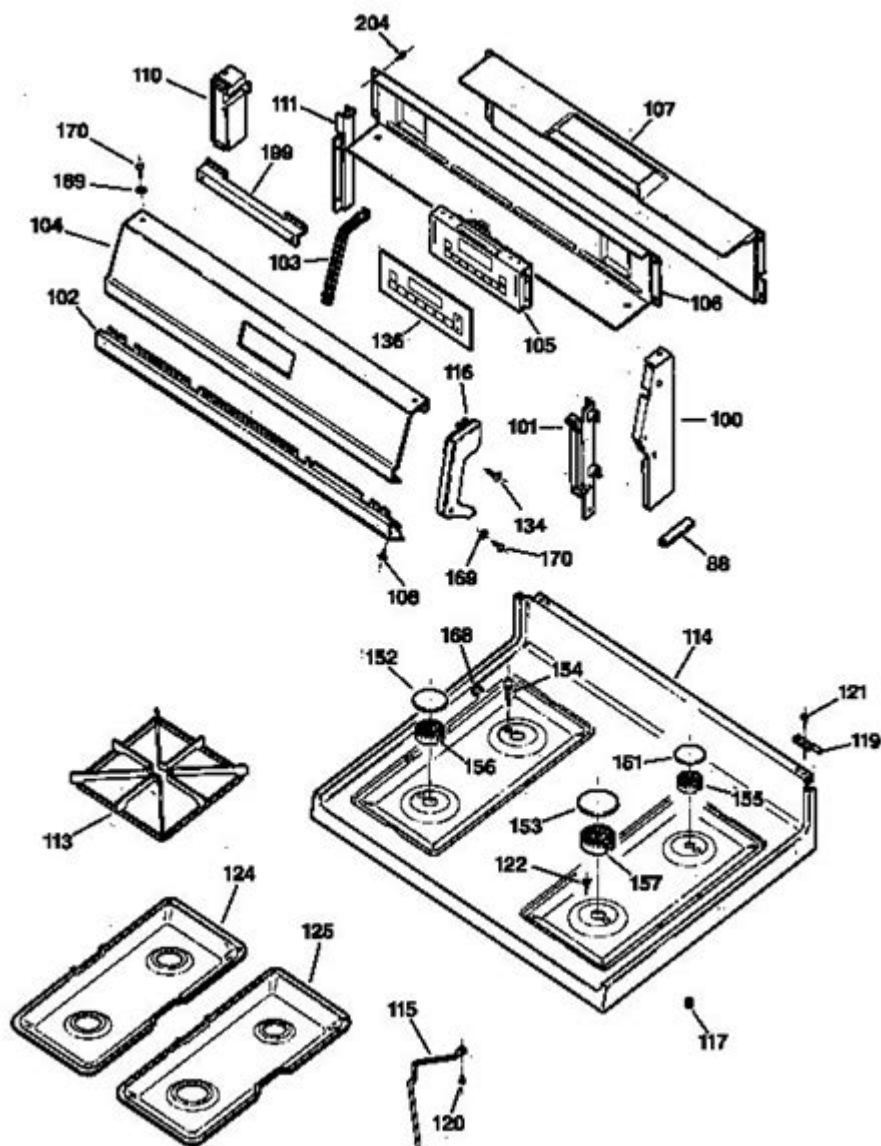

**GE Profile Gas Stove Manual** is an essential guide for anyone who owns or plans to purchase a GE Profile gas stove. Understanding how to operate, maintain, and troubleshoot your appliance can significantly enhance your cooking experience and extend the lifespan of the stove. In this article, we will explore the features of GE Profile gas stoves, provide a detailed overview of the manual, and offer tips for maintenance and troubleshooting.

## Overview of GE Profile Gas Stoves

GE Profile gas stoves are known for their innovative technology, stylish designs, and efficiency. These appliances cater to the needs of modern home cooks, combining functionality with aesthetic appeal. Some of the key features include:

## Key Features

- Precision Cooking: Advanced burner technology offers precise temperature control for a variety of cooking methods.
- Self-Cleaning Ovens: Many models come equipped with self-cleaning features that make maintenance easier.
- Smart Technology: Certain models integrate with smart home systems, allowing users to control their stove remotely.
- Sleek Design: The contemporary design of GE Profile gas stoves complements any kitchen décor.
- Multiple Cooking Modes: Features such as convection cooking, broiling, and baking provide versatility in meal preparation.

## Understanding Your GE Profile Gas Stove Manual

The GE Profile gas stove manual is a comprehensive document that provides essential information for operating and maintaining your stove. It typically includes the following sections:

### 1. Safety Information

Safety is paramount when using gas appliances. The manual includes important safety instructions to prevent accidents and ensure safe operation. Key points include:

- Ensure adequate ventilation in the kitchen.
- Regularly check for gas leaks.
- Avoid using the stove for heating purposes.
- Keep flammable materials away from the stove.

### 2. Installation Instructions

Proper installation is crucial for optimal performance. The manual provides step-by-step instructions for installing your GE Profile gas stove, including:

- Required tools and materials.
- Guidelines for connecting the gas supply.
- Electrical requirements if applicable.
- Clearances needed around the stove.

### 3. Operating Instructions

This section details how to operate your stove effectively. Key topics include:

- Igniting the Burners: Instructions on how to light the burners manually or with an automatic igniter.

- Using the Oven: Guidelines for setting temperatures, using different cooking modes, and timers.
- Cleaning the Stove: Recommendations for cleaning different parts of the stove without causing damage.

## **4. Maintenance and Care**

Regular maintenance ensures your gas stove operates efficiently. The manual typically includes:

- Routine cleaning schedules for burners, grates, and oven interiors.
- Tips for checking and replacing parts, like igniters or thermostats.
- Instructions for winterizing or preparing the stove for long periods of non-use.

## **5. Troubleshooting Guide**

Even with the best appliances, issues may arise. The troubleshooting section of the manual provides solutions for common problems, such as:

- Burner Won't Ignite: Check the igniter, gas supply, and clean the burner.
- Uneven Cooking: Ensure the oven is level and check the heating elements.
- Error Codes: Interpret error codes displayed on electronic models and steps to reset.

## **Tips for Efficient Use of Your GE Profile Gas Stove**

Maximizing the efficiency of your GE Profile gas stove can improve cooking performance and save energy. Here are some tips:

### **1. Use the Right Cookware**

- Flat-bottomed pans: Ensure even heat distribution.
- Size matters: Match the pan size to the burner size for efficient cooking.
- Material: Use materials that retain heat well, such as cast iron or stainless steel.

### **2. Preheat the Oven**

- Preheating ensures that food cooks evenly and at the right temperature.
- Be mindful of cooking times if using convection settings, as they can cook food faster.

### **3. Keep it Clean**

- Regularly clean spills and splatters to prevent buildup.
- Use appropriate cleaning agents to avoid damaging the stove's finish.

## **4. Monitor Cooking Times**

- Keep an eye on cooking progress, especially when using high heat settings.
- Use timers to prevent food from burning or overcooking.

## **5. Practice Safe Cooking**

- Always ensure the stove is turned off after use.
- Never leave the stove unattended while in use.
- Be cautious with hot surfaces and cookware.

## **Frequently Asked Questions (FAQs)**

### **1. How do I know if my gas stove is leaking gas?**

If you smell gas or hear a hissing sound, turn off the gas supply immediately and ventilate the area. Do not use flames or electrical devices and call your gas company.

### **2. Can I use aluminum foil in the oven?**

Yes, you can use aluminum foil in the oven, but avoid covering vents and heating elements to prevent fire hazards.

### **3. What should I do if the oven is not heating properly?**

Check the gas supply and ensure the oven settings are correct. If the problem persists, consult the troubleshooting section of the manual or contact customer service.

### **4. How often should I clean my stove?**

It's advisable to clean your stove after each use to prevent buildup. A deep clean is recommended at least once a month.

## **5. Is it safe to use my GE Profile gas stove during a power outage?**

Yes, you can use the gas burners during a power outage as long as the gas supply is secure and the igniter can be manually lit.

## **Conclusion**

Understanding the GE Profile gas stove manual is crucial for ensuring safe and efficient operation of your appliance. By familiarizing yourself with the features, safety precautions, operating instructions, and maintenance tips, you can enhance your cooking experience and prolong the life of your gas stove. Whether you are a novice or an experienced cook, mastering your appliance will help you prepare delicious meals with ease. Always refer to your specific model's manual for detailed information and guidance tailored to your stove.

## **Frequently Asked Questions**

### **Where can I find the GE Profile gas stove manual online?**

You can find the GE Profile gas stove manual on the official GE Appliances website under the 'Support' section, where you can search for your specific model.

### **What should I do if I lost my GE Profile gas stove manual?**

If you lost your manual, you can download a digital version from the GE Appliances website by entering your stove's model number.

### **How do I troubleshoot my GE Profile gas stove if it won't ignite?**

First, check that the gas supply is turned on and the stove is properly plugged in. If it still won't ignite, consult the troubleshooting section of your manual for specific steps.

### **What maintenance tips are recommended in the GE Profile gas stove manual?**

The manual typically recommends regular cleaning of burners and grates, checking for gas leaks, and ensuring proper ventilation for safety.

### **How can I adjust the flame on my GE Profile gas stove?**

To adjust the flame, refer to the manual's instructions on the burner adjustment screw, usually located under the burner cap.

## Is there a warranty for my GE Profile gas stove mentioned in the manual?

Yes, the manual usually outlines the warranty details, including coverage duration and what is included.

## What features are highlighted in the GE Profile gas stove manual?

Common features highlighted include self-cleaning options, smart technology integration, various cooking modes, and safety features.

### Can I download the GE Profile gas stove manual for offline use?

Yes, you can download the manual as a PDF from the GE Appliances website for offline access.

## What common errors are listed in the GE Profile gas stove manual?

Common errors may include ignition failures, uneven cooking, and error codes displayed on digital models, along with troubleshooting steps.

## How do I properly clean my GE Profile gas stove according to the manual?

The manual provides specific cleaning instructions, usually recommending non-abrasive cleaners, soft cloths, and periodic deep cleaning for optimal performance.

Find other PDF article:

<https://soc.up.edu.ph/63-zoom/Book?docid=wvl80-4074&title=tropique-de-la-violence.pdf>

# Ge Profile Gas Stove Manual

## Download and install Google Chrome

How to install Chrome Important: Before you download, you can check if Chrome supports your operating ...

□□□□□□□□□? - □□

16 ...

GE Online [R 1000 - 1000](#)

GE Online R

**Under review** **Awaiting Recommendation** ...

under review under review under review ...

**edge** -

edge win10 ...

## Download and install Google Chrome

How to install Chrome Important: Before you download, you can check if Chrome supports your operating ...

? -

16 ...

**GE Online** **R** -

GE Online R

**Under review** **Awaiting Recommendation** ...

under review under review ...

**edge** -

edge win10 ...

Find the complete GE Profile gas stove manual here! Discover how to operate

[Back to Home](#)