

Ge Profile Refrigerator Water Line Diagram

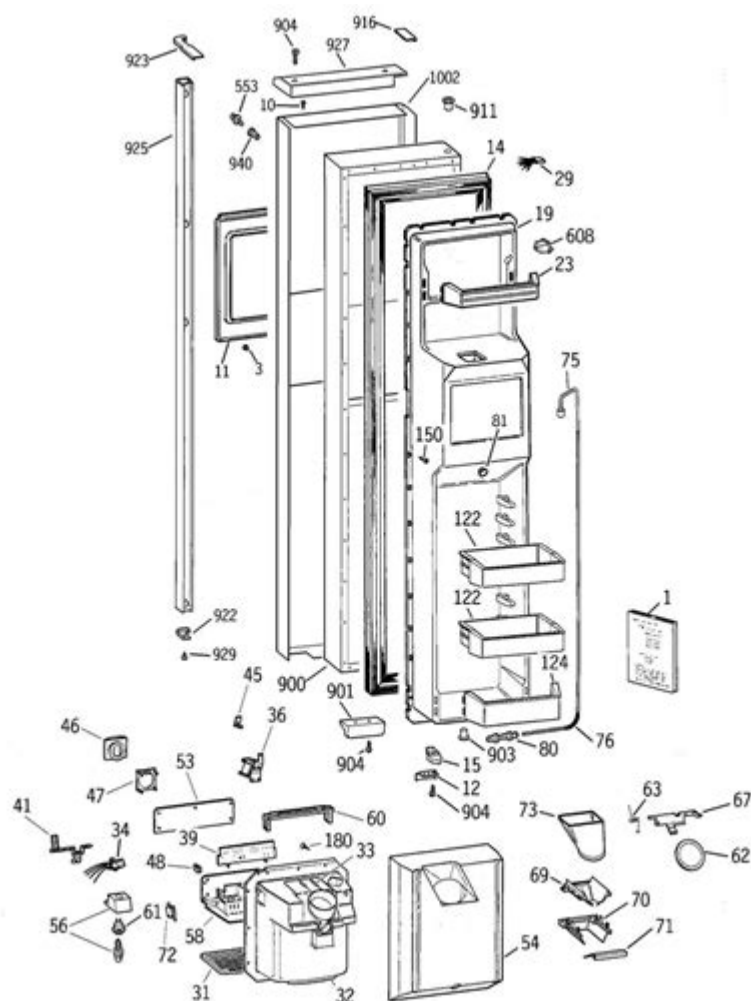

GE profile refrigerator water line diagram is a crucial aspect for any homeowner who wishes to understand their refrigerator's water supply system. An efficient refrigerator does not only keep food and beverages cold but also provides fresh water and ice, a feature that is particularly appreciated in modern kitchens. Understanding the water line diagram can help troubleshoot issues, perform maintenance, and ensure the system operates efficiently. This article will explore the components of the GE profile refrigerator water line system, how it works, common issues, and maintenance practices.

Overview of the GE Profile Refrigerator Water System

The water line system in a GE Profile refrigerator is designed to supply water to both the ice maker and the water dispenser. The system consists of various components that work together to ensure a steady flow of water.

Key Components

1. **Water Supply Line:** This is the primary line that connects your refrigerator to the water source, typically your home's plumbing system.
2. **Water Filter:** Most GE Profile refrigerators come equipped with an internal water filter that removes impurities from the water before it reaches the dispenser and ice maker.
3. **Water Reservoir:** This component holds a small amount of water, which is cooled and dispensed as needed.
4. **Ice Maker:** The ice maker relies on the water supply to produce ice cubes. It has its own set of components to manage the freezing and dispensing of ice.
5. **Control Valves:** These valves regulate the flow of water to different components, ensuring that the refrigerator operates efficiently.
6. **Dispensing Mechanism:** This is the system that allows users to access water directly from the refrigerator.

Understanding the Water Line Diagram

A water line diagram is a visual representation of how water flows from the supply line to the various components of the refrigerator. Understanding this diagram can be beneficial for troubleshooting and repairs.

Reading the Diagram

1. **Identify the Water Source:** The diagram typically starts with the water supply line connected to your home's plumbing.
2. **Trace the Flow:** Follow the path of the water as it moves through the filter, reservoir, and into the ice maker and water dispenser.
3. **Note the Connections:** Pay attention to the connections between components, as leaks or blockages can often occur at these junctions.
4. **Control Mechanisms:** Look for any control valves or solenoids that regulate water flow, as these are critical for proper functioning.

How the Water Supply System Works

Understanding how the water supply system works can help you appreciate the complexity of your refrigerator's design.

Water Flow Process

1. **Water Inlet:** The process begins when water enters the refrigerator through the water supply line.
2. **Filtration:** As water flows into the refrigerator, it passes through the water filter, which removes contaminants and improves taste.

3. **Reservoir Cooling:** The filtered water moves to the reservoir, where it is chilled for immediate dispensing.
4. **Ice Production:** Simultaneously, water is routed to the ice maker, where it is frozen into ice cubes.
5. **Dispensing:** When you press the water dispenser lever, the control valve opens, allowing cold water to flow from the reservoir and out through the dispenser.

Common Issues with the Water Line System

Understanding potential problems that can arise with your GE Profile refrigerator's water line system will help you maintain it effectively.

Common Problems

1. **No Water Supply:** This can occur due to a clogged water filter, frozen water line, or a closed shut-off valve.
2. **Low Water Pressure:** Insufficient water pressure may lead to slow filling of the ice maker or water dispenser.
3. **Water Leaks:** Leaks can happen at any connection point, leading to water pooling under the refrigerator.
4. **Ice Maker Issues:** Problems in the ice maker can stem from a malfunctioning control valve or a clogged water line.
5. **Dispenser Malfunctions:** If the water dispenser is not working, it could be due to a faulty switch or a blockage in the water line.

Troubleshooting Steps

1. **Check the Water Supply:** Ensure that the water supply line is connected securely and that the shut-off valve is open.
2. **Inspect the Water Filter:** Replace the water filter if it is clogged or has exceeded its lifespan, typically every six months.
3. **Examine for Leaks:** Look for any signs of water pooling under the refrigerator or around the connections.
4. **Test the Ice Maker:** If the ice maker is not producing ice, check if it is receiving water and that the control arm is in the correct position.
5. **Check the Dispenser Mechanism:** Make sure the lever is functioning properly and that there are no obstructions in the water line.

Maintenance Practices for the Water Line System

Regular maintenance is essential to ensure the longevity and efficiency of your refrigerator's water line system.

Recommended Maintenance Steps

1. **Regular Filter Replacement:** Change the water filter every six months or as recommended by the manufacturer to ensure clean water.
2. **Inspect the Water Line:** Regularly check the water line for signs of wear, cracks, or kinks that could impede water flow.
3. **Clean the Dispenser:** Periodically clean the water dispenser to prevent mold and bacteria buildup.
4. **Monitor Temperatures:** Keep an eye on the temperatures of your refrigerator and freezer to ensure they are within the ideal range.
5. **Professional Maintenance:** Consider scheduling annual maintenance with a professional technician to inspect and service the entire system.

Conclusion

Understanding the GE profile refrigerator water line diagram is essential for any homeowner looking to maintain or troubleshoot their appliance. By familiarizing yourself with the components, flow process, common issues, and maintenance practices, you can ensure that your refrigerator continues to provide fresh water and ice efficiently. Regular care and awareness of potential problems will help you avoid costly repairs and extend the life of your appliance. With the right knowledge and tools, managing your refrigerator's water line system can be a straightforward task, allowing you to enjoy the convenience it provides.

Frequently Asked Questions

What is the purpose of the water line diagram for a GE Profile refrigerator?

The water line diagram provides a detailed layout of how the water supply connects to the refrigerator, indicating the path of water from the source to the ice maker and water dispenser.

Where can I find the water line diagram for my GE Profile refrigerator model?

You can typically find the water line diagram in the user manual included with the refrigerator, or you can download it from the GE Appliances website by searching for your specific model number.

What are common issues that can be identified using the water line diagram?

Common issues include clogged lines, leaks, or incorrect connections, which can lead to problems such as insufficient water flow, ice maker malfunctions, or water pooling around the refrigerator.

How do I properly install the water line according to the GE Profile refrigerator diagram?

To install the water line properly, follow the diagram's instructions for routing the line, securing connections, and ensuring there are no kinks or sharp bends that could restrict water flow.

Can I modify the water line installation based on the diagram?

While you can modify the installation, it is important to adhere to the guidelines provided in the water line diagram to ensure proper function and prevent leaks. Consult a professional if unsure.

Find other PDF article:

<https://soc.up.edu.ph/11-plot/pdf?trackid=nVs56-4042&title=calvin-and-hobbes-lazy-sunday.pdf>

Ge Profile Refrigerator Water Line Diagram

Download and install Google Chrome

How to install Chrome Important: Before you download, you can check if Chrome supports your operating system and other system requirements.

□□□□□□□□□□? - □□

...
 ...

GE Online [R 1000 - 1000](#)

GE Online R

□□□□Under review□Awaiting Recommendation□□□□ ...

under review [REDACTED] under review [REDACTED] awaiting
recommendaion[REDACTED] ...

edge[0][0][0][0][0] - 00

```
edge[0] edge[1] win10 ...
```

□□□□ **M** □□□□ - □□□□

Dec 27, 2023 · M

GeForce MX150 - 4GB

Jun 10, 2017 · MX150 2GB GDDR5 1469mhz boost 1532mhz 6008mhz
GP108 3 SM 384SP ...

□□□□□□□□? - □□

0000000000 00 00 00 0000 0000 00 [1]00 “000XXX”0“000XXX”0“XXX”0 [2]00 00000000“00”0000000000000000
 0000“0000 ...

Gemini Apps Help - Google Help

Official Gemini Apps Help Center where you can find tips and tutorials on using Gemini Apps and other answers to frequently asked questions.

win11????????? - ?

win11??...

Download and install Google Chrome

How to install Chrome Important: Before you download, you can check if Chrome supports your operating system and other system requirements.

????????????? - ?

??16??
...

GE Online ???? R ??? - ????

????GE Online ???? R??

?????Under review?Awaiting Recommendation????? ...

under review ?? under review ??????????????awaiting
recommendaion????????????????????????????? ...

edge???????????? - ?

??edge????????????????????????edge????????????????? ??win10??
???????? ...

???? M ??? - ????

Dec 27, 2023 · ?????????? M??

????????????GeForce?MX150 ???? - ?

Jun 10, 2017 · MX150?2GB????GDDR5????????????1469mhz?boost????1532mhz????????6008mhz????
????GP108????3?SM?384SP????? ...

????????????? - ?

????????????? ?? ?? ?? ?? ?? ?? [1]?? “???XXX”?“???XXX”?“XXX” [2]?? ?????????“??”????????????????????
????“????? ...

Gemini Apps Help - Google Help

Official Gemini Apps Help Center where you can find tips and tutorials on using Gemini Apps and other answers to frequently asked questions.

win11????????????? - ?

win11??...

Discover how to effectively navigate your GE Profile refrigerator water line diagram. Get clear insights and expert tips for optimal installation and maintenance. Learn more!

[Back to Home](#)